

CLINTON CREEK CRACK  
MONITORING

6324 TO 6385

TOP OF STEEP SLOPE

NOTES 6355 TO 6356



CRACK TIES OLD & NEW

~~NEW~~ NEW

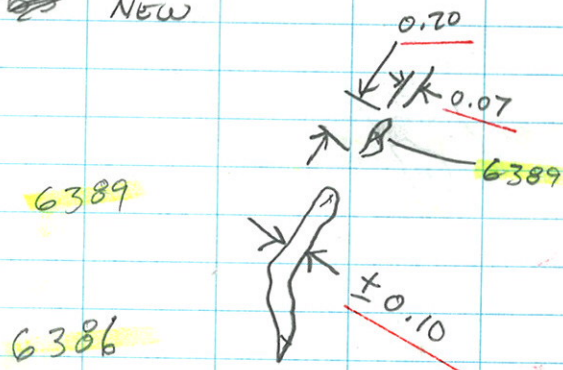

Return to Plan

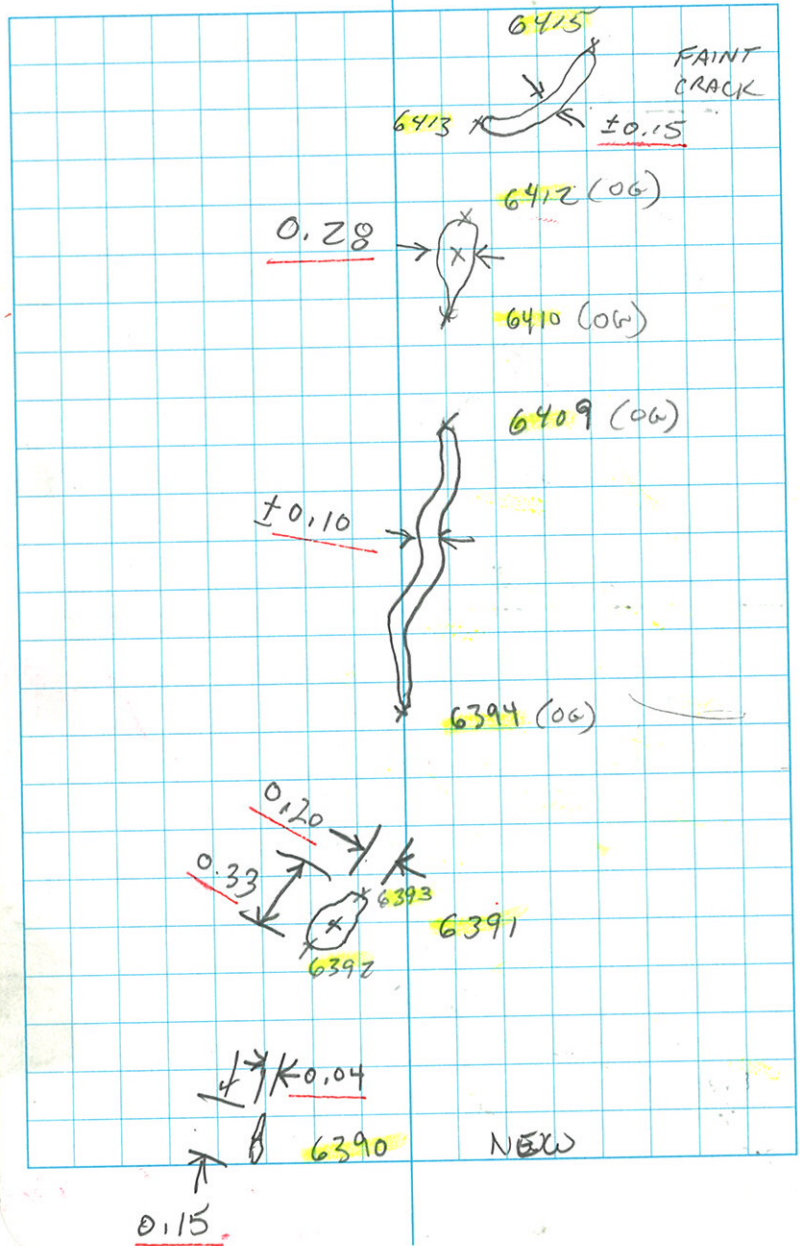

No.352

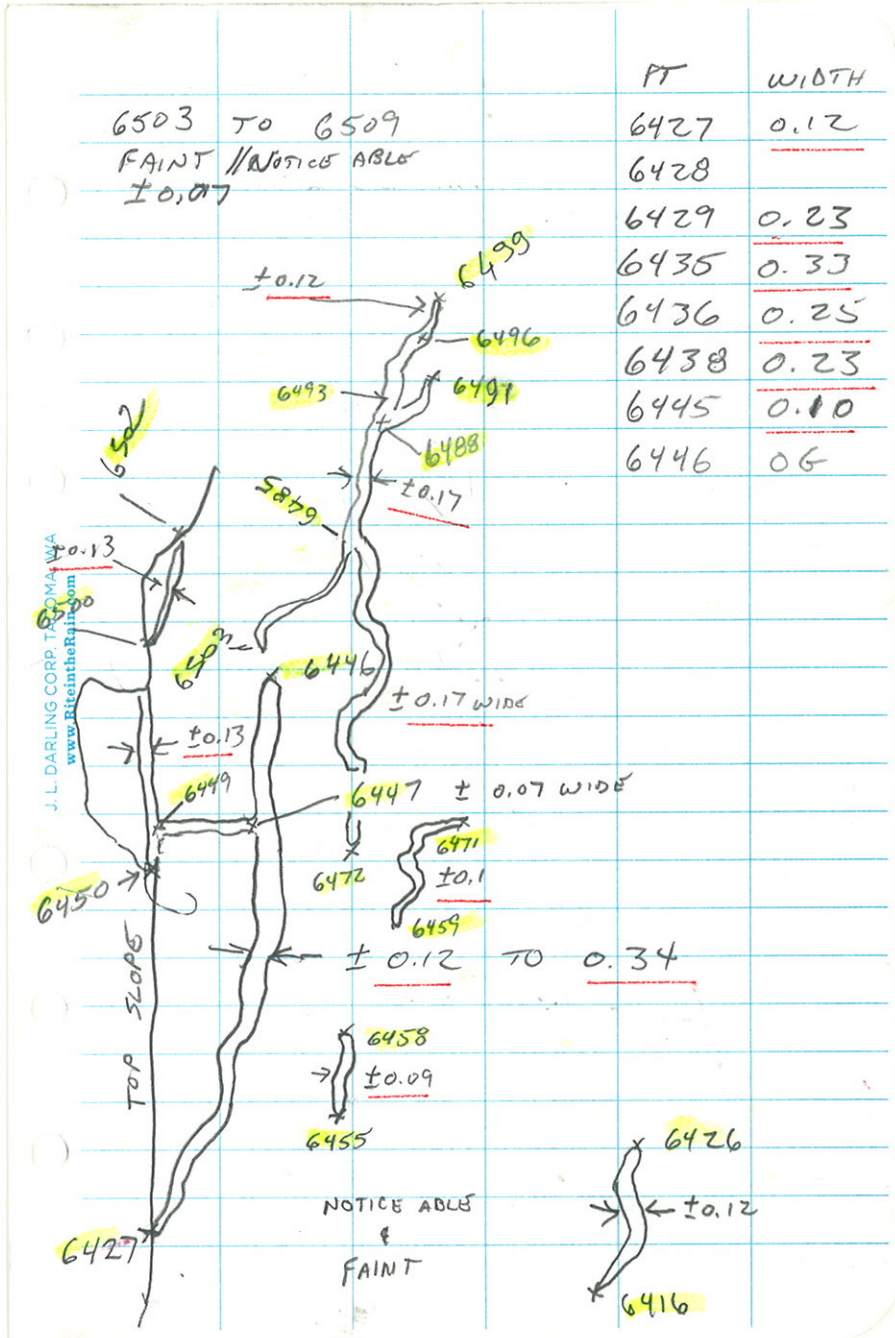

Return to River

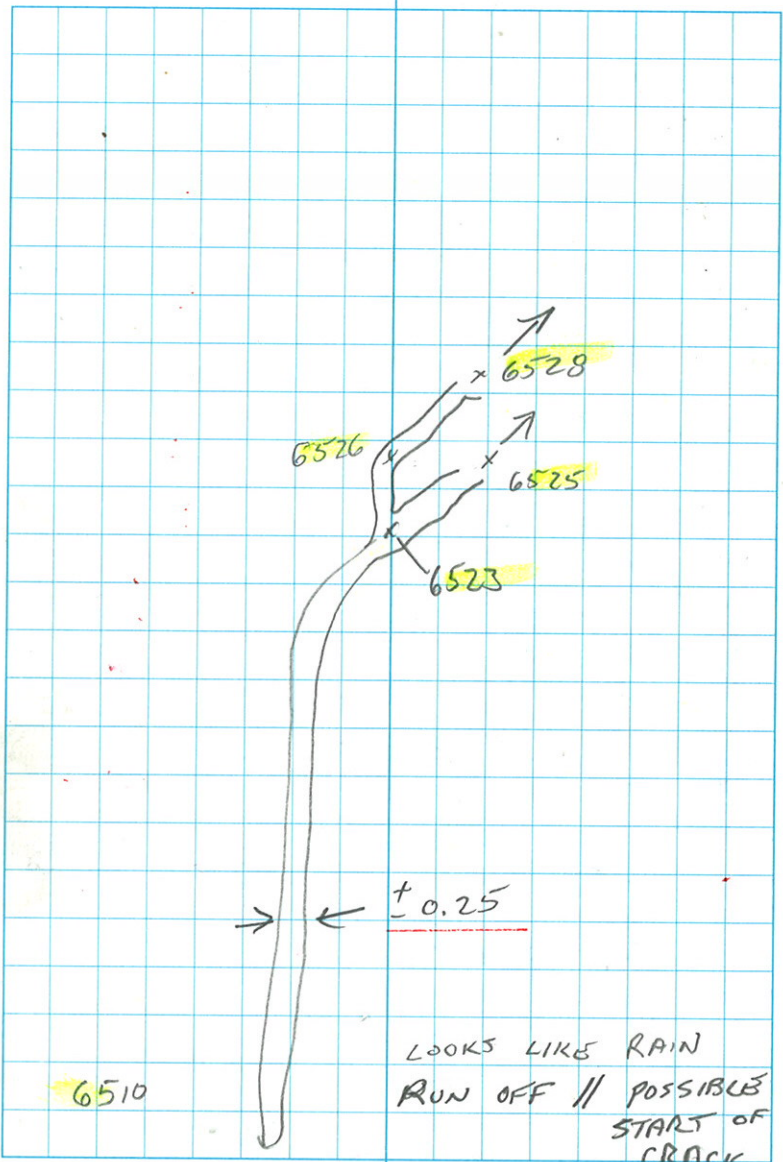

No. 352

J.L. DARLING CORP. TACOMA, WA  
www.RiteintheRain.com

6529	→	6531		
		FAINT CRACK	<u>± 0.1</u>	WIDG
6532	→	6536	<u>± 0.06</u>	
6537	→	6541	<u>± 0.07</u>	} FAINT & NOTICE ABLE
6542	→	6546	"	
6547	→	6551	<u>± 0.15</u>	} NOTICE ABLE
6552	→	6566	<u>± 0.20</u>	
6567	→	6592	<u>± 0.12</u>	FAINT
6593	→	6595	<u>± 0.10</u>	FAINT
6596	→	6598	<u>± 0.07</u>	FAINT//Not
6599	→	6607	<u>± 0.10</u>	NOTICE ABLE
6608	→	6613	<u>± 0.10</u>	FAINT NOT.

