

Addendum

To

Historical Review
Of
Former United Keno Hill Mines LTD
Quartz Claims

Site Maps and GPS Locations

Keno Hill

Volume #1

Prepared for
Assessment and Abandoned Mines Branch
Energy Mines and Resources
Government of Yukon

By
McQuesten Lake Enterprises

March 2007

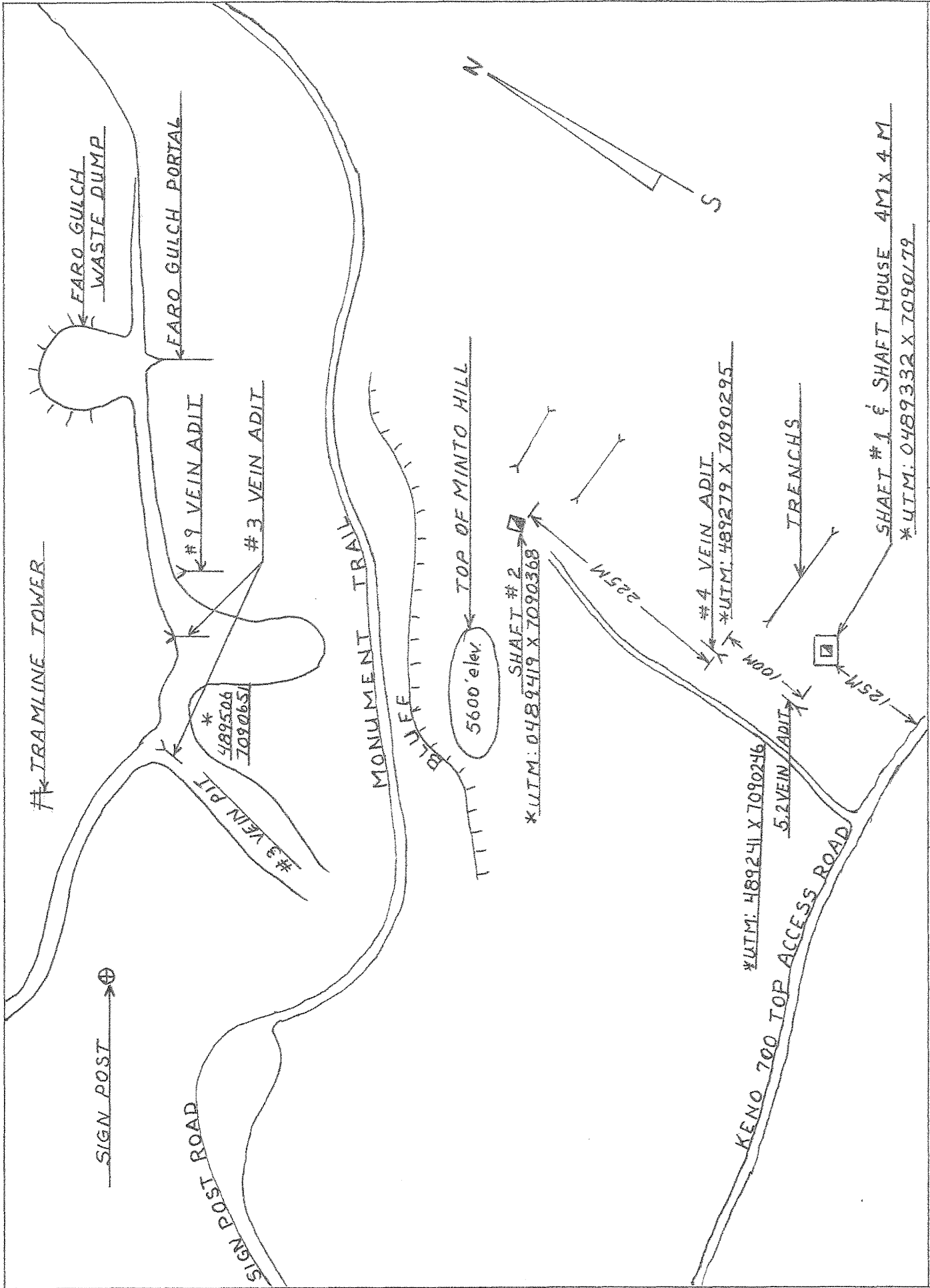

SITE: TOP OF THE HILL SITE DR BY: McQuesten Lake Ent. SCALE: 25mm = 100M MARCH, 23, 2007

*UTM: 0488212 x 7090764

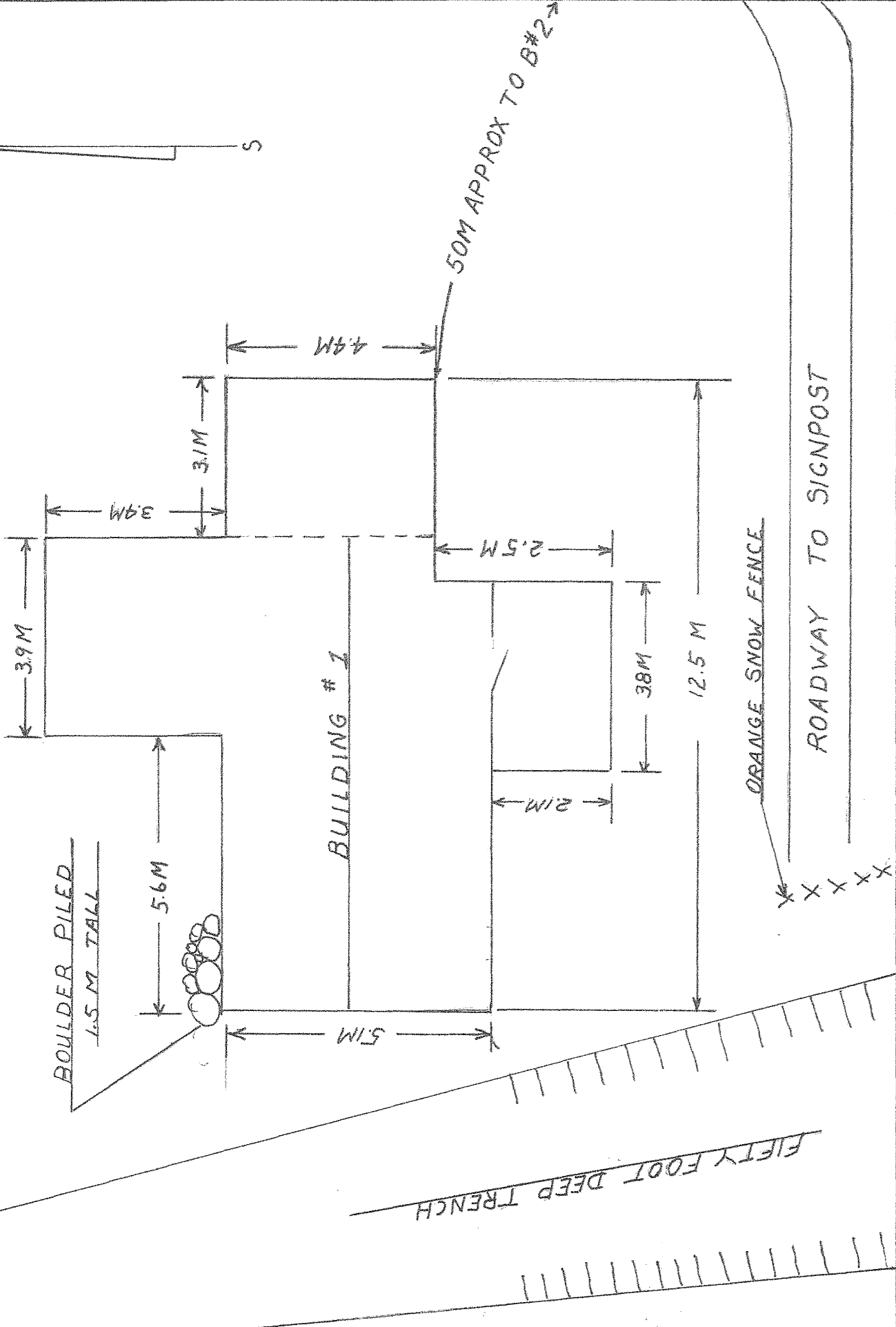
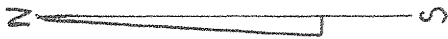

ROADWAY TO SIGNPOST

MARCH, 21, 2007

SCALE: 10mm = 1 M

DR BY: McQuesten Lake Ent.

SITE: SHAMROCK B # 1

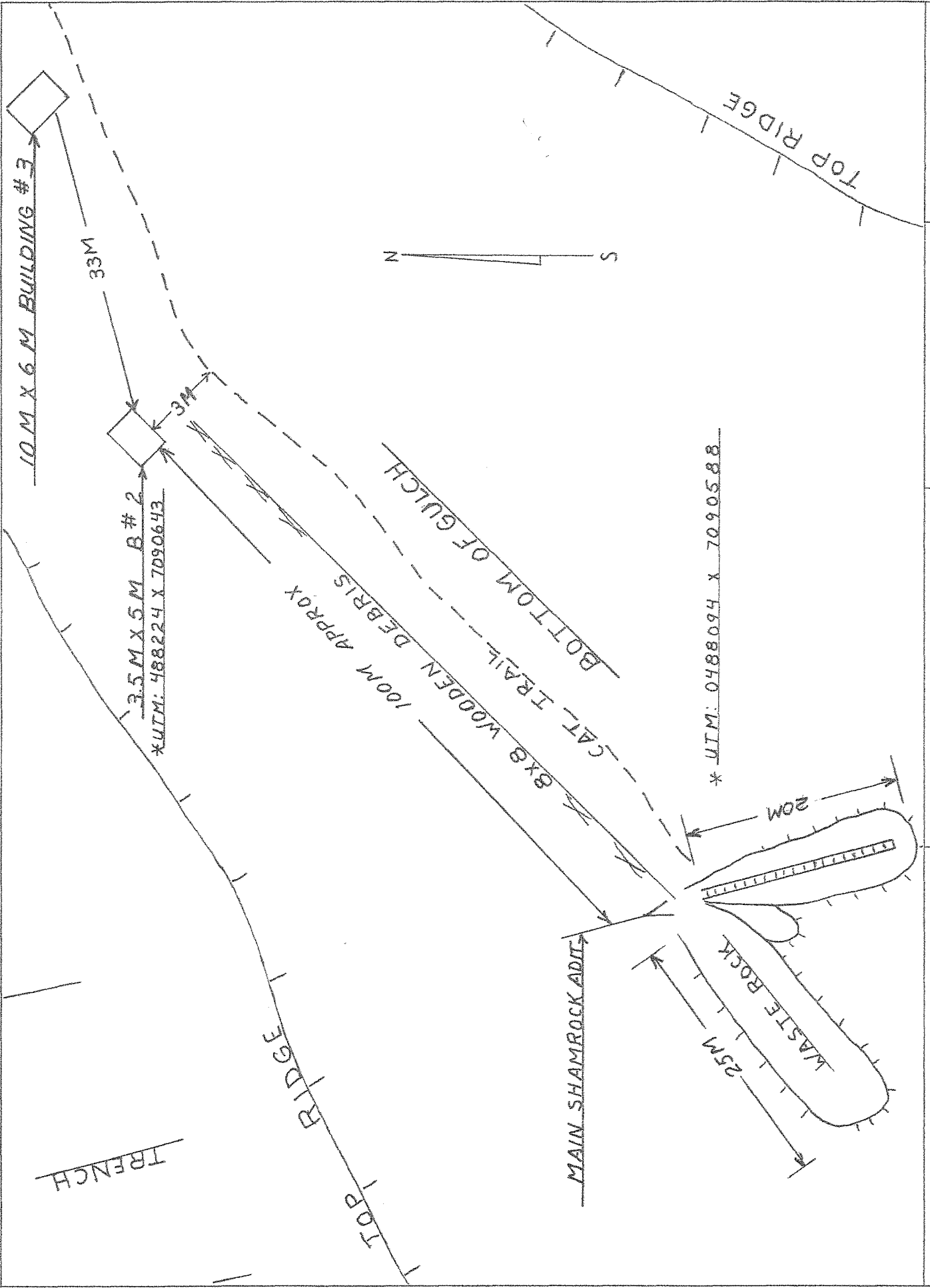

MARCH 22, 2007	SCALE: 20mm = 10M	DR BY: McQuesten Lake Ent.	SITE: SHAMROCK, B#1 & 2 & ADIT
----------------	-------------------	----------------------------	--------------------------------

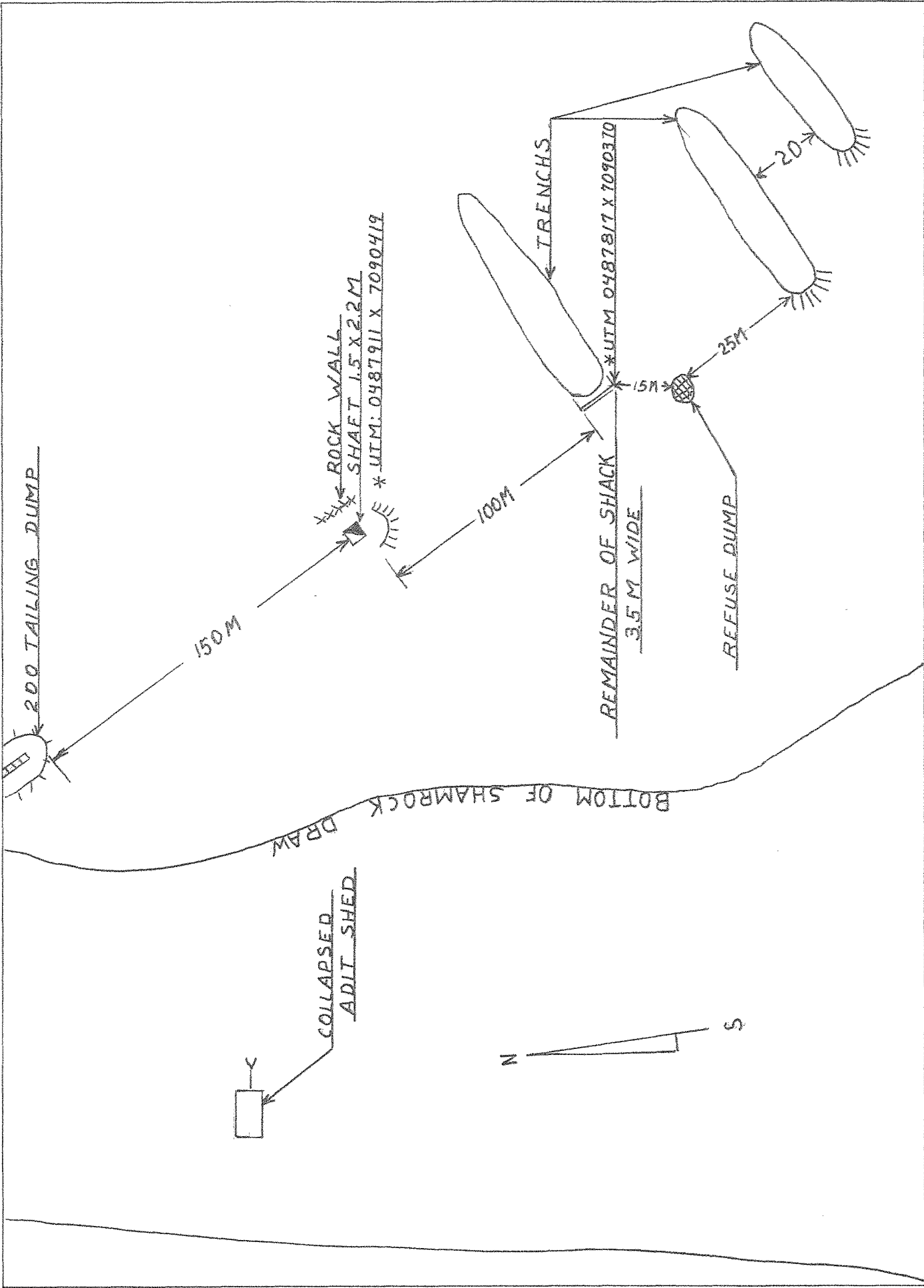

MARCH, 22, 2007

SCALE: NOT TO SCALE

DR BY: McQuesten Lake Ent.

SITE: SHAMROCK, SHAFT, & SHACK

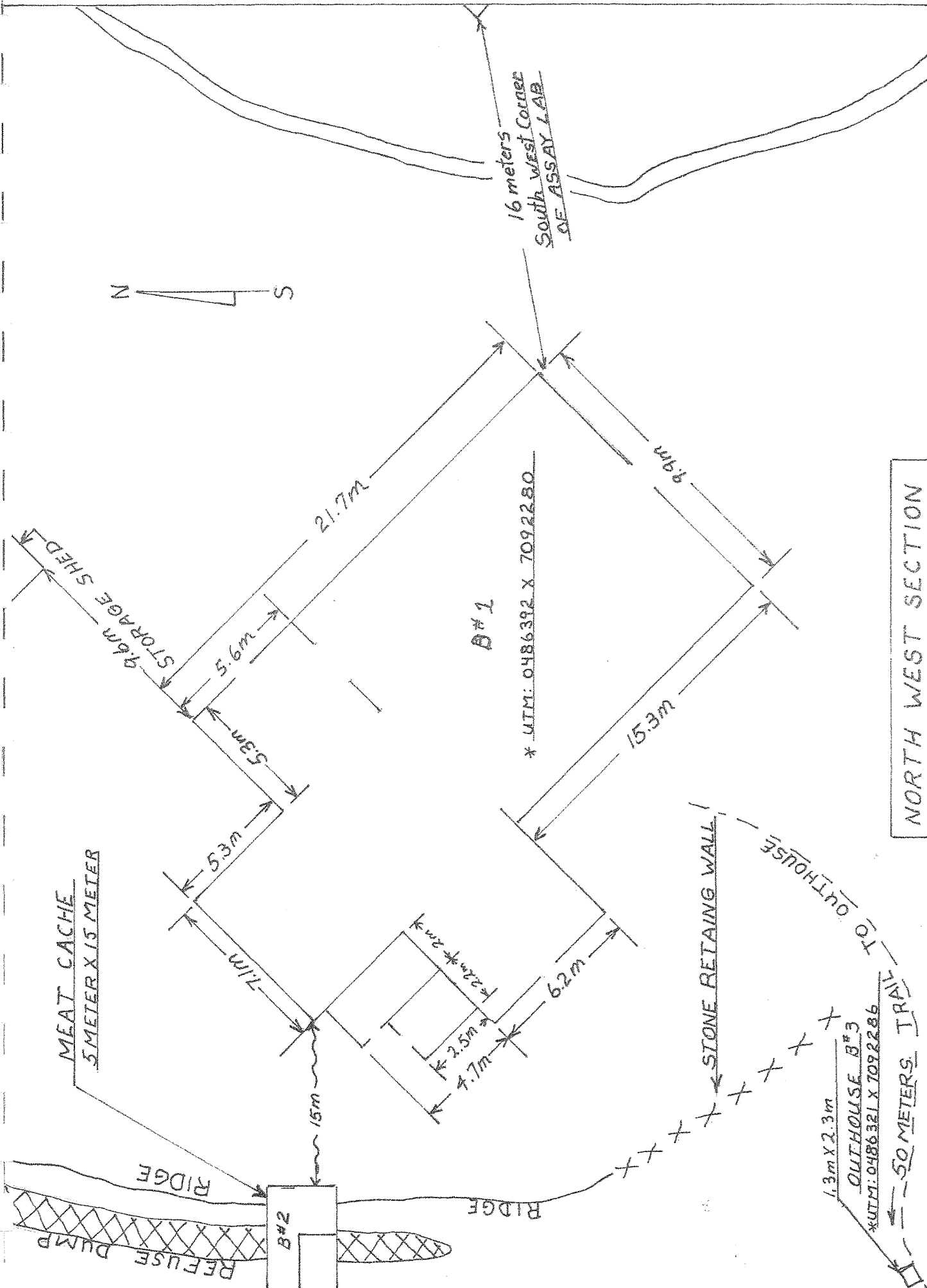

NORTH WEST SECTION
SITE: WERNECKE KITCHEN

SCALE : 5mm = 1 METER

McQuesten Lake Ent. 2006

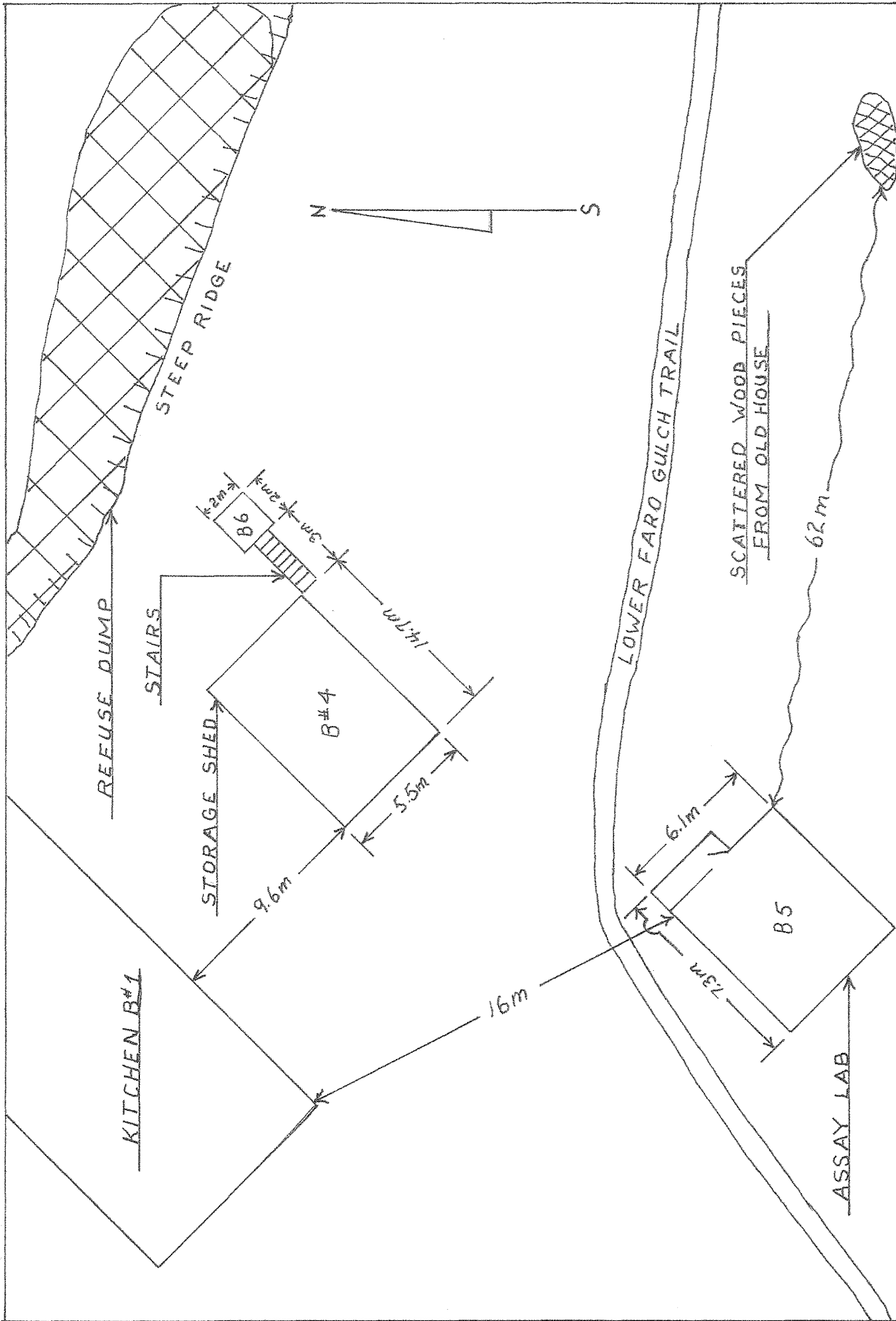

ASSAY BUILDING, STORAGE SHED, NORTH WEST SECTION OF SITE

SCALE : 5mm = 1M

SITE: WERNECKE

McQuesten Lake Ent. 2007

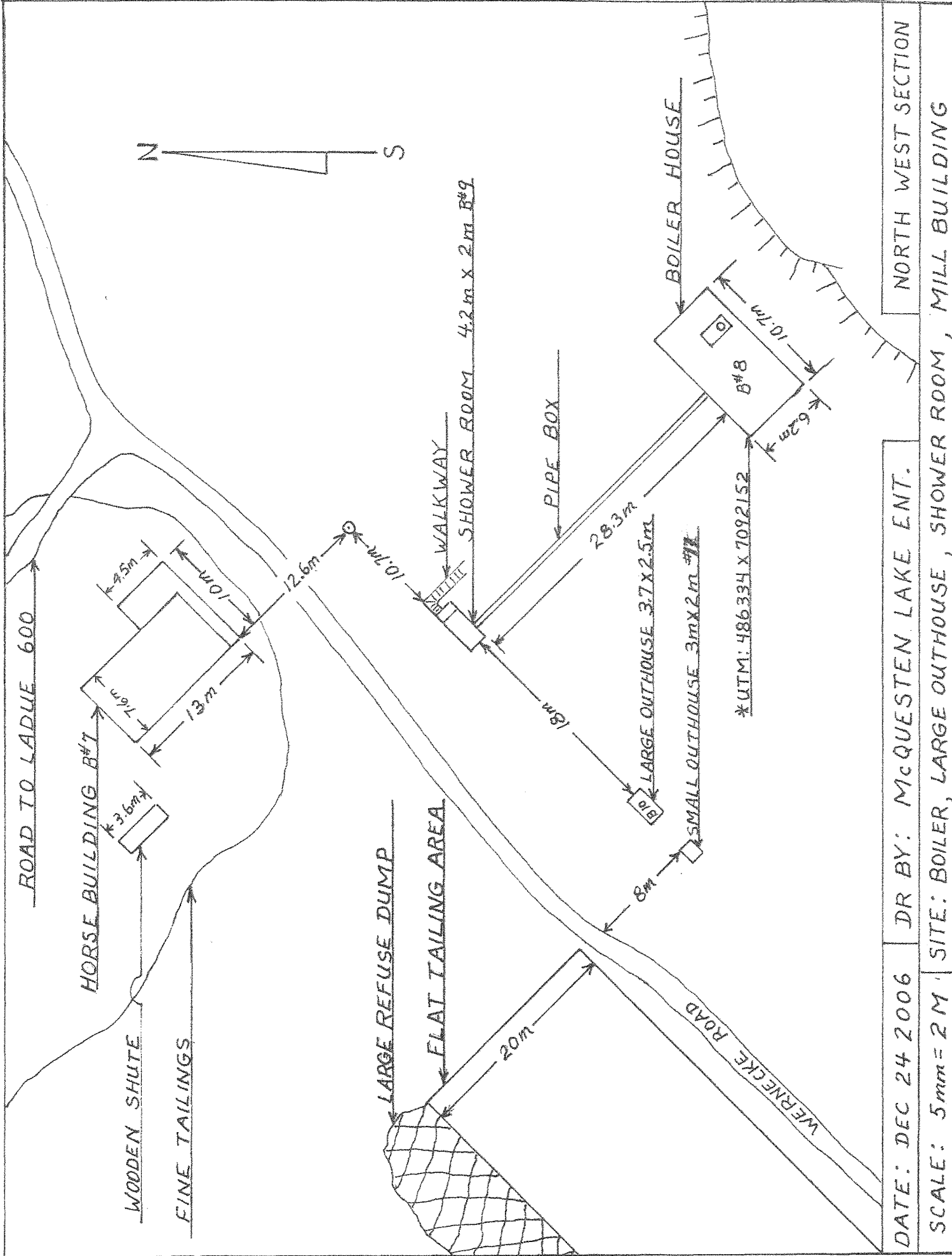

DATE: DEC 24 2006 DR BY: McQUESTEN LAKE ENT.
 SCALE: 5mm = 2M SITE: BOILER, LARGE OUTHOUSE, SHOWER ROOM, MILL BUILDING

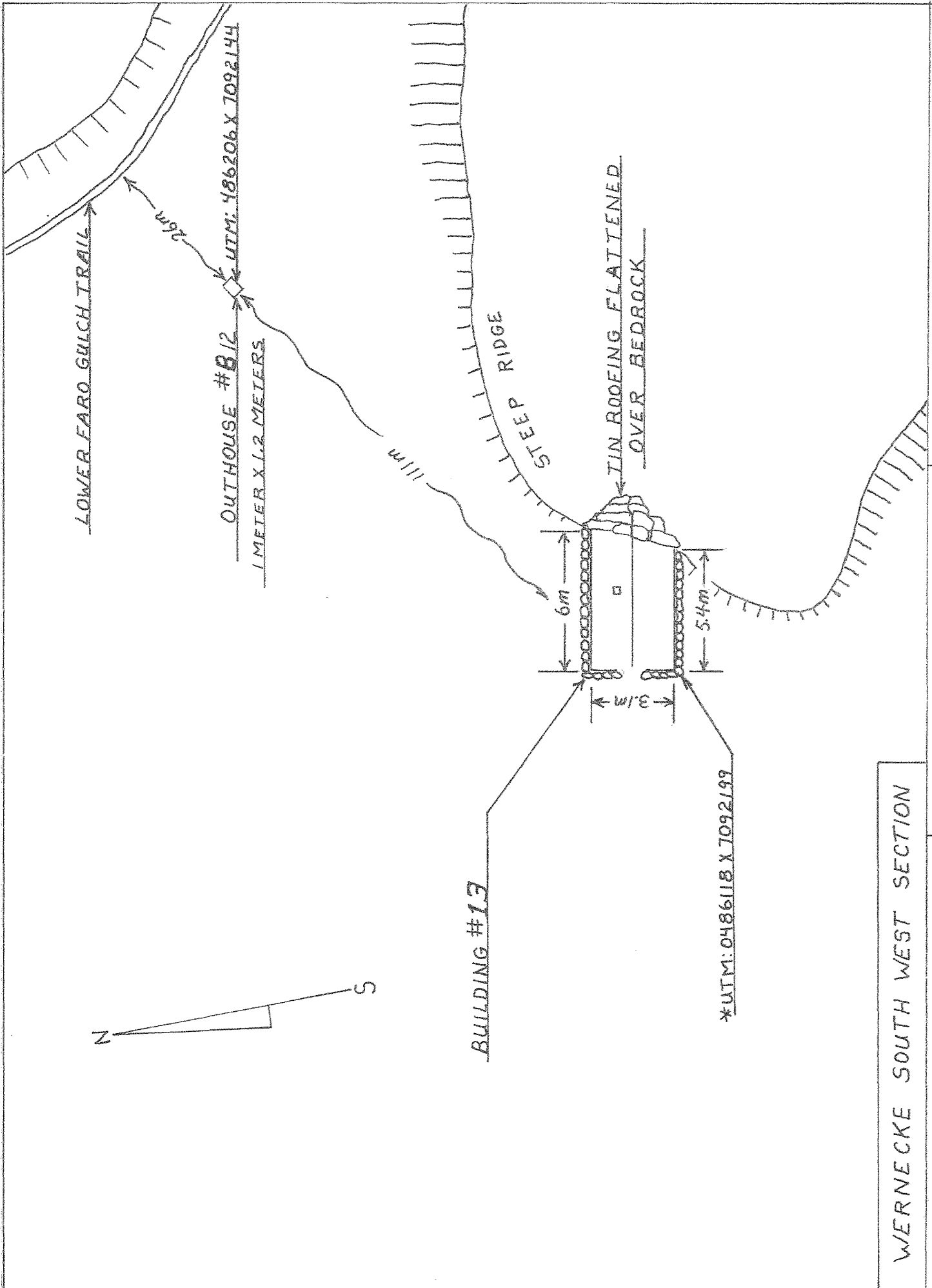

BUILDING #13

*UTM: 0486118 X 7092199

LOWER FARO GULCH TRAIL

OUTHOUSE #B12
1 METER X 1.2 METERS

*UTM: 486206 X 7092144

2.6m

STEEP RIDGE

TIN ROOFING FLATTENED
OVER BEDROCK

6m

5.4m

3.1m



WERNECKE SOUTH WEST SECTION

SCALE : 5m = 1 METER

SITE: STONE HOUSE

McQuesten Lake Ent. 2006

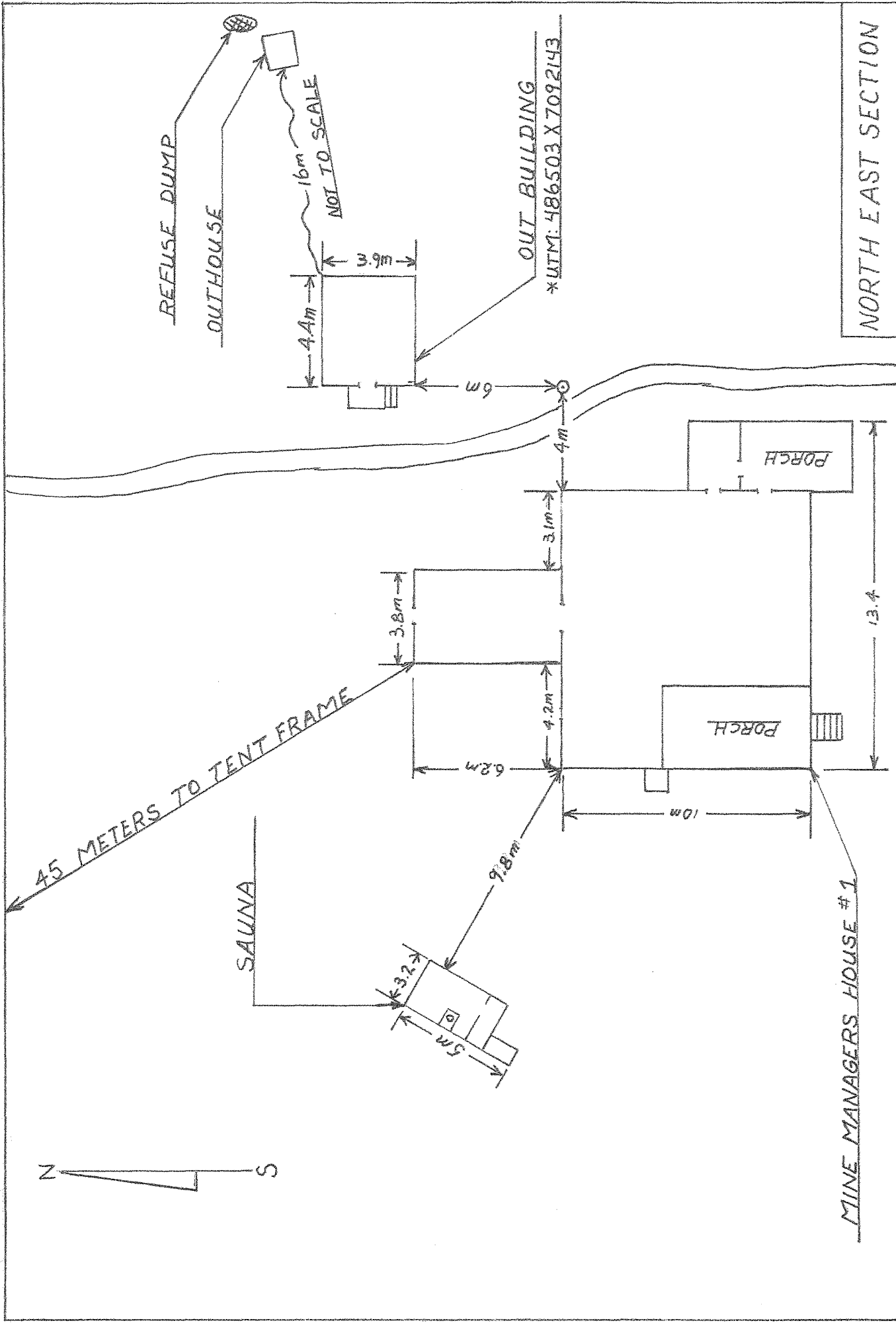

NORTH EAST SECTION

MINE MANAGER HOUSE, OUT BUILDING, SAUNA, TENT FRAME, REFUSE

SCALE : 5mm = 1M SITE: WERNECKE McQuesten Lake Ent. 2006

PART OF TRANSERE
STATION

LADUE #2 SHAFT
1.5 M X 1.5 M

* UTM: 486435 X 7092152

2.5' x 2.5'

2.5'

15.6 M

20 M

OUTHOUSE # 1.4 M X 1.4 M
OVER VENT RAISE SHAFT

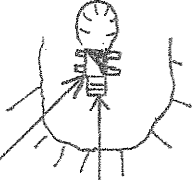

TRANSERE STATION

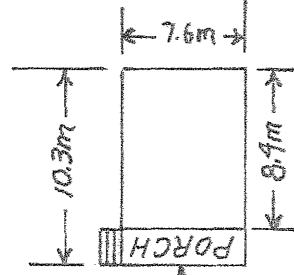
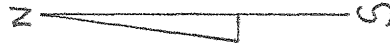

RESIDENCE #
* UTM: 486469 X 7092075

NORTH EAST SECTION

SCALE : 5m = 2 METERS

SITE: WERNECKE

McQuester Lake Ent. 2007

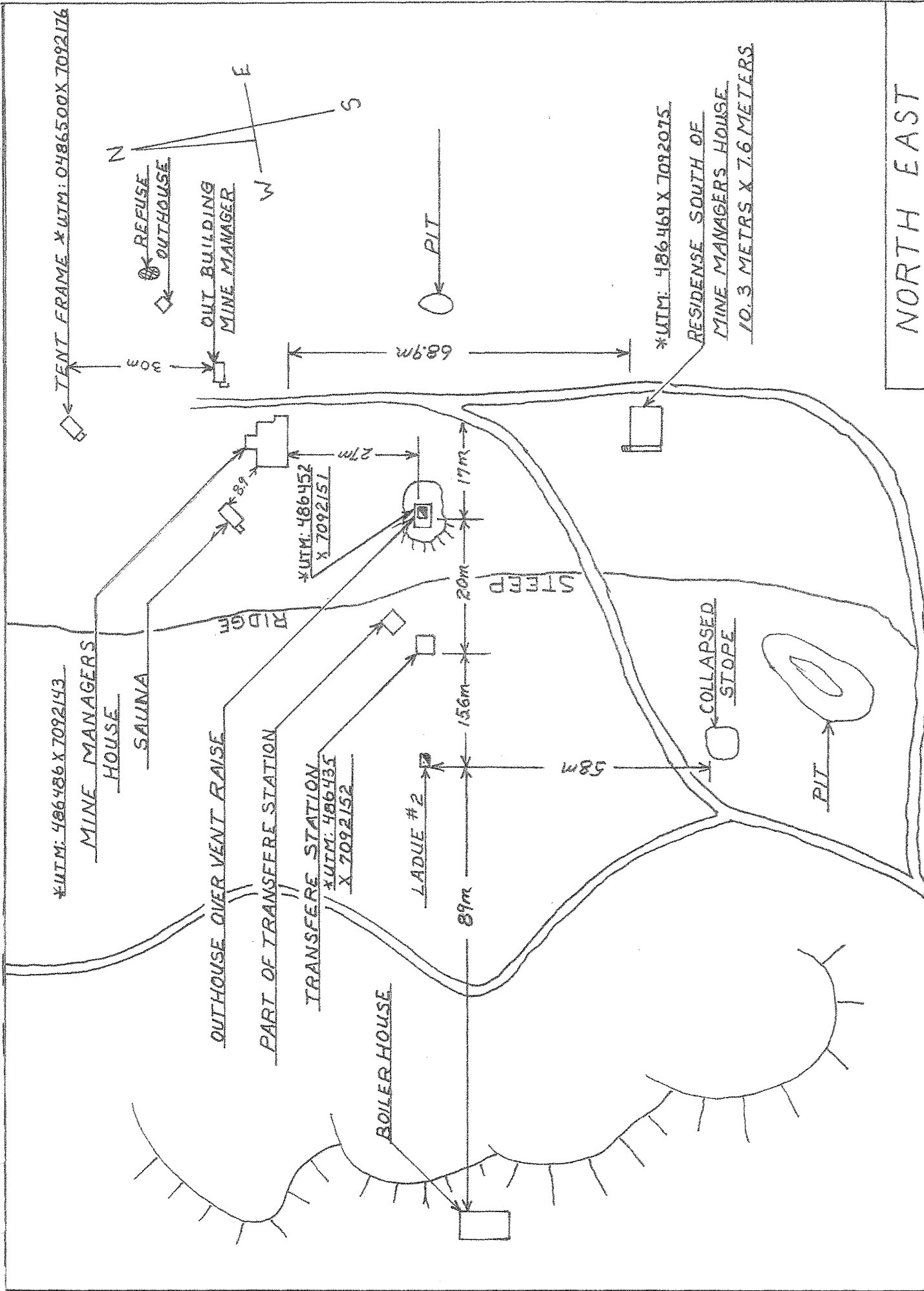

SCALE : 5mm = 5 METERS

SITE: WERNECKE

McQuesten Lake Ent. 2006

NORTH EAST

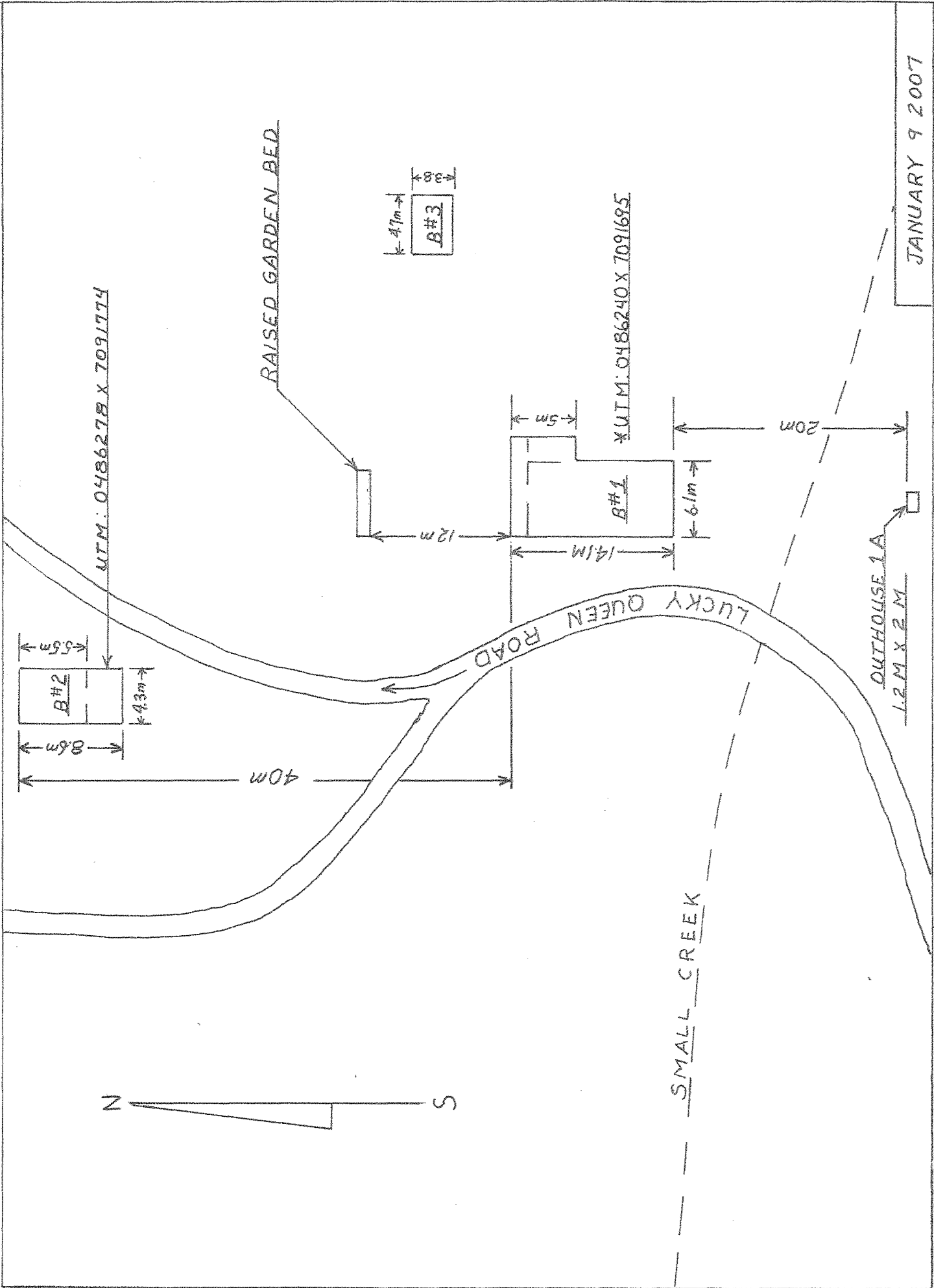

JANUARY 9 2007

SCALE: 5m = 2 METERS WERNECKE SOUTH EAST SECTION DR BY: McQUESTEN LAKE ENT.

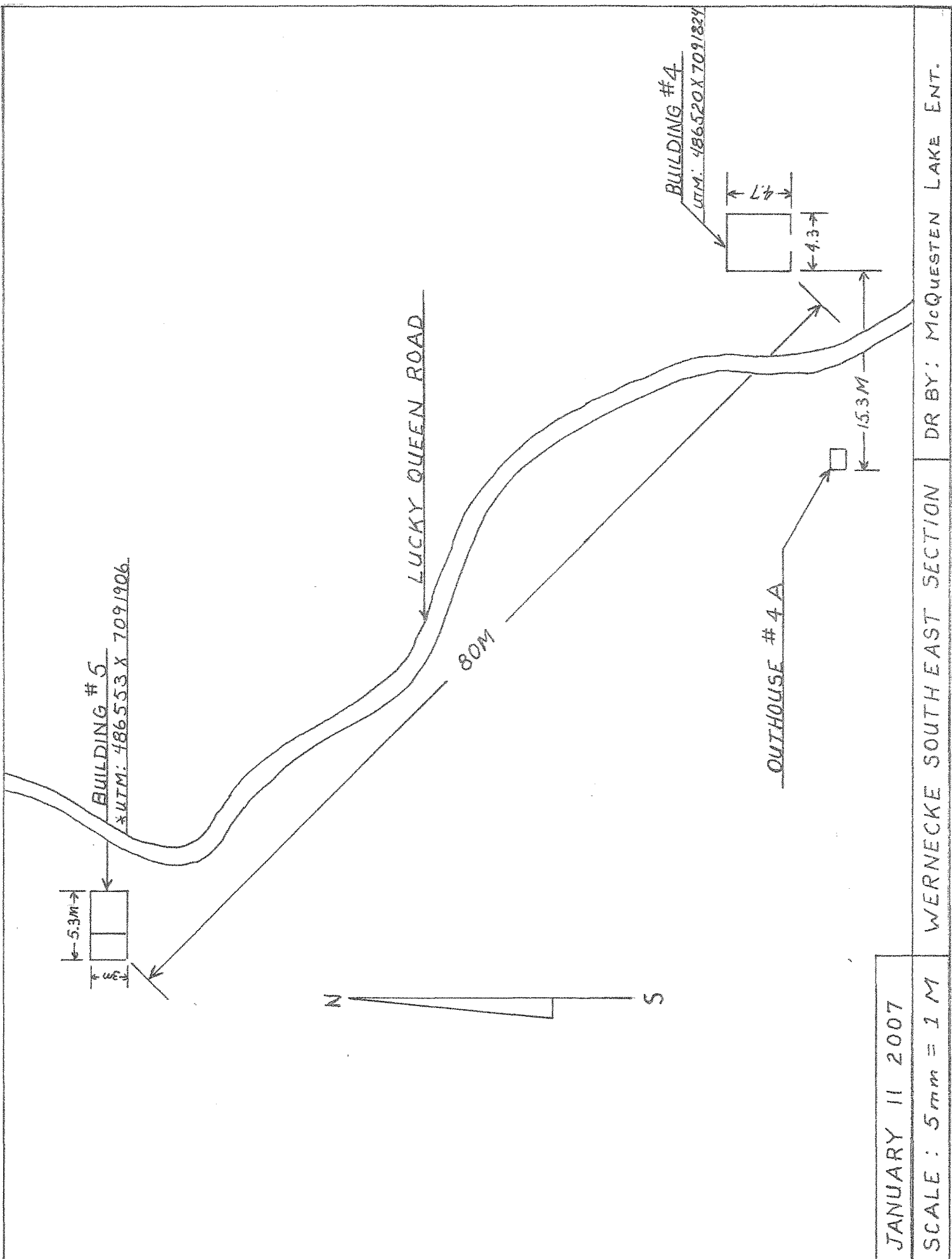

JANUARY 11 2007

SCALE : 5mm = 1M

WERNECKE SOUTH EAST SECTION

DR BY: McQUESTEN LAKE ENT.

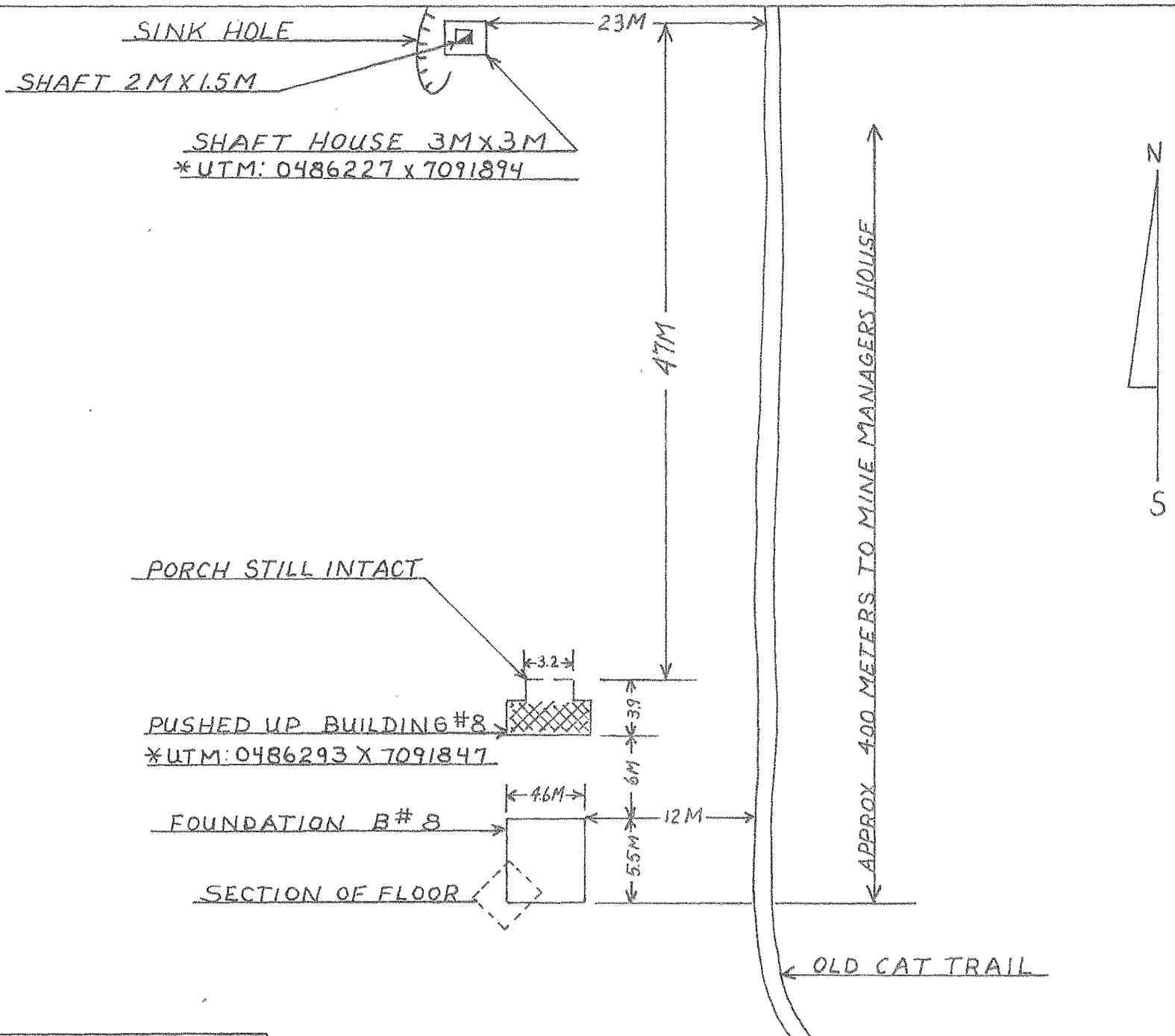

DATE: JANUARY 10 2007

SCALE: 5mm = 2M

WERNECKE, SOUTH EAST SECTION

DR BY: McQUESTEN LAKE ENT.

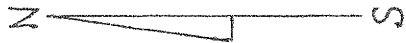

WERNECKE ROAD

47m

15m

2m x 2m Outhouse B*1A

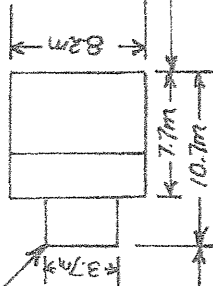

30m

BUILDING # 1

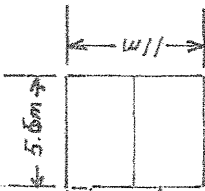

1.3m WIDE STEPS

BUILDING # 2

SCALE: 5mm = 2 METERS

WERNECKE SOUTH WEST SECTION

SITE: WERNECKE RESIDENCES # 1 & 2

McQUESTEN LAKE ENT. DEC 23 2006

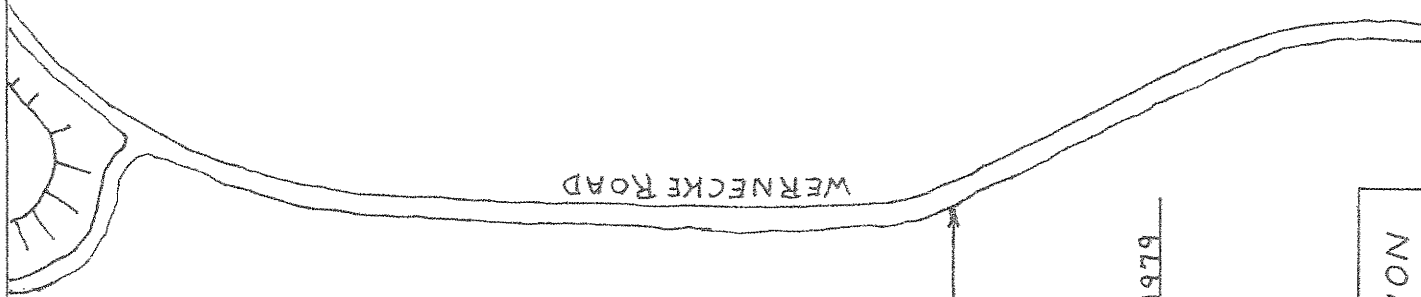
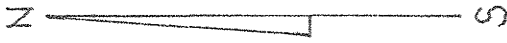

OUTHOUSE 1A

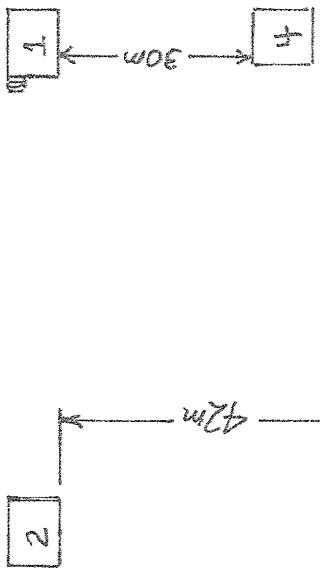

40m

REFUSE
DUMPS

SHED# 5

* UTM: 0486182 X 7091979

WERNECKE SOUTH BUILDINGS OVERVIEW SOUTH WEST SECTION

SCALE : NOT TO SCALE

SITE : #1, 2, 3, 4 & SHED

McQuester Lake Ent. 2006

WERNECKE ROAD

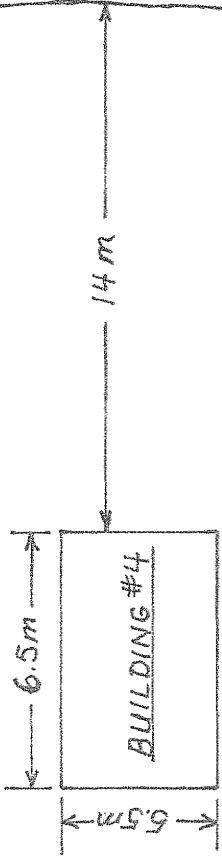

40m

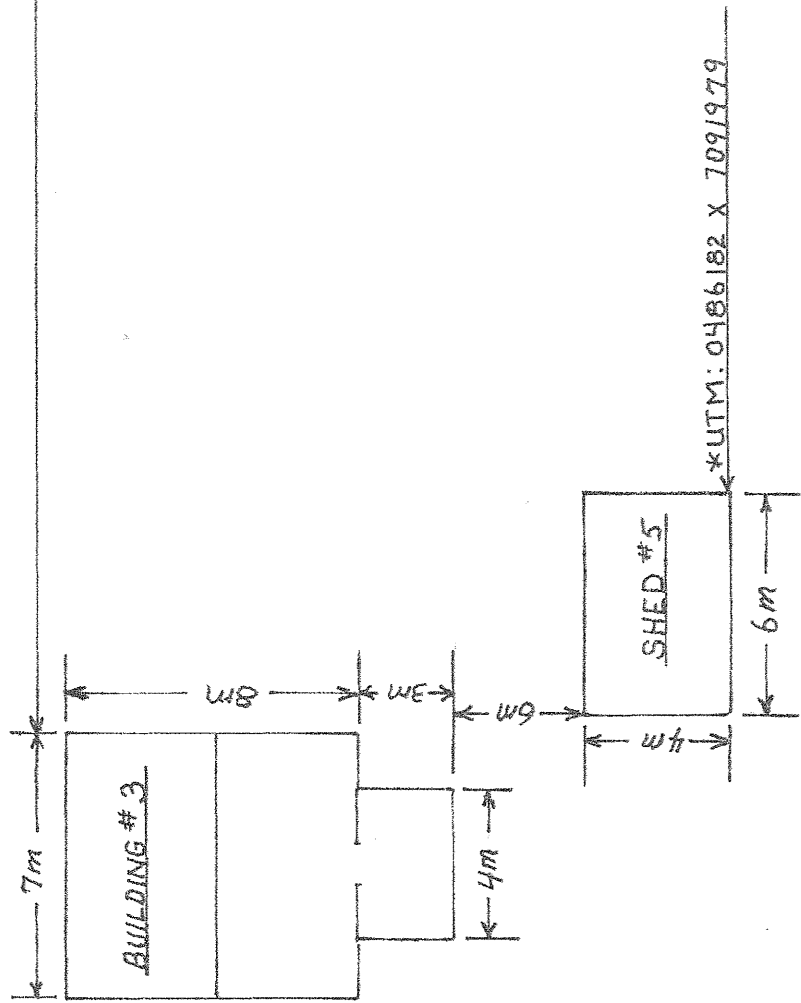
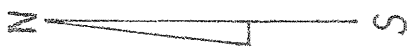

WERNECKE SOUTH WEST SECTION

SCALE : 10mm = 2 METERS SITE : BUILDING#3, 4, 5 McQuesten Lake Ent. 2006

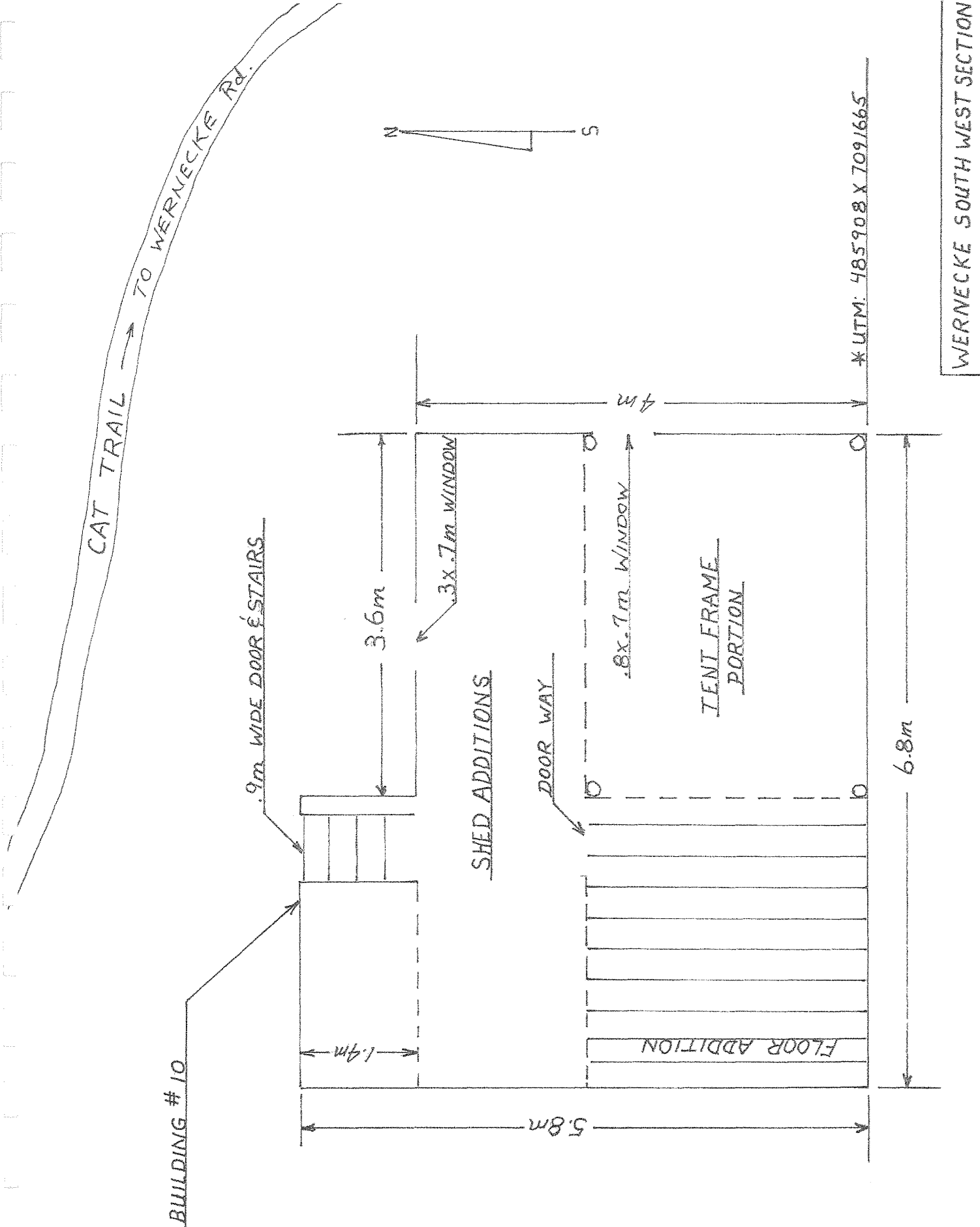

SCALE : 1 cm = .5 METER SITE : CROSS CABIN McQuesten Lake Ent 2006

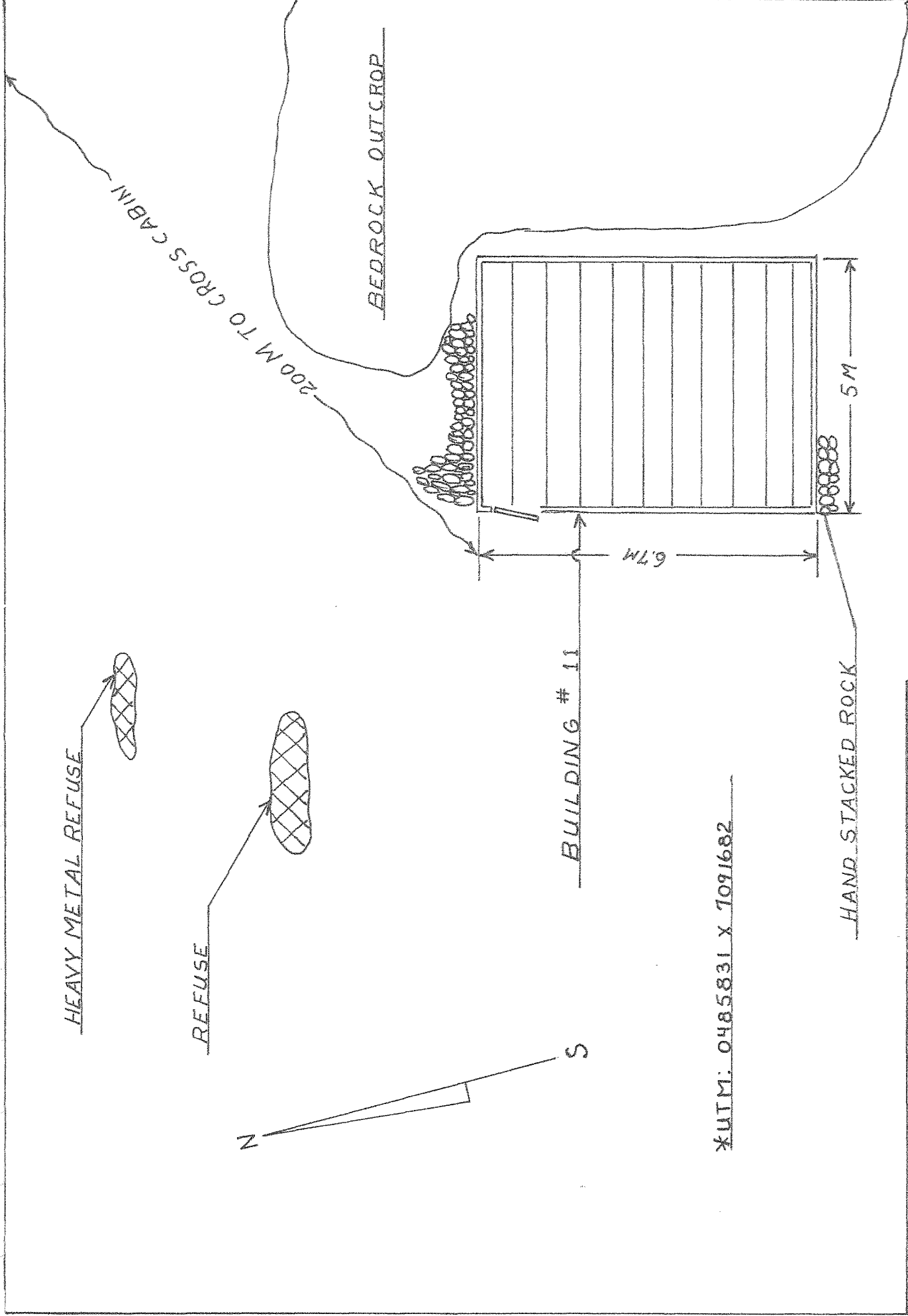

WERNECKE SOUTH WEST SECTION

SCALE : 10 mm = 1 METER

SITE : BARREL SHACK

McQuesten Lake Ent. 2007

*UTM: 0485831 X 7091682

TO SMARCH CABIN

TO CROSS CABIN

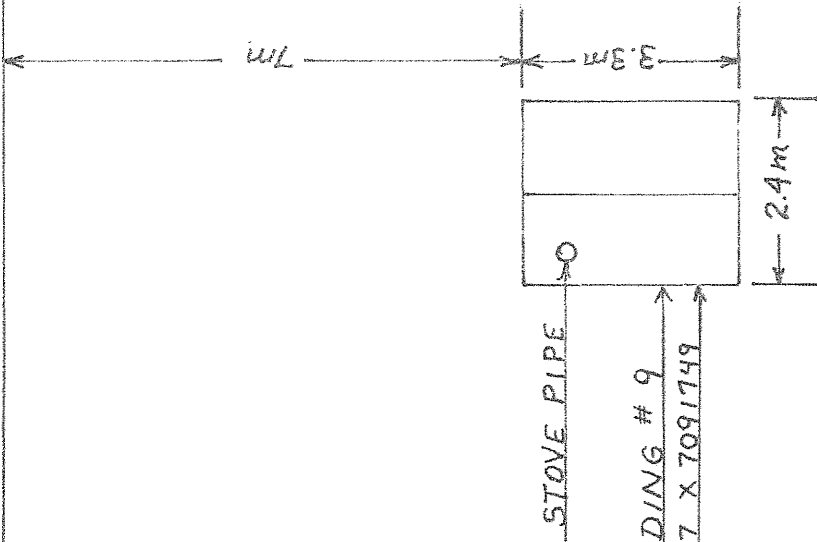
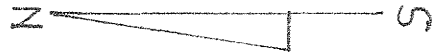

STOVE PIPE

BUILDING # 9

*UTM: 0485857 X 7091749

WERNECKE SOUTH WEST SECTION

SCALE : 1 Cm = .5 METER

SITE : SMOKE HOUSE

McQuesten Lake Ent. 2006

SMARCHES CABIN
BUILDING #9
*UTM 0485576 X 7092118



1000m

SMOKE HOUSE
TENT B#8

150m

REMAINS OF OUTHOUSE

22m

CROSSES CABIN
BUILDING #6
*UTM: 0485857 X 7091749

WORKED
AREA

REFUSE DUMPS

WERNECKE ROAD

WERNECKE SOUTH WEST SECTION

SCALE: N/A

DEC 1 2006 McQuesten Lake Ent.

TRENCH

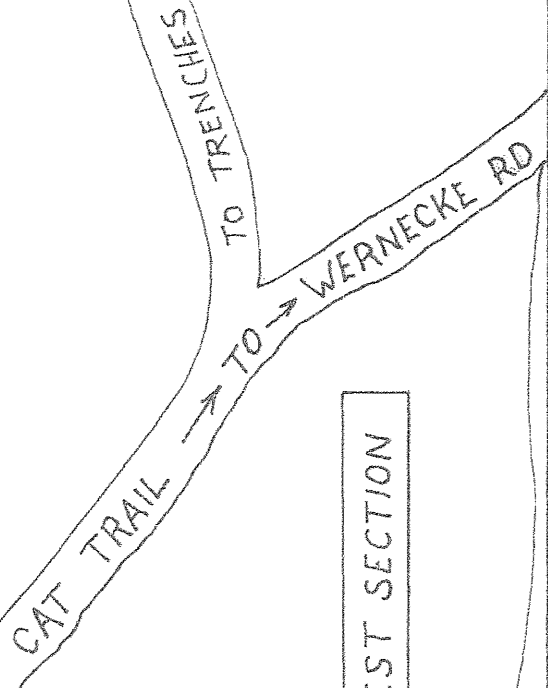
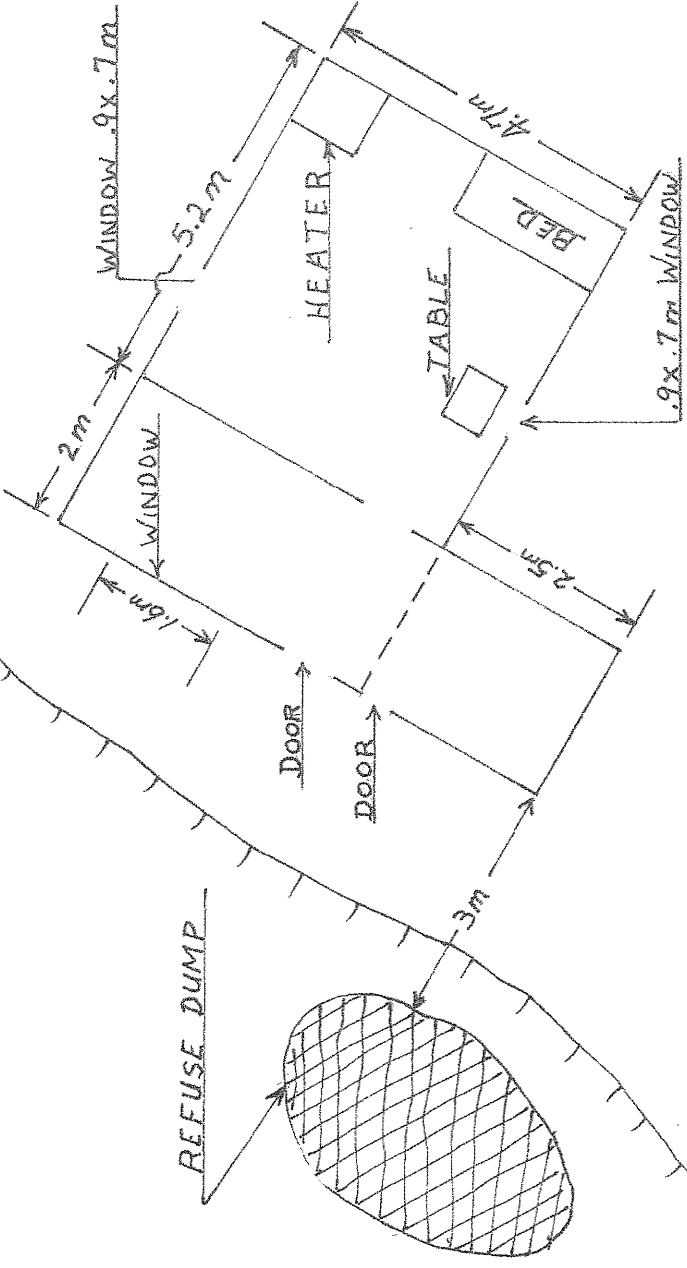

BUILDING #9
*UTM: 0485576 X 7092118

WERNECKE SOUTH WEST SECTION

CLEARED AREA

SCALE: 1cm = 1 M SITE: SMARCHES CABIN McQuesten Lake Ent. 2006

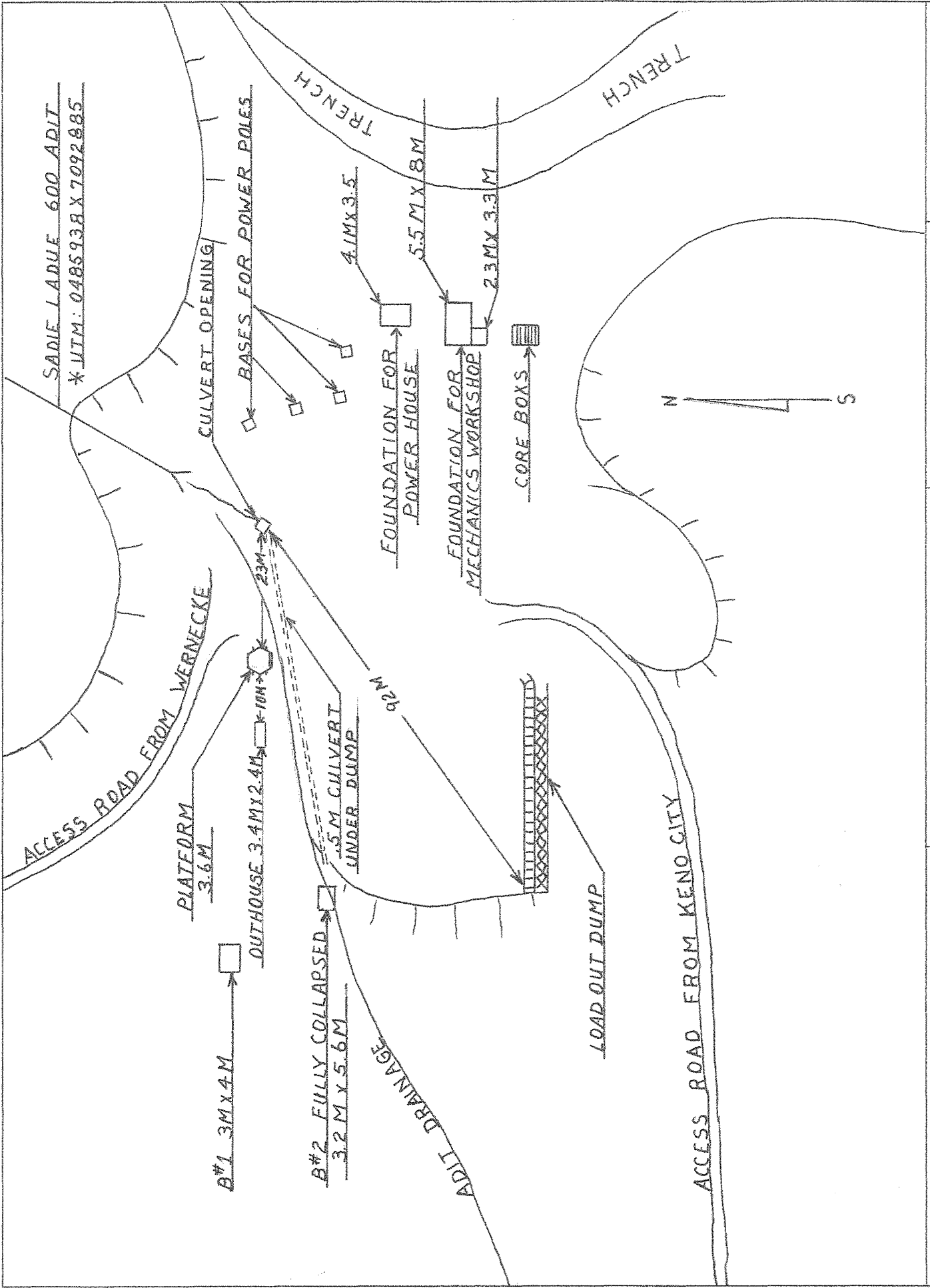

SITE: SADIE LADUE 600 ADIT	DR BY: McQueen Lake Ent.	SCALE: 1m = 1 M	MARCH, 24, 2007
----------------------------	--------------------------	-----------------	-----------------

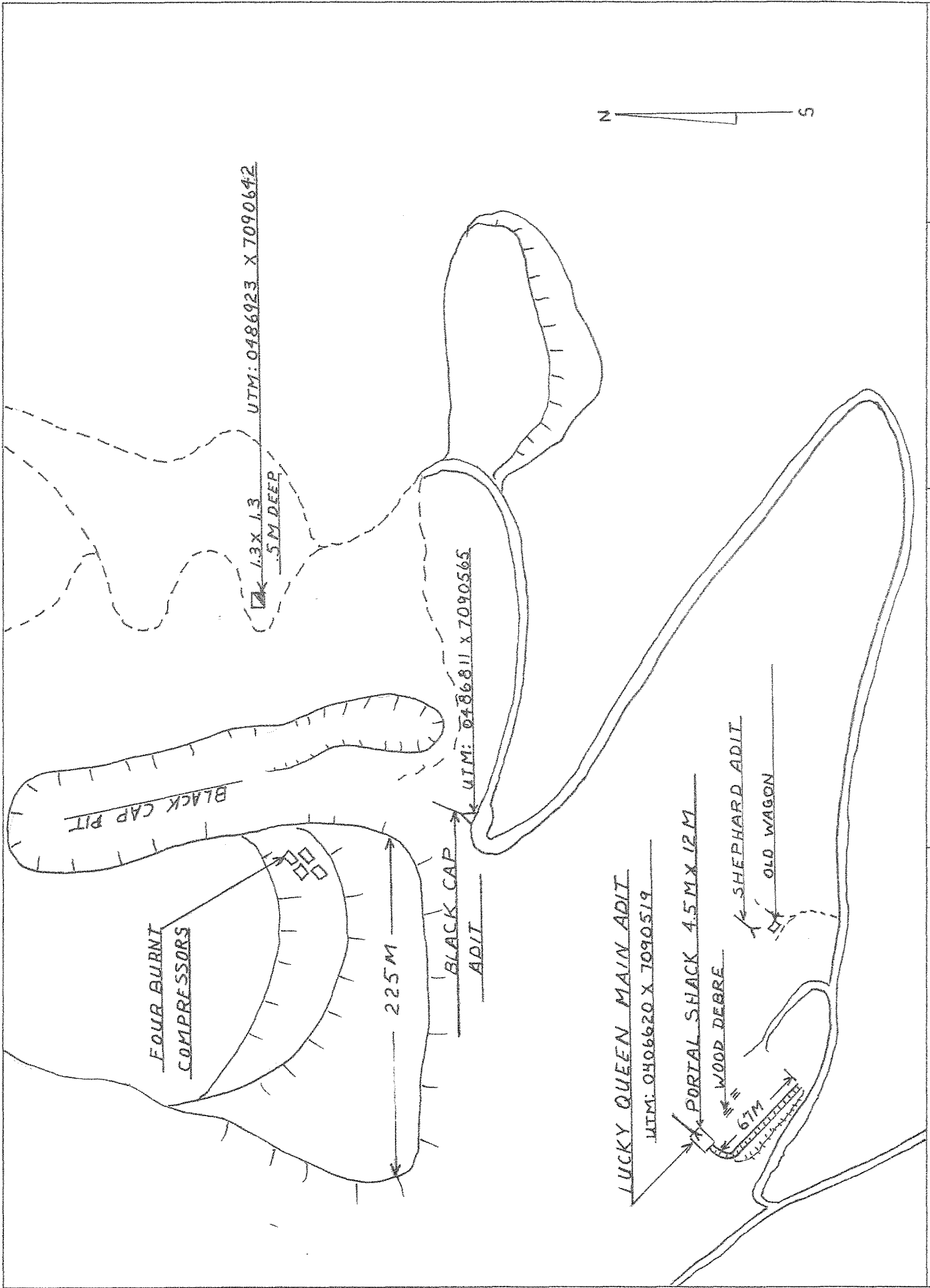

SITE: LUCKY QUEEN 500 / BLACK CAP DR BY: McQuesten Lake Ent. SCALE: NOT TO SCALE MARCH 24, 2007

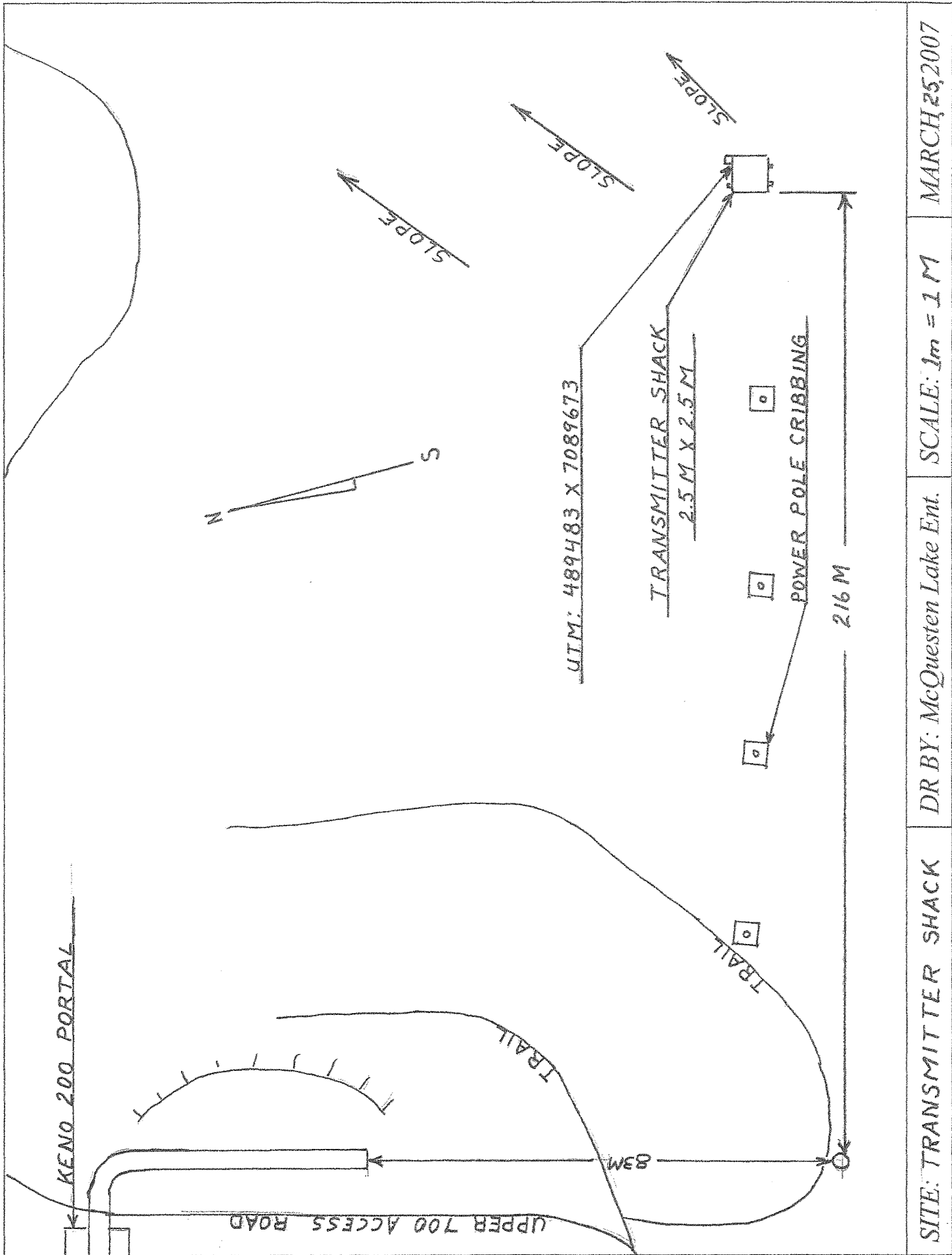

MARCH 25, 2007

SCALE: 1m = 1M

DR BY: McQuesten Lake Ent.

SITE: TRANSMITTER SHACK

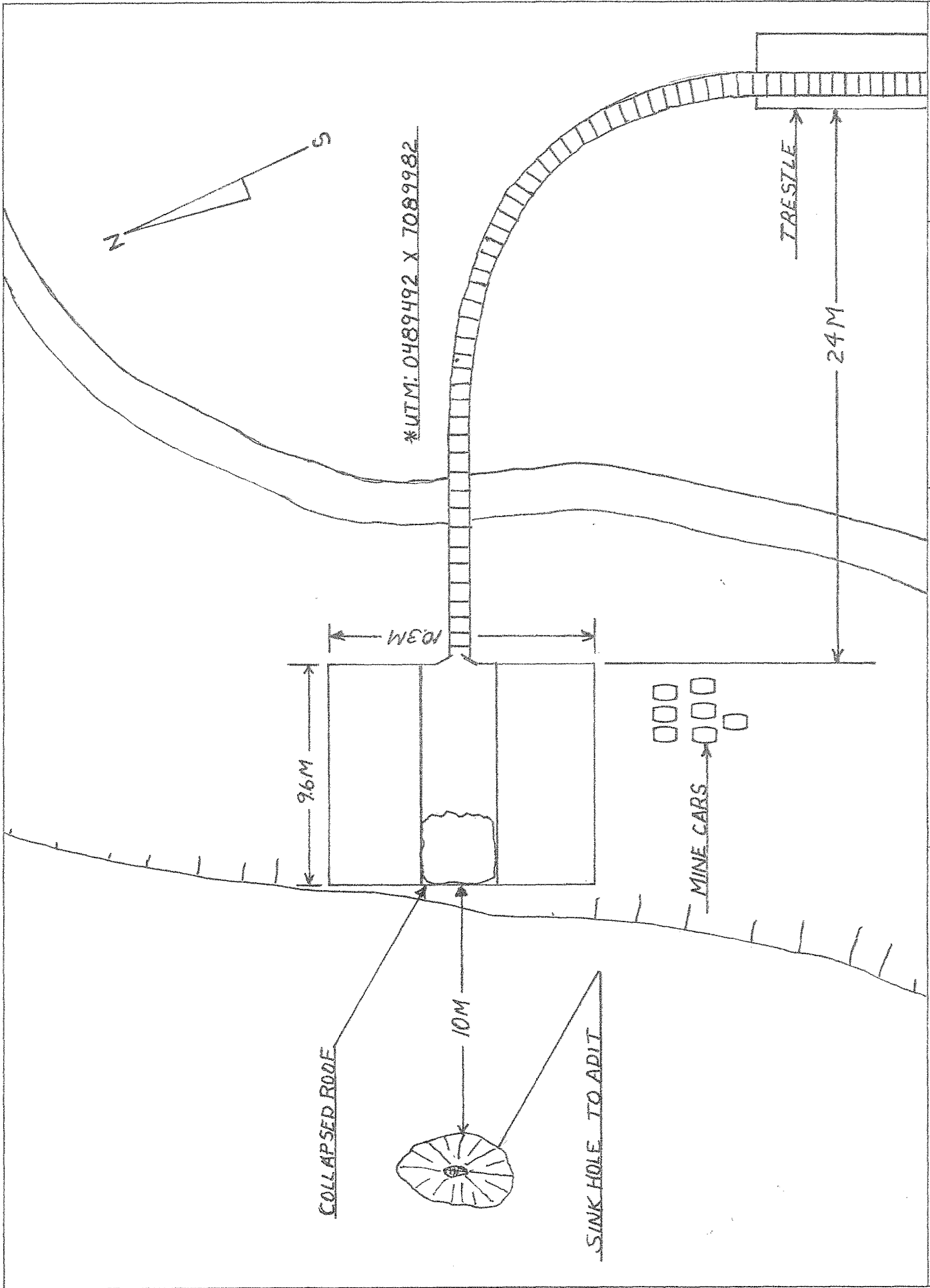

SITE: KENO 700/200 PORTAL DR BY: McQuesten Lake Ent. SCALE: 10mm = 2M MARCH, 15, 2007

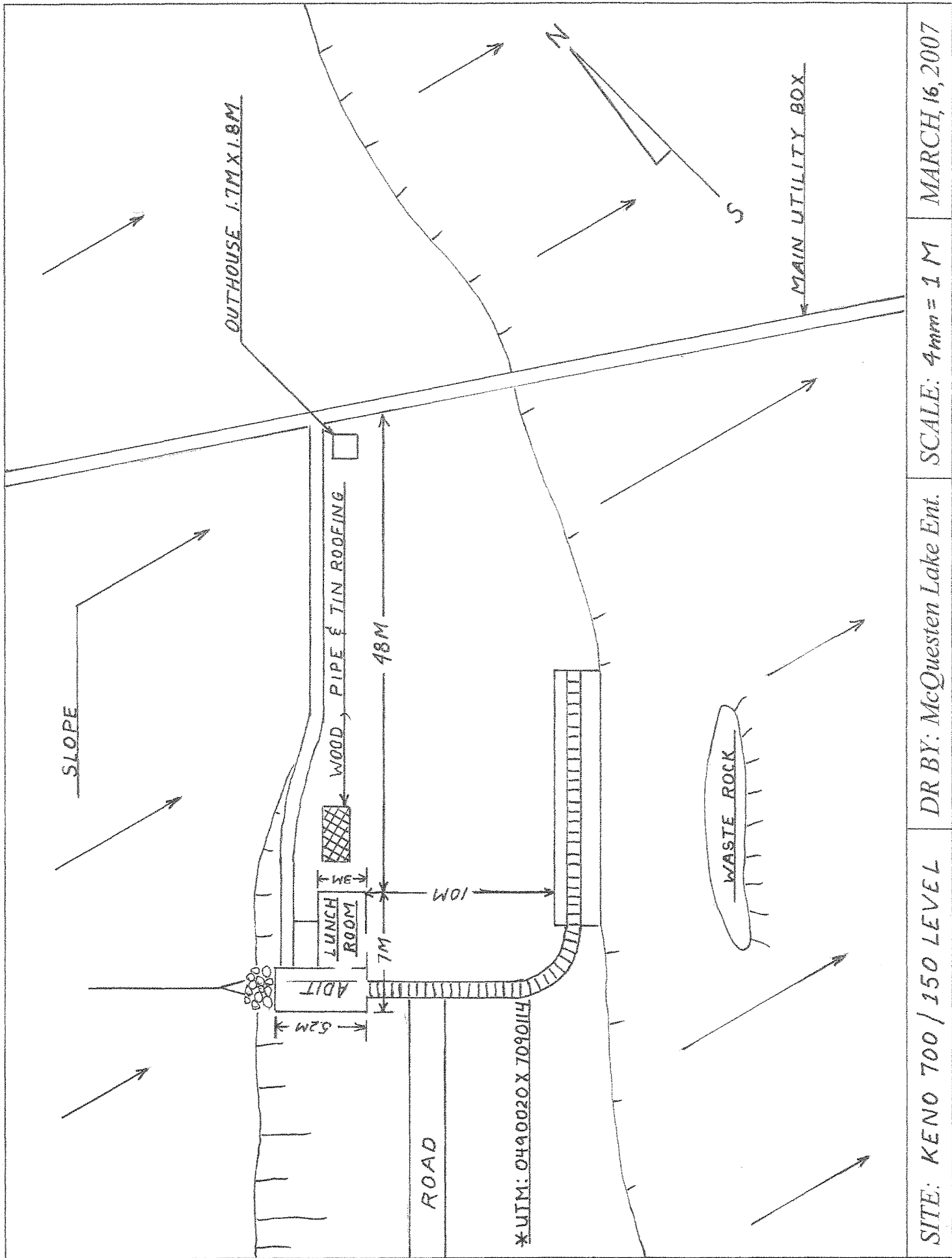

SITE: KENO 700 / 150 LEVEL DR BY: McQuesten Lake Ent. SCALE: 4mm = 1 M MARCH, 16, 2007

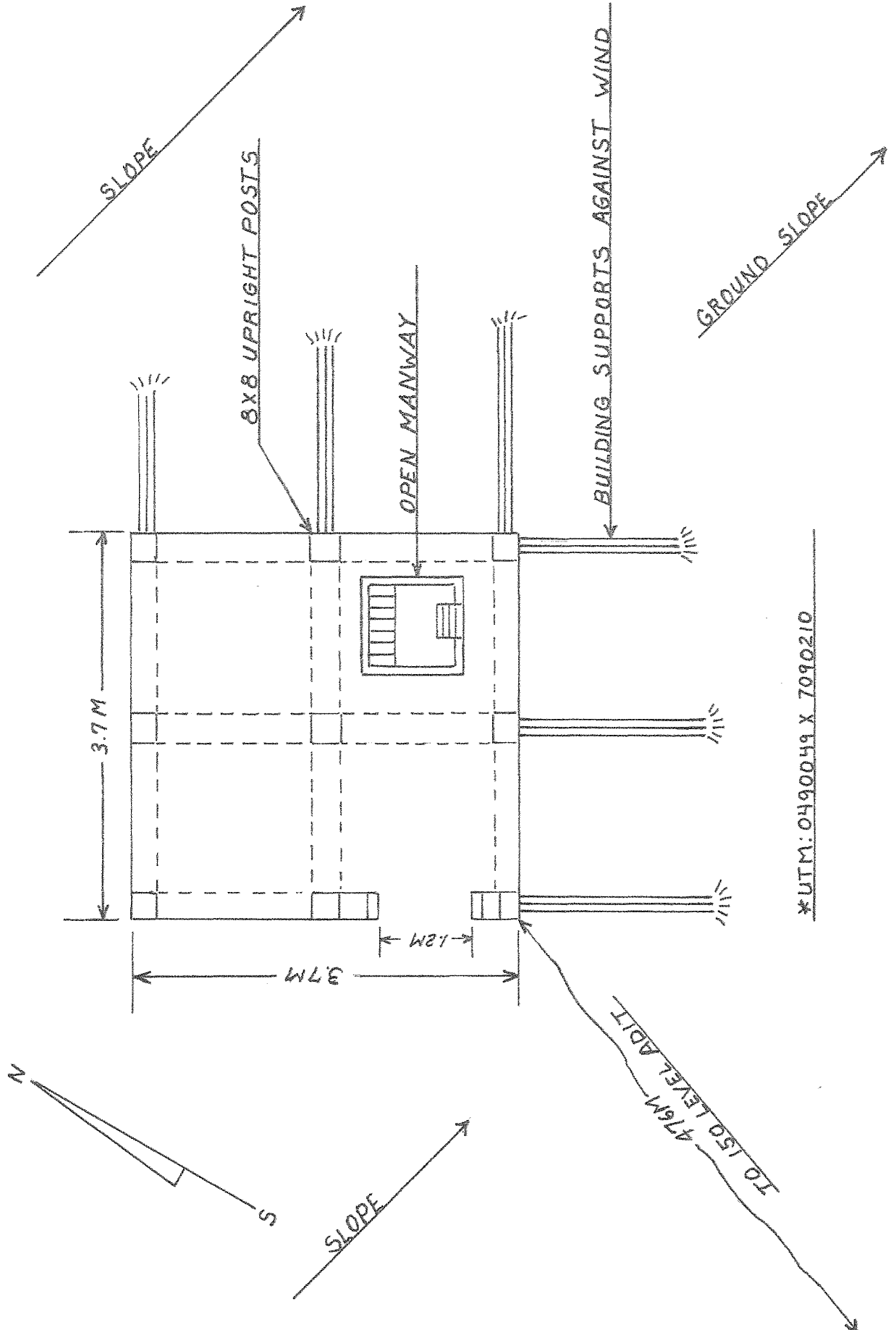

SITE: KENO 700/VENT RAISE DR BY: McQuesten Lake Ent. SCALE: 20mm = 1M MARCH, 18, 2007

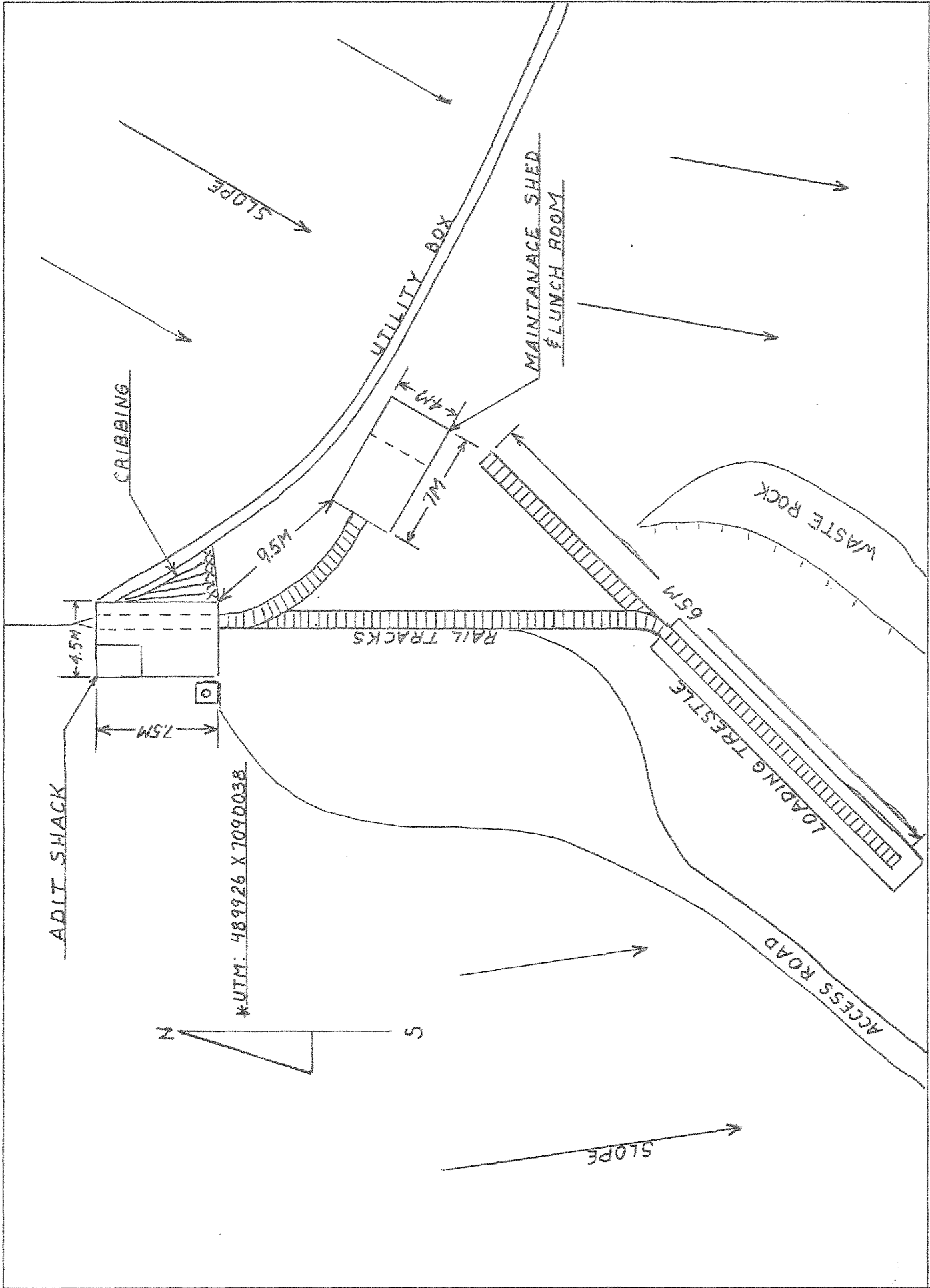

SITE: COMSTOCK 200/KEN0 700 DR BY: McQueenen Lake Ent. SCALE: 4mm = 1M MARCH, 17, 2007

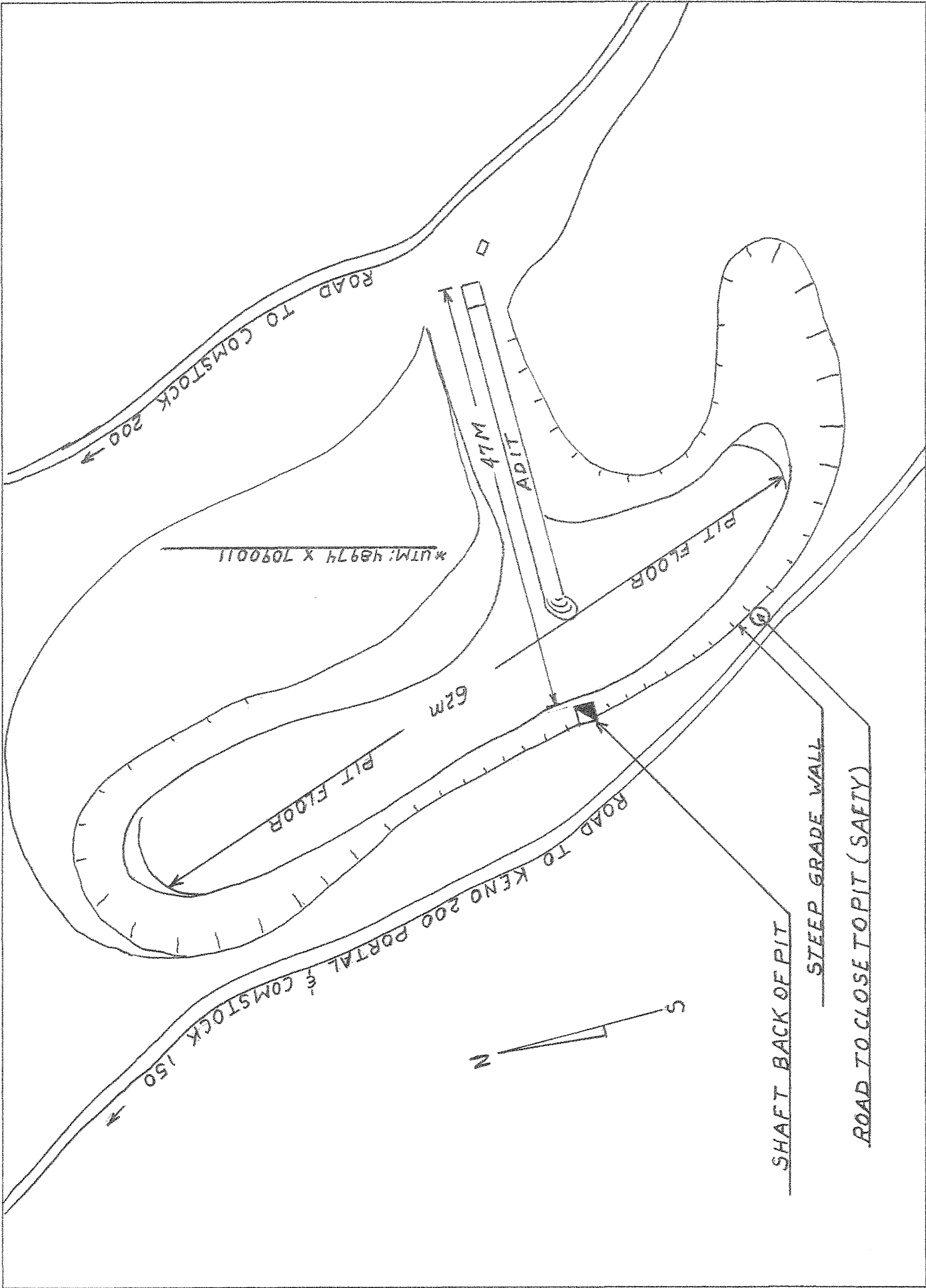

SITE: PORCUPINE ADIT & PIT

DR BY: McQuesten Lake Ent.

SCALE: 5mm = 2M

MARCH 20, 2007

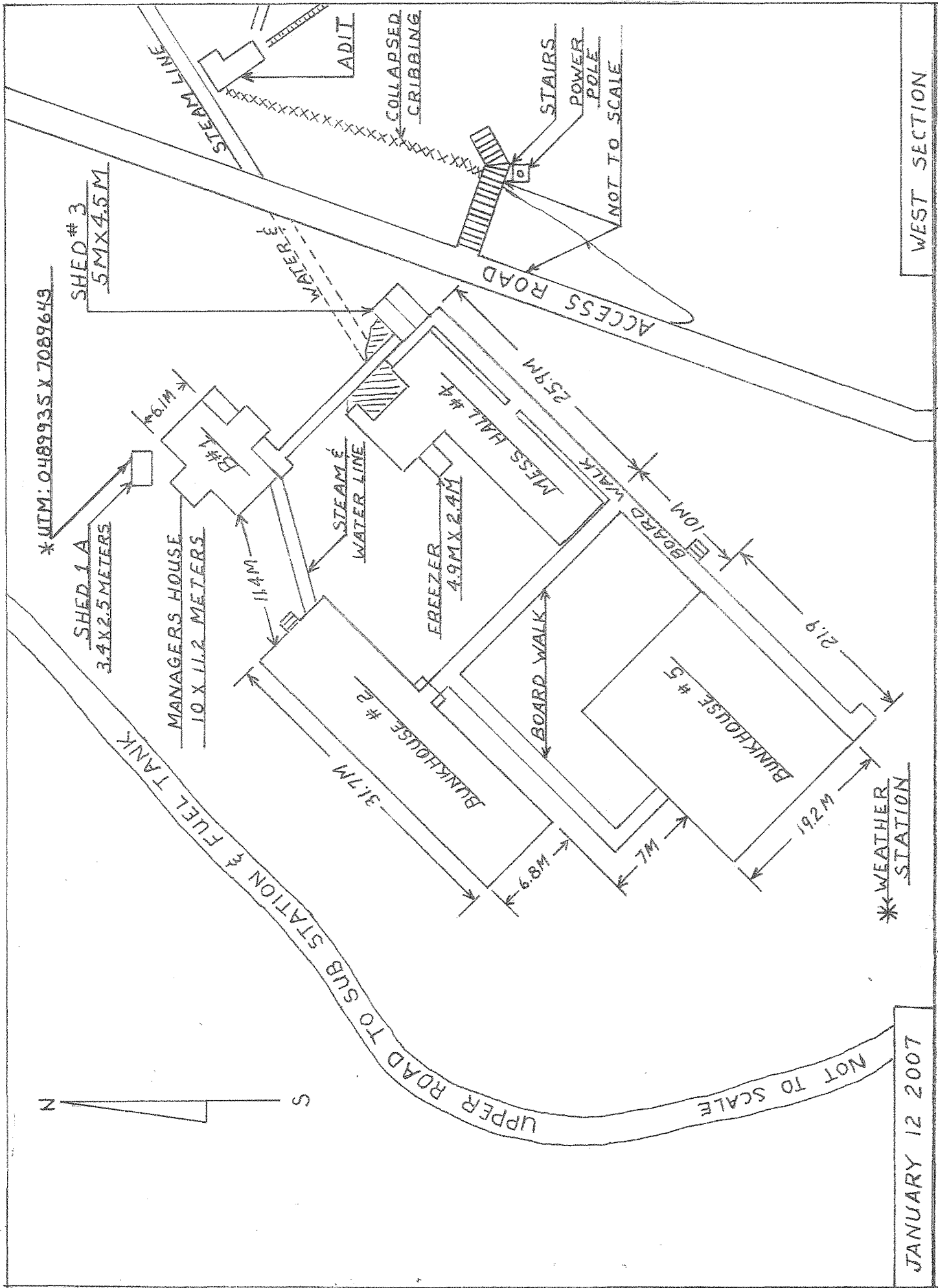

JANUARY 12 2007

SCALE: 4 mm = 2 METERS

KENO 700 BUILDINGS # 1, 1A, 2, 3, 4, 5 & ADIT

DR BY: McQUESTEN LAKE ENT.

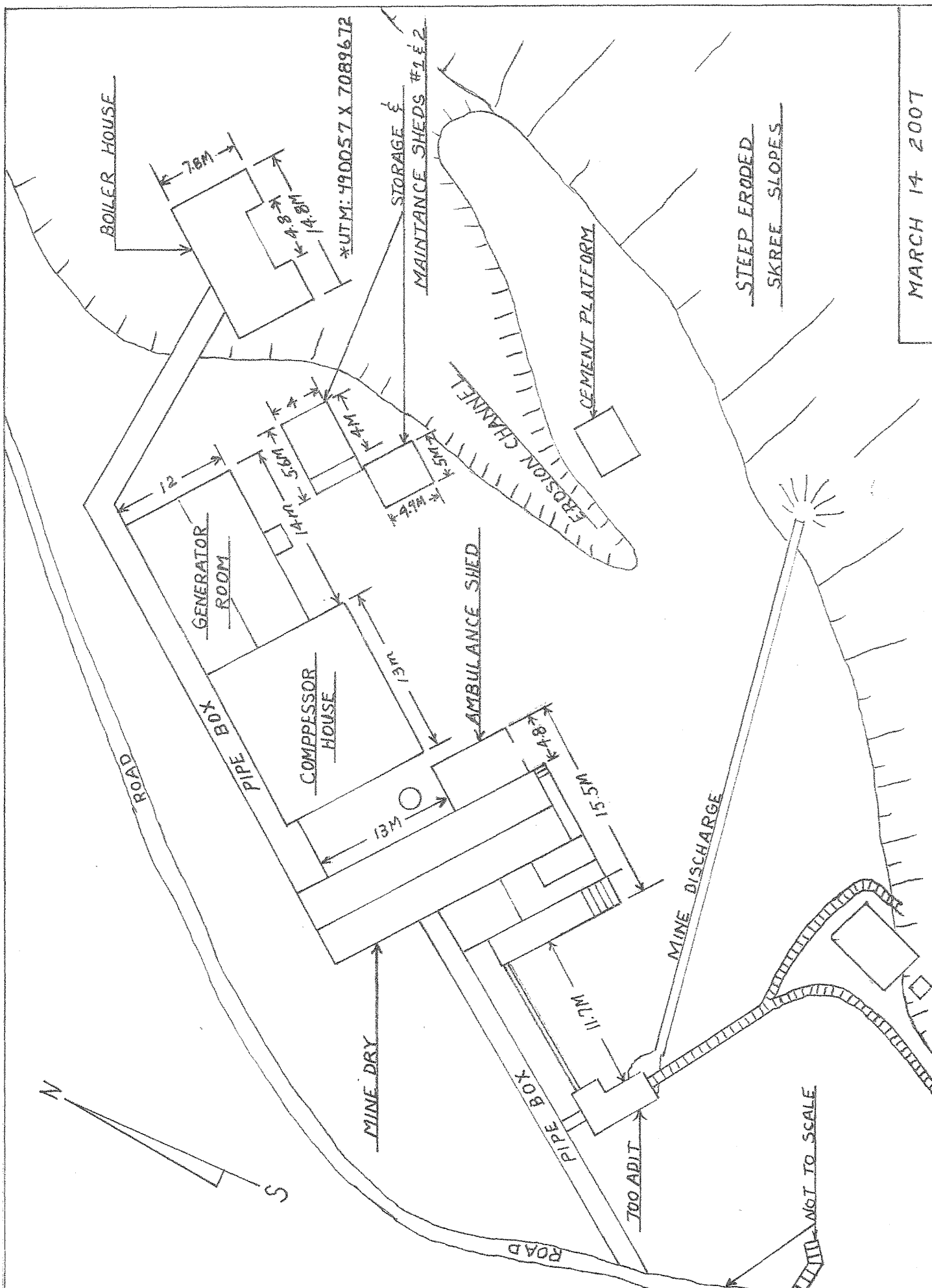

MARCH 14 2007

SCALE: 4mm = 2m KENO 700 BUILDINGS, EAST SECTION DR BY: McQUESTEN LAKE ENTERPRISES