

**Appendix A**

**Arctic Environmental Strategy Information Package**

**Contractor: CCSG**

**Sites 30, 39,44**

**Site 30: Located at Km. 1808.3 Alaska Highway, old milepost 1126.4, north of Burwash .**

**Site 39: Located at Kathleen River crossing along the Haines Highway; see hand drawn map.**

**Site 44: Located along old Marshall Creek road, adjacent to Dezadeash River, Haines Junction area.**

Priority 3700

Environment Canada  
Environmental Protection Service

Site Code 132  
NTS Sheet 115 G/12  
Donjek

IDENTIFICATION AND VERIFICATION OF ACTIVE AND INACTIVE  
LAND DISPOSAL SITES IN THE YUKON TERRITORY

Community Landfill Presently in use no

Community Name Pump Station F Region Southwestern Yukon

Km 1808.3  
1.0 LOCATION Mile 1126.5 Alaska Highway

1.1 Latitude N 139°37'20" Longitude W 61°36'45" Elevation 905 M.

1.2 Distance from disposal area to townsite N.A. km.

1.3 Distance from disposal area to town water source N.A. km.  
Is there any chance of contamination? minimal

1.4 What type of water source N.A.

1.5 Population served by water source N.A.

1.6 Distance from disposal area to major surface water 300m  
small lake

1.7 Uses of major surface water unknown

1.8 Distance to nearest house more than 1km

1.9 Surrounding land use:  
1/4 km radius      1/4 - 1 km radius      Beyond 1 km radius  
Alaska Highway      brush      Residential -  
brush      Commercial -

2.0 DISPOSAL SITE CHARACTERISTICS

2.1 Dimensions: Length 80 meters      Width 80 meters  
Approximate depth of waste \_\_\_\_\_ meters

2.2 Present condition: Open yes  
Covered no details -  
Other - specify -

2.3 Source of waste U.S. Army

2.4 Types of waste:  
Liquid sewage no Garbage biodegradable yes  
Non degradable (appliances, car/truck bodies, metal scrap) minimal  
Industrial waste (specify) (oils, chemicals etc) 1 oil tank  
Inventory of other likely wastes -

2.5 Operation:  
Open Dump yes  
Open Dump with Burning no

10  
5  
5  
10  
5  
10  
20  
10

Dump with Occasional Cover no  
Sanitary Land Fill no  
Other (specify) \_\_\_\_\_

2.6 Who had access to the site during operation? Public no  
Community Services \_\_\_\_\_ Specify U.S. Army

2.7 Methods of containment for high concern wastes none

2.8 Evidence of leachate (liquids produced by garbage) YES \_\_\_\_\_ NO ✓

2.9 Leachate containment (liquids escaping from dump) YES \_\_\_\_\_ NO ✓

2.10 Evidence of methane gas or odours YES \_\_\_\_\_ NO ✓  
Comments \_\_\_\_\_

2.11 Period of operation 1942 to 1946?

2.12 Mean high temperature for July 18.5 °C

2.13 General soil type gravel

2.14 Vegetation spruce, muskeg, willow, aspen

2.15 Depth to permafrost during the summer discontinuous but present here

2.16 Are there any sensitive environments or critical habitats such as endangered species breeding grounds in the area? NO \_\_\_\_\_ YES ✓  
Specify muskrat, beaver, nesting ducks, are common in this area

2.17 How far from the landfill are they? 100m

3.0 GENERAL NOTES: ANNUAL RAINFALL - 300mm.

3.1 Property owner: Present crown and private lease 3391-2  
Past (during operation) U.S. Army (crown)

3.2 Past or present problems with site can be easily seen from highway

3.3 Reason for closing or abandoning site U.S. Army left area

3.4 Closure procedures unknown

3.5 Information source and/or references Colin Eddy's Booklet Alaska Highway Clean-up Assessment Study 1976

4.0 COMMENTS  
Site consists of 5 bldg. 1 oil tank  
Area is restricted

J.R. Initials

Date Apr 22, 1987



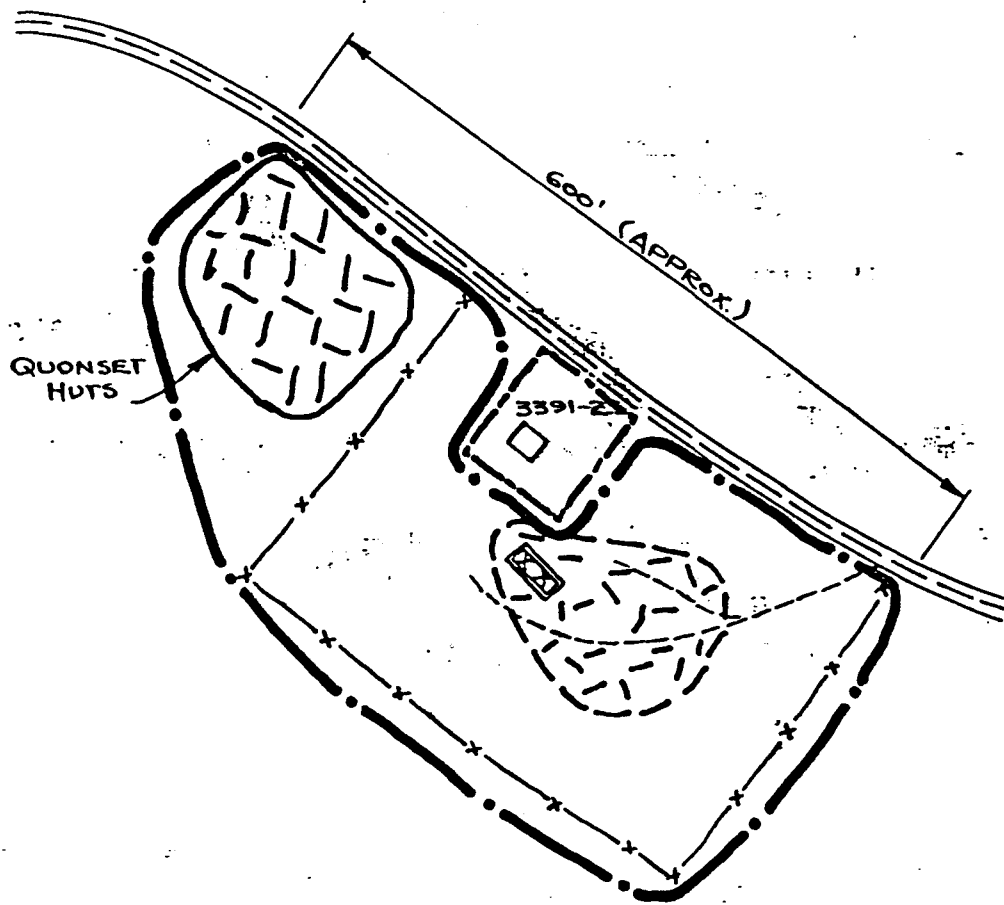

ALASKA HIGHWAY

MILE - 1126.4

CANAL PUMPING STATION F

FIGURE 29

EDRY, C.E. 1976

# LEGEND

==== - ALASKA HIGHWAY



- WOODEN DEBRIS



- CONCRETE



- DUMP SITE

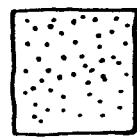

- METAL DEBRIS

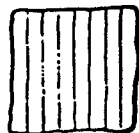

- VEHICLE HULKS



- GRAVEL PITS



- STANDING BUILDING



- PARTIAL BUILDING



- BUILDING FOUNDATION  
OTHER THAN CONCRETE



- POSSIBLE BURY SITE



- POSSIBLE  
BURNING SITE



- MUSKEG

----- LEASED or TITLED  
PROPERTY BOUNDARY.

..... - OVERALL AREA



- FENCE



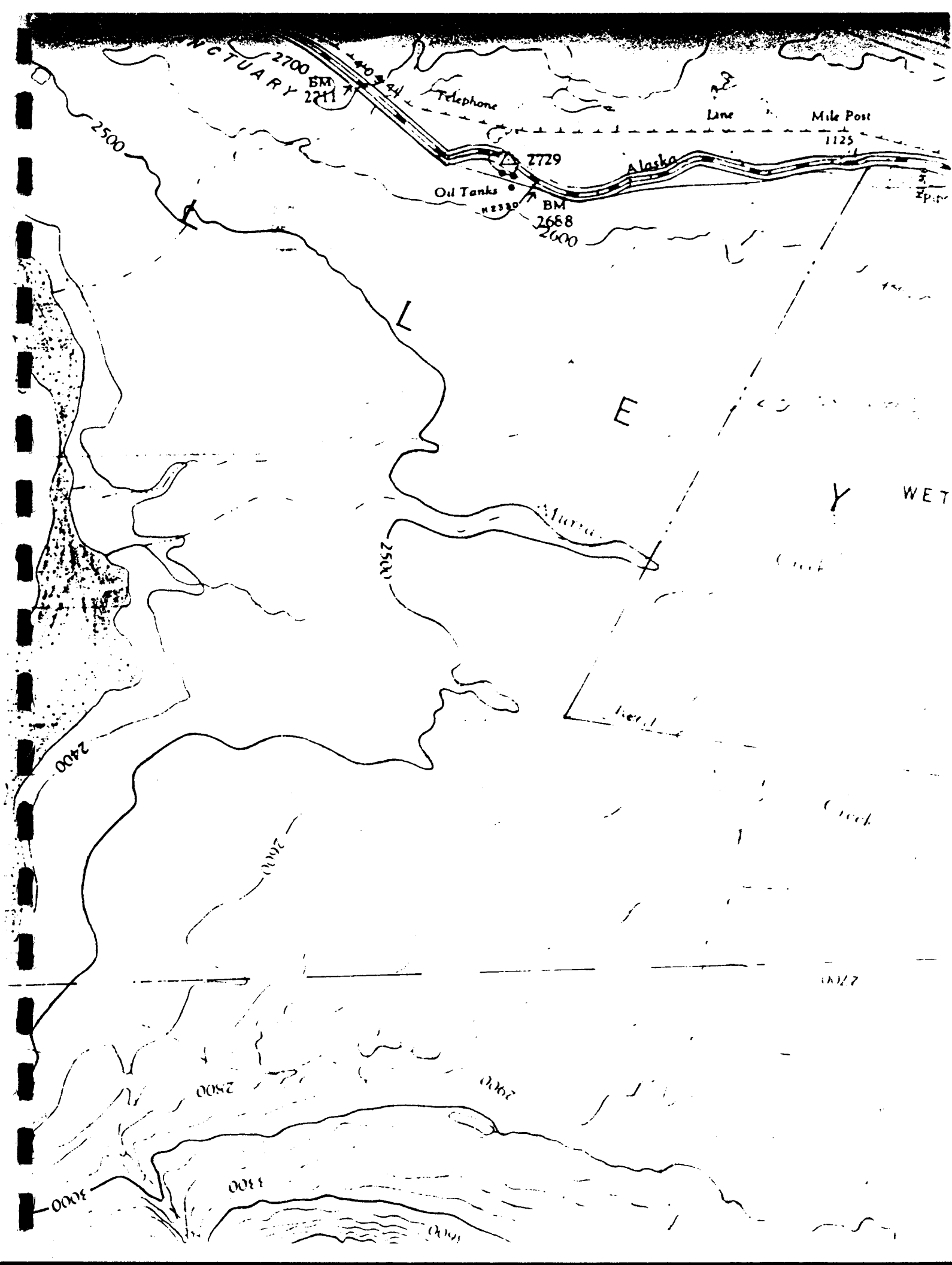

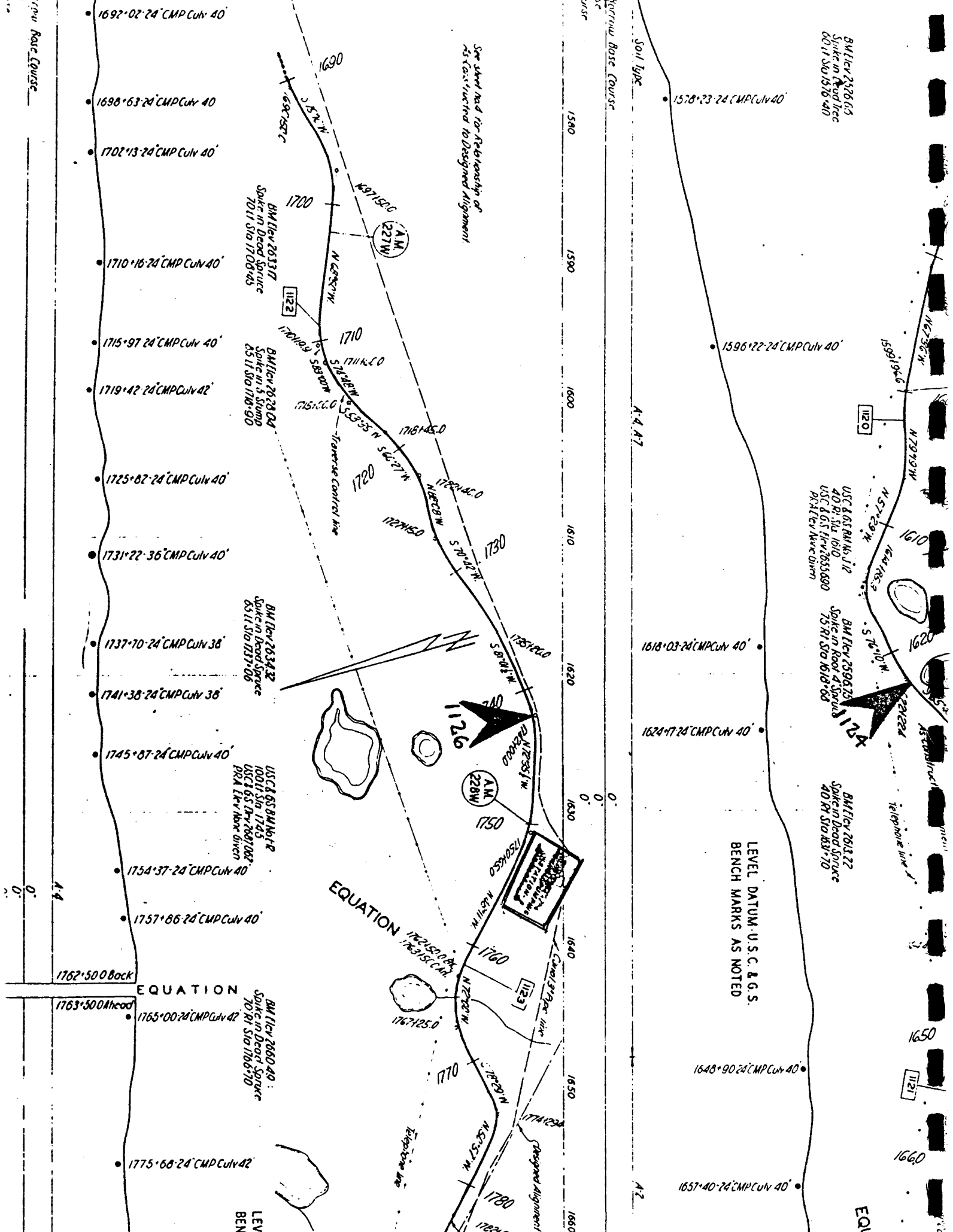

1692°02'24" CMP CUV 40'  
 1698°53'24" CMP CUV 40'  
 1702°43'24" CMP CUV 40'  
 1710°16'24" CMP CUV 40'  
 1715°97'24" CMP CUV 40'  
 1719°42'24" CMP CUV 42'  
 1725°02'24" CMP CUV 40'  
 1731°22'36" CMP CUV 40'  
 1737°70'24" CMP CUV 38'  
 1741°38'24" CMP CUV 38'  
 1745°07'24" CMP CUV 40'  
 1754°37'24" CMP CUV 40'  
 1757°06'24" CMP CUV 40'  
 1762°50'0" Back  
 1763°50'0" Ahead  
 1765°00'24" CMP CUV 42'  
 1775°08'24" CMP CUV 42'

1578°23'24" CMP CUV 40'  
 1596°22'24" CMP CUV 40'  
 1618°03'24" CMP CUV 40'  
 1624°47'24" CMP CUV 40'  
 1648°00'24" CMP CUV 40'  
 1657°40'24" CMP CUV 40'

See sheet next for relationship of  
 existing structure to designed alignment.

LEVEL DATUM - U.S.C. & G.S.  
 BENCH MARKS AS NOTED

See sheet next for relationship of  
 existing structure to designed alignment.

BM Lev 2326665  
 Spike in Dead Spruce  
 70 Rl Sta 1706+45

USC & G.S. B.M. No. 112  
 40 Rl Sta 1610  
 USC & G.S. Twp 18S 35E 800  
 P.M. Lev. Wire 011111

BM Lev 2596724  
 Spike in Dead Spruce  
 73 Rl Sta 1618+08

BM Lev 2613722  
 Spike in Dead Spruce  
 40 Rl Sta 183+70

BM Lev 263317  
 Spike in Dead Spruce  
 70 Rl Sta 1706+45

BM Lev 262804  
 Spike in Dead Spruce  
 63 Rl Sta 1718+90

BM Lev 263432  
 Spike in Dead Spruce  
 63 Rl Sta 1737+06

USC & G.S. B.M. No. 112  
 40 Rl Sta 1745  
 USC & G.S. Twp 18N 28E 067  
 P.M. Lev. Wire 011111

BM Lev 268049  
 Spike in Dead Spruce  
 70 Rl Sta 1718+70

LEV  
 BEN

EQU

# KATHLEEN RIVER MAINTENANCE CAMP

Bisset  
Report

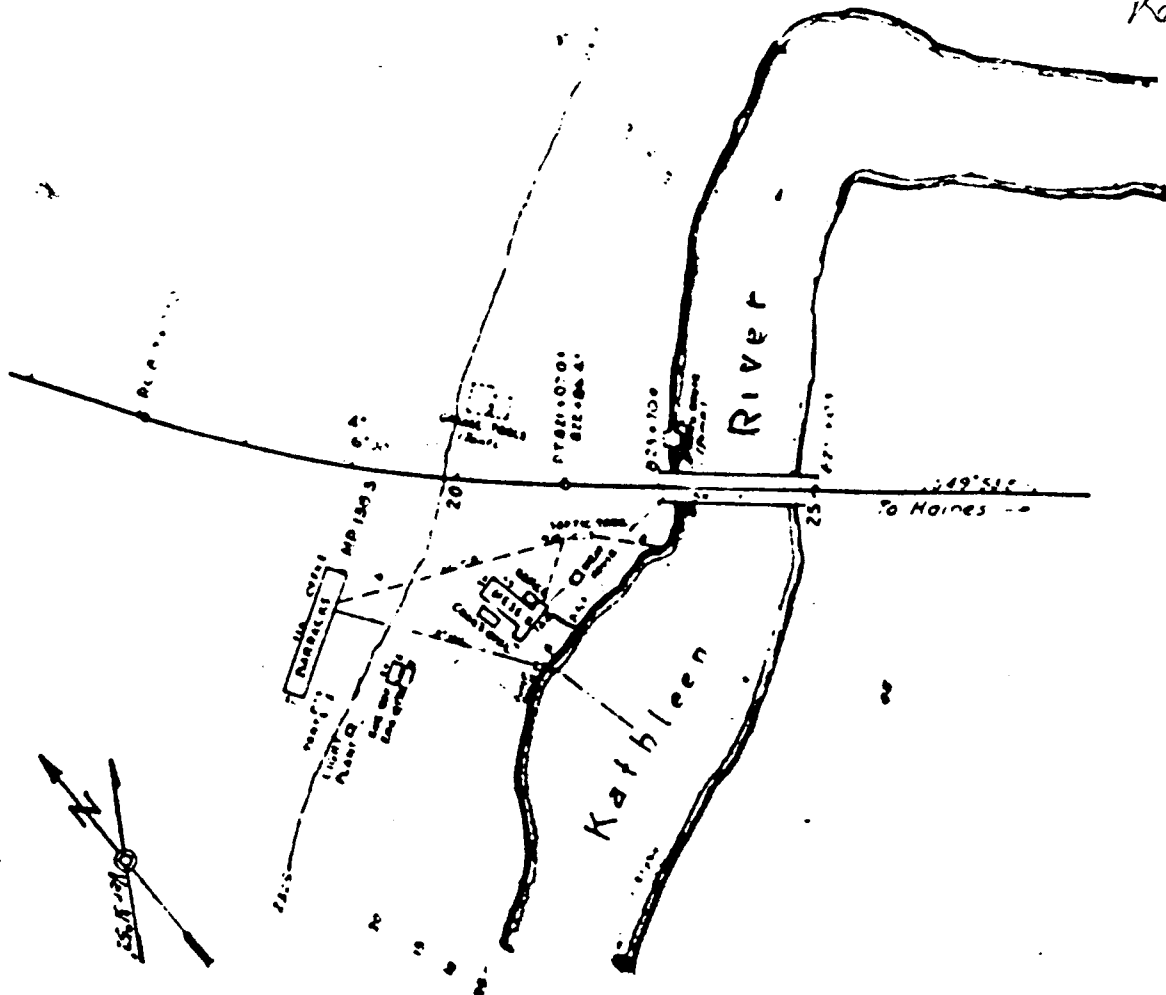

OLD \*C.C. MP 138.3

New (MP 143)

143

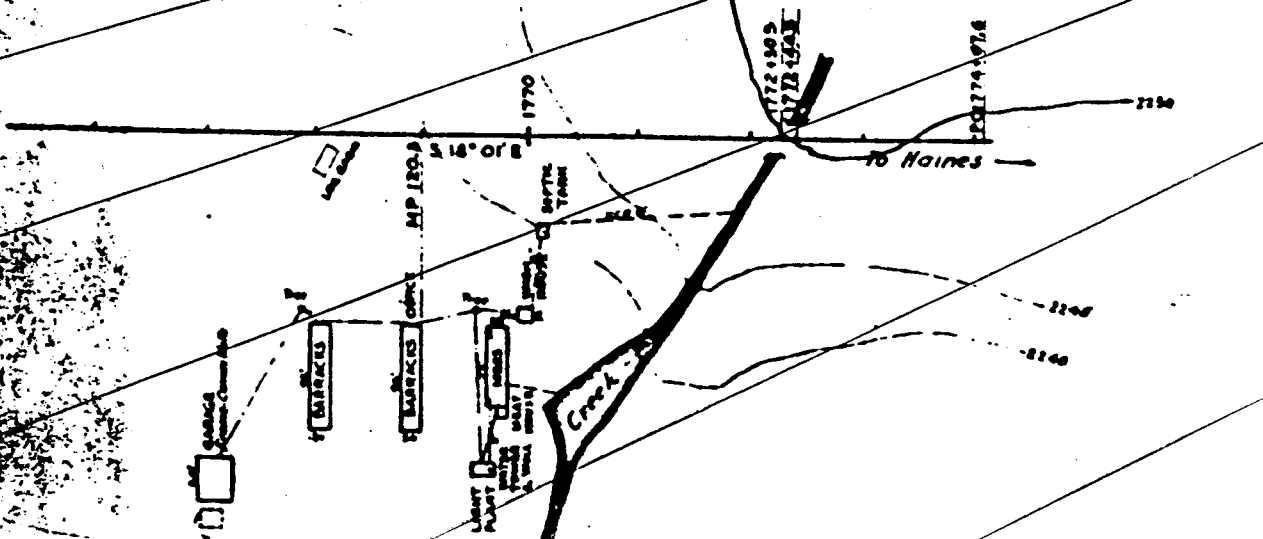

OCATE NEW  
R. DOWNSTP

7  
As Built

PHOTOS 11447  
CROSS 255

143

170

MATHISEN CAMP

<p><b>RECORD DRAWING</b></p> <p>JOEY BRIDGERS AND RONL EDNNDL DRAUGHTS &amp; SURVEYING VALLEJO, CALIF.</p> <p>FORWARD LOOK GEODESY CORP. OF SANITARY &amp; S.</p> <p>HAILEY, IDAHO</p> <p>PLAN AND PROJ NO. 100 TO 100</p>
--

3211

32142 51

SEG. 6

CHAMP/AIS FN  
S-428B

BM  
2568.5

CHAMP/AIS FN  
S-39B

Mile Post  
145

CHAMP/AIS FN  
R-13B

CHAMP/AIS FN  
S-224B

Y.T.G.  
013

LOT 108 & ROADS  
PLAN 64243

LOT 1009, PL. 75911  
PLAN 60746

BM CHAMP/AIS FN  
S-225B

CHAMP/AIS FN  
S-38B

CHAMP/AIS FN  
S-433B

Lot 68, G. 803  
Plan 52276

Lot 68  
Plan 52276

CHAMP/AIS FN  
S-267B

L. 1007, PL. 73483  
PLAN 59125

75

76

77

78

LOT 1008, PL. 75908  
PLAN 60746

032

Plan 57169

Lot 82, G. 803  
Plan 57169

BM  
2523.5

Eg/P 13810

WILSON

WILSON

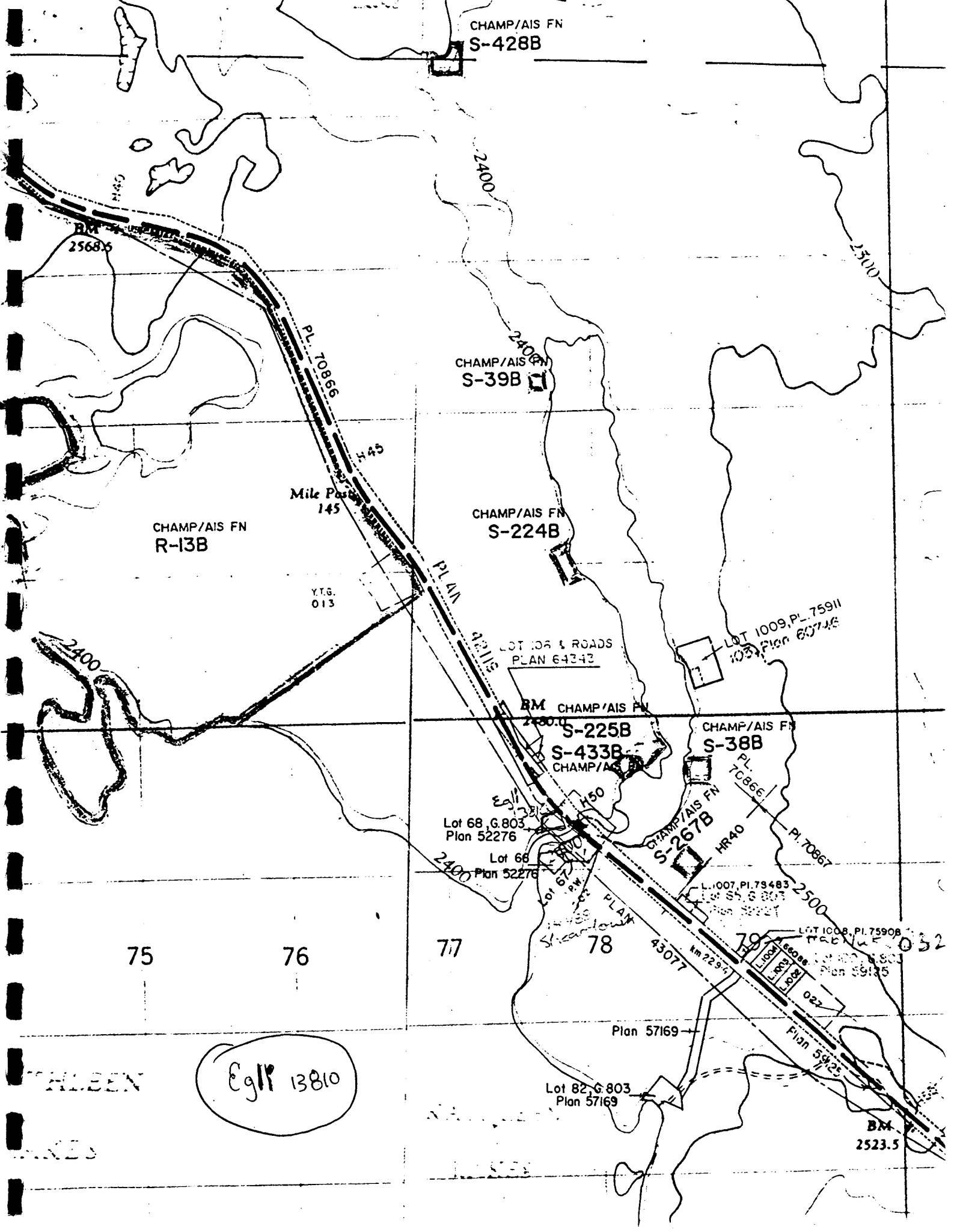

# Kathleen River / Maintenance Camp

New highway covers parts of the site  
Buildings and site are bulldozed over into piles

- Recommendations:
- have garbage picked up
  - soil samples of pile bottom at the side of the river (notably from the other)

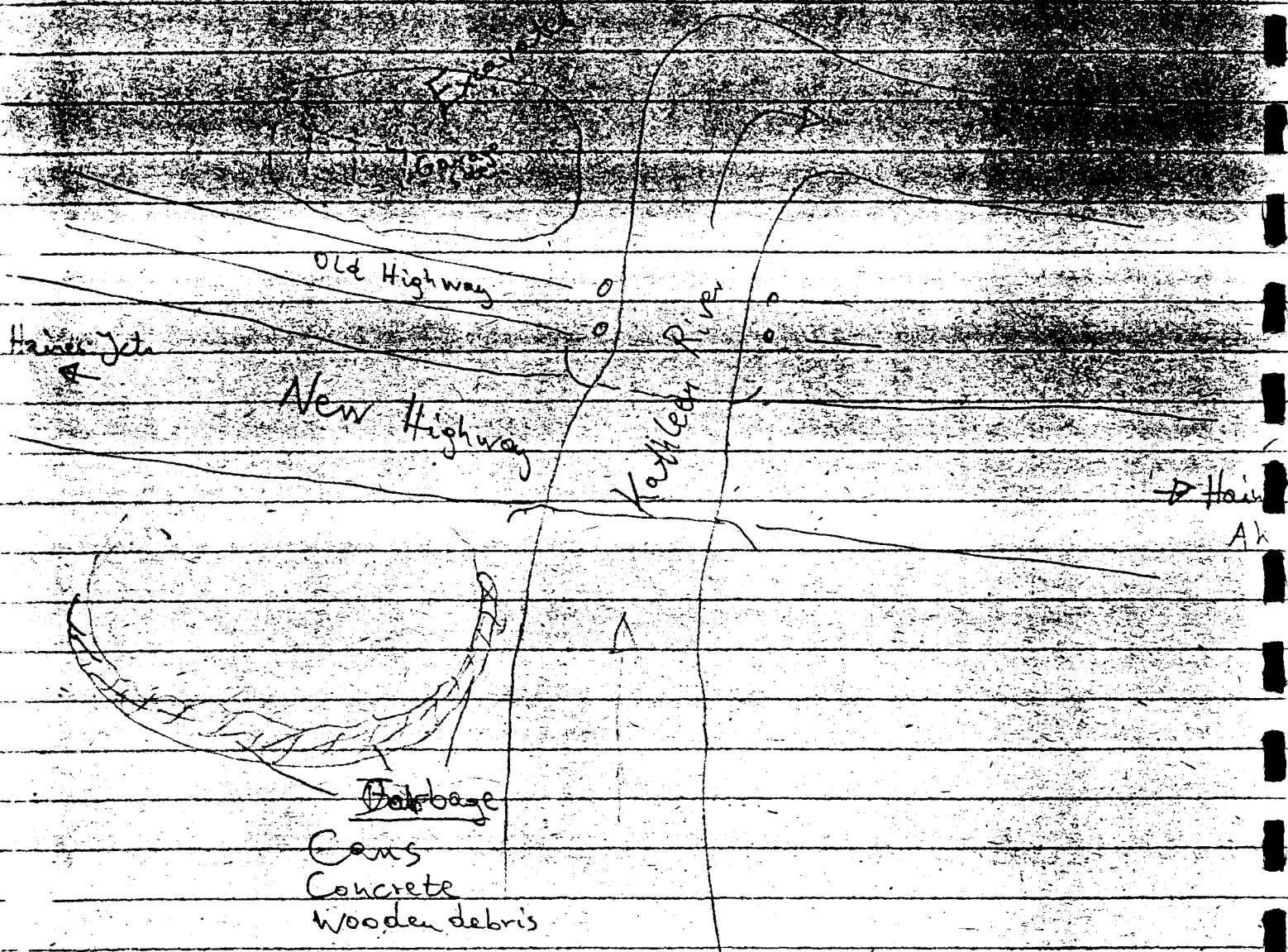

115A-11

H044

# YUKON AES WASTE SITE INVENTORY

X

UPDATED: 10.04.95

DISTRICT: HJ

SITE NUMBER: 011

GENERAL: OLD MARSHALL CREEK ROAD 8 KM FROM DEZADEASH RIVER

LATITUDE: 60 46

LONGITUDE: 137 25 0

PRESENT LAND TENURE: FEDERAL

STATUS: INVENTORIED

SITE DESCRIPTION: OLD GARBAGE SITE ADJACENT TO DEZADEASH RIVER. SITE INCLUDES OLD VEHICLE BODIES, DRUMS, TIRES, GENERAL HOUSEHOLD CANS & BOTTLES

SIZE OF SITE:

SITE ACTIVITY:

E.P. RANK: 0

ABANDONED: YES

WASTE MATERIAL: DRUMS, REFUSE

DRUMS NUMBER:

FULL:

EMPTY:

CONTENTS:

ACCESS:

PRESENT OCCUPANT:

PREVIOUS OCCUPANT:

PERMANENT IMPROVEMENTS:

VEGETATION:

IMPACT POTENTIAL:

ASPECT AFFECTED:

RECOMMENDATIONS: SOIL SAMPLES SHOULD BE TAKEN FOR POSSIBLE CONTAMINANTS. IF SATISFACTORY ALL ITEMS SHOULD BE REMOVED TO THE HAINES JUNCTION DISPOSAL SITE. THERE DOES NOT APPEAR TO BE A PIT, ONLY SURFACE LITTER. THIS SITE IS LOCATED 8M FROM THE RIVER'S EDGE.

DISTRICT AND SITE: HJ 011

CLEAN-UP COST ESTIMATE:

INSPECTOR: J.TROTTER

INSPECTION DATE: 28.10.92

FOLLOW UP: SITE WAS TO BE CLEANED UP SUMMER OF 1994 BY Y2C2, BUT WAS NOT  
STARTED.

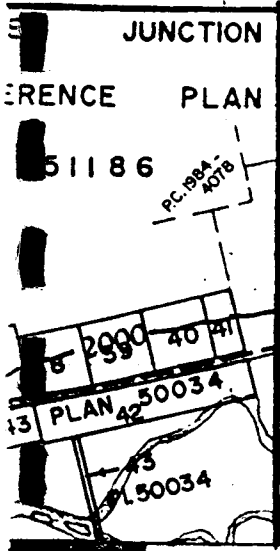
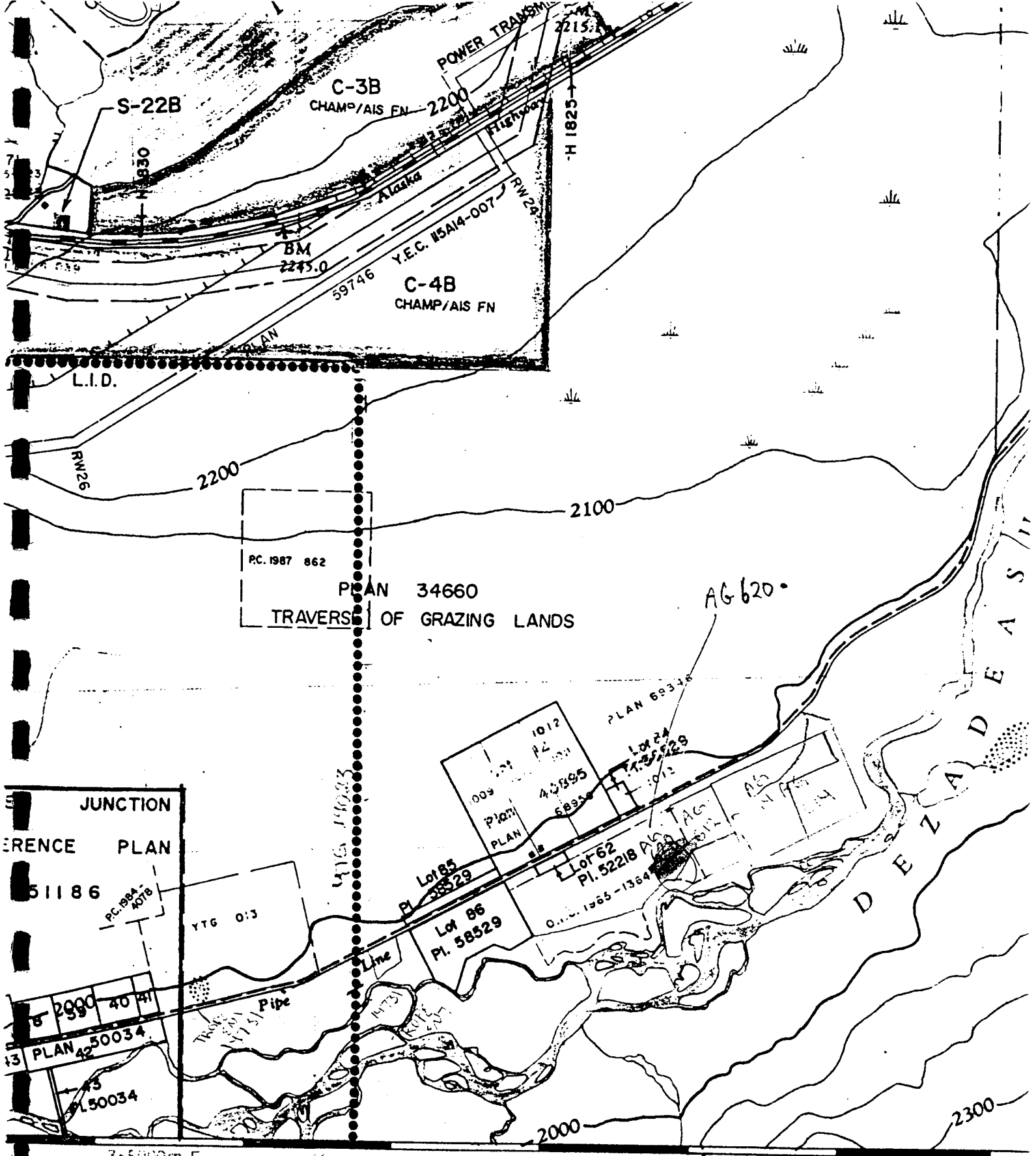

365000m.E 66 25 60 70

Surveyed, compiled, drawn and printed by the Army Survey Est. R.C.E. 1950-52. Aerial photography by R.C.A.F. 1947.

MAGNETIC DECLINATION 31° 16' EAST AT CENTRE OF SHEET, 1952 Annual magnetic change 3' westerly

**Appendix B - 30**

**Sampling Details**

**Site 30 - Burwash Landing**

## Burwash Landing

### Soil Sampling

---

Sample: 30-S1                      Coordinates: E20, 0+70                      Date: September 05, 1996  
Location:                      Mound (long, thin) 20 metres east of pumphouse.  
Sample:                      Depth of 2'. Brown dry soil. Some light brown fibrous dirt, 20% stones, 20% pebbles.

---

Sample: 30-S2                      Coordinates: E21, 0+70                      Date: September 05, 1996  
Location:                      Mound (long, thin) 20 metres east of pumphouse.  
Sample:                      Depth of 3'. At 2' some light grey, medium brown soil, dry. 20% gravel, 70% pebbles.

---

Sample: 30-S3                      Coordinates: E15, 0+90                      Date: September 05, 1996  
Location:                      Scattered wood debris, broken concrete and insulation debris forming slight mound.  
Vegetation:                      Balsam poplar, bearberries growing on top of mound, and on edge.  
Sample:                      Granular soil - white and moist brown dirt. At 1.5', 80% white, 20% brown (in a thin layer).  
Sample taken at 1.5'.

---

Sample: 30-S4                      Coordinates: E15, 0+90                      Date: September 05, 1996  
Location:                      Scattered wood debris, broken concrete and insulation debris forming slight mound.  
Sample:                      Granular soil - white and moist brown dirt. At 1.5', 80% white, 20% brown (in a thin layer).  
At 3.5', dark grey wet clay. Sample taken at 3.5'.

---

Sample: 30-S5                      Coordinates: E62, 0+98                      Date: September 05, 1996  
Location:                      Depression just north of north west corner of concrete foundation. Some protruding timbers  
on the east side. Concrete block (crumbling) and wood slats on the west side.  
Vegetation:                      Plants around edge. A few sparse grasses in bottom of the depression. Stones and  
cobble for top 5-30 cm.  
Sample:                      Brown matt layer - fibrous matt looks like sample 30-A2 taken behind pumphouse (E15,  
0+95). Sample taken from 6"-1'. 60% pebbles, moist grainy grey dirt.

---

Sample: 30-S6                      Coordinates: E84, 1+00                      Date: September 05, 1996  
Location:                      East end of foundation channel - 1' from edge of concrete.  
Sample:                      Sample taken at 6" depth. Grey granular dirt - 10% pebble and stone.

---

Sample: 30-S7                      Coordinates: E90, 1+02                      Date: September 05, 1996

Location: 4' from edge of concrete on east juttred end. Surrounding vegetation - fireweed, poplars.

Sample: 4" humic layer. Granular grey/brown dirt with white grains. Sample taken at 6" depth.

---

Sample: 30-S8 Coordinates: E52, 0+98 Date: September 05, 1996

Location: Mound with 20' poplars with galls growing at leaf base. Leaf sample taken. Sparse moss on W/N sides. There is a silver shrub on the NE side.

Sample: Dirt/gravel mound. Granular, grey, brown, dry. Sample taken at 5" depth.

---

Sample: 30-S9 Coordinates: E90, 0+75 Date: September 05, 1996

Location: Square depression at end of tracks. Surrounded by many 30'-40' poplar trees. Other vegetation includes bearberries, fireweed.

Sample: Moist brown soil.

---

Sample: 30-S10 Coordinates: E95, 0+25 Date: September 05, 1996

Location: At protruding pipe.

Sample: 3" rich dark moist soil humic layer. Sample taken at 6" - predominately white granular material with light brown dirt.

---

Sample: 30-S11 Coordinates: E95, 0+25 Date: September 05, 1996

Location: At protruding pipe

Sample: 3" rich dark moist soil humic layer. At 6" - predominately white granular material with light brown dirt. Sample taken at 1' depth - grey moist clay.

---

Sample: 30-S12 Coordinates: E10, 0+40 Date: September 05, 1996

Location: Clearing with bear berries.

Sample: 25% stone and pebble. Sample granular brown, some white soil.

---

Sample: 30-S13 Coordinates: E20, 0+85 Date: September 05, 1996

Location: Between broken concrete blocks, surrounded by bearberries.

Sample: 4" organic layer. Granular white sand, brown fine moist soil. Taken at 6".

---

Sample: 30-S14 Coordinates: W45, 0+75 Date: September 05, 1996

Location: Ditch running north/south 25 metres west of pumphouse.

Sample: Active organic layer first 5". Granular white 50% and brown 50% and organics interspersed at 4"-6" level. Grey clay at 1' depth, 5% rock, 5% organics - sample depth.

---

Sample: 30-S15                      Coordinates: W75, 0+60                      Date: September 05, 1996

Location:            50 m east of pump house

Sample:              A fine light brown sand and granular white sand.

---

Sample: 30-S16                      Coordinates: W105, 0+15                      Date: September 05, 1996

Location:            15 m south of highway

Sample:              Light brown sand with large white granular substance mixed throughout surface sample top 6", slight trace of organic material at 2" (included).

---

Sample: 30-S17                      Coordinates: W50, 1+50                      Date: September 05, 1996

Location:            80m SSE off pumphouse. Very rich organics, smells very strongly of oil, dark brown/black in colour. Sample taken at south corner of water filled depression at water level. Depression is surrounded by thin swampy grasses.

Sample:              Very clay like and difficult to remove from auger. Sample taken from 6" to 10" below ground surface.

Comment:            Oil like slicks on water surface, not seen when 30-W2 was taken. Refer to 30-W2 for details.

---

Sample: 30-S18                      Coordinates: E55, 1+35                      Date: September 06, 1996

Location:            35 metres south west of concrete foundation. 4 metre by 10 metre depression with wood debris and 3 metre section of 2" pipe, one end depression.

Sample:              Grey/green very fine silt, very thin layer of brown sand. Sample representative from 2" - 24". Plastic yellow tube discarded from sample (1" long, 2 mm diameter).

---

Sample: 30-S19                      Coordinates: E115, 0+15                      Date: September 06, 1996

Location:            Bare spot - similar to other bare spots running parallel to the highway between 0+30 and 0+40

Sample:              First 3" - brown, dry soil. 3" - 7.5" dark brown soil, some root matter observed. 7.5" - 9.5" light brown intermixed with very fine silt, still evidence of root material. At 9.5" auger hit rock. Sample taken from 3" to 7.5".

---

Sample: 30-S20                      Coordinates: E99, 0+70                      Date: September 06, 1996

Location:            Equidistant between Alaska Highway and the large concrete foundation.

Sample:              Top 7" white granular substance. 7"-14" dark brown, moist soil. Trace presence of organics.

---

Sample: 30-S21                      Coordinates: E135, 0+85                      Date: September 06, 1996

Location:            On bare spot that looks like a R.V. pad, adjacent to access trail that leads south of concrete foundation.

Sample: No active layer. 0-6" light brown sand, some gravel.

Comment: There are signs of recent use - modern camping type debris: matches, ketchup packets. There is also old debris - metal, wood, roofing material.

---

Sample: 30-S22                      Coordinates: E101, 1+05                      Date: September 06, 1996

Location: Two test holes, 1.5 feet apart in depression by trail. About 15 metre east of concrete foundation.

Sample: 0-4" one hole, 0-10" 2nd hole for sample. Gravel then encountered. Sample mixed together.

---

Sample: 30-S23                      Coordinates: W110, 1+05                      Date: September 06, 1996

Location: Pit 115" by 75". Pit walls mossy and wooden retaining walls visible along with miscellaneous lumber surrounding the pit.

Sample: Strong smell of decomposing fecal matter. The sample was taken from the centre of the pit, the sample being very black and wet in appearance.

Comment: Refer to 30-W1.

---

## Water Sampling

---

Sample: 30-W1

Coordinates: W110, 1+05

Date: September 05, 1996

Location: Pit 115" by 75". Pit walls mossy and wooden retaining walls visible along with miscellaneous lumber surrounding the pit. Water was 26" beneath ground level. A stick was sunk into 12" of what appeared to be sludge. Unknown how deep the sludge goes.

Sample: Oily substance on water surface.

Comment: Refer to 30-S23

---

Sample: 30-W2

Coordinates: W40, 1+65

Date: September 06, 1996

Location: Approximately 80 metres from the pumphouse heading directly away from the Alaska Highway.

Sample: Oily smell from water. There was no oil sheen on the surface. Ice on the surface of pit had to be broken.

Comment: Refer to 30-S17. The 30-S17 sample hole had been filled with water by the time 30-W2 was taken.

---

## Asbestos Sampling

---

Sample: 30-A1                      Coordinates: W05, 0+74                      Date: September 05, 1996

Location:              Pumphouse - insulation on outside pipe.

Sample:              Concrete wrapped as an insulator around the pipe.

---

Sample: 30-A2                      Coordinates: E15, 0+95                      Date: September 05, 1996

Location:              Scattered wood debris, broken concrete and insulation debris (brown matt layer).

Sample:              Sample taken from insulation like material.

---

Sample: 30-A3                      Coordinates: W100, 0+35                      Date: September 05, 1996

Location:              Scattered wood debris and exterior building tiles.

Sample:              Sample taken from tile.

---

**Appendix B - 39**

**Sampling Details**

**Site 39 - Kathleen River**

## Site 39 - Sampling Record

### Water Sampling Record

---

Sample: 39-W1                      Coordinates: 0+95, Y0+95                      Date: September 07, 1996

Location: In the Kathleen River, under the Haines Highway bridge.

Clarity: Clear                      Water Temperature: 11 °C                      pH: 8.3

Comments: Rock and pebble bottom with water flowing in a swift current. There is a brown/orange algae covering, with a smell of algae. Clumps of grass are on the bank edge.

---

Sample: 39-W2                      Coordinates: 0+95, Y1+75                      Date: September 07, 1996

Location: Upstream by 75 m of sample 39-W1, in a 3 m. inlet adjacent to the main river current.

pH: 8.4                      Water Temperature: 11 °C                      Clarity: Clear

Comments: Grey/brown algae matter on rocks and pebbles.

---

Sample: 39-W3                      Coordinates: 1+05, Y1+30                      Date: September 07, 1996

Location: Back eddy on the Kathleen River - near soil sample 39-S5 (1+10, Y1+25)

pH: 8.2                      Water Temperature: 13 °C                      Clarity: Clear

Comments: Silt bottom over rocks and pebbles, green algae in the water. Grasses on the bank. 1 m. downstream is a portion of 1" pipe in the water and buried in the river bed sediment.

---

Sample: 39-W4                      Coordinates: 1+80, Y1+78                      Date: September 07, 1996

Location: Western pond.

pH: 7.7                      Water Temperature: 7 °C                      Clarity: Clear

Comments: Marsh grass growing around periphery. Thick sediment on bottom of lake.

---

## Test Pit Sampling Record

---

Sample: 39-TP1                      Coordinates: 1+95, Y1+30                      Date: September 07, 1996  
Location: Located on the NW side of the bare patch atop the mound.

Adjacent Vegetation:      No vegetation growth on the surface. Within a 2 metre radius there were small poplars growing (maximum height of 3 metres).

Ground Description:      Gravel on surface. The test pit consisted of packed soil and gravel from the surface to the bottom of the test pit (a 2 metre depth).

Sample Profile:              Refer to 39-S1. Taken at 2 metre depth. 10% stone, 40% pebbles. Soil colour was medium brown.

---

Sample: 39-TP2                      Coordinates: 1+25, Y1+35                      Date: September 07, 1996  
Location: Located on the SE side of the mound on the second tier.

Adjacent Vegetation:      Lush fireweed and rose hip growth adjacent to old uprooted dead tree stumps.

Ground Description:      On the surface empty cement bags and old lumber (possibly from pallets), 1960's era empty oil cans, pop tins, metal strips and broken glass.

Sample Profile:              Refer to 39-S2. Taken at 1 m. depth. Soil grey/light brown and quite fine. 20% of the sample was pebbles.

---

Sample: 39-TP3                      Coordinates: 1+76, Y1+49                      Date: September 07, 1996  
Location: Located on the SW side of the mound, halfway down to the second tier.

Adjacent Vegetation:      Dense growth of raspberries, poplars, uprooted old stumps and rose hips. Adjacent to 4 metre high poplars.

Ground Profile:              On surface some 6" rusted cans - possibly oil cans - and miscellaneous smaller cans. Underneath this was a 20 cm active layer. At 0.5 metre depth a green bottle and some cans were found. At 1.5 metre depth the sand was light brown/grey and silty.

Sample Profile:              Sample 39-S3 was taken at 0.5 metre depth and was brown in colour. It was taken near some tin cans. Sample 39-S4 was taken at 1.5 metre depth, the sample was hard packed-possibly native soil.

---

Sample: 39-TP4                      Coordinates: 1+76, Y1+49                      Date: September 07, 1996  
Location: In between 39-TP2 and 39-TP3 but on the edge of the mound overlooking the ponds

Adjacent Vegetation:      Fireweed, raspberries, poplar (4 m. high), uprooted tree stumps and rosehips.

Ground Profile:              Food tins, oil cans, butter and coffee tins, "Peerless" motor oil cans, roof tar paper and lumber scraps

Soil Profile:                  At 0.5 metre depth small cans visible, soil is brown and gravelly. At the 1 metre depth soil is hard packed. Refer to 39-S8 for soil analysis.

---

## Soil Sampling Record

---

Sample: 39-S1

Coordinates: 1+25, Y1+30

Date: September 07, 1996

Location: At the bottom of Test Pit #1 (39-TP1), which was located on the NW side of the bare patch atop the mound.

Adjacent Vegetation: No vegetation growth on the surface. Within a 2 metre radius there were small poplars growing (maximum height of 3 metres).

Ground Description: Gravel on surface. The test pit consisted of packed soil and gravel from the surface to the bottom of the test pit (a 2 metre depth).

Sample Profile: Taken at 2 metre depth. 10% stone, 40% pebbles. Soil colour was medium brown.

---

Sample: 39-S2

Coordinates: 1+25, Y1+35

Date: September 07, 1996

Location: At the bottom of Test Pit #2 (39-TP1), which was located on the SE side of the mound on the tier.

Adjacent Vegetation: Lush fireweed and rose hip growth adjacent to old uprooted dead tree stumps.

Ground Description: On the surface empty cement bags and old lumber (possibly from pallets), 1960's era empty oil cans, pop tins, metal strips and broken glass.

Sample Profile: Taken at 1 m. depth. Soil grey/light brown and quite fine. 20% of the sample was pebbles.

---

Sample: 39-S3

Coordinates: 1+90, Y1+50

Date: September 07, 1996

Location: At the bottom of Test Pit #3 (39-TP3), which was located on the SW side of the mound, halfway down to the second tier.

Adjacent Vegetation: Dense growth of raspberries, poplars, uprooted old stumps and rose hips. Adjacent to 4 metre high poplars.

Ground Description: On surface some 6" rusted cans - possibly oil cans - and miscellaneous smaller cans. Underneath this was a 20 cm active layer. At 0.5 metre depth a green bottle and some cans were found. At 1.5 metre depth the sand was light brown/grey and silty.

Sample Profile: Sample was taken at 0.5 metre depth and was brown in colour. It was taken near some tin cans.

---

---

Sample: 39-S4

Coordinates: 1+90, Y1+50

Date: September 07, 1996

Location: At the bottom of Test Pit #3 (39-TP3), which was located on the SW side of the mound, halfway down to the second tier.

Adjacent Vegetation: Dense growth of raspberries, poplars, uprooted old stumps and rose hips. Adjacent to 4 metre high poplars.

Ground Description: On surface some 6" rusted cans - possibly oil cans - and miscellaneous smaller cans. Underneath this was a 20 cm active layer. At 0.5 metre depth a green bottle and some cans were found. At 1.5 metre depth the sand was light brown/grey and silty.

Sample Profile: At 1.5 M depth, sample hard packed-possibly native soil.

---

Sample: 39-S5

Coordinates: 1+10, Y1+25

Date: September 07, 1996

Location: Adjacent to Kathleen River, on bank shore. Close to 39-W3.

Adjacent Vegetation: Poplar trees present along river bank. Some metal debris adjacent to area.

Sample Profile: 5 mm active layer.  
0-2 inches: 40% gravel and 60% river clay. The clay is light grey and very malleable.  
2-6 inches=sample: moist, malleable clay; used a stick to push sample out of auger: 10% pebble, a trace of brown sand; 20% of sample discarded.  
6-8 inches: same characteristics as 2-6 inches, hit rock at 8 inches.

---

Sample: 39-S6

Coordinates: 1+60, Y1+75

Date: September 07, 1996

Location: Adjacent to east pond on north side.

Adjacent Vegetation: Marsh grass

Sample Profile: Entire sample is decayed vegetable/marsh matter; brown sludge with visible plant matter; sample taken 30 cm from pond.

---

Sample: 39-S7

Coordinates: 1+80, Y1+75

Date: September 07, 1996

Location: Adjacent to west pond on north side.

Adjacent Vegetation: Marsh grass, moss.

Sample Profile: Rocks 2 inches below surface, numerous auger holes.  
Sample taken about 2.5 m from pond  
2 inch active layer  
4 inch very organic dark brown soil-part of sample  
3 inch gravel/clay river silt: about 35%pebble-part of sample

---



