

**TOWN of WATSON LAKE
- Index**

Legend

- Legal Survey
- FN Interim Protected Lands
- Land Disposition

Yukon
Energy, Mines and Resources
Sustainable Development Division
Land Planning Branch
db 25 March, 2019

Map 1

WATSON LAKE WYE SUBDIVISION

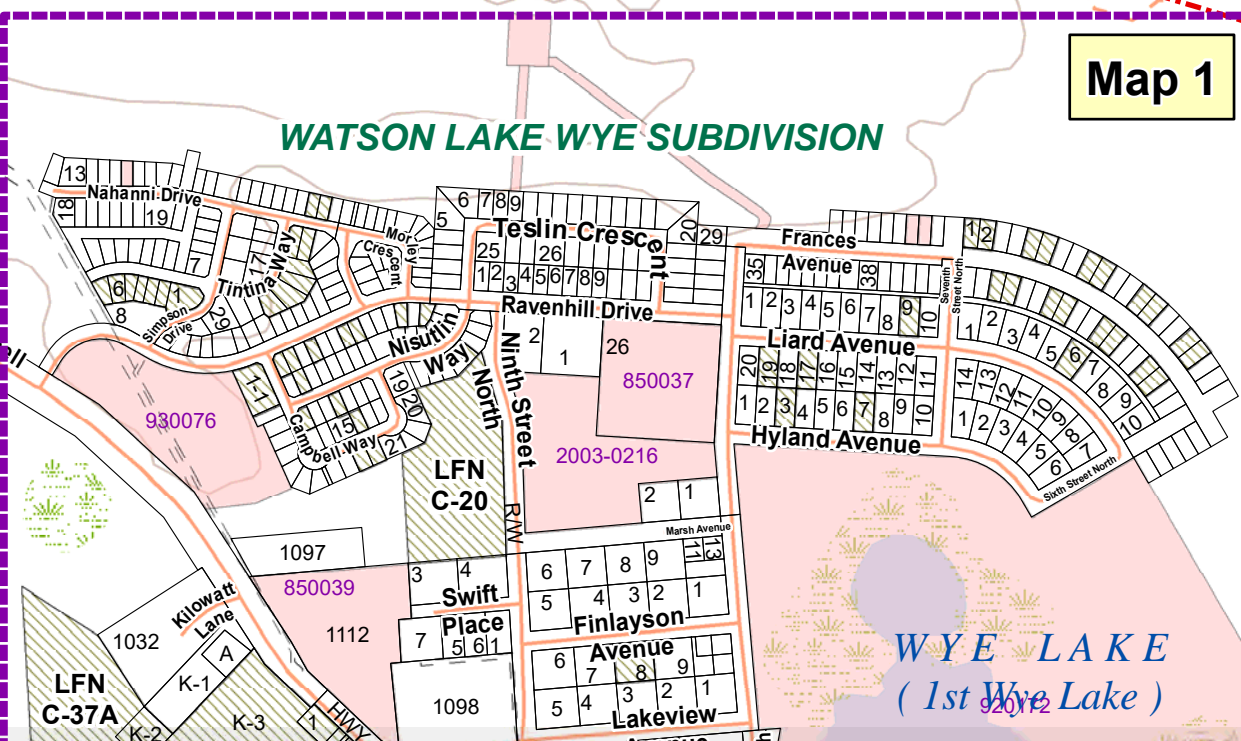

Map 2

Map 3

WATSON LAKE INDUSTRIAL SUBDIVISION

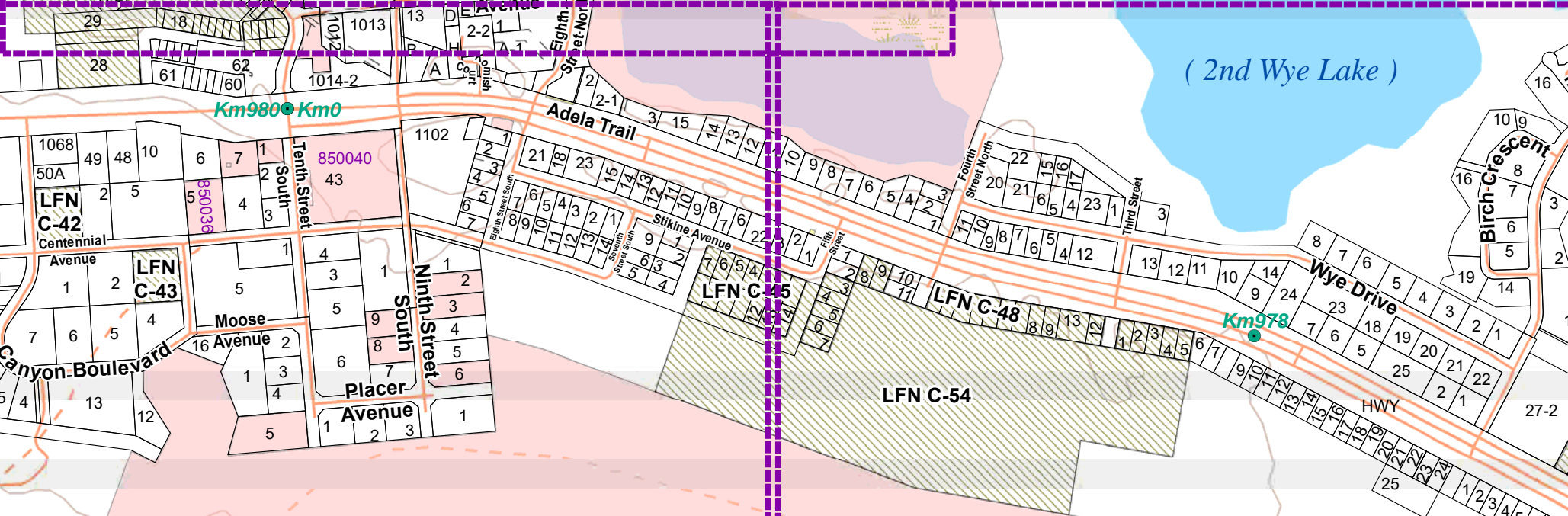

Map 4

BELLEVIEW SUBDIVISION

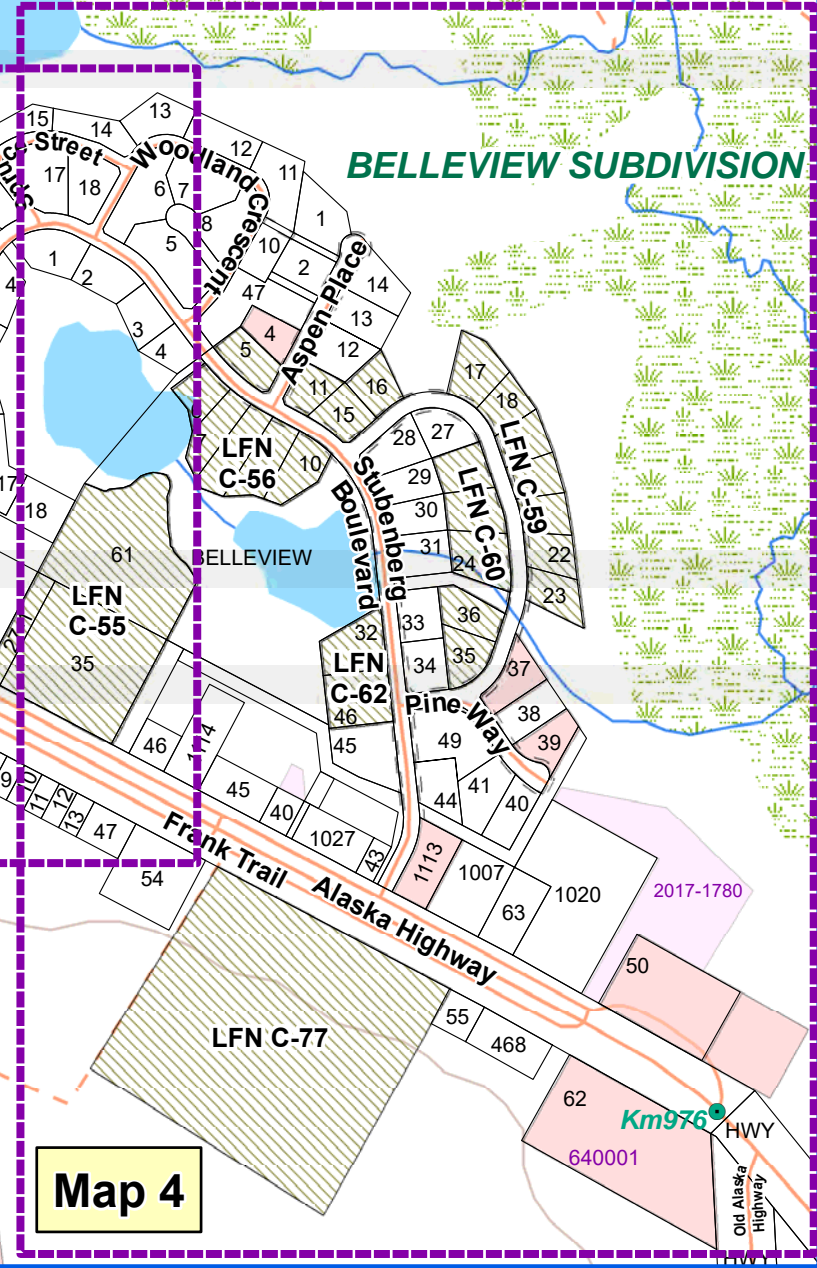

105A02-068

2017-1780

Km976

640001

(2nd Wye Lake)

WYE LAKE
(1st Wye Lake)

Km980 Km0

Km978

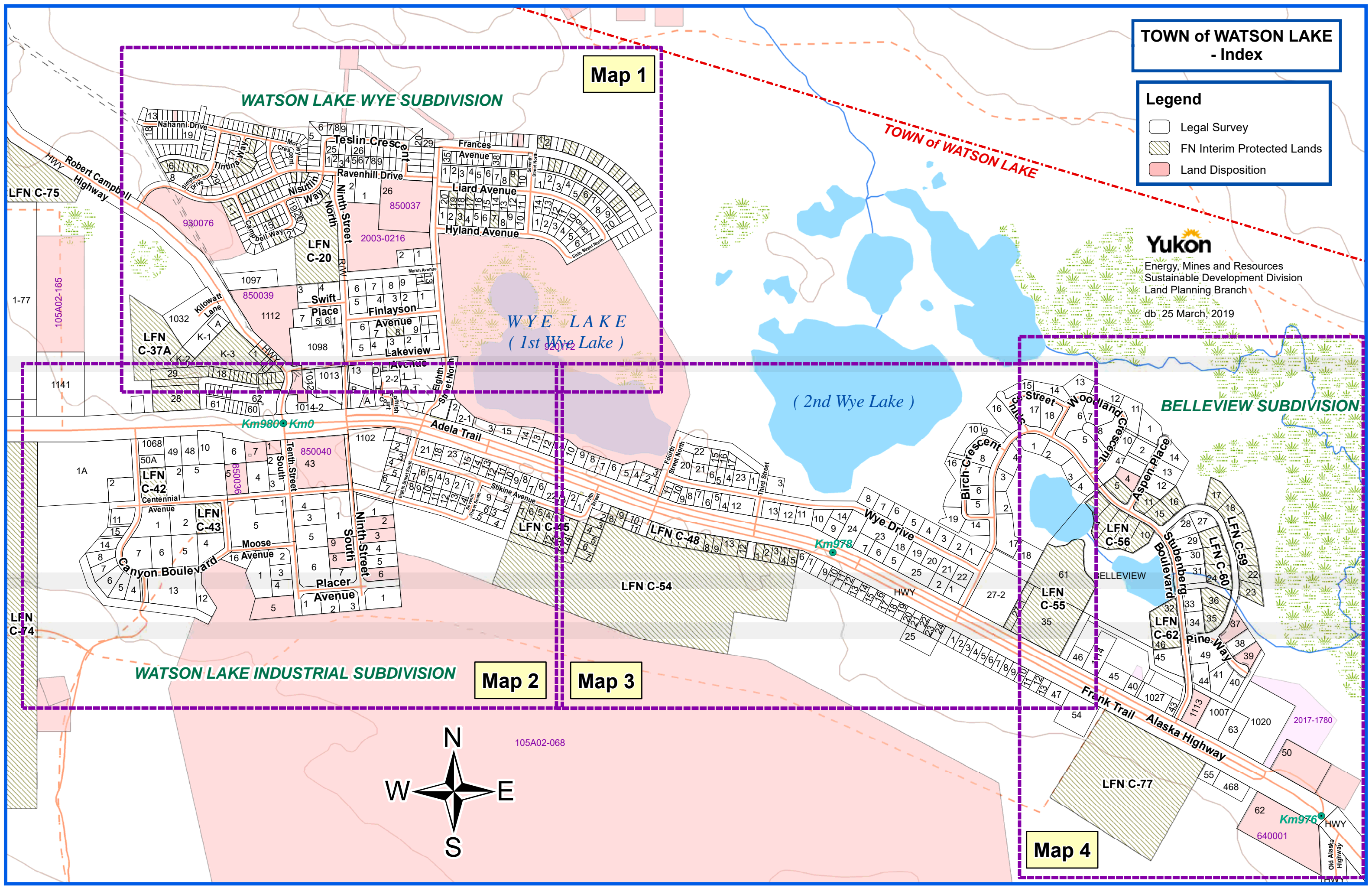

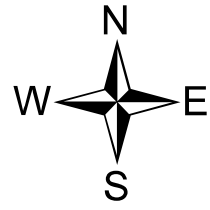

TOWN of WATSON LAKE
- Map 1

Legend

- Legal Survey
- FN Interim Protected Lands
- Land Disposition

Yukon
Energy, Mines and Resources
Sustainable Development Division
Land Planning Branch
db 25 March, 2019

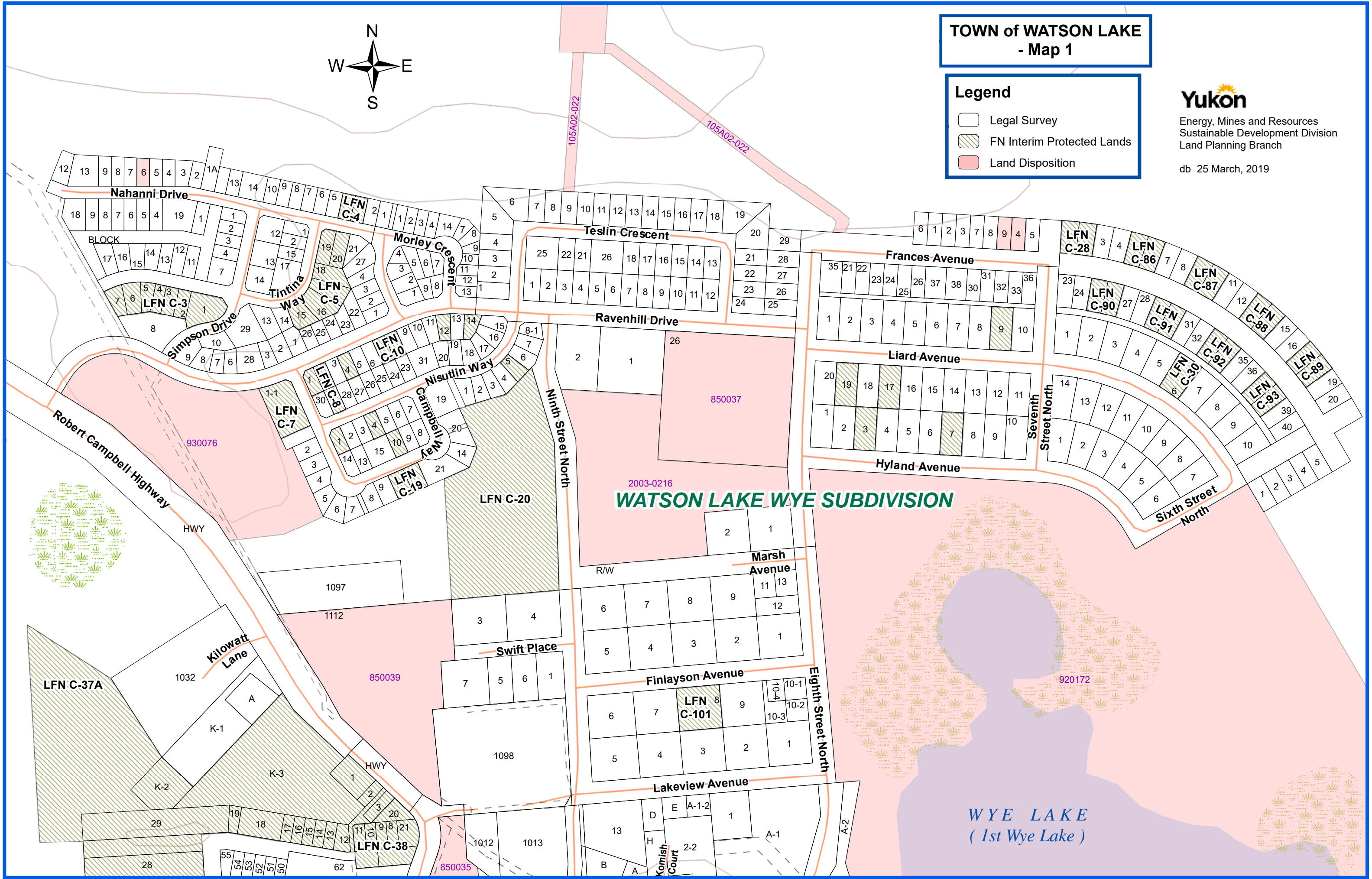

WATSON LAKE WYE SUBDIVISION

WYE LAKE
(1st Wye Lake)
920172

ALASKA HIGHWAY

Km0
Km980

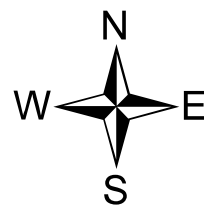

WATSON LAKE INDUSTRIAL SUBDIVISION

TOWN of WATSON LAKE
- Map 2

Legend

- Legal Survey
- FN Interim Protected Lands
- Land Disposition

Yukon
Energy, Mines and Resources
Sustainable Development Division
Land Planning Branch
db 25 March, 2019

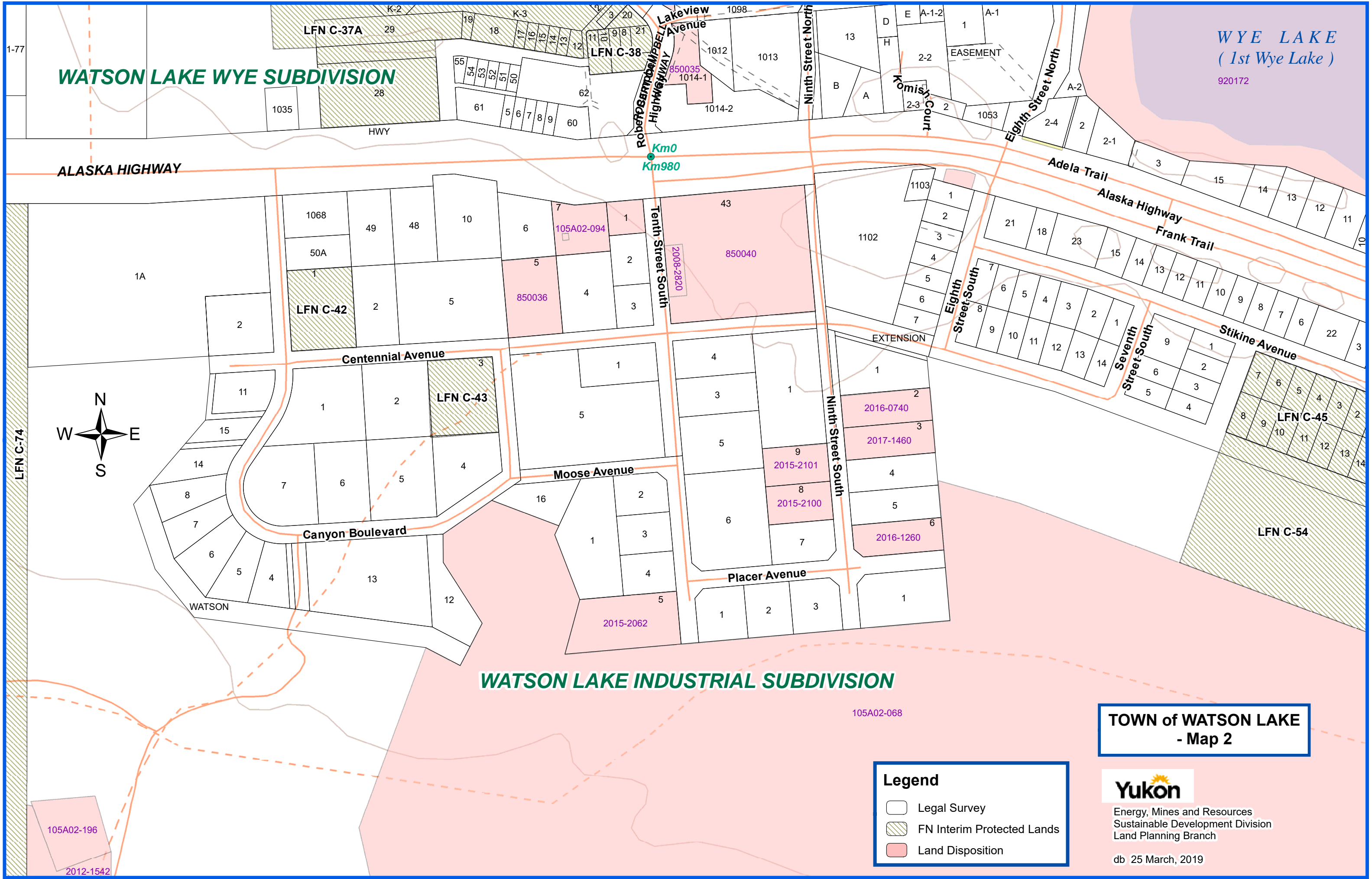

920172
WYE LAKE
(1st Wye Lake)

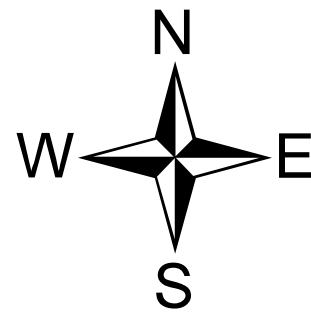

(2nd Wye Lake)

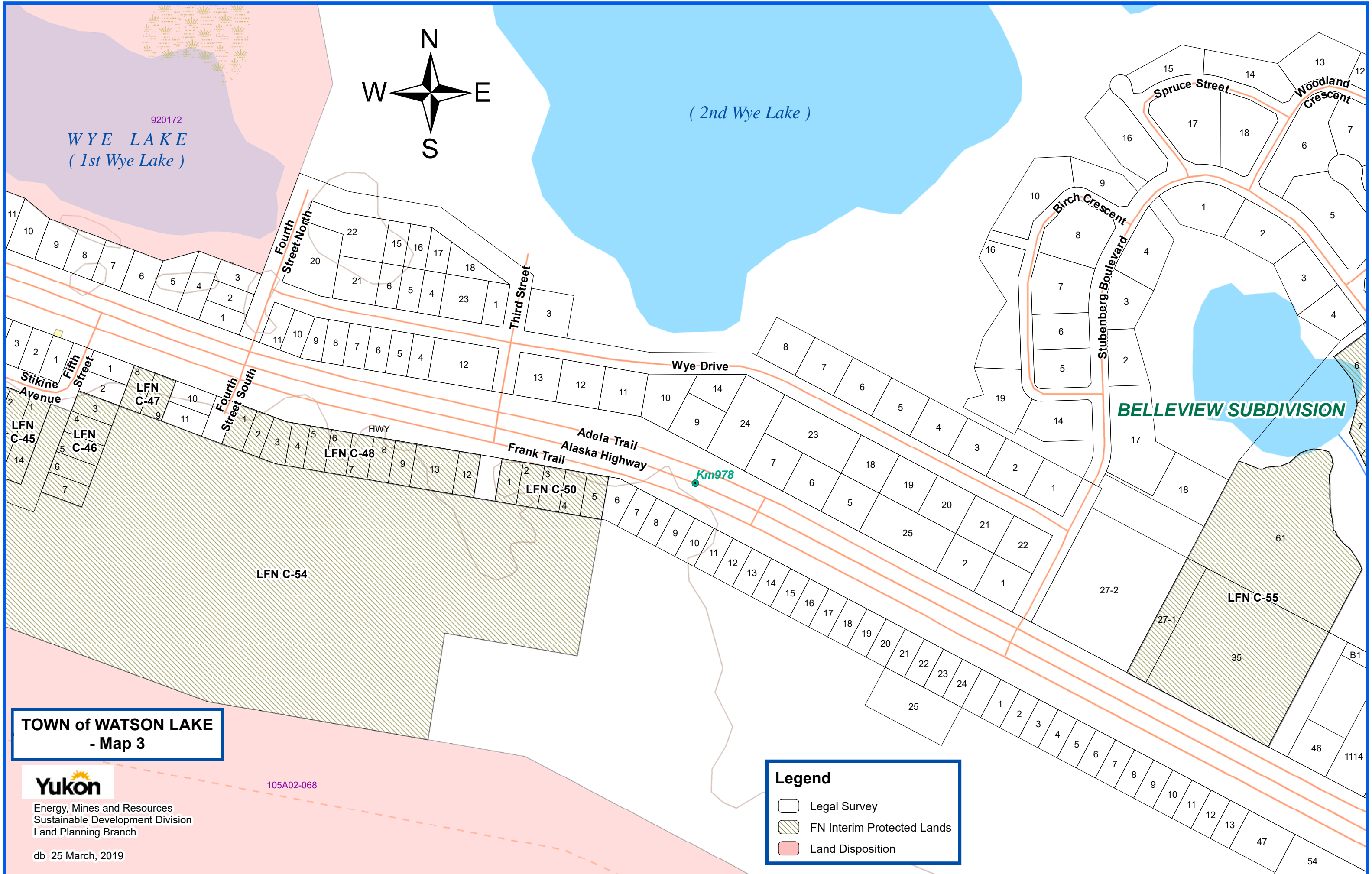

BELLEVIEW SUBDIVISION

TOWN of WATSON LAKE
- Map 3

Yukon
Energy, Mines and Resources
Sustainable Development Division
Land Planning Branch

db 25 March, 2019

105A02-068

Legend

- Legal Survey
- FN Interim Protected Lands
- Land Disposition

TOWN of WATSON LAKE
- Map 4

Legend

- Legal Survey
- FN Interim Protected Lands
- Land Disposition

Yukon
Energy, Mines and Resources
Sustainable Development Division
Land Planning Branch

db 25 March, 2019

