

YUKON TERRITORIAL GOVERNMENT
EXPLORATION INCENTIVES PROGRAM
PROJECT ~~95-080~~

**PLACER PROSPECTING ON
BROWN'S CREEK**

APRIL 11 - OCTOBER 8, 1995

TRANSVERSE MERCATOR PROJECTION CO-ORDINATES
141°52' longitude - 64°19' latitude
PLACER CLAIM SHEET 116C-7

prepared by
L. Chapman

Box 460, Dawson City
Yukon, Y0B-1G0

TABLE OF CONTENTS

1. Property Description	1
2. Summary of Previous Relevant Investigations	1
3. Objectives	2
4. Method	2
5. Results	2
6. Conclusions and Recommendations	2

TABLES

Table 1 - Results of Grab Samples Processed in Camp	4
Table 2 - 6-7 lb. Samples Panned on Site	5
Table 3 - 6-7 lb. Samples from Excavations Panned on Site	9
Table 4 - Grab Samples Processed in Camp	10
Table 5 - 6-7 lb. Samples from Excavations Panned on Site	11
Table 6 - 6-7 lb. Samples from Excavations Processed in Camp	13

MAPS

Map 1 - Project Location	15
Map 2 - Work Locations	16
Map 3 - Airphoto	17

FIELD NOTES

1. Property Description

Brown's Creek is a right limit tributary of the Fortymile River. The confluence of Brown's Creek and the Fortymile River is located approximately 4 miles below the Alaska/Yukon border and approximately 19 miles above the confluence of the Fortymile River and the Yukon River. The coordinates are 140° 52' longitude and 64°19' latitude. I looked at the first 2½ miles of the creek in this prospecting project. See the attached topographic map, **Map 1**, and claim sheet, **Map 2**, for the property location.

Brown's Creek is approximately 15 miles long and alternates between narrow gorges and wider flat areas. Most of the ground in the creek valley is frozen. Vegetation consists of black spruce and alders along the creeks banks. There are outcroppings and cliffs of both schist and basalt along the creek valley.

There is access to the property via a bush road which takes off from the Top of the World Highway and follows the ridge between Brown's Creek and Moose Creek. There are various spurs of this road which drop into the creek valley. I gained access to the creek by riverboat up the Fortymile River to the mouth of the creek, and then walked up the creek.

Brown's Creek is also sometimes known as Gates Creek. This is incorrect; Gates Creek was the old name for the downstream right limit Fortymile tributary which is now known as Bruin Creek.

2. Summary of Previous Relevant Investigations

Brown's Creek was worked in the late 1880's and 1890's during the Fortymile gold rush, although there is no evidence of extensive workings. There was a trail up Brown's Creek and into the Sixtymile River in the early days.

In 1975 a miner from Alaska obtained a lease on this section of Brown's Creek and worked briefly in the mouth of the creek with a 6 inch diameter suction dredge. He excavated a hole approximately 8 feet deep and ran into a layer of clay which he could not penetrate. He cleaned-up 10 grams of gold from the hole. Some of this gold which he recovered consisted of coarse particles. Because his dredge couldn't excavate to bedrock he didn't pursue the prospect.

There have been at least 10 different mining ventures in the Brown's Creek since the early 1980's. Reportedly, the gold produced by these operations is primarily fine and flakey. Most of the activity in Brown's Creek has been in the upper reach of the creek. This upper section of the creek is staked in placer claims. The lower portion, approximately 5 miles, of the creek has been staked to claims and then dropped in recent years.

3. Objectives

The purpose of this project was to identify viable placer reserves in the lower reaches of the creek. I was looking primarily for thawed gravel which would be suitable for floater dredging. As this was a preliminary prospecting project, the focus was to establish gold presence and to examine the gold recovered to determine the general size and shape of the gold particles. I didn't attempt to assign grade figures or reserve estimates to the property.

4. Method

I visited the area in early April while travel on the Fortymile River ice was still possible. I gathered samples which I hauled back to my camp for processing. I took samples from several excavations which a previous prospector had made with a cat. I also took samples from exposed gravel in the creek banks. I processed the samples using a spiral gold wheel.

After breakup, a prospecting assistant and I worked on the project based from our mining camp approximately 4 miles downstream from the mouth of Brown's Creek. We walked over the property taking pans from exposed gravel in the creek banks, from gravel on the creek bars, and from gravel exposed by cat work done by previous prospectors in the area. I explored the draws, or gulches draining into the creek looking for exposed gravel, and for thawed ground.

I hired a second assistant to dig some pits in areas which I thought might be not frozen on the benches adjacent to the creek. The location of these excavations is shown on **Map 2**. I took pans from these pits as they were being excavated. I also took 7 lb. samples back to camp for processing and analysis.

5. Results

Results are shown in the attached tables. I found some fine colours in the upper gravel layers. I obtained larger, flakey pieces from samples taken off bedrock. The size of the gold particles recovered in the samples ranged from very fine colours of 100 mesh to flakes of 30 mesh. The average size of the gold particles recovered is approximately 60 mesh. A copy of my field notes is attached.

The gravel is moderately well washed and rounded. The ground is sandy with gravel and sand layers alternating. There is little clay. Bedrock is a slabby, broken schist. There are also basalt outcrops. Depth to bedrock is shallow, 2 to 3 feet, near bedrock outcrops and creek cliffs. Depth to bedrock on the flats is unknown, but is greater than the 6 feet to which I excavated by hand.

6. Conclusions and Recommendations

Although I found some gold values in the entire gravel section, colours in top gravels are fine and far less common than on bedrock. I obtained some large flakes from samples taken off bedrock. I found it encouraging that large colours could be panned from

bedrock; it seems likely that there is coarse gold on bedrock. Further work is required to determine grade figures. Further work could also provide information as to whether there is sufficient gold in the upper layer gravels to make sluicing them worthwhile, or whether they should be regarded as overburden and stripped. Not all of the excavations yielded colours, and some of them had few colours, indicating spotty distribution of gold.

Some of the wider areas of the creek appear to have sufficient reserves to be suitable for mining using conventional dozer mining techniques. I found that most of the ground in the lower portion of Brown's Creek is permafrost, and therefore of limited suitability for mining by floater dredging.

I recommend that further work be done, preferably with heavy equipment, excavating several trenches to bedrock. Indications are that this ground would be relatively low in grade, but it may well have reserves grading sufficiently high to be profitably mined, particularly if the gold price increases from current levels of approximately US\$380.

Access to the property is fair. The bush access road from the Top of the World Highway requires upgrading to provide reliable access. Access from the lower end of the property would involve fording the Fortymile River. This would limit access by heavy equipment to times of low water, and a boat would be necessary for general support of a mining operation from the lower end of the property.

The lower 2 miles of Brown's Creek is classified as a Type 2, salmon rearing stream, by the Yukon Placer Authorization. For this reason, strict regulatory standards would apply to mining on this portion of the creek, and Fisheries issues would have to be addressed in mine planning.

Table 1
Results of Grab Samples Processed in Camp

Sample #	Weight Lbs.	# of Colours	Comments
1 1	7	1	bank sample, small colour, little black sand
1.2	7	0	bank sample
1 3	7	0	bar sample
1.4	35	2	sample from old stripped area, fine colours, little black sand
1 5	6	0	from old stripped area
1.6	7	1	bank sample, small flake
1.7	6	0	bank sample, garnets
1.8	6	1	bank sample, fine colour
1 9	42	5	old trench, fine colours
1.10	7	1	old trench, flake
1.11	7	0	old trench
2.1	7	0	bank sluff
2.2	7	1	bank sluff, fine colour
2.3	6.5	0	surface gravel from bar
2.4	6.5	0	bar gravel just under surface
2.5	7	4	old cat pit, fine colours
2.6	44	9	old cat pit, 1 flake
2 7	7	1	back end old cat pit, fine colour
2.8	41	2	back end old cat pit, fine colours

Table 2
6-7 lb. Samples Panned on Site

Samples 4.1 - 4.7 from old cat pit #1

Sample #	# Colours	Comments
4.1	0	
4.2	1	fine colour, lots black sand
4.3	0	
4.4	2	flakes
4.5	0	
4.6	0	
4.7	2	fine colours

Samples 5.1 - 5.10 from old cat pit #2

Sample #	# Colours	Comments
5.1	2	fine colours
5.2	0	
5.3	0	
5.4	1	fine, some black sand
5.5	0	
5.6	0	
5.7	0	
5.8	1	fine colour
5.9	1	
5.10	0	

Table 2 - continued
6-7 lb. Samples Panned on Site

Sample #	# Colours	Comments
6.1	0	bank gravel
6.2	0	bank gravel
6.3	0	creek bar gravel
6.4	1	fine colour, bar gravel
6.5	0	bar gravel
6.6	0	bar gravel
6.7	0	bar gravel
6.8	1	fine colour, bank gravel
6.9	2	fine colours, bank gravel
6.10	0	bank gravel
6.11	0	bank gravel near bedrock outcrop
6.12	0	bank gravel
6.13	1	fine colour, bank gravel
6.14	0	bank gravel
7.1	0	west end of old cat pit #3
7.2	1	west end of old cat pit #3
7.3	4	fine colours, west end old cat pit #3
7.4	0	east end old cat pit #3
7.5	0	east end old cat pit #3
7.6	0	east end old cat pit #3
7.7	1	fine colour, from old trench
7.8	0	old trench
7.9	0	old trench

Table 2 - continued
6-7 lb. Samples Panned on Site

Sample #	# Colours	Comments
8.1	2	medium sized colours, from old trench
8.2	0	old trench
8.3	0	old trench
8.4	0	from large bar
8.5	0	from large bar
8.6	0	from large bar
8.7	1	fine colour, from large bar
8.8	1	large flake, from exposed bedrock
8.9	0	exposed bedrock
8.10	5	1 is large flake, from exposed bedrock
9.1	0	approx 18" into creek gravel
9.2	4	1 flake, garnets, 18" into creek gravel
9.3	0	approx 18" into creek gravel
9.4	0	approx 18" into creek gravel
9.5	0	approx 18" into creek gravel
9.6	0	approx 18" into creek gravel
9.7	2	approx 18" into creek gravel
9.8	0	approx 18" into creek gravel
9.9	0	approx 18" into creek gravel
9.10	1	fine colour, approx 18" into creek gravel

Table 2 - continued
6-7 lb. Samples Panned on Site

Sample #	# Colours	Comments
11.1	0	from draw #2
11.2	0	from draw #2
12.1	2	fine colours, from old cat pit #2
12.2	0	from old cat pit # 2
12.3	0	from old cat pit # 2
12.4	1	excavation by hand in old cat pit #2
12.5	1	fine colour, hand excav. in old cat pit #2
12.6	0	hand excav. in old cat pit #2
12.7	1	hand excav. in old cat pit #2
12.8	0	hand excav. in old cat pit #2
13.1	0	creek gravel near 1st right limit draw
13.2	0	creek gravel near 1st right limit draw
13.3	0	creek gravel near 1st right limit draw
14.1	0	creek gravel near 2nd right limit draw
14.2	0	creek gravel near 2nd right limit draw
14.3	0	creek gravel near 2nd right limit draw
14.4	1	creek gravel near 2nd right limit draw
14.5	0	creek gravel near 2nd right limit draw
15.1	0	1/4 mile up draw #3 (left limit)
15.2	0	1/4 mile up draw #3 (left limit)
15.3	0	1/4 mile up draw #3 (left limit)

Table 3
6 - 7 lb. Samples from Excavations Panned on Site

Excav #	Sample #	# Colours	Comments
16.1	16.1.1	0	3' x 5' x 3' deep in creek gravel
	16.1.2	0	
	16.1.3	1	fine colour
	16.1.4	0	
	16.1.5	0	
16.2	16.2.6	0	3' x 5' x 3' deep in creek gravel
	16.2.7	2	fine colours
	16.2.8	0	
	16.2.9	0	
	16.2.10	1	
17.3	17.3.1	0	3' x 5' x 3' deep in creek gravel
	17.3.2	0	
	17.3.3	0	
	17.3.4	0	
	17.3.5	0	
17.4	17.4.6	1	3' x 5' x 3' deep in creek gravel
	17.4.7	0	
	17.4.8	0	
	17.4.9	1	fine colour
	17.4.10	0	

Table 4
Grab Samples Processed in Camp

Sample #	# Colours	Comments
18.1	0	silty clay
18.2	1	fine colour, little black sand
18.3	0	silt and gravel
18.4	0	
18.5	0	from gravel bar
18.6	0	gravel bar
18.7	1	gravel bar
18.8	0	gravel bar
18.9	1	fine colour, creek gravel
18.10	0	gravel bar
18.11	0	from creek bank
18.12	0	from creek bank
18.13	0	gravel bar opposite cliff
18.14	3	1 is flake, creek gravel

Table 5
6 -7 lb. Samples from Excavations Panned on Site

Excav #	Sample #	# of Colours	Comments
1	19.1.1	0	clay and sand mixed with gravel
	19.1.2	0	
	19.1.3	0	
	26.1.4	0	
	26.1.5	0	
	26.1.6	0	
3	19.3.1	0	angular gravel
	19.3.2	0	
	19.3.3	0	
	19.3.4	1	fine colour
	19.3.5	0	
	27.3.6	0	
	27.3.7	0	
	27.3.8	1	fine colour
	27.3.9	0	
4	20.4.1	2	fine colours off top
	20.4.2	0	
	20.4.3	0	
	20.4.4	1	

Table 5 continued
6 - 7 lb. Samples from Excavations Panned on Site

Excav #	Samples #	# of Colours	Comments
5	20.5.1	0	
	20.5.2	3	fine colours, from clay layer on gravel
	20.5.3	0	
	20.5.4	4	2 are fine, 2 larger
	20.5.5	1	fine
	20.5.6	6	good sized colours, lots of black sand
6	20.6.1	0	no overburden, gravel on surface
	20.6.2	0	
	20.6.3	0	
	20.6.4	1	flake
	20.6.5	0	
	20.6.6	0	
7	21.7.1	0	surface sandy gravel
	21.7.2	3	3 feet down
	21.7.3	1	flake, from 4 feet down
	21.7.4	0	4 feet down
	21.7.5	3	1 is flake, from 4½ down
bedrock exposed in old workings	25.1	1	large flake
	25.2	0	
	25.3	2	large flakes
	25.4	4	includes 1 flake

Table 6
6 -7 lb. Samples from Excavations Processed in Camp

Excav #	Sample #	# Colours	Comments
1	26.1.7	0	
	26.1.8	0	
	26.1.9	0	
	26.1.10	0	
3	27.3.10	1	fine colour
	27.3.11	0	
	27.3.12	0	
	27.3.13	2	fine colours
	27.3.14	0	
4	22.4.1	0	
	22.4.2	1	fine colour
	22.4.3	0	
	25.4.4	0	garnets
	25.4.5	0	
	25.4.6	1	fine colour
	25.4.7	2	fine colours
	25.4.8	0	
	25.4.9	0	

Table 6 continued
6 -7 lb. Samples from Excavations Processed in Camp

Excav #	Sample#	# Colours	Comments
5	22.5.1	4	fine colours
	22.5.2	2	1 is flake
	22.5.3	0	lots of black sand
	28.5.4	1	flake
	28.5.5	3	medium size colours, lots black sand
	28.5.6	0	
	28.5.7	2	1 is flake
6	22.6.5	0	
	22.6.6	0	
	22.6.7	1	fine
	22.6.8	0	
	22.6.9	0	
7	21.7.6	4	1 is flake
	21.7.7	3	lots of black sand
	22.7.8	1	flake
	22.7.9	3	
bedrock	25.5	2	very large flakes
old	25.6	1	flake
working	25.7	0	

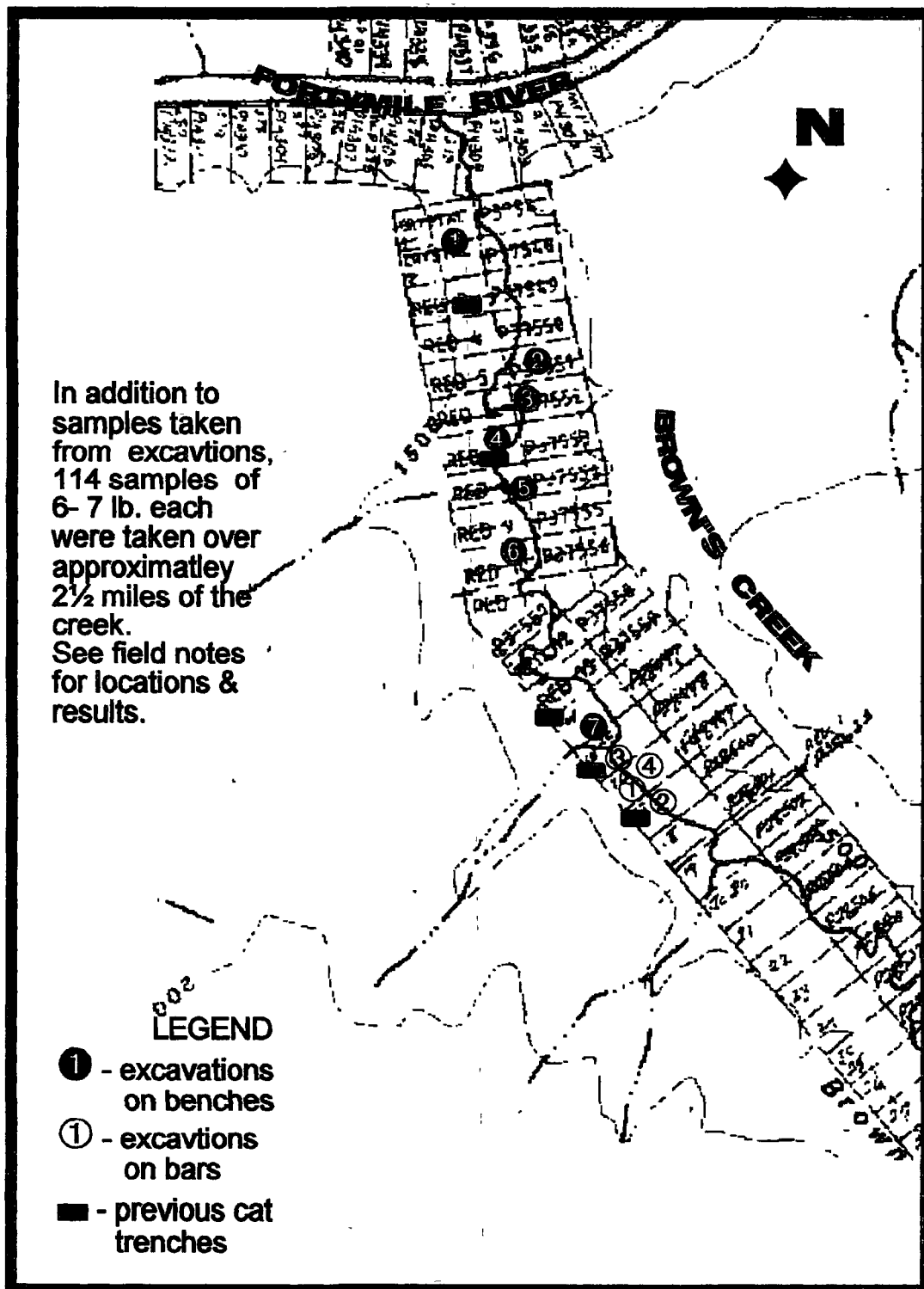

Map 2 - Work Locations

scale: ½" = 1000 ft.

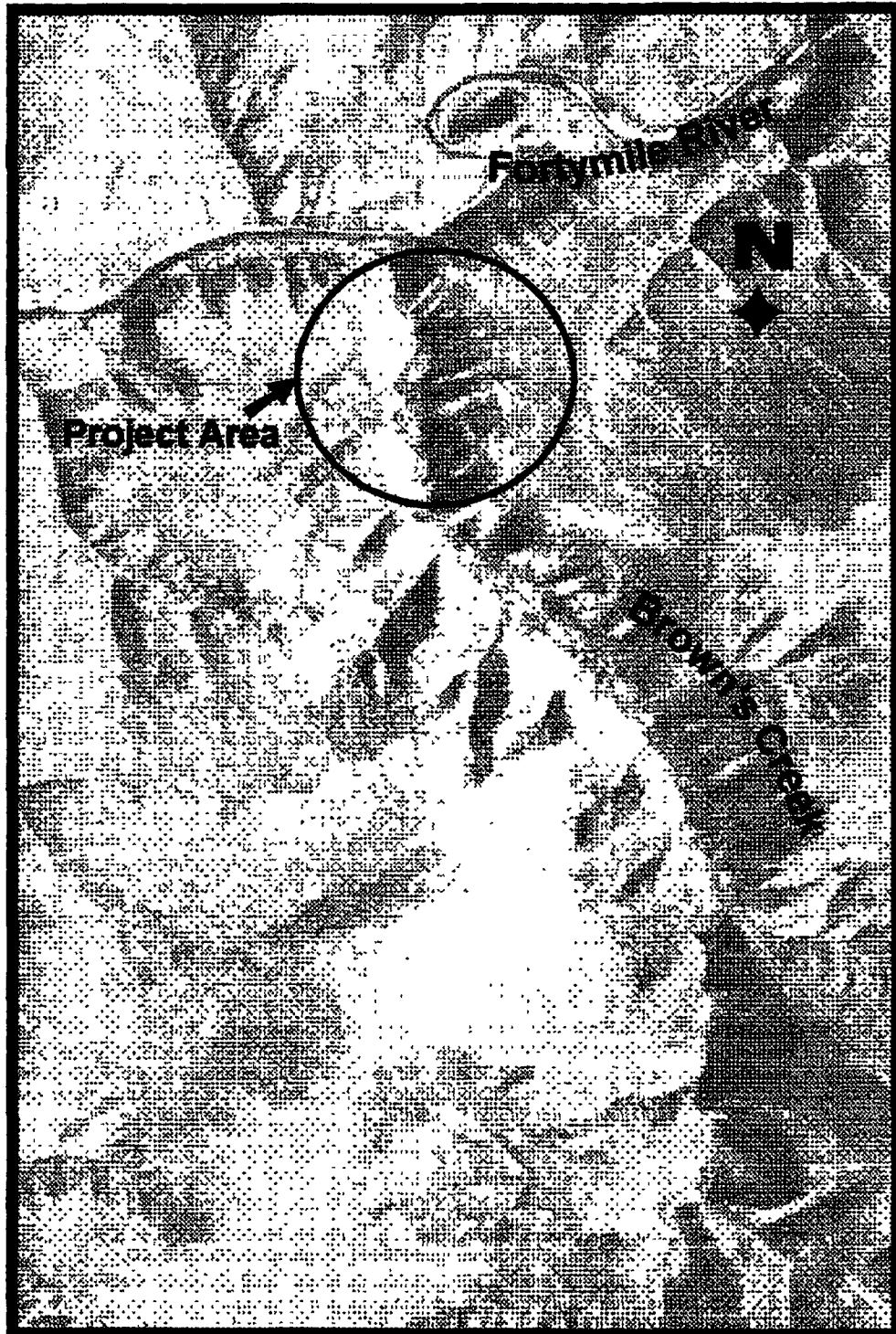

Map 3 - Airphoto

scale: 1" = 1.5 miles

April 11/95 (1)

Bill + I took 2 snowmachines up to Bruen Ck on the 40 mile ice. We had to go early because the ice is getting bad.

Samples taken from stuff gravel in creek bank. Some overflow in creek, but travel was surprisingly easy.

76 grab samples taken + transported back to camp + 2 pairs

1.1 - stuff gravel from creek bank

1.2 - stuff gravel from creek bank

1.3 - bar gravel

1.4 } from edge of stripped area

1.5 }

1.6 - bank sample

1.7 - bank sample

1.8 - bank sample

1.9 } from trench

1.10 }

1.11 }

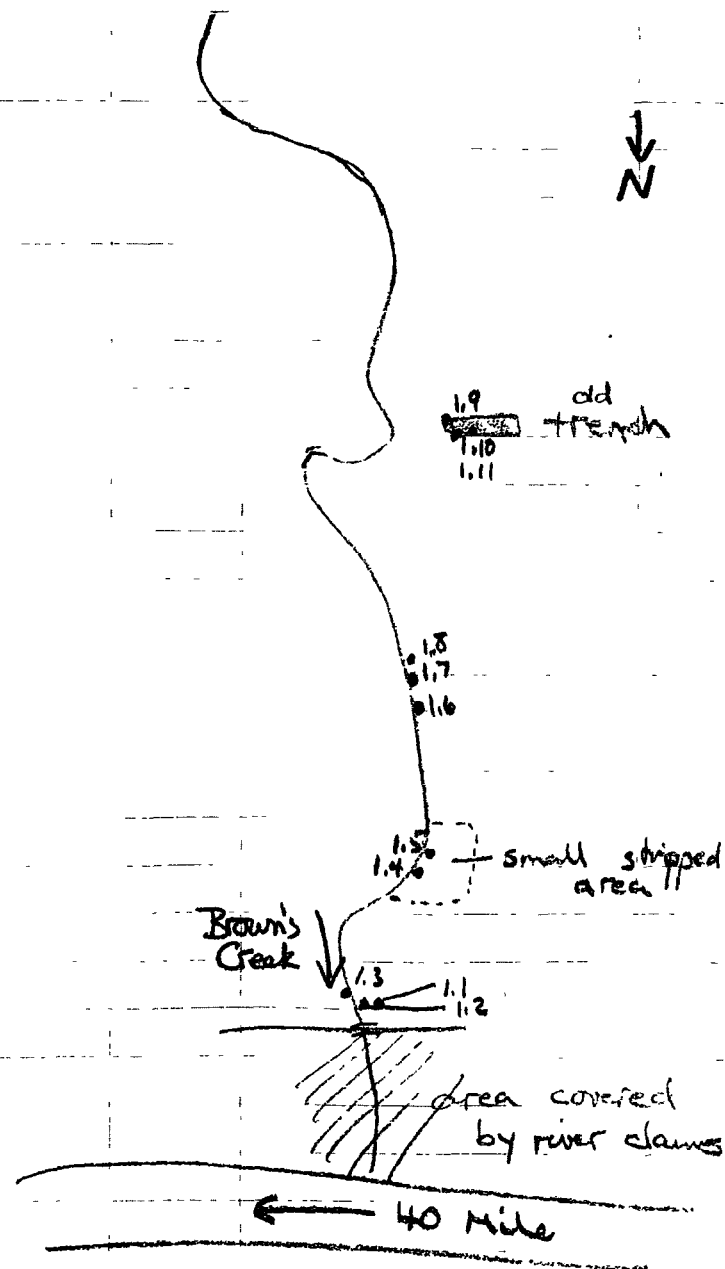

April 12/95 (2)

- 2.1 sample from bank sluff
- 2.2 sample from bank sluff
- 2.3 bar gravel surface
- 2.4 bar gravel from just under surface
- 2.5 front end old cat pit
- 2.6P " (2 1/2 gal pail)
- 2.7 - back end old cat pit
- 2.8P " (2 1/2 gal pail)

- 2 1/2 gal pail samples taken from old cat pit using a pail on frozen gravel
- all samples taken to camp for processing
- judging from the small black spruce, it looks like most of the creek valley is frozen ground

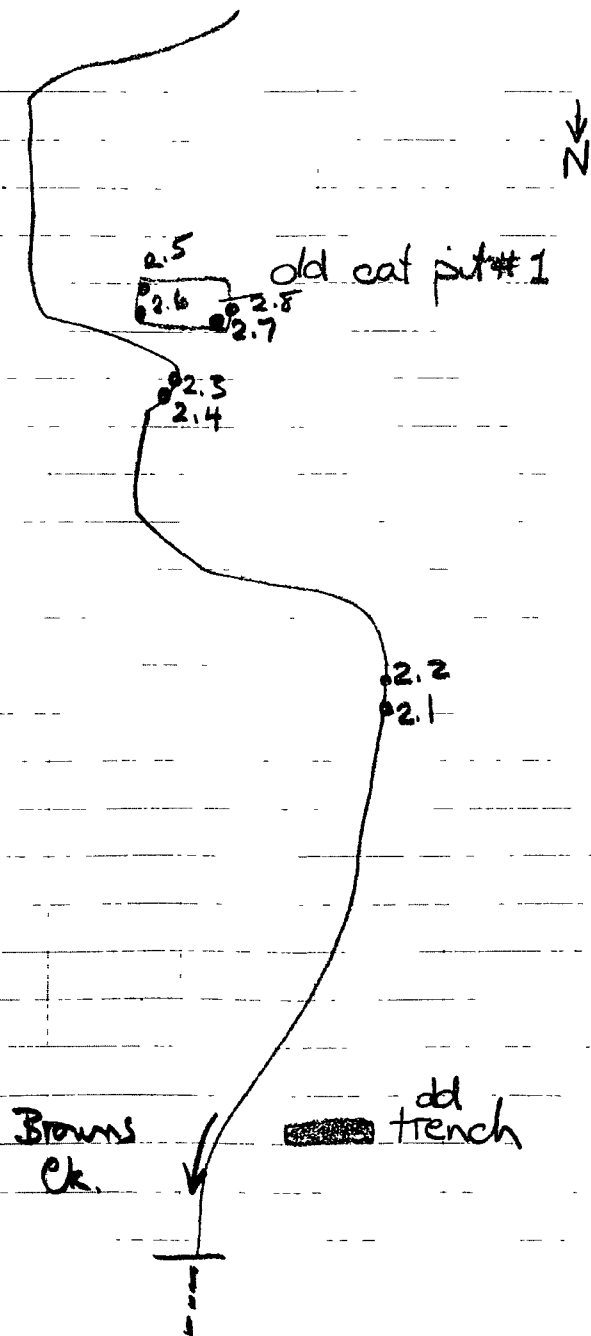

April 13/95 (3)

running samples thru gold wheel

1.1 - 7 lb.
- 1 small colour
- little blk sand.

1.2 - 7 lb
- 0

1.3 - 7 lb
- 0

1.4 - 35 lbs.
- 2 fine colours
- little black sand

1.5 - 6 lb
- 0

1.6 - 7 lb
- 1 small flake

1.7 - 6 lb
- 0 colours, some garnets

1.8 - 6 lb
- 1 fine colour

1.9 - 42 lbs.
- 5 fine colours

1.10 - 7 lb
- 1 flake

1.11 - 7 lb
- 0

	<u>weight</u>	<u># of colours</u>
2.1 -	7	0
2.2 -	7	1 fine
2.3	6.5	0
2.4	6.5	0
2.5	7	4 fine
2.6	44 lbs.	9 - 1 is flake
2.7	7 lbs.	1 fine
2.8 -	41 lbs.	2 fine

May 6/95 (4)
took boat up to mouth of
Brown's Creek - forty mile is high.
Bill + I walked up to the
old pit #1
panned no samples from creek gravel
because creek is high & cold - hard to cross!
samples from 'old pit #1'

- 4.1 - 0
- 4.2 - 1 fine, lots of blk sand
- 4.3 - 0
- 4.4 - 2 flakes
- 4.5 - 0
- 4.6 - 0
- 4.7 - 2 fine colours

this old cat pit is a trench pushed
up by a cat by a prairie propretor
in the creek. No bedrock evident. Pit
is approx 4' deep below very shallow
O.B. of mass.

9
May 7/95 (5)
Back up to the mouth of Brown's ck
by river - water higher today, some ice
in the river.
We walked up to the 2nd cat pit &
panned samples. This pit is deeper
with more gravel pushed up than
'old pit #1'.
Pit #2 extends across the creek

- 5.1 - 2 fine colours
- 5.2 - 0
- 5.3 - 0
- 5.4 - 1 fine w/ moderate blk sand
- 5.5 - 0
- 5.6 - 0
- 5.7 - 0
- 5.8 - 1 fine
- 5.9 - 1
- 5.10 - 0

note: pans taken w/ grizzly pan w/ 1/4"
holes - medium size pans of
about 6-7 lbs.

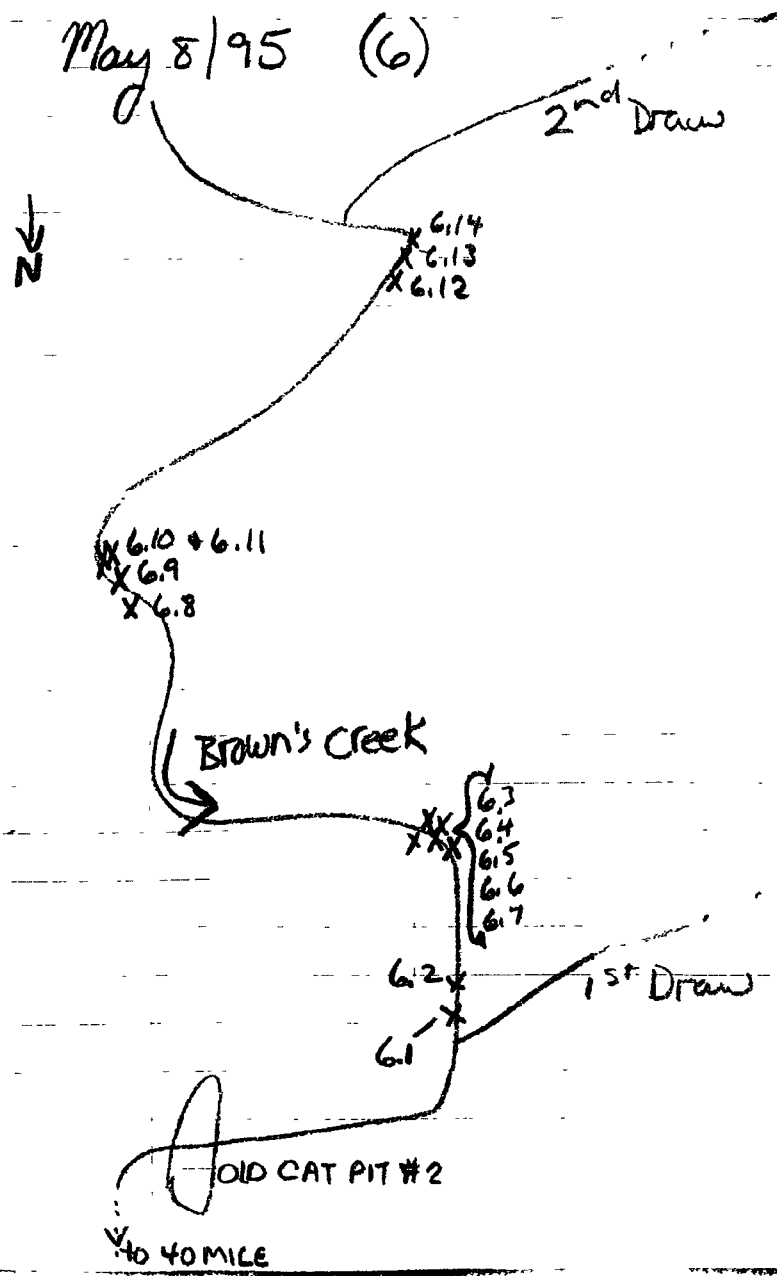
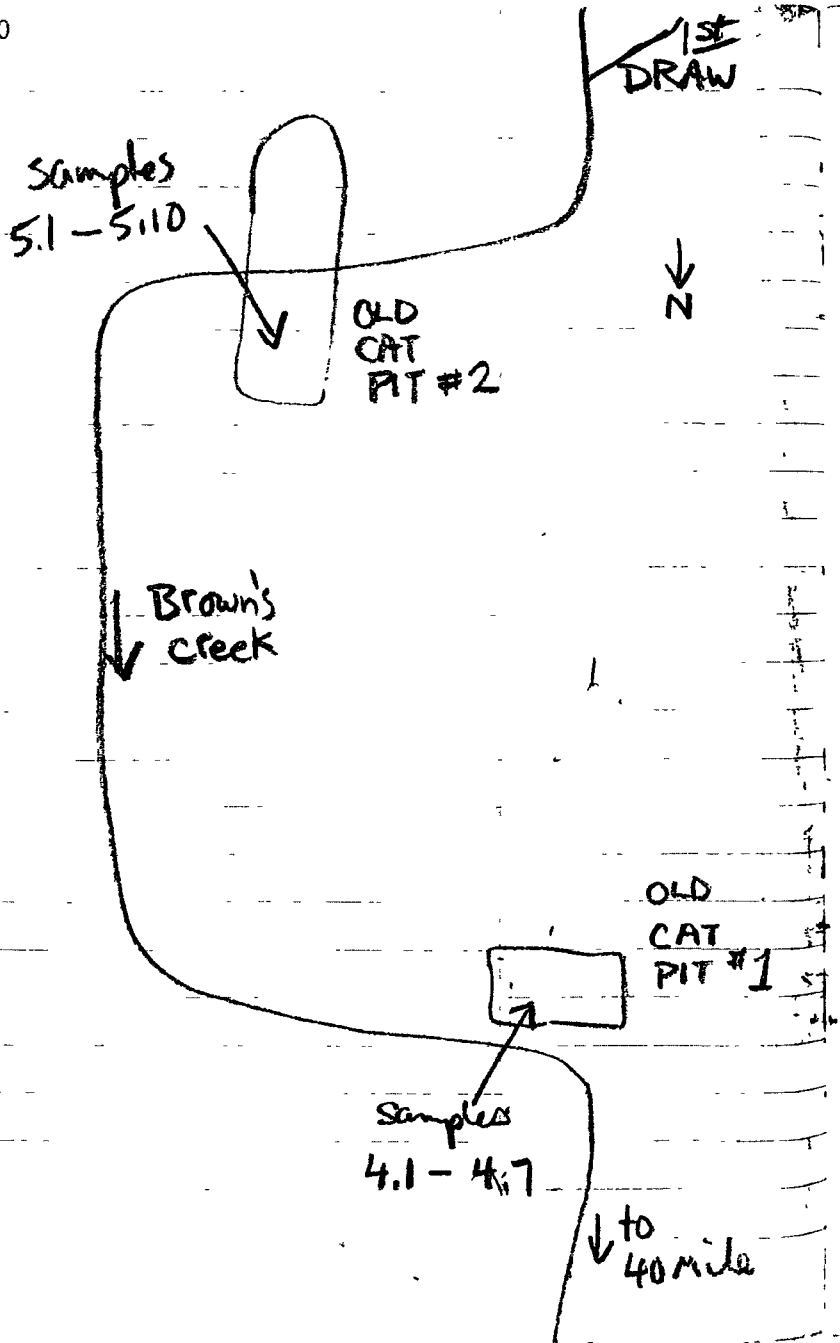

- 6.1 - 0 bank gravel
 6.2 - 0 bank gravel
 6.3 - 0 creek bar gravel
 6.4 - 1 bar
 6.5 - 0 bar
 6.6 - 0 bar
 6.7 - 0 bar gravel
 6.8 - 1 fine colour from bank
 6.9 - 2 fine colours from bank
 6.10 - 0 bank
 6.11 - 0 bank gravel near bank outcrop

- panned samples for bank & bar gravel between 1st & 2nd draws
- creek has dropped alot since yesterday - some high bars exposed, but water is still quite high
- outcroppings of basalt & dark gray schist along creek banks, less quartz veins than on similar 40 mile outcrops

- 6.12 - 0
 6.13 - 1 fine
 6.14 - 0 } from bank gravel

May 10/95 (7)

walked up to area of old workings - OLD CAT PIT #3 - further up the creek - above 2nd draw pans from lower end of workings

- 7.1 - 0
 7.2 - 1
 7.3 - 4 fine
 7.4 - 0
 7.5 - 0
 7.6 - 0
 7.7 - 1 fine
 7.8 - 0
 7.9 - 0

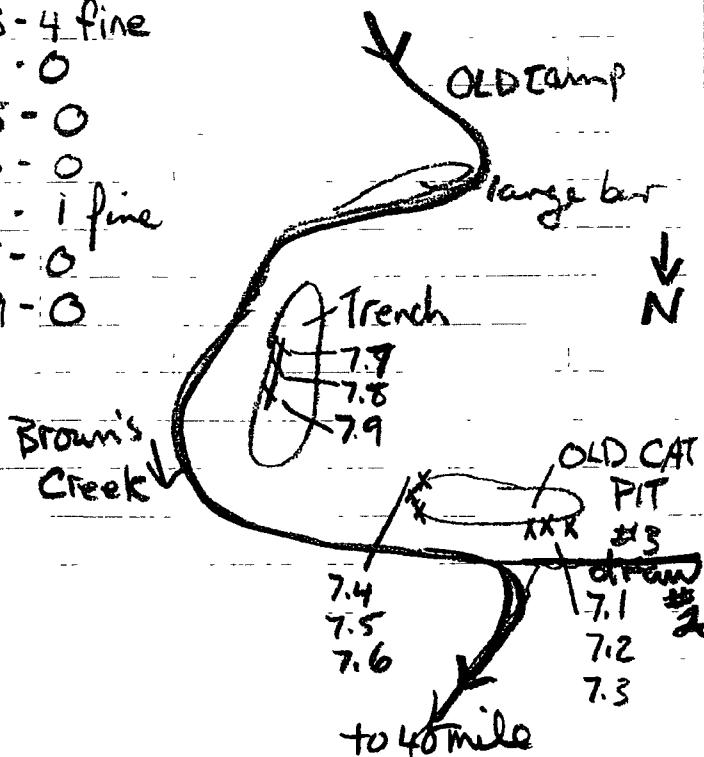

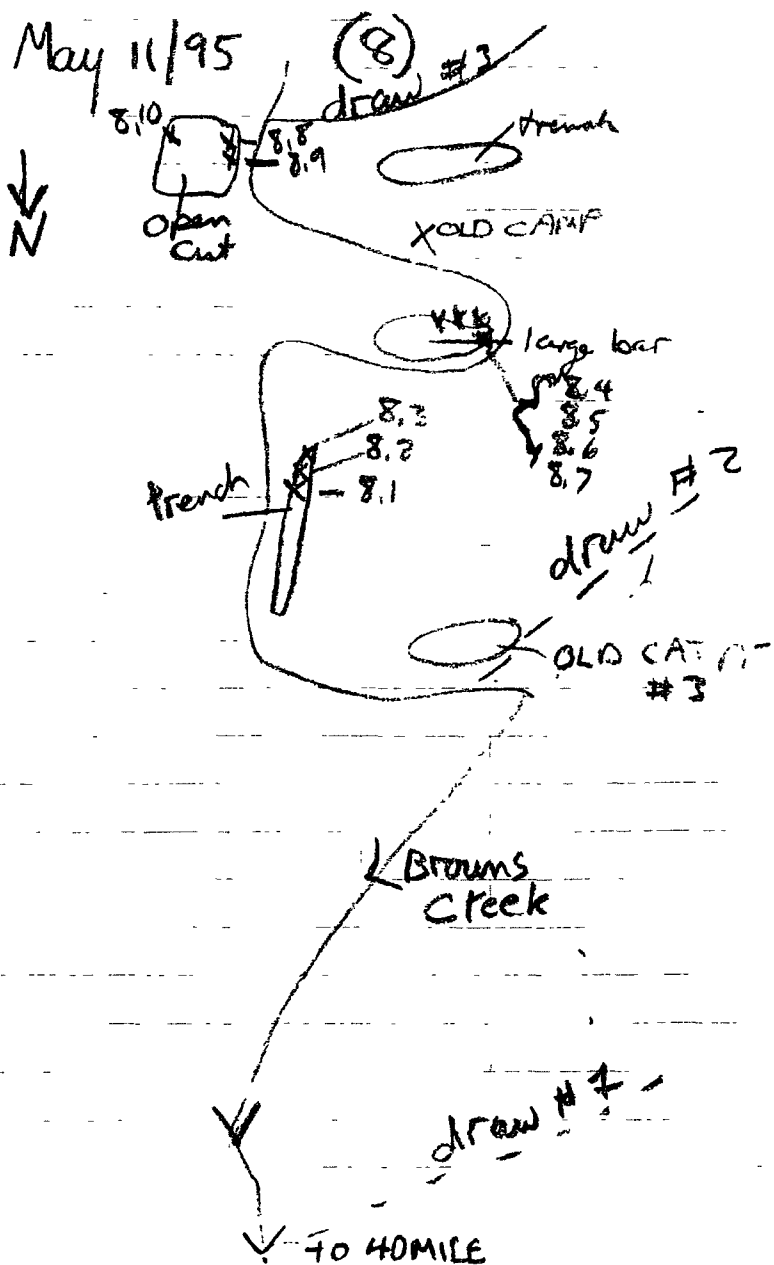

from trench

8.1 - 2 med sized clasts

8.2 - 0

8.3 - 0

from bar

8.4 - 0

8.5 - 0

8.6 - 0

8.7 - 1 fine clast

8.8 - 1 large flake

8.9 - 0

8.10 - 4 fine clasts + 1 large flake

bedrock exposed in open cut
 shallow gravel layer
 bedrock is a slabby schist

May 13/95 (9)

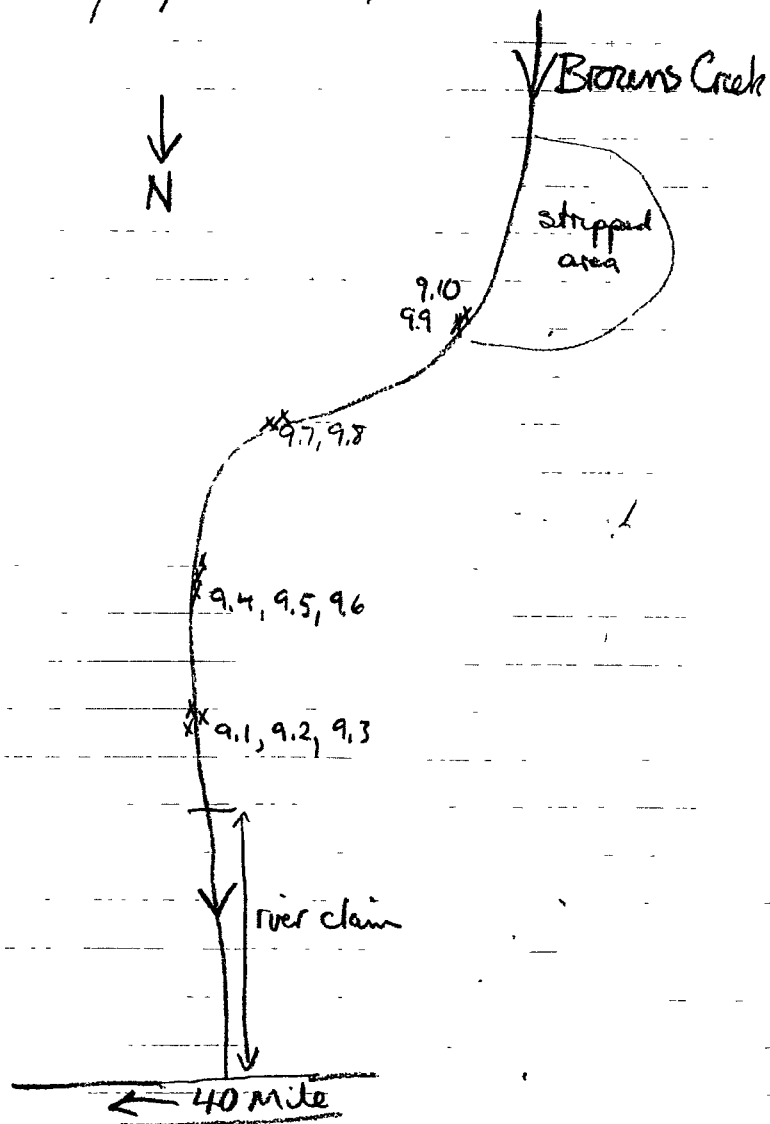

creek is lower again today so we took pans from creek gravel surface gravel is angular & poorly sorted. It is loose on the bars but more tightly packed near the banks. Pans are from approx 1-1/2 ft into gravel, rather than surface layer.

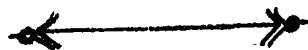

9.1 - 0

9.2 - 4 fine colours inc 1 flake, garnet

9.3 - 0

9.4 - 0

9.5 - 0

9.6 - 0

9.7 - 2 colours

9.8 - 0

9.9 - 0

9.10 - 1 fine

May 15/95 (10)

Today we walked up the 1st left hand draw (Draw #1 on my earlier map) as you go up from the mouth.

Draw is very narrow & ground is frozen

Bedrock outcrops in a few spots - the same schist as in the main creek

I wasn't able to take any pans up the draw as I couldn't find any gravel doesn't look too promising.

May 17/95 (11)
we hiked up to draw #2 today & walked up it always to have a look again frozen with little gravel in evidence took 2 pans back to

creek to pan but
got nothing
11.1 - 0
11.2 - 0

June 2/95 (12)

Motor problems on the boat today - had to drift back to camp, then start out again after Bill fixed the problem. Late start by the time we finally got to Brown's Ck!

We walked up to a 2nd old cat pit & took some pans. We dug a pit into the gravel exposed by the old cat work. Difficult to sample because the hole fills w/ ground water which is a good sign for dredging gravel.

results of today's samples were:
12.1 - 2 fine colours 12.6 - 0
12.2 - 0 12.7 - 1
12.3 - 0 12.8 - 0
12.4 - 1
12.5 - 1 fine (samples 4 thru 8 were from pit)

June 3/95 (13)

walked further up creek
past old workings

there is a old cat trail
but it is very poor & it
would be a lot of work to
get thru swampy areas.

went approx 1/2 mile
above old workings

this area not too
promising - mainly narrow &
frozen with no real open
flats suitable for working,
except area at the mouth
of R.L. draw 3 pans taken
in creek gravel near mouth
of draw didn't yield any gold

13.1 - 0

13.2 - 0

13.3 - 0

June 4/95 (14)

today we walked about a mile
further up the creek than
yesterday.

again creek quite narrow &
frozen looking ground

a 2nd R.L. pulp - largest tub
so far - provides a flat
which could be worked
pans from creek gravel near
mouth of R.L. pump

14.1 - 0

14.4 - 1

14.2 - 0

14.5 - 0

14.3 - 0

this is getting a fair way up
the creek to be practical for
access from the river - coming
in the other way, overland from
the headwaters might be better.

June 13/95 (15)

I brought the boat up to Browns Creek myself today & walked up the creek to DRAW #3 (my previous sketch map)

Draw #3 is steep & frozen. I tried to dig a few pits but was not able to find an area without permafrost.

I saw some large grizzly tracks in this area today - kind of scary!

there is some water in the draw so I was able to pan a few samples, but get no colour there is little gravel here.

15.1	-0	} all from the counts up DRAW #3
15.2	-0	
15.3	-0	

June 26/95 (16)

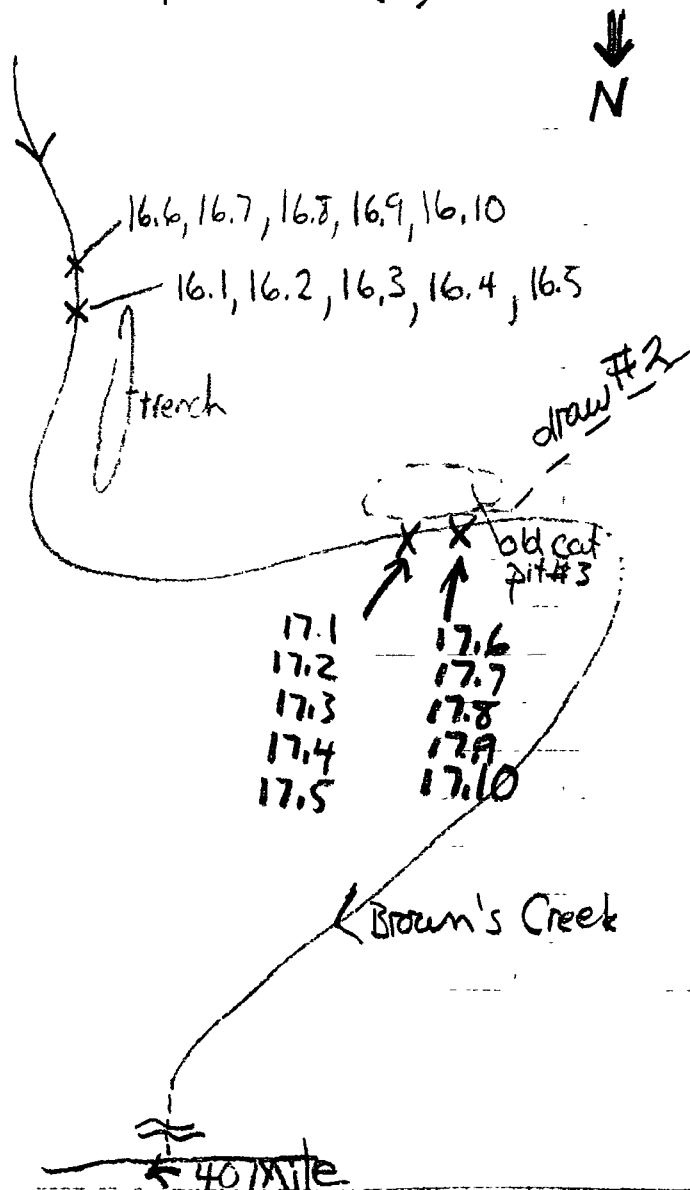

1 dug 2 pits in the creek
gravel on an exposed bar.
pits dug by hand to
approx 1' below water level -
a total depth of approx 3'
pits are 3' x 5'

5 samples taken & panned from
each pit

pit 16.1

16.1.1 - 0

16.1.2 - 0

16.1.3 - 1 fine

16.1.4 - 0

16.1.5 - 0

pit 16.2

16.2.6 - 0

16.2.7 - 2 fine

16.2.8 - 0

16.2.9 - 0

16.2.10 - 1

July 23/95 (17)

returned to area around
draw #2 + dug 2
3x5 pits into creek
gravel on bar - went
down to about 1 1/2'
below water level

- location of pits marked
on Day 16 map

17.1.1 0

(17.3) 17.2.2 0

17.3.3 0

17.4.4 0

17.5.5 0

(called 17.3
in results &
map)
unrepit)

17.6.6 - 1

(17.4) 17.7.7 - 0

17.8.8 - 0

17.9.9 1 fine color

17.20.0 0

(called
17.4

Aug. 31 / 95 (18)

Eric & I took the boat up to Browns Creek. We walked up the creek together and looked for good places for him to dig 6 test pits. Today he took 14 samples which he brought back to camp for me to process.

18.1. frozen

1200' up creek
left side
silt clay
3 ft

18.2. 2500' up - left
3 ft down
natural hole

18.3. 2600' up - right
silt

18.4. 3000' up right

gravel bar opposite bluff
1 ft. down.

18.5. 6, 7 & 8 3100-3200 ft up
left
samples off gravel bar.

18.9. 3300' up crk gravel

18.10. 3400' gravel bar sample

18.11. 4200' r. crk bank

18.12. crk bank 4300' L

18.13. 4500' R
gravel bar opposite bluff

18.14. 4500' R
50' from crk
2 ft down

cont next page

18.16x

18.9x

18.5, 18.6, 18.7, 18.7

x18.4

18.3

18.2x

18.1x

strapped area

Post

← 4 Mile

☐ CAT PIT #2

☐ CAT PIT #1

18.14

x18.13

18.12x

cont from
prev page

Sept. 1/95 (19)

Eric + I up to Brown's Creek
to continue from yesterday flagging
sites ~~from~~ for bench pits.
worked up as far as 1st draw
dug 3 pits today

19.1 3x5x4' deep 19.1.1 - 0
0.15 us 4' deep 19.1.2 - 0
(in 1st stripping) 19.1.3 - 0
19.2 3x5x 1/2' deep
frozen no gravel found

19.3 3x5x 4' deep
19.3.1 - 0
19.3.2 - 0
19.3.3 - 0
19.3.4 - 1 fine color
19.3.5 - 0

Very angular gravel
about 1' overburden

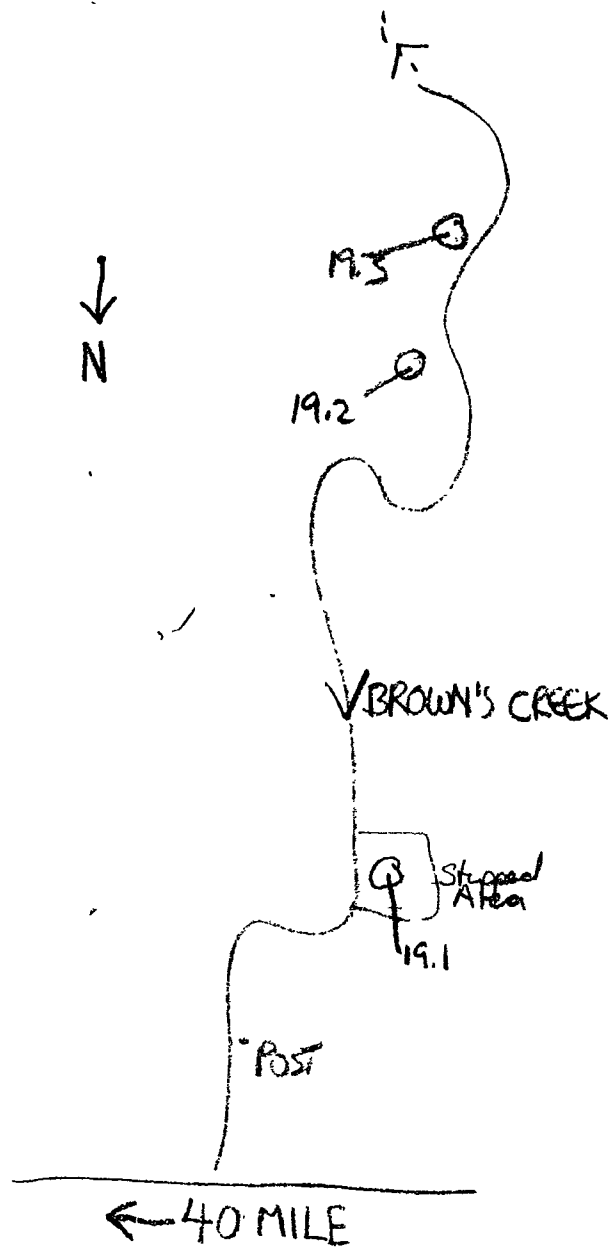

Sept 2/95 (20)

Eric + I worked on digging pits in areas chosen yesterday

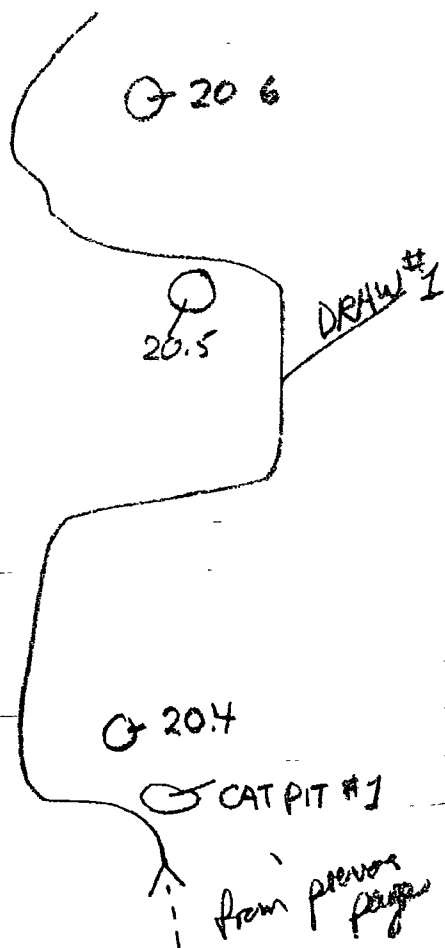

20.4 pit

20.4.1 - 2 fine colours off top
 20.4.2 - 0
 20.4.3 - 0
 20.4.4 - 1

20.5 pit

bedrock exposed in creek bank opposite pit #5

20.5.1 - 0

20.5.2 - 3 fine colours

20.5.3 - 0

20.5.4 - 4 - 2 fine + 2 larger

20.5.5 - 1 fine

20.5.6 - 6 lots of black sand

colours from clay layer near gravel

good size colours

20.6 pit pit in burn

gravel on surface - no overburden

large flat left limit

20.6.1 - 0

20.6.3 - 1 flake | 20.6.5 - 0

20.6.2 - 0

20.6.4 - 0 | 20.6.6 - 0

Sept 3/95 (21)

Eric + I went up further than the last pit we did yesterday we did one more pit on the Right bank just below draw #2

we found an old (very old) camp here with an octagon barrel rifle with the stock rotted off it looks very old.

samples from pit 21.7.

21.7.1 - 0 from surface sand gravel near surface then 2 1/2' sand then more gravel

21.7.2 - 3 colours - 3 ft down

21.7.3 - 1 flake - 4' down

21.7.4 - 0 - 4'

21.7.5 - 2 colours + 1 flake - 4 1/2'

21.7.6 + 21.7.7 - taken back to camp

Schist bedrock outcroppings on both sides of the creek

Sept 4/95 (22)

I went up to Brown's Creek by myself to gather samples from pits. Samples taken to camp for future processing.

22.4.1

22.4.2

22.4.3

} from pit 4

22.5.1

22.5.2

22.5.3

} pit 5

22.6.1

22.6.2

22.6.3

22.6.4

} pit 6

I got 2 more samples from pit 7

22.7.8 + 22.7.9 - 4 1/2' down

made 3 trips down to the knot packing these samples

Sept. 6 (23)
 processed 14 samples Eric
 took

18.1 - 0
 18.2 - 1 fine colour, little br sand
 18.3 - 0
 18.4 - 0
 18.5 - 0
 18.6 - 0
 18.7 - 1
 18.8 - 0
 18.9 - 1 fine colour
 18.10 - 0
 18.11 - 0
 18.12 - 0
 18.13 - 0
 18.14 - 3 colours, 1 is flake

Sept. 7 (24)
 processing samples Brown's Ck.
 (N & lb each)

21.7.6 - 4 colours inc 1 flake
 21.7.7 - 3 colours, little sand
 22.7.8 - 1 flake
 22.7.9 - 3 colours

22.4.1 - 0
 22.4.2 - 1 fine colour
 22.4.3 - 0

22.5.1 - 4 fine colours
 22.5.2 - 2, 1 is flake
 22.5.3 - 0, lots little sand

22.6.1 - 0
 22.6.2 - 0
 22.6.3 - 1 fine colour
 22.6.4 - 1 med colour



Sept. 14 (25)

walked up to area of
exposed bedrock above old
workings

25.1 = 1 large flake

25.2 = 0

25.3 = 2 large flakes

25.4 = 4 colours w/ 1 flake

4 took 3 samples to take to camp
also from same area
25.5, 25.6, 25.7

4 2 more samples from Pit #4

~~25.8~~

25.4.4

25.4.5

Sept 15 (26)

panned samples from pit #19.1

26.1.4 - 0

26.1.5 - 0

26.1.6 - 0

also took samples from #19.1 pit
to camp

26.1.7 -

26.1.8 -

26.1.9 -

26.1.10 -

Sept 16 (27)

went up to pit #19.3 -

panned a few samples & took
some back for processing

27.3.6 - 0

27.3.7 - 0

27.3.8 - 1 fine colour

27.3.9 - 0

27.3.10, 27.3.11, 27.3.12, 27.3.13, 27.3.14
to camp

Sept 20 (28)
 hard getting up to Brown's -
 water level in 40 mile is getting low
 made 3 trips up creek
 to pack samples back to boat
 from pit #4

28.4.5, 28.4.7, 28.4.8, 28.4.9

from pit #5
 28.5.4, 28.5.5, 28.5.6, 28.5.7

from pit #6
 28.6.5, 28.6.6, 28.6.7, 28.6.8
 28.6.9

Oct 7 (29)
 running samples thru wheel

25.5 - 2 v. lrg plates
 25.6 - 1 plate
 25.7 - 0

25.7.7 - 0, garnets
 25.7.5 - 0

28.4.6 - 1 fine colour
 28.4.7 - 2 fine colours
 28.4.8 - 0
 28.4.9 - 0

26.1.7 - 0
 26.1.8 - 0
 26.1.9 - 0
 26.1.10 - 0

27.3.10 - 1 fine colour
 27.3.11 - 0
 27.3.12 - 0
 27.3.13 - 2 fine
 27.3.14 - 0

Oct. 8 (30)

finish running samples

- 28.5.4 - 1 flake
 28.5.5 - 3 med. sized, lots of sand
 28.5.6 - 0
 28.5.7 - 2, 1 w/ flake
- 28.6.5 - 0
 28.6.6 - 0
 28.6.7 - 1 fine
 28.6.8 - 0
 28.6.9 - 0

Nov. 16 (31)

Bill + I took the snowmachine up the creek to check out the road that comes down the creek from the Top of the Whiskey. We had to cut quite a bit of deadfall off the road going up the hill. So far the road is O.K., although it does need cut work. The part of the road in the valley bottom is the worst - it goes through some pretty bad swampy areas.

NOV. 18 (32)

We went back up the road. This time we got quite a bit further - the going is better on the ridge. It looks like it would be pretty easy to drop into Haxdent Creek from this road, as long as the top part of the road isn't too bad.

NOV. 19 (33)

We got the rest of the way along the Brown's Cr road today. There is some sidehill which would need improvement - nothing too bad though.

It is quite a long way to walk equipment in to get in the mouth of the creek. It would be feasible though & might be simpler than depending on fording the river for heavy equipment access.

Mineral Rights / Droits miniers

Canada

DAWSON 23 JULY 86

116C-7
 PLACER

95-080

LATITUDE 64° 15' TO 64° 30'
 LONGITUDE 140° 30' TO 141° 00'

ISSUED UNDER THE AUTHORITY OF THE MINISTER
 OF INDIAN AFFAIRS AND NORTHERN DEVELOPMENT

SCALE 1:30,000

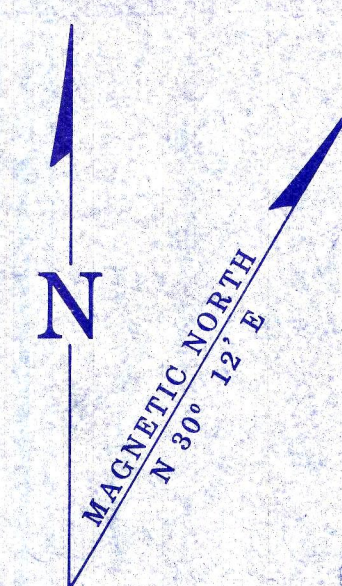

NOTE:

THIS MAP IS ISSUED AS A PRELIMINARY GUIDE FOR WHICH THE DEPARTMENT OF INDIAN AFFAIRS AND NORTHERN DEVELOPMENT WILL ACCEPT NO RESPONSIBILITY FOR ANY ERRORS, INACCURACIES OR OMISSIONS WHATSOEVER.

TOPOGRAPHY COMPILED FROM 1:50,000 NATIONAL TOPOGRAPHIC SERIES. CONTOUR INTERVAL 500 FEET. SURVEY INFORMATION COMPILED FROM LEGAL SURVEYS, BY DRAFTING SERVICES.

Note: Entry on certain lands is withdrawn from staking in cross-hatched areas to facilitate the settlement of Native Land Claims without prejudice to Existing Surface and Subsurface Rights.

ALASKA	116C-10	116C-9
	116C-7	116C-8
	116C-2	116C-1

FOR QUARTZ SEE 116C-2



CLAIMS WITHOUT GRANT NO.	
NAMES	GRANT NO.
MCP 2	P11138
MCP 34	P11174
MCP 35	P11175
MCP 38	P11178
MCP 39	P11179
MCP 42	P11182
MCP 43	P11183
MCP 44	P11184
MCP 81	P11221
MCP 82	P11222
MCP 83	P11223
MCP 224	P14384
MCP 230	P14390
MCP 249	P14409
MCP 250	P14410
MCP 268	P14428

CLAIMS NOT ON MAP	
NAMES	GRANT NO.
MCP 29	P11165
MCP 30	P11170
MCP 31	P11171
MCP 32	P11172
MCP 33	P11173

BROWN'S CREEK PROJECT (these claims have lapsed)