

2023 Field Season

Geochemical Sampling and Prospecting Report
On The
Pup Property
July 20th to September 4th, 2023

Claims

Pup 1-64
YF76601 to YF76664

Located In
Dawson Mining District

On
NTS 116-B-04
At
64° 03' north and 139° 40' west

By
Bernie Kreft
January 31st, 2024

Table Of Contents

Location	Page 1
Claims Status Table	Page 1
Access	Page 1
Topography And Vegetation	Page 1
History And Previous Work	Page 1
Yukon Map (figure 1)	Page 2
Claim Map (figure 2)	Page 3
Regional Geology and Mineralogy	Page 4
Geology Map (figure 3)	Page 5
Geology Map Legend (figure 3A)	Page 6
Property Geology	Page 7
Geophysics	Page 7
Current Work and Results	Page 7
Regional Total Mag Map (figure 4)	Page 8
Property First Vertical Map (figure 5)	Page 9
Conclusions	Page 11
Recommendations	Page 11
Sample Label, Copper and Zinc Value Maps (figures 6-11)	Pages 12 to 17
Rock Sample Table	Page 18
Soil Sample Table	Page 20
Statement Of Qualifications	Page 22
Statement Of Costs	Page 23
Assay Sheets	At Back

Location – The Pup Project is located in the Dawson Mining District west of the Yukon River and south of the Top of The World Highway, on NTS map sheet 116-B-04, at 64° 03’ N and 139° 40’ W. The centre of the project is located approximately 10.5 kilometres west of Dawson City or a 17.5 km drive west from the ferry crossing across the Yukon River.

Claim Status Table

Name	Number	Grant Number	Owner	Expiry Date	District	NTS Map
Pup	1 to 16	YF76601 to 616	Bernard Kreft - 100%	2024-10-31	Dawson	116B04
Pup	17 to 44	YF76617 to 644	Bernard Kreft - 100%	2024-11-06	Dawson	116B04
Pup	45 to 58	YF76645 to 658	Bernard Kreft - 100%	2024-10-31	Dawson	116B04
Pup	59 to 64	YF76659 to 664	Bernard Kreft - 100%	2024-11-06	Dawson	116B04

Access – Access to the various target areas on the Project is via the Top of The World Highway and a series of rough 4 wheel drive gravel roads extending from the Highway to placer mining operations located along Swede Creek which flows along the south edge of the property. Total drive time from the ferry landing on the west side of the Yukon River to the centre of the project is approximately 15 minutes.

Topography And Vegetation – The project is located within the un-glaciated Klondike Plateau, which is characterized by low rolling hills dissected by deeply incised stream valleys. This region experienced strong surficial weathering during the early and mid-Tertiary, as a result, bedrock exposures are limited with the effects of surface weathering extending to depths of as much as 30 metres or more. Overburden and regolithic material averages about 1-2 metres in most areas, thereby allowing for effective soil sampling (via hand held augers) and hand trenching. Permafrost is widespread on north facing slopes, and in shaded low-lying areas. Although snow cover is mostly gone by early May, frost does not leave the ground sufficiently to allow for exploration methods such as soil sampling and trenching until about late May on south facing slopes to late July for north facing slopes. The project is below tree line, higher elevations are covered by mixed spruce, birch, poplar and brush, with tree cover generally increasing at lower elevations and on south facing slopes, with brush and stunted trees predominating on north facing slopes, at higher elevations and in areas of permafrost.

History and Previous Work – During the period 1978-80, Cominco Ltd explored their Pup property with silt sampling, broad spaced contour soil sampling, prospecting, age-dating and whole-rock geochemistry. A total of four Cu +/- Pb-Zn-Ag soil geochemical anomalies were located, with prospecting at one of the soil geochemical anomalies resulting in the discovery of a 2cm thick stratabound layer of massive pyrite-chalcopyrite (the Cominco Showing) hosted by felsic meta-tuff. Whole rock geochemistry confirmed the presence of calc-alkaline felsic volcanics favourable for VMS mineralization, while age-dating yielded a Mississippian age for mineralization which is similar to the age of VMS deposits in the Finlayson district. Further work to define a source for the geochemical anomalies was recommended but not completed.

During 2013-18 Morgan Fraughton explored the Pup property with rock and soil sampling programs. Soil sampling defined numerous areas with strongly anomalous copper and lesser zinc values, confirming both the presence of the historic Cominco anomalies as well as locating several new anomalies. The main target generated by this work consists of a 400m x 1,000m Cu +/- Zn anomaly with numerous samples ranging from 388 ppm Cu to 2,962.9 ppm Cu. Rock sampling returned strongly anomalous values for Cu to 3,028 ppm and Zn to 2,017 ppm from samples described as felsic mica schist and rusty (limonitic) orange schist respectively. The presence of copper oxides and limonite suggests that the surface samples have

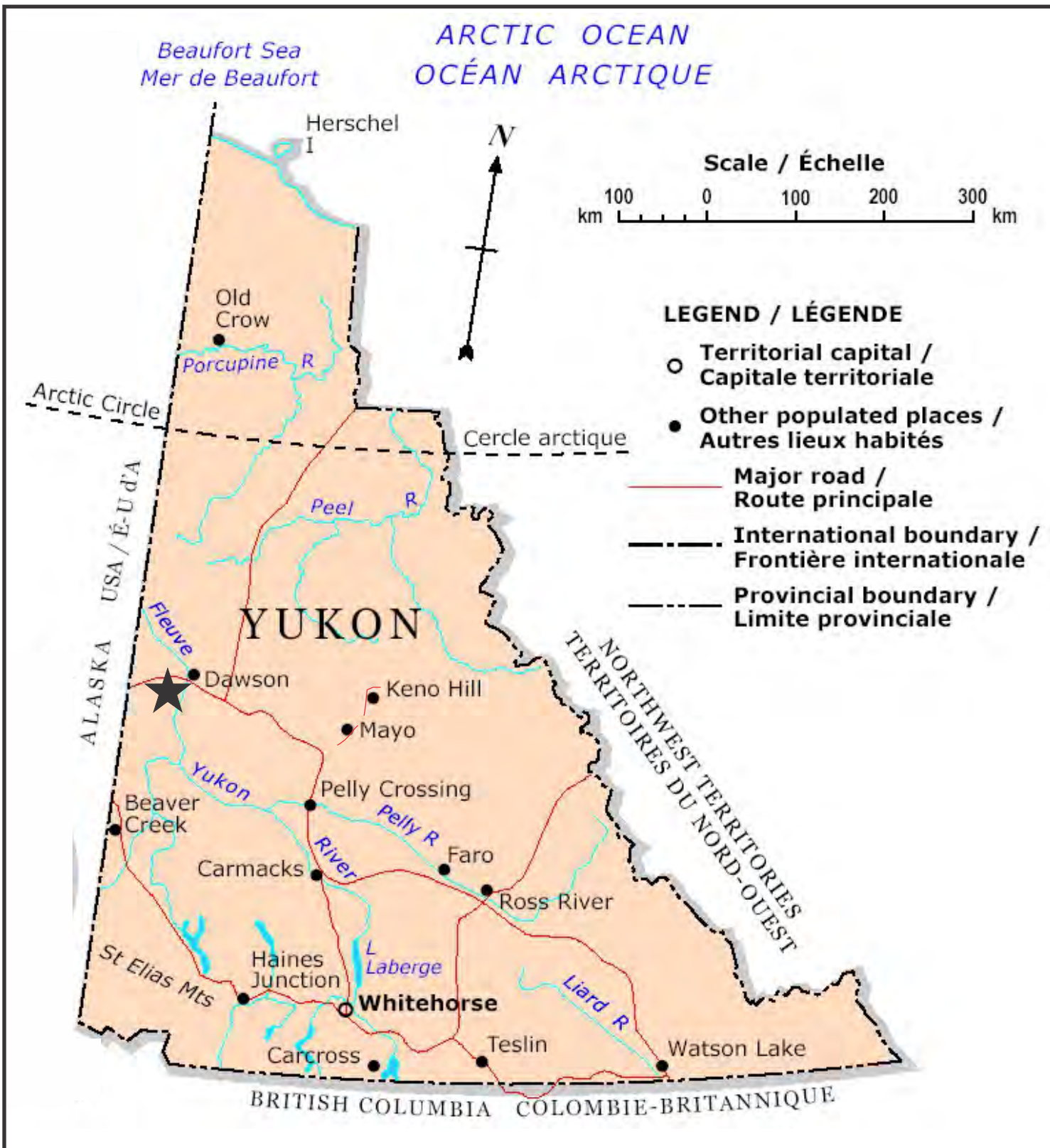

Pup Project ★

To Accompany: 2024 Pup Report

February 2nd, 2024

By: Jarret Kreft

Figure 1

562500 564000 565500 567000

7107000
7105500
7104000
7102500
7101000



116-B-04
Scale: 1:30,000

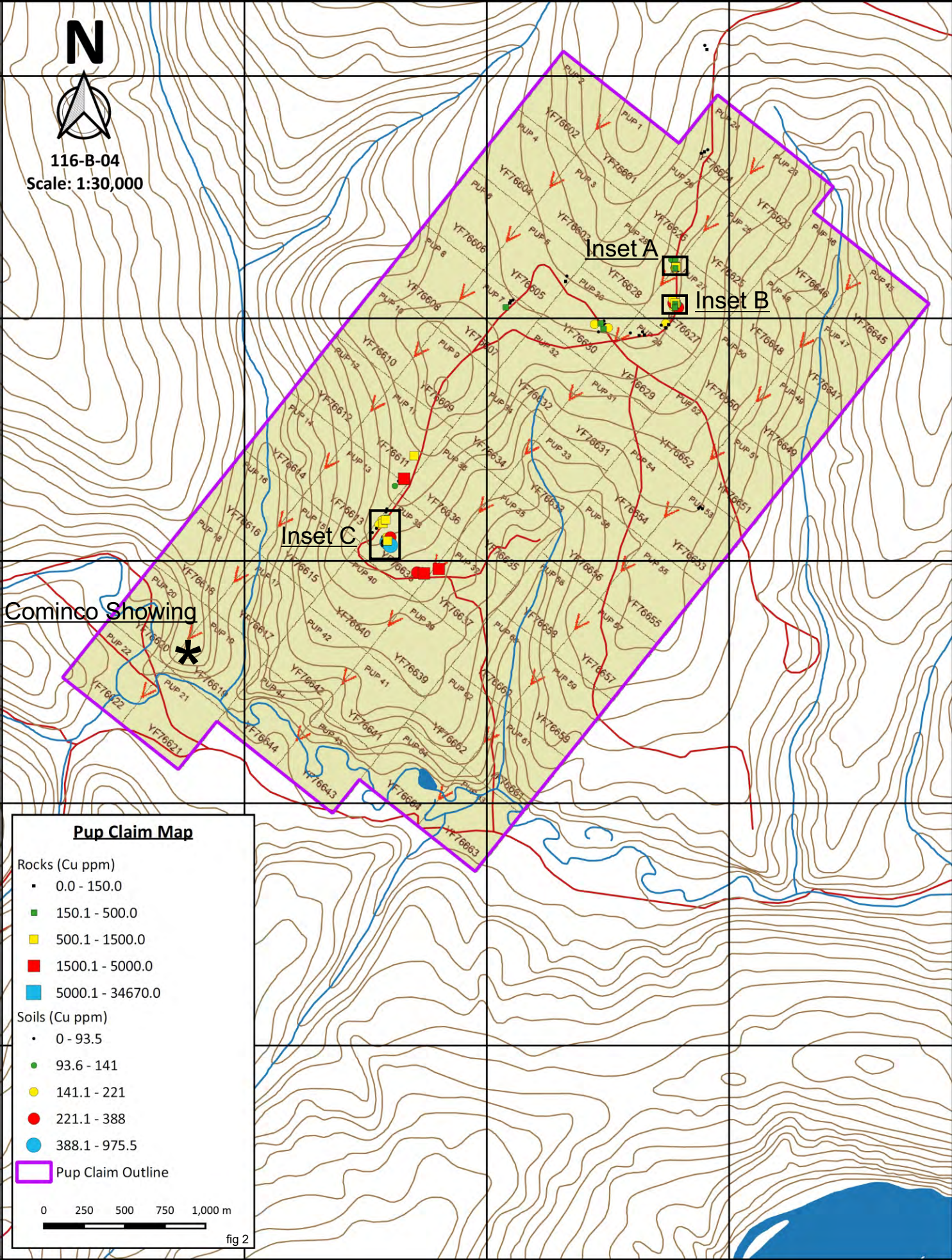

Pup Claim Map

- Rocks (Cu ppm)
 - 0.0 - 150.0
 - 150.1 - 500.0
 - 500.1 - 1500.0
 - 1500.1 - 5000.0
 - 5000.1 - 34670.0
- Soils (Cu ppm)
 - 0 - 93.5
 - 93.6 - 141
 - 141.1 - 221
 - 221.1 - 388
 - 388.1 - 975.5
- Pup Claim Outline

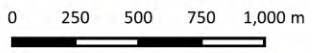

fig 2

been leached and that fresh rock samples may yield improved grades. Stratigraphy is reportedly northwest trending in this area, with lineation's in airborne magnetic data for the area supporting this observation.

Regional Geology and Mineralogy – Due to a lack of exposure, geology of the Klondike Plateau south and west of Dawson remains an enigma or, at a minimum, poorly understood. Broad areas mapped as a single unit are almost certainly significantly more geologically complex. Small intrusive bodies are likely significantly more numerous than current mapping suggests. In the Finlayson district the Grass Lakes and Snowcap assemblages provide the sub-volcanic granitoid root to, or the basement of, favourable VMS stratigraphy. In the Klondike Plateau the same assemblages are mapped as large continuous sheets/bodies with little to no indication of rafts or islands of the favourable volcanic stratigraphy that undoubtedly exist. This enigmatic or poorly understood geology has likely hindered historical exploration efforts resulting in a district where discovery potential remains high.

The Pup property is underlain by rocks of the Yukon Tanana Terrane and therefore should be considered highly favorable for VMS style mineralization. A cluster of VMS deposits and mines in the Finlayson District, 450 km to the southeast are hosted by the same Yukon Tanana Terrane stratigraphy, specifically Devonian to Mississippian volcanics. VMS deposits in the Finlayson district include Kuroko style Cu-Zn-Pb-Ag-Au deposits, Besshi style Cu-Zn-Co-Au types and Cyprus type Cu +/- Zn-Co-Au which occur over a broad time interval. Certain parts of the Dawson area and the Finlayson District are believed to have been linked as part of a concurrent back-arc/basinal environment prior to displacement along the Tintina Fault. The recent discovery by Arcus Developments of VMS style mineralization within Devonian to Mississippian felsic to mafic volcanics at the Touleary Property confirms potential for this deposit type south and west of Dawson City. Limited diamond drilling at Touleary has returned up to 2.25 metres of 7.18% Cu, 4.3% Zn, 116 g/t Ag and 3.55 g/t Au.

Besides Touleary, other significant base metal targets south and west of Dawson City include: Lucky Joe, Kam, Rackla and Connaught, descriptions of which are as follows.

Lucky Joe is a bulk-tonnage copper-gold target within and adjacent to presumed Simpson Range Devonian-Mississippian biotite bearing and altered granodioritic orthogneiss. The Lucky Joe mineralized zone occurs over an 800 m strike length, 200 m width and 30 m thickness. Copper grades range from 0.35 to 0.6% over 20 to 30 m intervals with the best drill interval reported being 0.95% copper over 5.2 m. Gold was shown to have a near 1:1 correlation with copper. Recent work has identified several multi-kilometric scale Cu-Au soil anomalies and a high temperature geological model has been suggested for the mineralization with the system being either a metamorphosed Cu-Au porphyry target or an IOCG type target.

Exploration in the Sixtymile River area on the Kam property encountered metamorphosed Cu-Au-Ag-Mo mineralization within Devonian to Mississippian mafic orthogneiss. This 2012 discovery yielded grab sample results of up to 0.48% copper and 1.406 g/t Au.

During 2011 Rackla Metals encountered a blind late Cretaceous (Casino or Prospector Mt Suite intrusive) Cu-Mo porphyry target while exploring for epithermal style mineralization in the Sixtymile River area. Drill results of up to 542 ppm Cu and 41 ppm Mo over 271.27m were returned from a potassic and sericitically altered feldspar porphyry body.

Work by Atac Resources in the Connaught area south of the Sixtymile placer camp has outlined a compelling early-stage copper-molybdenum ± gold porphyry target in an area of Late Cretaceous Prospector Mountain Suite intrusive rocks.

520000

540000

560000

580000

600000

7100000

7080000

7060000

7040000

7020000

7000000



Scale:1:500,000

Kam



Pup

Racklā

Connaught

Lucky Joe

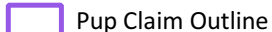
Pup Regional Geology Map

-  Roads
-  Pup Claim Outline
-  Targets From Text
-  Kreft Owned Target

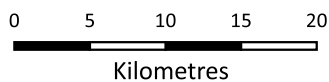

fig 3

Touleary



K L O N D I K E

Y U K O N

D A W S O N R A N G E

Geology Legend

TERTIARY(?) AND QUATERNARY

TQS: SELKIRK: columnar jointed, vesicular to massive basalt flows

PALEOCENE TO LOWER EOCENE

PRC2: RHYOLITE CREEK: maroon to reddish purple, fine to very coarse grained andesite

PRC1: RHYOLITE CREEK: light grey, green, maroon, purple and black rhyolite and dacite

LOWER TERTIARY, MOSTLY(?) EOCENE

ITR3: ROSS: brown, thin-bedded, claystone, siltstone, shale and coal

ITR2: ROSS: rhyolite flows, tuff, ash-flow tuff and breccia

ITR1: ROSS: dark grey-green olivine basalt necks and flows

LATE CRETACEOUS TO TERTIARY

LKqP: PROSPECTOR MOUNTAIN SUITE: Hbl-Bt granodiorite, Hbl diorite, quartz diorite

LKfP: PROSPECTOR MOUNTAIN SUITE: quartz-feldspar porphyry

MID-CRETACEOUS

mKqW: WHITEHORSE SUITE: Bt-Hbl granodiorite, Hbl quartz diorite and Hbl diorite

mKqW: WHITEHORSE SUITE: Bt quartz monzonite, Bt granite and leucogranite

mKyT: TOMBSTONE SUITE: Bt-Hbl-Cpx syenite, quartz syenite

UPPER CRETACEOUS

uKc4: CARMACKS: sandstone, pebble conglomerate, shale, tuff, and coal

uKc2: CARMACKS: andesite, porphyry

uKc1: CARMACKS: augite-olivine basalt and breccia

uKc3: CARMACKS: acid vitric crystal tuff, lapilli tuff and welded tuff

LOWER CRETACEOUS

KM5: MONSTER: arkosic sandstone, silty mudstone, chert-quartz sandstone-pebble conglomerate

IKIR: INDIAN RIVER: clast-supported pebble to cobble conglomerate

EARLY JURASSIC

EJgL: LONG LAKE SUITE: massive to weakly foliated Bt-Hbl granodiorite

EJyL: LONG LAKE SUITE: coarse to very coarse grained and porphyritic, mesocratic Hbl syenite

JURASSIC

JB1: LOWER SCHIST: dark grey argillite, slate, and phyllite, commonly graphitic

LATE TRIASSIC TO EARLY JURASSIC

LTrEJgM: MINTO SUITE: Bt-Hbl granodiorite, locally foliated, local Bt-rich screens and gneissic schlieren

LTrEJqM: MINTO SUITE: porphyritic Bt and Bt-Hbl quartz monzonite to granite

LTrEJgBm: MINTO SUITE: Hbl gabbro

MIDDLE TO UPPER TRIASSIC

TrJ2: JONES LAKE: bioclastic limestone and interbedded sandy or silty limestone

TrJ1: JONES LAKE: calcareous siltstone, shale, and fine sandstone

TRIASSIC

TrG: GALENA SUITE: Hbl diorite and gabbro sills

LATE TRIASSIC

LTrGp: PYROXENE MTN SUITE: coarse-grained, foliated Hbl gabbro, pyroxenite

MIDDLE TO LATE PERMIAN

PqS: SULPHUR CREEK SUITE: granodiorite and quartz monzonite

PqS: SULPHUR CREEK SUITE: variably foliated, K-feldspar augen granite, metaporphry

PK3: KLONDIKE SCHIST: chlorite schist and phyllite, amphibolite

PK2: KLONDIKE SCHIST: silvery grey muscovite-chlorite quartz phyllite, micaceous quartzite

PK1: KLONDIKE SCHIST: quartz-muscovite-chlorite schist

MIDDLE PERMIAN

PDC2: DAWSON-CLINTON CREEK: brown weathering, variably serpentinized ultramafic rocks

PDC1: DAWSON-CLINTON CREEK: greenstone, phyllite, chert

LOWER AND MIDDLE PERMIAN

PJC3: TAHKANDIT: crystalline skeletal limestone, black chert, calcareous sandstone, conglomerate

PJC2: SADLEROCHIT: shale, siltstone and limestone

PJC1: JUNGLE CREEK: chert pebble conglomerate, sandstone and shale

UPPER CARBONIFEROUS

CE: ETTRAIN: fossiliferous limestone and glauconitic sandy carbonate

UPPER DEVONIAN TO PERMIAN

uDPF3: FORD LAKE: shale, siltstone, limestone, sandstone, conglomerate, chert undivided

uDPF2: FORD LAKE: shale, siltstone, limestone, sandstone, conglomerate, chert undivided

CARBONIFEROUS TO PERMIAN

CPSM2: CAMPBELL RANGE: dark green to black basalt, greenstone, locally pillowed

CPMC: MOUNT CHRISTIE: burrowed, interbedded greenish grey cherty shale and green shale

CARBONIFEROUS

CT4: TSICHU: siliceous calcarenite, dolostone, sandy dolostone and minor grey quartzite

CT2: TSICHU/KENO HILL: black to silvery shale or carbonaceous phyllite

CT1: TSICHU/KENO HILL: massive to thick-bedded quartz arenite

MISSISSIPPIAN

MqSR: SIMPSON RANGE SUITE: foliated metagranite, quartz monzonite and granodiorite, augen granite

MgSR: SIMPSON RANGE SUITE: Hbl-bearing metagranodiorite, metadiorite and metatonalite

DEVONIAN, MISSISSIPPIAN AND(?) OLDER

DMF6: FINLAYSON: ultramafic rocks, serpentinite; metagabbro

DMF5: FINLAYSON: light grey to white marble, locally crinoidal

DMF4: FINLAYSON: light green to grey, fine-grained siliciclastic and metavolcaniclastic rocks

DMF3: FINLAYSON: dark grey to black carbonaceous metasedimentary rocks, metachert

DMF1: FINLAYSON: intermediate to mafic volcanic and volcanoclastic rocks

LATE DEVONIAN TO MISSISSIPPIAN

DMgG: GRASS LAKES SUITE: fine to medium-grained, foliated granodiorite, granite, quartz monzonite

ORDOVICIAN TO LOWER DEVONIAN

ODS2: SCOTTIE CREEK: layered paragneiss, migmatite

ODS1: SCOTTIE CREEK: quartzite, micaceous quartzite, psammitic Qtz-Ms-Bt ± Grt schist

ODR: ROAD RIVER - SELWYN: black shale and chert, dolomitic siltstone, calcareous shale, buff platy limestone

ODR5: ROAD RIVER: barite

ODR1: DUO LAKE/ELMER CREEK - SELWYN: black graptolitic shale and black chert

UPPER CAMBRIAN TO LOWER DEVONIAN

CDB2: JONES RIDGE: biogenic, oolitic, siliceous, massive limestone

CDB1: BOUVETTE: grey and buff-weathering dolostone and limestone

CAMBRIAN TO DEVONIAN

CDR: ROAD RIVER - RICHARDSON: black graptolitic shale, limestone and minor chert (undivided)

CAMBRIAN TO SILURIAN

CSM9: MENZIE CREEK/DEMPSTER: gabbro, pyroxenite

CSM5: DEMPSSTER: white weathering limestone, locally bioclastic

CSM4: DEMPSSTER: flow banded rhyolite and felsite, breccia and felsic tuff

CSM3: DEMPSSTER: mafic volcanic flows, tuff and hyaloclastic breccia

CSM1: MENZIE CREEK: massive, locally pillowed, dark grey-green basalt, tuff and breccia

UPPER CAMBRIAN AND ORDOVICIAN

COR1: RABBITKETTLE: thin-bedded, silty limestone and grey lustrous calcareous phyllite

LOWER AND MIDDLE CAMBRIAN

ImCS2: ADAMS: grey, green and red argillite with laminated quartzite and siltstone

ImCS1: SLATS CREEK: turbiditic, quartz sandstone with minor shale and siltstone

LOWER CAMBRIAN

ICG1: GULL LAKE: shale, siltstone and mudstone, minor quartz sandstone

ICi3: FUNNEL CREEK: massive, light grey limestone, locally dolomitic

ICi2: HILLARD: fine-grained, yellow brown limestone, limy conglomerate-breccia

NEOPROTEROZOIC AND PALEOZOIC

PDS2: SNOWCAP: light grey to buff weathering marble

PDS1: SNOWCAP: quartzite, psammite, pelite and marble; minor greenstone and amphibolite

PDS3: SNOWCAP: amphibolite, commonly garnet-bearing; greenstone

SYMBOLS

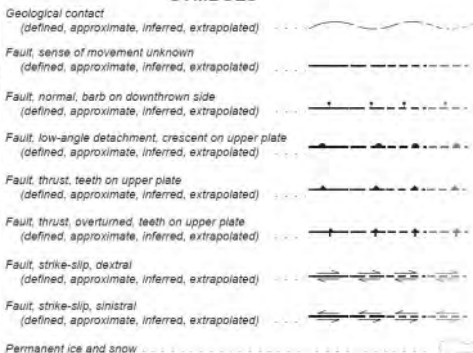

NEOPROTEROZOIC TO LOWER CAMBRIAN

PCB1: BACKBONE: thick-bedded, medium to coarse-grained orthoquartzite

PCH: HYLAND: undivided coarse turbiditic clastics, limestone, maroon and green shale

PCH7: NARCHILLA: interbedded maroon and apple-green slate, siltstone, sandstone

PCH6: ALGAE: grey weathering, very fine crystalline limestone, locally sandy

PCH5: YUSEZYU: brown to pale green shale, quartz-rich sandstone, grit, pebble conglomerate

NEOPROTEROZOIC

uPG: GAMETRAIL: yellow/orange weathering dolostone, dolomitic siltstone and limestone

uPS: SHEEPBED: recessive, black weathering shale and siltstone

uPHC: HAY CREEK: undivided post-rift siliciclastic rocks, dolostone and glacial diamictite

uPR3: EAGLE CREEK: polymictic, matrix-supported conglomerate

uPH6: MT HARPER: rhyolite flows, breccia and ignimbrite

uPH5: MT HARPER: diabase dikes and sills

uPH4: MT HARPER/CALLISON LAKE: stromatolitic dolostone, laminated sandstone, siltstone, and shale

uPH3: MT HARPER/SEELA PASS: heterolithic sandstone and conglomerate

uPH2: MT HARPER: massive and pillowed andesitic flows, tuff-breccia, lapilli tuff

MESO TO NEOPROTEROZOIC

uPFu2: FIFTEENMILE/CRAGGY: thick-bedded and massively recrystallized, silicified sucrosic dolostone

uPFu1: FIFTEENMILE/REEFAL: black to brown-coloured shale, siltstone, minor sandstone and conglomerate

MINERAL OCCURRENCE

- Deposit
- Historic Deposit
- Significant exploration project

GEOCHRONOLOGY METHOD

- U/Pb, Zircon
- U/Pb, Other
- Ar/Ar
- K/Ar

Property Geology – The Pup property has potential for VMS and porphyry copper style mineralization within Devonian-Mississippian volcanics and granitoids respectively. There is also potential for porphyry copper style mineralization associated with late Cretaceous granitic plugs intruding the Devonian to Mississippian package.

Fieldwork completed during 2023 noted presumed Devonian-Mississippian rocks consisting primarily of various types of felsic volcanics with lesser gneissic units and sedimentary rocks. Although no late Cretaceous intrusive bodies were noted, widespread vegetation and overburden cover would obscure small bodies and mask their alteration effects, particularly given the strong surficial weathering and if the intrusive body is blind.

Many of the rock samples consist of small, broken and heavily weathered fragments, making field identifications somewhat tenuous. Anomalous copper values are found within numerous lithologies including: quartz limonite veins, bedded limonite-goethite rock that may be representing skarn or replacement style mineralization within a bedded volcanic such as a tuff or a sedimentary rock, weathered and limonitic quartz sericite chlorite schist or gneiss and crenulated quartz sericite schist which may be representing a regionally metamorphosed granite and rhyolite respectively. Fracturing and brecciation is common within all rock types.

Geochemically speaking the project is predominantly a copper property with occasionally anomalous Zn-Pb-Ag-Mo-Au. Anomalous copper is typically found alone, occasionally with weakly anomalous amounts of zinc and rarely with other elements. Sampling of limonitic quartz-sericite-biotite schist in one area returned anomalous Cu-Mo-Au-Ag which is a metal signature commonly associated with porphyry copper targets. Although geochemically anomalous zones remain to be fully defined, work to date shows a general northwest trend to anomalies which would be consistent with stratigraphically controlled targets such as a Lucky Joe or Kam type copper porphyry or a VMS.

Geological and geochemical results suggest potential for a copper porphyry target, either associated with Devonian to Mississippian intrusive activity or a late Cretaceous intrusive intruding the Devonian to Mississippian volcanics. Although the broad range of rock types with anomalous copper values such as exists at Pup is often diagnostic of a porphyry style system, Besshi or Cyprus type VMS targets can also contain a wide variety of mineralization so the potential for a VMS system cannot be discounted at this stage.

Geophysics – The northwest trending lineation's obvious in airborne magnetic data for the area likely represent stratigraphy which is reportedly northwest trending. Late Cretaceous magmatism in this region is typically associated with an obvious airborne magnetic feature, either a positive feature in the case of an exposed intrusive or a low which would suggest the presence of magnetite destructive phyllic alteration often found bounding these intrusives, the absence of an obvious magnetic feature at Pup suggests that should a porphyry style system be present that it is more likely to be Devonian to Mississippian in age than late Cretaceous. The linear magnetic anomalies present at Pup are somewhat similar to the linear anomalies at Lucky Joe, while the strongly magnetic Devonian to Mississippian stratigraphy within which the Pup property is located, and which manifests as a broad magnetic high, would obscure moderately magnetic stratigraphy associated with a Kam or Lucky Joe type Cu-Au porphyry target.

Current Work and Results – Work was conducted during the period July 20th to Sept 4th 2023 yielding a total of 40 rock samples and 57 soil samples. Soil samples were taken from the C horizon and were designed to provide reconnaissance style coverage in overburden covered areas of interest. Prospecting

520000

540000

560000

580000

600000

7100000

7080000

7060000

7040000

7020000

7000000



Scale:1:500,000

Kam



Rackla

Connaught

Lucky Joe

Touleary

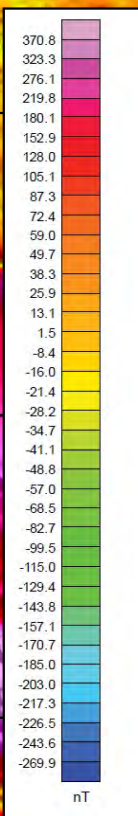

Pup Regional Total Mag Map

- Roads
- Pup Claim Outline
- Targets From Text
- Kreft Owned Target

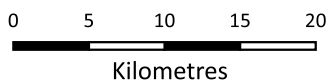

fig 4

564000

565500

567000

N



116-B-04
Scale: 1:30,000

7107000

7105500

7104000

7102500

7101000

Inset A



Inset B



Inset C



Cominco Showing *



Pup 1VD Map

Pup Claim Outline

Rocks (Cu ppm)

- 0.0 - 150.0
- 150.1 - 500.0
- 500.1 - 1500.0
- 1500.1 - 5000.0
- 5000.1 - 34670.0

Soils (Cu ppm)

- 0 - 93.5
- 93.6 - 141
- 141.1 - 221
- 221.1 - 388
- 388.1 - 975.5

0 250 500 750 1,000 m

fig 5

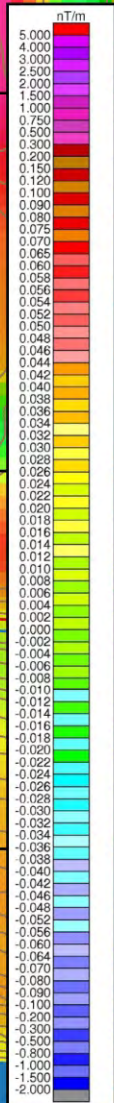

rock samples were sourced from bedrock exposed in road cuts as well as small hand dug prospecting pits. Soil sample sites were marked in the field by tying flagging inscribed with the sample code to a tree or brush near to the sample site, while rock samples sites were marked in the field by wrapping flagging inscribed with the sample code to rocks representative of the material sampled that remain at the sample site. Soil sample material was placed in industry standard paper packets while rock samples were placed in industry standard poly sample bags. All samples were analyzed by Bureau Veritas, with soils prepared using SS80 (sieve 100g of soil to -80 mesh), and rocks prepared using PRP70-250 (crush 70% to 10 mesh and pulverize a 250g split). All samples were analyzed using AQ201, a 15g analytical package that uses a 1:1:1 Aqua Regia digestion and ICP-MS analysis to provide analytical values for gold plus 36 elements.

Work was conducted in two phases, a preliminary trip to the project to define access and to provide confirmation style soil and rock sampling of several of the historical anomalies or showings, and once analytical results from this trip were received, a follow up program of more detailed sampling of anomalous sample sites from the preliminary trip and other areas of potential that had yet to be assessed.

Weakly to moderately anomalous copper values were encountered in numerous different lithologies and numerous different areas of the property. Potentially significant targets are starting to take shape at Inset's B and C, while interesting results were returned from Inset A.

Work at Inset B located a potentially northwest trending moderate to strong copper and lesser zinc soil geochemical anomaly. Bedrock consists of variably limonitic and rare weakly malachite stained quartz-sericite-chlorite-biotite, schist to gneiss. Sampling of bedrock in this area yielded seven samples, all of which returned weakly to moderately anomalous copper. Two samples also returned interesting amounts of Au-Ag-Mo, including sample BKPU-04, consisting of limonitic quartz-sericite-chlorite schist, analyses of which returned 219 ppb Au, 3.3 ppm Ag, 639 ppm Cu and 120 ppm Mo. Anomalous rock and soil samples occur within an approximate 40m x 60m area open in all direction.

Work at Inset C was designed to provide confirmation soil sampling of, and prospecting to define a source for, a previously defined 400m x 1,000m northwest trending copper soil anomaly with values of up to 2,963 ppm Cu. Soil sampling in this area returned up to 976 ppm Cu, confirming the presence of the historically reported copper in soil anomaly, while prospecting along road cuts that bisect the northwest end, and parallel the southern edge, of the historical anomaly located several styles of copper bearing bedrock detailed on the following table:

Lithology	Description	Top Cu Value	Other
quartz vein	fractured and limonitic with rare malachite	2,555 ppm	veins not abundant
quartz breccia	sericite and limonite groundmass	1,895 ppm	ragged quartz fragments
replacement?	bedded limonite and goethite	2,064 ppm	82 ppm Co
rhyolite	limonitic and weak goethite lined fractures	657 ppm	strongly limonitic
schist	limonitic chlorite-sericite-quartz	842 ppm	408 ppm Pb, 782 ppm Zn
schist	sheared or gougey quartz-sericite-chlorite	305 ppm/1.6m	presumed NW trend

Prospecting and rock sampling located copper mineralization within quartz veins, breccia zones, possible skarn or replacement type zones, shear zones and as disseminated and/or fracture controlled mineralization within limonitic rhyolite and limonitic chlorite-sericite-quartz schist. The variable styles of mineralization in conjunction with a sizeable and fairly intense copper soil anomaly suggest excellent potential to rapidly develop a drill target in this area.

Prospecting and sampling at Inset A encountered strongly anomalous Cu to 1,222 ppm and Zn to 747 ppm within several rock types including limonitic quartz-muscovite schist and strongly limonitic quartz-sericite schist. Soil augers were used to take deep samples of the weathered bedrock located within the ditch proximal to the anomalous rock samples, with these “soil” samples returning 193 and 197 ppm Cu. Unfortunately, soil sampling outbound of the anomalous rock and soil sample sites located in the road ditch failed to return anomalous copper values. Although the reason for the lack of a soil anomaly surrounding the anomalous sample sites remains to be explained, possible explanations include deeper than normal overburden muting soil response or the anomalous zone within the road ditch is too small to provide much in the way of a soil anomaly.

Conclusions – The Pup Property is host to several copper dominant base metal showings and anomalies likely representing a metamorphosed Devonian to Mississippian copper porphyry type target such as exists at Kam or Lucky Joe. There is also potential for a Besshi or Cyprus type copper dominant VMS system but it is subsidiary to the Devono-Mississippian porphyry copper potential. The anomaly located at Inset C is almost drill ready while the anomaly at Inset B will require a bit more work to get to the drill stage. Other anomalies do exist including at Inset A as well as the Cominco showing (not assessed during the course of this program) and these sites together with the generally underexplored nature of the property bode well for the discovery of new targets of potential significance. Excellent access allows for rapid cost-effective exploration programs.

Recommendations – In an effort to define trenching and drill targets, several tight spaced, 12.5m sample spacings, NE-SW trending soil lines should be completed across the main copper soil anomaly at Inset C. Grid style soil sampling should be completed at 25m x25m spacings over Inset B along with a tight spaced (6.25m interval) sample line in the road ditch straddling the area of the Cu-Mo-Au-Ag bearing rock samples. Further reconnaissance style prospecting and sampling should be conducted at Inset A, the area of the original Cominco discovery and other untested areas of the property.

565000

566000

567000

N



116-B-04

Scale: 1:15,000

7107000

7106000

7105000

7104000

FPD-01

PFBR-01

PFBR-02

FPD-02

FPD-03

FPD-12

PFBR-13

BKPU-11

BKPU-12

BKPU-13,14

CPUD-09

PFBR-12

PJD-09

PFBR-11

PJD-10

CPUD-07

CPUD-08

FPD-10

BKPU-10

BKPU-09

FPD-11

FPD-08

FPD-09

FPD-07

PFBR-08

PFBR-09

PFBR-10

PFBR-07

BKPU-15

FPD-13

PFBR-14

FPD-14

FPD-15

FPD-25

FPD-26

FPD-27

FPD-23

FPD-22

PFBR-17

PFBR-16

Pup Sample Overview Map

- Rocks (Cu ppm)**
- 0.0 - 150.0
 - 150.1 - 500.0
 - 500.1 - 1500.0
 - 1500.1 - 5000.0
 - 5000.1 - 34670.0

- Soils (Cu ppm)**
- 0 - 93.5
 - 93.6 - 141
 - 141.1 - 221
 - 221.1 - 388
 - 388.1 - 975.5

0 150 300 450 m

fig 6

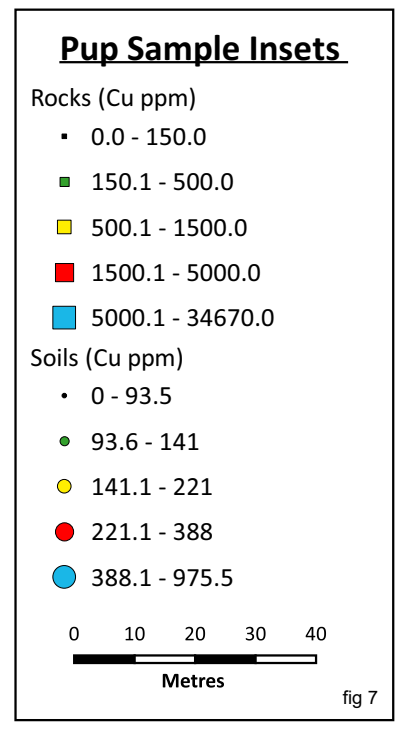
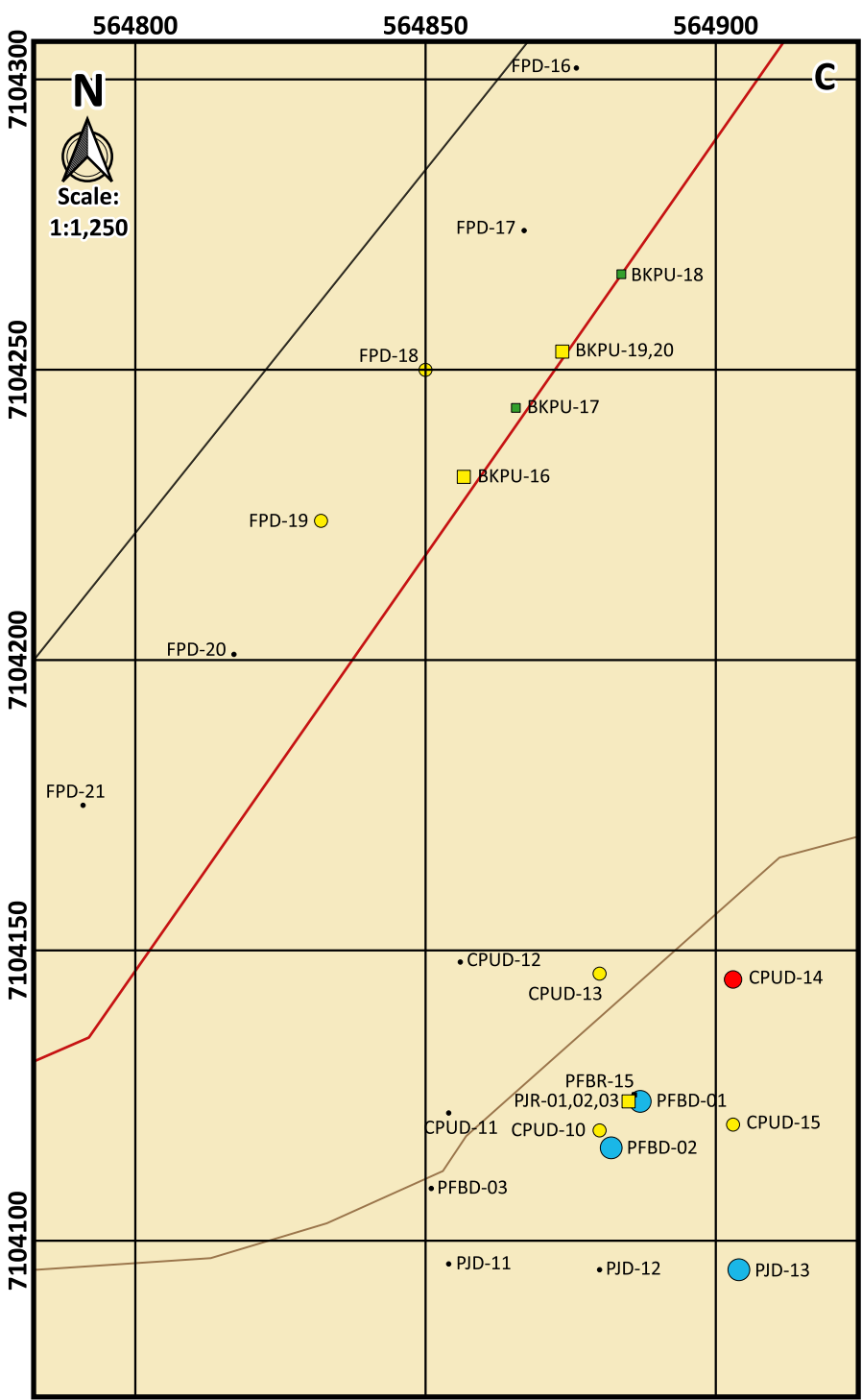
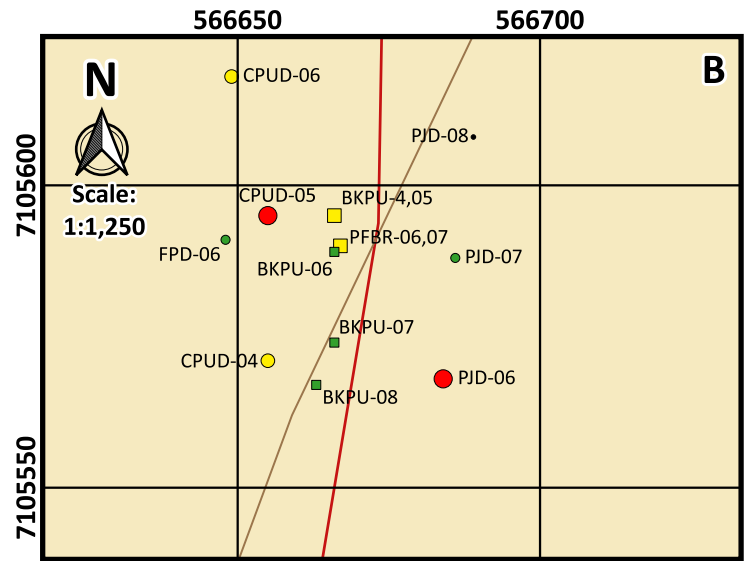
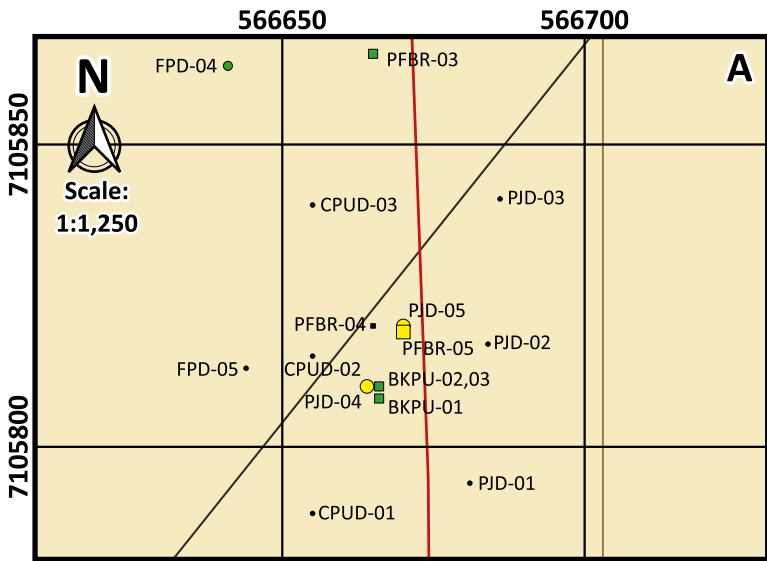

565000

566000

567000

N



116-B-04

Scale: 1:15,000

7107000

7106000

7105000

7104000

13.7

15.5

9.1

11.5

12.0

48.1

3.5

94.3

134.9

68.3

17.3

289.0

191.7

60.5

86.2

195.0

139.2

142.0

62.0

300.4

43.1

194.0

91.3

51.5

95.8

39.8

102.8

12.6

11127.1

53.4

124.0

2064.0

11.9

52.8

43.6

55.3

118.0

263.0

1895.4

2555.1

Pup Cu Overview Map

Rocks (Cu ppm)

- 0.0 - 150.0
- 150.1 - 500.0
- 500.1 - 1500.0
- 1500.1 - 5000.0
- 5000.1 - 34670.0

Soils (Cu ppm)

- 0 - 93.5
- 93.6 - 141
- 141.1 - 221
- 221.1 - 388
- 388.1 - 975.5

0 150 300 450 m

fig 8

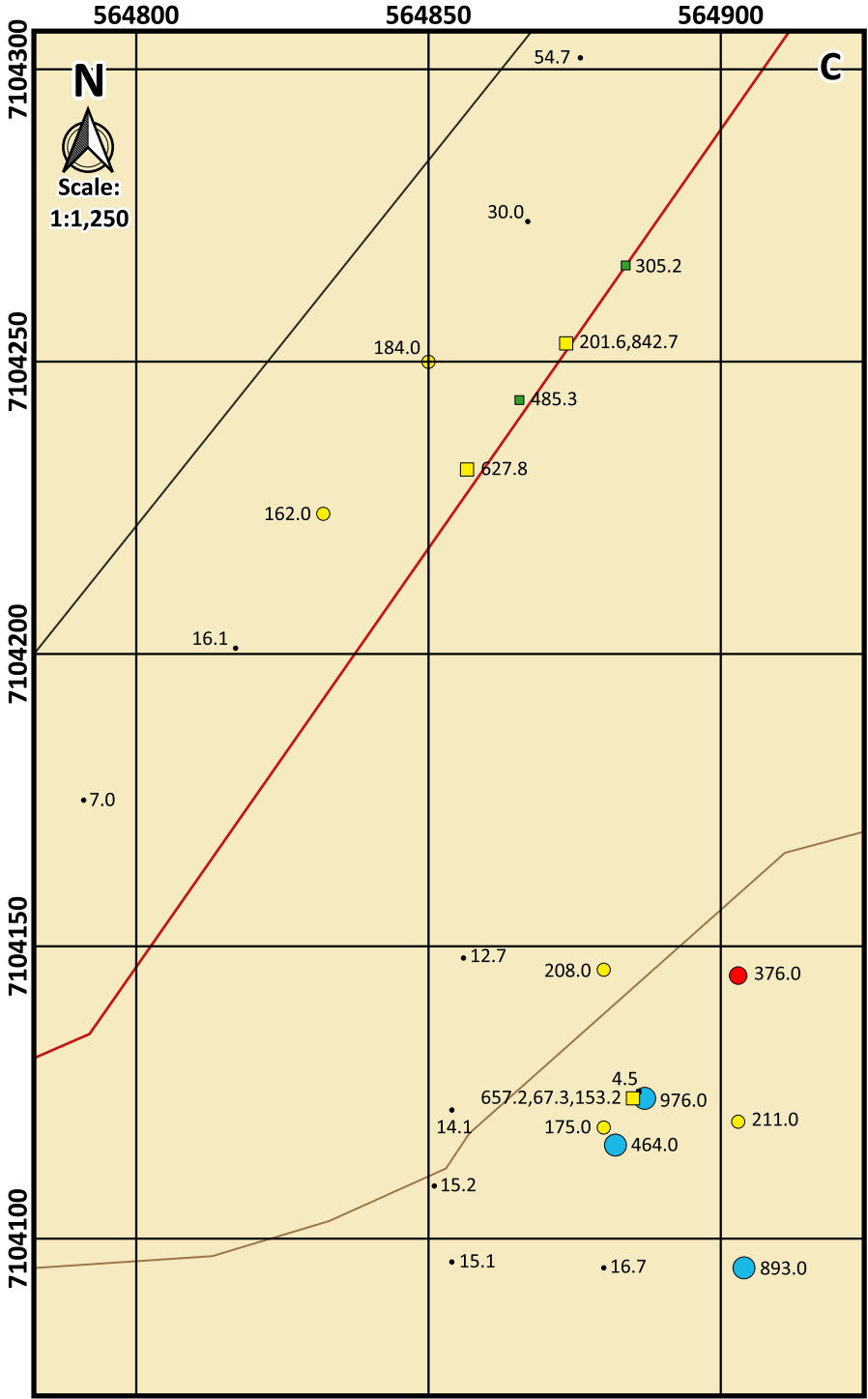
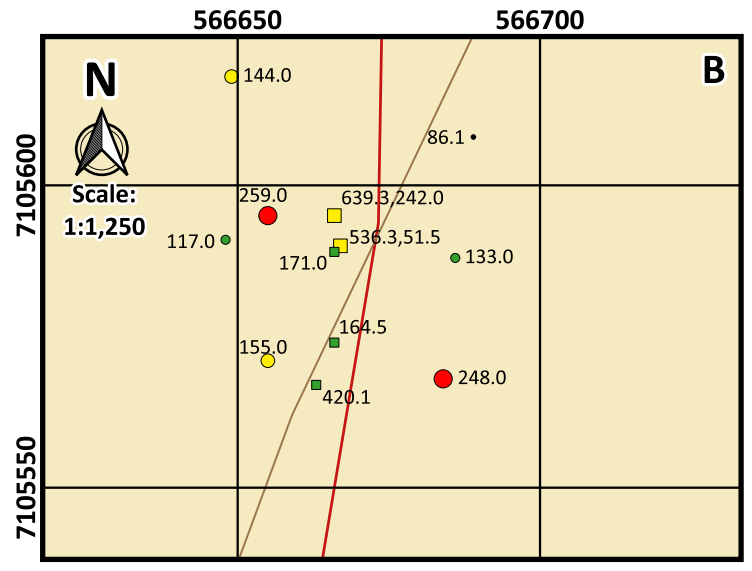
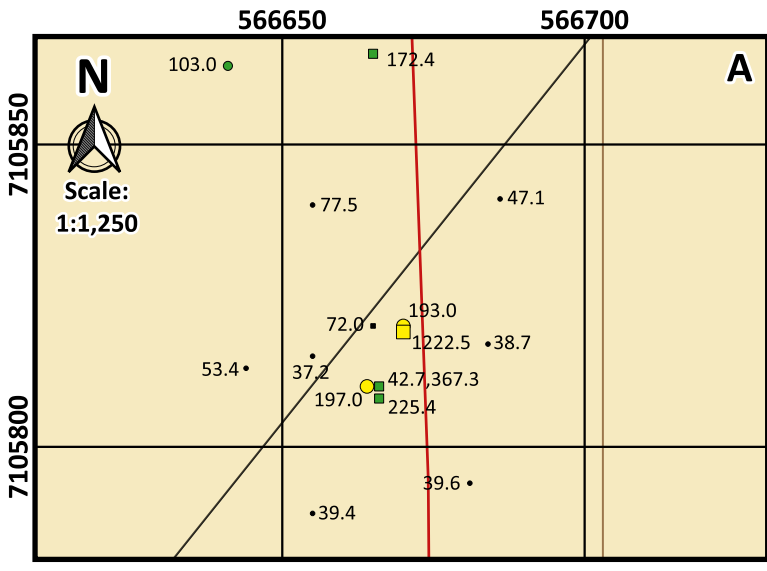

Pup Cu Insets

Rocks (Cu ppm)

- 0.0 - 150.0
- 150.1 - 500.0
- 500.1 - 1500.0
- 1500.1 - 5000.0
- 5000.1 - 34670.0

Soils (Cu ppm)

- 0 - 93.5
- 93.6 - 141
- 141.1 - 221
- 221.1 - 388
- 388.1 - 975.5

0 10 20 30 40
Metres

fig 9

565000

566000

567000

N



116-B-04

Scale: 1:15,000

7107000

7106000

7105000

7104000

41.0
73.0

11.0
39.0
40.0

147.0
122.0
14.0, 64.0

60.0
5.0

447.0
83.0
99.0
154.0
70.0
72.0
644.0
57.0
9.0

163.0
75.0
68.0
100.0
72.0
44.0

56.0
55.0
70.0

63.0

450.0
458.0
227.0

194.0
29.0
20.0
20.0

Pup Zn Overview Map

Rocks (Zn ppm)

- 0 - 249.9
- 250 - 500
- 500.1 - 1000
- 1000 - 2000
- 2000.1 - 2017

Soils (Zn ppm)

- 0 - 169.9
- 170 - 229.9
- 230 - 399.9
- 400 - 899.9
- 900 - 3169

0 150 300 450 m

fig 10

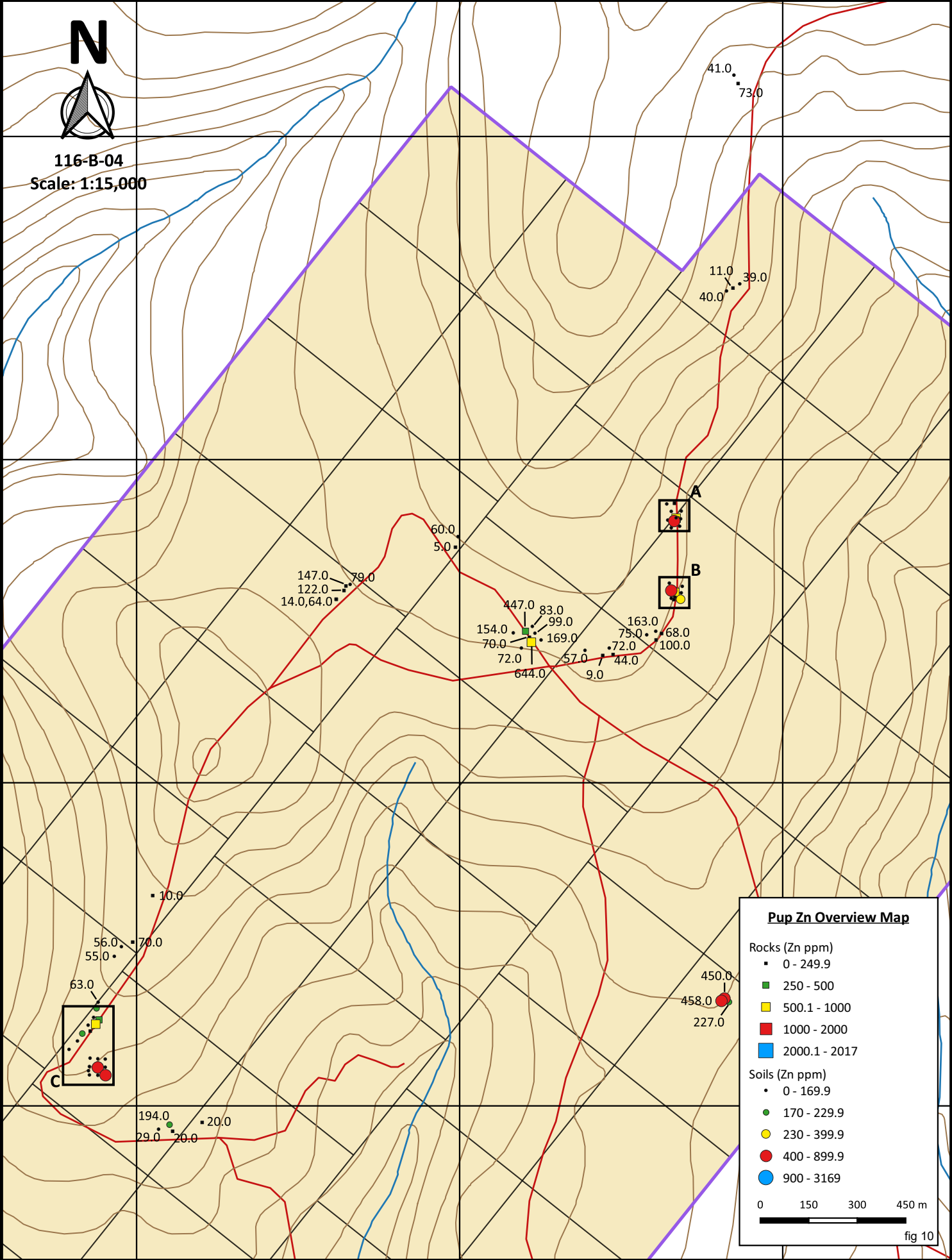

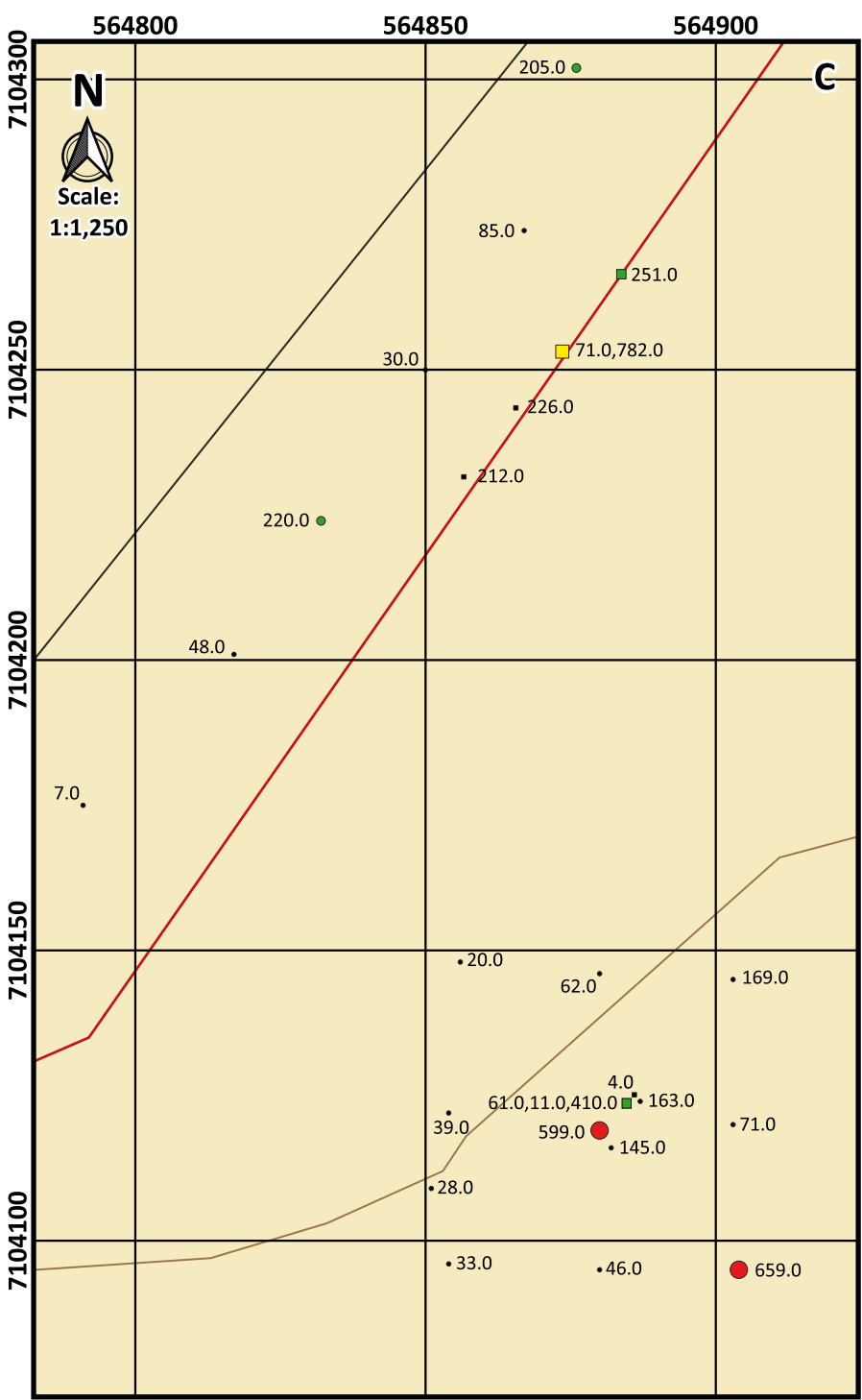
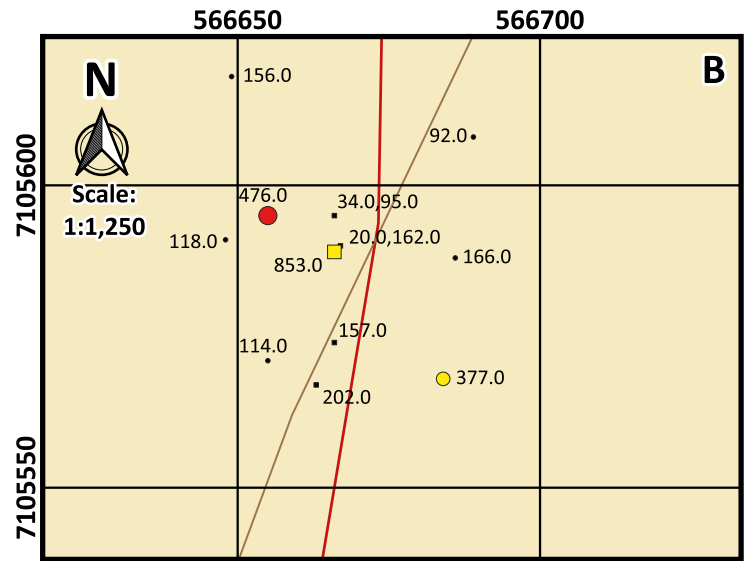
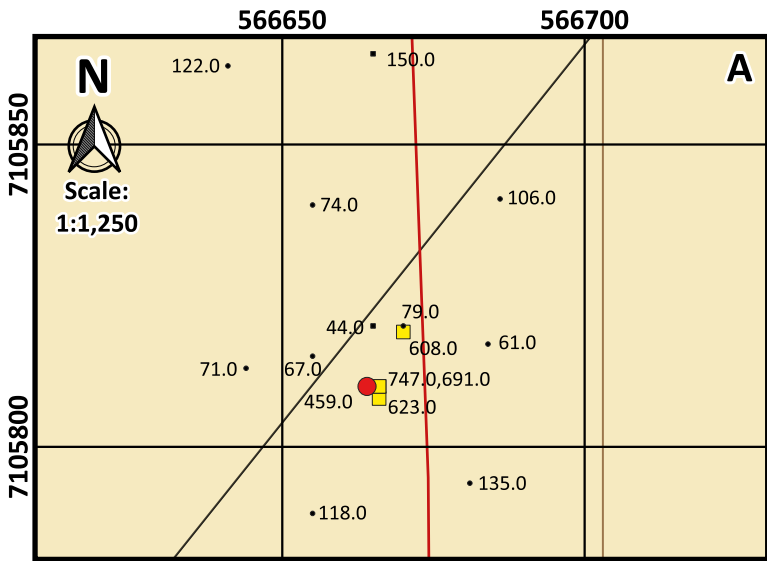

Pup Zn Insets

Rocks (Zn ppm)

- 0 - 249.9
- 250 - 500
- 500.1 - 1000
- 1000.1 - 2000
- 2000.1 - 2017

Soils (Zn ppm)

- 0 - 169.9
- 170 - 229.9
- 230 - 399.9
- 400 - 899.9
- 900 - 3169

0 10 20 30 40
Metres

fig 11

2023 Pup Rock Samples

Sample	Easting	Northing	Description	Wgt	Au	Ag	Cu	Fe	Mo	Pb	Zn
BKPU-01	566666	7105808	muscovite schist poss pre-meta morph qtz py vn or qtz py rich layer	0.56	4.1	1.4	225.4	9.61	0.8	14.3	623
BKPU-02	566666	7105810	crenulated chloritic meta rhyolite with lim	0.51	1.3	0.2	42.7	2.38	1.4	11.4	747
BKPU-03	566666	7105810	qtz muscovite sericite schist with lim as patches and along layer	1.2	6.4	0.8	367.3	10.95	1.1	18.1	691
BKPU-04	566666	7105595	lim qtz sericite chlorite schist	1.08	218.8	3.3	639.3	12.05	120.4	42.3	34
BKPU-05	566666	7105595	qtz chlorite vfg rock poss fine mafic metatuff or gneiss? weak malachite poss biotite	0.53	0.7	0.1	242	6.03	1.2	56.1	95
BKPU-06	566666	7105589	chlorite qtz sericite rock poss mafic meta tuff weathered lim patches	1.1	3	0.1	171	5.68	1.2	9.1	853
BKPU-07	566666	7105574	sericite chlorite qtz schist poss meta version of BKPU-06	1.15	1.5	<0.1	164.5	5.02	1	30.9	157
BKPU-08	566663	7105567	weakly lim sericite qtz chlorite schist version of BKPU-06/07	0.98	4.1	0.2	420.1	4.51	0.8	15.9	202
BKPU-09	566443	7105394	creamy yellow weathering rhyolite weakly lim weathered py vugs	0.76	8.7	0.8	58.9	3.77	12.6	38.8	9
BKPU-10	566222	7105435	creamy yellow weathering rhyo, fine to coarse brx, frac coated with lim, goethite	1.08	12.9	1.3	300.4	11.05	8	253.2	644
BKPU-11	565648	7105609	as per BKPU-10, frags from ditch	0.83	2.8	1.5	94.3	4.92	6.1	339.1	147
BKPU-12	565642	7105595	as per BKPU-10, frags from ditch over 5m	1.28	3.9	0.5	134.9	3.7	2.7	67.6	122
BKPU-13	565618	7105568	qtz lim vn	1.08	0.5	<0.1	17.3	1.18	1.1	6.3	14
BKPU-14	565618	7105568	brx frac lim rhyolite with goethite	0.87	4.9	0.5	289	9.2	3.4	148	64
BKPU-15	565050	7104651	crenulated qtz sericite schist, weathered py vugs lim	0.79	3.5	0.5	1127.1	11.01	7.2	23.9	10
BKPU-16	564844	7104240	chlorite sericite qtz schist with lim diss and foliaform py	1.08	41.3	4.1	627.8	4.91	11.1	408.6	212
BKPU-17	564850	7104250	as per BKPU-16	0.78	67.1	1.3	485.3	3.98	3.4	37.3	226
BKPU-18	564876	7104270	340 trend shear gouge zone or foliaform weathered layers qtz sericite chlorite schist, chip over 1.6m	1.6	7.1	0.4	305.2	3.57	2.6	23.1	251
BKPU-19	564864	7104257	brx qtz vn cemented with black oxide	1.09	0.7	<0.1	201.6	1.21	1.2	6.6	71
BKPU-20	564864	7104257	chlorite sericite qtz schist lim heavily weathered	0.24	3.1	<0.1	842.7	8.46	3.4	53.7	782
PFBR-01	566862	7107164	rusty gouge in rd ditch 1m chip	0.93	1.6	<0.1	15.5	2.62	1.1	17.7	73
PFBR-02	566846	7106531	rep grabs of rusty rock in ditch lim sericite qtz schist, vfg py poss magnetite	1	<0.5	<0.1	9.1	1.67	1.8	11	50
PFBR-03	566665	7105865	select grab from rd ditch heavily lim qtz sericite schist	0.74	0.6	0.2	172.4	4.04	1.5	28.3	150
PFBR-04	566665	7105820	rd ditch, as per PFBR-03, poss chlorite cubic py, looks like a rhyolite	0.44	<0.5	0.2	72	2.41	2.2	9.5	44
PFBR-05	566670	7105819	50% lim poss mal, heavily weathered qtz sericite schist and leached, numerous frags in ditch	0.39	40.5	4.3	1222.5	19.83	9.4	79.8	608
PFBR-06	566667	7105590	heavily lim qtz sericite schist tr fine py 20cm wide layer poss fine biotite	0.63	110.8	1.6	348.2	9.39	56.3	27.7	20

Sample	Easting	Northing	Description	Wgt	Au	Ag	Cu	Fe	Mo	Pb	Zn
PFBR-07	566667	7105590	qtz chlorite less lim adjacent to PFBR-06	0.67	4.7	0.1	536.3	6.65	1.5	17.8	162
PFBR-08	566625	7105462	lim gougey qtz chlorite schist poss vns, in ditch, (6 auger holes)	0.78	2.4	<0.1	51.5	4.56	1.6	5.2	68
PFBR-09	566608	7105442	gougey/grungy pale to lim crud from ditch (4 auger holes)	0.69	1.8	0.1	95.8	2.79	2	12.4	100
PFBR-10	566475	7105397	weakly pyritic lim rhyolite in ditch	0.6	4.3	0.3	102.8	3.78	2.1	30.2	44
PFBR-11	566216	7105450	lim creamy qtz rich schist likely a meta-rhyolite diss py and along foliation almost tuffaceous	0.75	42.3	6.8	139.2	3.63	6.3	1720.7	70
PFBR-12	566204	7105469	ferricrete cemented creamy brx rhyolite lim	0.75	6.9	0.2	191.7	16.24	2.6	102.1	447
PFBR-13	565987	7105729	meta sandstone cut by qv sheeted/stkwrk lim on vn margins, grab over 20m	1.51	<0.5	<0.1	3.5	0.37	0.6	21.5	5
PFBR-14	564988	7104507	bedded lim goethite rock leached and yet still heavy	0.27	3.6	0.4	2064	28.69	5.9	20.9	70
PFBR-15	564887	7104124	hematitic qtz rich poss super qtz rich rhyo, chlorite sericite schist inclusions in host	1.03	<0.5	<0.1	4.5	0.68	1.5	12	4
PFBR-16	565104	7103939	lim qtz frags in ditch, with mal	0.39	<0.5	0.1	2555.1	1	0.9	5.9	20
PFBR-17	565203	7103949	qtz sericite lim goethite brx ragged qtz frags in fine sericite lim groundmass	0.9	4.2	0.5	1895.4	15.38	2.3	26.6	20
PJR-01	564885	7104124	heavily lim meta rhyolite with goethite on rare frac tr diss py poss meta tuff	0.43	4.2	0.1	657.2	8.77	3.2	58.3	61
PJR-02	564885	7104124	yellow weathering weakly lim rhyolite	0.81	94.2	1.9	67.3	4.8	4.2	26.4	11
PJR-03	564885	7104124	crumbly sheared up material beige yellow brown lim, 4 pull from pit bottom with auger	0.83	11	0.2	153.2	1.98	2.3	49.2	410

2023 Pup Soils

Sample	Easting	Northing	Description	Au	Ag	Cu	Fe	Mo	Pb	Zn
CPUD-01	566655	7105789		2	0.2	39.4	2.98	1.4	20.6	118
CPUD-02	566655	7105815		2.3	0.1	37.2	2.11	0.9	11.6	67
CPUD-03	566655	7105840		2.4	<0.1	77.5	2.57	0.7	11.4	74
CPUD-04	566655	7105571		4.5	0.1	154.9	3.81	0.7	9.7	114
CPUD-05	566655	7105595		3.9	0.1	259.1	3.97	0.7	10	476
CPUD-06	566649	7105618		5.9	<0.1	143.9	3.97	0.6	21	156
CPUD-07	566225	7105484		5.9	0.3	60.5	2.9	1	31.8	83
CPUD-08	566252	7105442		14.4	0.4	142.3	4.75	2.6	83.7	169
CPUD-09	565661	7105614	rd ditch	7.6	0.5	68.3	4.23	2.6	148.2	79
CPUD-10	564880	7104119		27.4	2.3	175.2	3.63	8.7	94.9	599
CPUD-11	564854	7104122		1	0.2	14.1	4.08	1.5	55.9	39
CPUD-12	564856	7104148		4.6	0.1	12.7	2.63	1.3	31.1	20
CPUD-13	564880	7104146		10.6	0.4	208.4	4	1.1	21.1	62
CPUD-14	564903	7104145		9.5	0.3	375.9	3.01	1.3	38.9	169
CPUD-15	564903	7104120		10.4	0.3	211.4	2.65	1.2	20.1	71
FPD-01	566849	7107190	c horizon	1.8	<0.1	13.7	1.65	0.5	9.2	41
FPD-02	566867	7106544	weak limonite	1.2	<0.1	11.5	1.39	0.5	14.2	39
FPD-03	566826	7106522	weak limonite	1.2	<0.1	12	1.52	0.4	14.1	40
FPD-04	566641	7105863	dark schist	3.5	0.2	102.8	4.02	0.4	15.8	122
FPD-05	566644	7105813	weak limonite	1.8	0.1	53.4	2.63	0.9	10.7	71
FPD-06	566648	7105591		3.8	<0.1	117.3	1.97	0.3	13.2	118
FPD-07	566607	7105469		3.4	<0.1	194	4.43	0.5	10.7	163
FPD-08	566579	7105458		6.3	0.3	91.3	2.2	0.6	38.9	75
FPD-09	566463	7105417		6.1	0.2	39.8	2.77	1.5	34.1	72
FPD-10	566388	7105410		5.4	0.3	43.1	3.41	3.1	84.2	57
FPD-11	566233	7105463		10.1	0.3	86.2	4.05	1.5	42.2	99
FPD-12	565995	7105762		2.8	<0.1	48.1	2.96	0.8	12.4	60
FPD-13	564953	7104493		1.1	<0.1	53.4	3.72	<0.1	1.5	56
FPD-14	564931	7104463		0.8	0.3	123.6	2.69	0.9	8.7	55
FPD-15	564881	7104321	ditch weathered bedrock	1.3	<0.1	11.9	1.46	0.1	35.9	63
FPD-16	564876	7104302	ditch weathered bedrock	6.6	<0.1	54.7	2.54	2.1	28.3	205
FPD-17	564867	7104274	ditch weathered bedrock	1.5	<0.1	30	2.5	0.7	11.7	85
FPD-18	564850	7104250	ditch weathered bedrock	4.6	0.1	184.2	0.36	0.7	18.4	30
FPD-19	564832	7104224	ditch weathered bedrock	9.9	0.3	162.1	1.44	1.2	44.3	220
FPD-20	564817	7104201	ditch weathered bedrock	3.9	0.3	16.1	3.58	1.5	59.1	48
FPD-21	564791	7104175	ditch weathered bedrock	3.4	0.2	7	1.73	1.7	15.9	7
FPD-22	565068	7103928		22	0.6	265.4	3.91	1.9	9.1	29
FPD-23	565102	7103942		9.4	0.2	117.6	2.01	1	15.1	194
FPD-24	566828	7104326		4.1	0.2	55.3	2.59	0.6	74.5	227
FPD-25	566819	7104328		4.9	0.3	43.6	2.61	0.7	86.1	450
FPD-26	566814	7104325		9.3	0.2	52.8	2.18	0.7	116.7	458
PFBD-01	564887	7104124		71.3	1.7	975.5	4.42	2.1	62.1	163
PFBD-02	564882	7104116		138.4	3	464.4	5.9	3.6	189.7	145
PFBD-03	564851	7104109		1.4	0.2	15.2	2.64	1	24.6	28
PJD-01	566681	7105794		7.7	0.2	39.6	2.8	1.1	27.1	135
PJD-02	566684	7105817		2.4	<0.1	38.7	2.12	0.7	11.3	61
PJD-03	566686	7105841		2.3	<0.1	47.1	3.51	0.9	17.7	106
PJD-04	566664	7105810	ditch weathered bedrock	0.6	0.2	197	2.55	0.9	16.2	459
PJD-05	566670	7105820	ditch weathered bedrock	1.1	0.1	192.5	3.19	0.4	13.2	79
PJD-06	566684	7105568		8.9	0.3	247.9	4.41	1.5	32.6	377
PJD-07	566686	7105588		3.2	<0.1	132.6	2.79	0.5	13.1	166
PJD-08	566689	7105608		4.3	0.1	86.1	3.36	1	22.4	92

<u>Sample</u>	<u>Easting</u>	<u>Northing</u>	<u>Description</u>	<u>Au</u>	<u>Ag</u>	<u>Cu</u>	<u>Fe</u>	<u>Mo</u>	<u>Pb</u>	<u>Zn</u>
PJD-09	566166	7105464	mixed b/c	8.3	0.1	195.4	4.09	2.3	44	154
PJD-10	566191	7105417	mixed b/c	5.4	0.3	62	2.96	1.6	38.9	72
PJD-11	564854	7104096		3	0.2	15.1	3.28	1.4	31.5	33
PJD-12	564880	7104095		1.4	<0.1	16.7	2.94	1.2	15.7	46
PJD-13	564904	7104095		9.9	0.2	893.1	3.54	1.1	87.1	659

Statement Of Qualifications

I, Bernie Kreft, conducted and directed the exploration work described herein.

I have 34 years prospecting experience in the Yukon and BC.

This report is based on fieldwork conducted by Jarret Kreft, Justin Kreft and the author, and includes information from publicly available assessment reports.

This report is based on fieldwork completed from July 20th to September 4th, 2023.

This report is based on fieldwork completed on the Pup Project, west of Dawson City, Yukon.

Respectfully Submitted,

Bernie Kreft

Pup Project Statement Of Costs from July 20th to September 4th, 2023

Wages Jarret Kreft, 3.5 days x \$300/day	\$1,050.00
Wages Justin Kreft, 3.5 days x \$300/day	\$1,050.00
Wages Bernie Kreft, 3.5 days x \$350/day	\$1,225.00
Field supplies, food, camp and lodging 3.5 days x \$100/day/person x 3 people	\$1,050.00
Describe rock samples, pack, de-pack, drop at lab 1 day x \$350/day	\$350.00
Truck travel 4x4 truck, 2168 kilometres x \$0.60/km	\$1,300.80
Report writing Bernie Kreft, maps and figures Jarret Kreft	\$2,500.00
Claim staking, 64 claims, Spere Exploration, Morgan Fraughton	\$8,400.00
Bureau Veritas 40 rocks and 57 soils for Au + 36 elements via AQ201 acid digestion	<u>\$3,413.15</u>
Total	\$20,338.95



**BUREAU
VERITAS**

MINERAL LABORATORIES
Canada

www.bvna.com/mining-laboratory-services

Bureau Veritas Commodities Canada Ltd.

9050 Shaughnessy St Vancouver British Columbia V6P 6E5 Canada

PHONE (604) 253-3158

Client: Kreft, Bernie

1 Locust Place

Whitehorse Yukon Y1A 5G9 Canada

Submitted By: Bernie Kreft

Receiving Lab: Canada-Whitehorse

Received: July 28, 2023

Analysis Start: August 11, 2023

Report Date: August 25, 2023

Page: 1 of 2

CERTIFICATE OF ANALYSIS

WHI23000259.1

CLIENT JOB INFORMATION

Project: NA
Shipment ID:
P.O. Number
Number of Samples: 17

SAMPLE DISPOSAL

DISP-PLP Dispose of Pulp After 90 days
DISP-RJT Dispose of Reject After 60 days

Bureau Veritas does not accept responsibility for samples left at the laboratory after 90 days without prior written instructions for sample storage or return.

Invoice To: Kreft, Bernie
1 Locust Place
Whitehorse Yukon Y1A 5G9
Canada

CC:

SAMPLE PREPARATION AND ANALYTICAL PROCEDURES

Procedure Code	Number of Samples	Code Description	Test Wgt (g)	Report Status	Lab
PRP70-250	17	Crush, split and pulverize 250 g rock to 200 mesh			WHI
SHP01	17	Per sample shipping charges for branch shipments			VAN
AQ201	17	1:1:1 Aqua Regia digestion ICP-MS analysis	15	Completed	VAN

ADDITIONAL COMMENTS

CLAIRE HO
Special Projects Coordinator

This report supersedes all previous preliminary and final reports with this file number dated prior to the date on this certificate. Signature indicates final approval; preliminary reports are unsigned and should be used for reference only. All results are considered the confidential property of the client. Bureau Veritas assumes the liabilities for actual cost of analysis only. Results apply to samples as submitted.
*** asterisk indicates that an analytical result could not be provided due to unusually high levels of interference from other elements.



Bureau Veritas Commodities Canada Ltd.

9050 Shaughnessy St Vancouver British Columbia V6P 6E5 Canada

PHONE (604) 253-3158

Project: NA
Report Date: August 25, 2023

Page: 2 of 2

Part: 1 of 2

CERTIFICATE OF ANALYSIS

WHI23000259.1

Method	Analyte	WGHT	AQ201	AQ201	AQ201	AQ201	AQ201	AQ201	AQ201	AQ201	AQ201	AQ201	AQ201	AQ201	AQ201	AQ201	AQ201	AQ201	AQ201	AQ201	AQ201	AQ201
		Wgt	Mo	Cu	Pb	Zn	Ag	Ni	Co	Mn	Fe	As	U	Au	Th	Sr	Cd	Sb	Bi	V	Ca	
Unit		kg	ppm	ppm	ppm	ppm	ppm	ppm	ppm	%	ppm	ppm	ppb	ppm	ppm	ppm	ppm	ppm	ppm	ppm	ppm	
MDL		0.01	0.1	0.1	0.1	1	0.1	0.1	0.1	1	0.01	0.5	0.1	0.5	0.1	1	0.1	0.1	0.1	1	0.01	
PFBR-01	Rock	0.93	1.1	15.5	17.7	73	<0.1	7.0	5.2	420	2.62	3.9	2.0	1.6	10.0	15	0.2	0.7	0.2	13	0.17	
PFBR-02	Rock	1.00	1.8	9.1	11.0	50	<0.1	4.9	3.9	209	1.67	1.0	1.2	<0.5	10.2	10	<0.1	0.2	0.1	4	0.07	
PFBR-03	Rock	0.74	1.5	172.4	28.3	150	0.2	7.8	13.0	1405	4.04	2.8	0.6	0.6	3.4	7	0.5	0.2	0.3	34	0.30	
PFBR-04	Rock	0.44	2.2	72.0	9.5	44	0.2	3.5	3.7	420	2.41	17.4	1.2	<0.5	5.8	5	0.5	0.2	3.6	2	0.06	
PFBR-05	Rock	0.39	9.4	1222.5	79.8	608	4.3	3.2	2.9	407	19.83	262.1	2.5	40.5	3.5	6	5.5	0.3	36.3	6	0.12	
PFBR-06	Rock	0.63	56.3	348.2	27.7	20	1.6	2.7	5.6	126	9.39	31.9	0.6	110.8	0.7	15	<0.1	0.2	0.8	48	0.32	
PFBR-07	Rock	0.67	1.5	536.3	17.8	162	0.1	16.0	24.3	1648	6.65	5.6	1.0	4.7	1.5	28	0.1	<0.1	0.3	93	0.28	
PFBR-08	Rock	0.78	1.6	51.5	5.2	68	<0.1	17.5	22.6	1030	4.56	1.4	0.7	2.4	1.2	44	0.1	0.2	<0.1	91	5.15	
PFBR-09	Rock	0.69	2.0	95.8	12.4	100	0.1	20.0	16.9	889	2.79	0.9	1.2	1.8	4.1	13	0.3	0.1	0.2	28	2.05	
PFBR-10	Rock	0.60	2.1	102.8	30.2	44	0.3	3.2	1.5	194	3.78	13.3	1.1	4.3	7.1	14	<0.1	0.2	1.9	16	0.06	
PFBR-11	Rock	0.75	6.3	139.2	1720.7	70	6.8	3.4	0.6	195	3.63	10.1	1.5	42.3	10.9	27	<0.1	1.2	35.9	13	0.05	
PFBR-12	Rock	0.75	2.6	191.7	102.1	447	0.2	15.0	15.8	308	16.24	12.0	2.6	6.9	8.8	15	<0.1	1.3	1.5	21	0.11	
PFBR-13	Rock	1.51	0.6	3.5	21.5	5	<0.1	1.1	0.4	385	0.37	<0.5	0.6	<0.5	19.4	64	<0.1	<0.1	0.1	<1	0.63	
PFBR-14	Rock	0.27	5.9	2064.0	20.9	70	0.4	23.7	82.2	187	28.69	154.0	4.8	3.6	0.4	13	4.8	0.4	1.9	118	0.19	
PFBR-15	Rock	1.03	1.5	4.5	12.0	4	<0.1	1.6	0.6	34	0.68	0.8	0.2	<0.5	2.9	8	<0.1	0.1	<0.1	2	<0.01	
PFBR-16	Rock	0.39	0.9	2555.1	5.9	20	0.1	1.4	1.5	83	1.00	<0.5	0.7	<0.5	0.3	10	0.2	<0.1	<0.1	1	<0.01	
PFBR-17	Rock	0.90	2.3	1895.4	26.6	20	0.5	5.0	1.7	91	15.38	3.7	2.5	4.2	9.5	13	0.1	0.2	<0.1	4	0.03	



Bureau Veritas Commodities Canada Ltd.

9050 Shaughnessy St Vancouver British Columbia V6P 6E5 Canada

PHONE (604) 253-3158

Project: NA
Report Date: August 25, 2023

Page: 2 of 2

Part: 2 of 2

CERTIFICATE OF ANALYSIS

WHI23000259.1

Method	Analyte	AQ201	AQ201	AQ201	AQ201	AQ201	AQ201	AQ201	AQ201	AQ201	AQ201	AQ201	AQ201	AQ201	AQ201	AQ201	AQ201	AQ201	AQ201	AQ201
		P	La	Cr	Mg	Ba	Ti	B	Al	Na	K	W	Hg	Sc	Tl	S	Ga	Se	Te	
Unit		%	ppm	ppm	%	ppm	%	ppm	%	%	ppm	ppm	ppm	ppm	%	ppm	ppm	ppm		
MDL		0.001	1	1	0.01	1	0.001	1	0.01	0.001	0.01	0.01	0.1	0.01	0.1	0.1	0.05	1	0.5	0.2
PFBR-01	Rock	0.047	16	11	0.13	409	0.005	1	1.04	0.021	0.22	<0.1	0.02	9.2	0.1	<0.05	3	<0.5	<0.2	
PFBR-02	Rock	0.030	12	13	0.11	207	0.001	<1	0.46	0.027	0.18	<0.1	0.01	2.1	<0.1	<0.05	1	<0.5	<0.2	
PFBR-03	Rock	0.081	9	8	0.16	258	<0.001	<1	0.64	0.016	0.12	<0.1	0.05	8.6	<0.1	<0.05	2	<0.5	<0.2	
PFBR-04	Rock	0.017	16	12	0.06	217	<0.001	<1	0.49	0.024	0.14	<0.1	<0.01	4.3	<0.1	<0.05	<1	<0.5	<0.2	
PFBR-05	Rock	0.015	16	6	0.19	160	0.005	<1	0.93	0.003	<0.01	<0.1	0.35	3.9	<0.1	<0.05	11	7.9	0.4	
PFBR-06	Rock	0.033	4	15	0.16	138	0.008	<1	0.53	0.012	0.11	<0.1	0.22	6.5	<0.1	0.07	4	8.6	1.2	
PFBR-07	Rock	0.093	10	32	2.77	123	0.004	<1	3.81	0.010	0.10	<0.1	0.02	10.4	<0.1	<0.05	9	<0.5	<0.2	
PFBR-08	Rock	0.031	4	19	0.91	111	0.002	<1	1.01	0.035	0.06	<0.1	<0.01	17.7	<0.1	<0.05	3	<0.5	<0.2	
PFBR-09	Rock	0.045	7	16	0.13	413	0.001	<1	0.49	0.019	0.18	<0.1	0.02	6.2	<0.1	<0.05	1	<0.5	<0.2	
PFBR-10	Rock	0.059	7	22	0.54	249	0.017	<1	0.67	0.029	0.50	<0.1	0.05	1.5	0.4	0.73	3	8.2	0.5	
PFBR-11	Rock	0.061	12	22	0.57	309	0.016	<1	0.99	0.007	0.35	<0.1	0.30	2.1	0.2	0.37	3	25.7	5.7	
PFBR-12	Rock	0.192	9	20	0.40	297	0.004	<1	0.93	0.018	0.32	<0.1	0.13	2.6	0.3	0.39	3	3.3	0.4	
PFBR-13	Rock	0.010	29	4	0.03	1795	0.002	<1	0.27	0.028	0.26	<0.1	<0.01	0.2	<0.1	<0.05	<1	<0.5	<0.2	
PFBR-14	Rock	0.023	4	21	0.36	146	0.006	<1	1.23	0.002	0.04	<0.1	0.05	6.0	<0.1	<0.05	5	14.6	<0.2	
PFBR-15	Rock	0.007	9	7	<0.01	75	0.002	<1	0.14	0.055	0.08	<0.1	<0.01	0.2	<0.1	0.07	<1	<0.5	<0.2	
PFBR-16	Rock	0.005	<1	5	<0.01	1185	<0.001	<1	0.03	0.002	0.01	<0.1	<0.01	0.3	<0.1	<0.05	<1	1.6	<0.2	
PFBR-17	Rock	0.043	6	7	0.02	1081	<0.001	<1	0.65	0.003	0.17	<0.1	0.81	1.6	<0.1	0.06	<1	1.9	<0.2	



Bureau Veritas Commodities Canada Ltd.
9050 Shaughnessy St Vancouver British Columbia V6P 6E5 Canada
PHONE (604) 253-3158

Project: NA
Report Date: August 25, 2023

Page: 1 of 1

Part: 1 of 2

QUALITY CONTROL REPORT

WHI23000259.1

Method	WGHT	AQ201	AQ201	AQ201	AQ201	AQ201	AQ201	AQ201	AQ201	AQ201	AQ201	AQ201	AQ201	AQ201	AQ201	AQ201	AQ201	AQ201	AQ201	AQ201	AQ201
Analyte	Wgt	Mo	Cu	Pb	Zn	Ag	Ni	Co	Mn	Fe	As	U	Au	Th	Sr	Cd	Sb	Bi	V	Ca	
Unit	kg	ppm	ppm	ppm	ppm	ppm	ppm	ppm	ppm	%	ppm	ppm	ppb	ppm	ppm	ppm	ppm	ppm	ppm	ppm	
MDL	0.01	0.1	0.1	0.1	1	0.1	0.1	0.1	1	0.01	0.5	0.1	0.5	0.1	1	0.1	0.1	0.1	1	0.01	
Pulp Duplicates																					
PFBR-07	Rock	0.67	1.5	536.3	17.8	162	0.1	16.0	24.3	1648	6.65	5.6	1.0	4.7	1.5	28	0.1	<0.1	0.3	93	0.28
REP PFBR-07	QC		1.5	536.7	16.7	161	0.1	15.8	23.7	1684	6.67	5.5	1.0	4.4	1.5	27	0.1	<0.1	0.3	95	0.29
Core Reject Duplicates																					
PFBR-12	Rock	0.75	2.6	191.7	102.1	447	0.2	15.0	15.8	308	16.24	12.0	2.6	6.9	8.8	15	<0.1	1.3	1.5	21	0.11
DUP PFBR-12	QC		2.9	208.6	115.4	496	0.2	16.6	17.7	349	18.15	13.3	2.9	7.6	9.6	17	0.1	1.5	1.5	23	0.12
Reference Materials																					
STD BVGEO01	Standard		10.3	4281.4	171.2	1651	2.3	154.2	23.6	686	3.52	116.7	3.3	201.7	13.0	53	5.7	3.5	21.8	69	1.28
STD BVGEO01	Standard		9.8	4234.6	172.5	1624	2.4	156.7	24.5	679	3.52	116.8	3.3	203.1	13.1	52	5.9	3.2	23.4	72	1.27
STD OREAS262	Standard		0.6	111.9	52.5	149	0.4	61.4	26.6	517	3.15	34.4	1.1	57.3	8.3	34	0.6	4.8	0.9	21	2.84
STD BVGEO01 Expected			11.2	4415	187	1712	2.53	163	25	706	3.7	121	3.67	214	14.4	55	6.25	3.39	24.3	73	1.3219
STD OREAS262 Expected			0.68	118	56	154	0.45	62	26.9	530	3.284	35.8	1.22	65	9.33	36	0.61	5.06	1.03	22.5	2.98
BLK	Blank		<0.1	<0.1	<0.1	<1	<0.1	<0.1	<0.1	<1	<0.01	<0.5	<0.1	<0.5	<0.1	<1	<0.1	<0.1	<0.1	<1	<0.01
BLK	Blank		<0.1	<0.1	<0.1	<1	<0.1	<0.1	<0.1	<1	<0.01	<0.5	<0.1	<0.5	<0.1	<1	<0.1	<0.1	<0.1	<1	<0.01
Prep Wash																					
ROCK-WHI	Prep Blank		1.9	2.8	1.1	28	<0.1	1.6	3.1	417	1.63	1.0	0.3	0.6	1.9	19	<0.1	<0.1	<0.1	20	0.53
ROCK-WHI	Prep Blank		2.5	3.4	1.1	29	<0.1	2.5	3.4	464	1.84	0.9	0.4	<0.5	2.1	22	<0.1	<0.1	<0.1	21	0.57



Bureau Veritas Commodities Canada Ltd.
9050 Shaughnessy St Vancouver British Columbia V6P 6E5 Canada
PHONE (604) 253-3158

Project: NA
Report Date: August 25, 2023

Page: 1 of 1

Part: 2 of 2

QUALITY CONTROL REPORT

WHI23000259.1

Method	AQ201	AQ201	AQ201	AQ201	AQ201	AQ201	AQ201	AQ201	AQ201	AQ201	AQ201	AQ201	AQ201	AQ201	AQ201	AQ201	AQ201	AQ201	AQ201
Analyte	P	La	Cr	Mg	Ba	Ti	B	Al	Na	K	W	Hg	Sc	Tl	S	Ga	Se	Te	
Unit	%	ppm	ppm	%	ppm	%	ppm	%	%	%	ppm	ppm	ppm	ppm	%	ppm	ppm	ppm	
MDL	0.001	1	1	0.01	1	0.001	1	0.01	0.001	0.01	0.1	0.01	0.1	0.1	0.05	1	0.5	0.2	
Pulp Duplicates																			
PFBR-07	Rock	0.093	10	32	2.77	123	0.004	<1	3.81	0.010	0.10	<0.1	0.02	10.4	<0.1	<0.05	9	<0.5	<0.2
REP PFBR-07	QC	0.094	10	32	2.83	118	0.004	<1	3.91	0.010	0.11	<0.1	0.02	10.4	<0.1	<0.05	9	<0.5	<0.2
Core Reject Duplicates																			
PFBR-12	Rock	0.192	9	20	0.40	297	0.004	<1	0.93	0.018	0.32	<0.1	0.13	2.6	0.3	0.39	3	3.3	0.4
DUP PFBR-12	QC	0.213	10	21	0.44	321	0.005	<1	1.03	0.020	0.37	<0.1	0.13	2.9	0.4	0.44	3	3.8	0.5
Reference Materials																			
STD BVGEO01	Standard	0.068	24	175	1.24	249	0.221	3	2.25	0.184	0.84	4.9	0.09	5.5	0.6	0.65	7	5.1	1.0
STD BVGEO01	Standard	0.070	24	181	1.26	269	0.222	4	2.22	0.187	0.88	4.9	0.09	5.5	0.6	0.60	6	4.8	1.0
STD OREAS262	Standard	0.037	15	42	1.17	236	0.002	4	1.28	0.066	0.30	0.2	0.17	3.0	0.4	0.26	4	<0.5	0.2
STD BVGEO01 Expected		0.0727	25.9	187	1.3175	260	0.233	3.8	2.2628	0.1924	0.8669	5.3	0.1	5.97	0.62	0.6655	7.37	4.84	1.02
STD OREAS262 Expected		0.04	15.9	41.7	1.17	248	0.0027	4	1.3	0.071	0.312	0.2	0.17	3.24	0.47	0.253	4.1	0.4	0.23
BLK	Blank	<0.001	<1	<1	<0.01	<1	<0.001	<1	<0.01	<0.001	<0.01	<0.1	<0.01	<0.1	<0.1	<0.05	<1	<0.5	<0.2
BLK	Blank	<0.001	<1	<1	<0.01	<1	<0.001	<1	<0.01	<0.001	<0.01	<0.1	<0.01	<0.1	<0.1	<0.05	<1	<0.5	<0.2
Prep Wash																			
ROCK-WHI	Prep Blank	0.035	5	7	0.39	44	0.069	1	0.75	0.070	0.07	<0.1	<0.01	2.0	<0.1	<0.05	3	<0.5	<0.2
ROCK-WHI	Prep Blank	0.039	6	12	0.42	52	0.080	1	0.82	0.083	0.08	0.1	<0.01	2.3	<0.1	<0.05	4	<0.5	<0.2



**BUREAU
VERITAS**

MINERAL LABORATORIES
Canada

www.bvna.com/mining-laboratory-services

Bureau Veritas Commodities Canada Ltd.
9050 Shaughnessy St Vancouver British Columbia V6P 6E5 Canada
PHONE (604) 253-3158

Client: Kreft, Bernie
1 Locust Place
Whitehorse Yukon Y1A 5G9 Canada

Submitted By: Bernie Kreft
Receiving Lab: Canada-Whitehorse
Received: July 28, 2023
Analysis Start: August 14, 2023
Report Date: August 17, 2023
Page: 1 of 2

CERTIFICATE OF ANALYSIS

WHI23000258.1

CLIENT JOB INFORMATION

Project: NA
Shipment ID:
P.O. Number
Number of Samples: 29

SAMPLE DISPOSAL

DISP-PLP Dispose of Pulp After 90 days
DISP-RJT-SOIL Immediate Disposal of Soil Reject

Bureau Veritas does not accept responsibility for samples left at the laboratory after 90 days without prior written instructions for sample storage or return.

Invoice To: Kreft, Bernie
1 Locust Place
Whitehorse Yukon Y1A 5G9
Canada

CC:

SAMPLE PREPARATION AND ANALYTICAL PROCEDURES

Procedure Code	Number of Samples	Code Description	Test Wgt (g)	Report Status	Lab
DY060	29	Dry at 60C			WHI
SS80	29	Dry at 60C sieve 100g to -80 mesh			WHI
AQ201	29	1:1:1 Aqua Regia digestion ICP-MS analysis	15	Completed	VAN
DISPL	29	Disposal of pulps			VAN
SHP01	29	Per sample shipping charges for branch shipments			VAN

ADDITIONAL COMMENTS



This report supersedes all previous preliminary and final reports with this file number dated prior to the date on this certificate. Signature indicates final approval; preliminary reports are unsigned and should be used for reference only. All results are considered the confidential property of the client. Bureau Veritas assumes the liabilities for actual cost of analysis only. Results apply to samples as submitted.
*** asterisk indicates that an analytical result could not be provided due to unusually high levels of interference from other elements.



Bureau Veritas Commodities Canada Ltd.

9050 Shaughnessy St Vancouver British Columbia V6P 6E5 Canada
PHONE (604) 253-3158

Project: NA
Report Date: August 17, 2023

Page: 2 of 2

Part: 1 of 2

CERTIFICATE OF ANALYSIS

WHI23000258.1

Method	Analyte	AQ201	AQ201	AQ201	AQ201	AQ201	AQ201	AQ201	AQ201	AQ201	AQ201	AQ201	AQ201	AQ201	AQ201	AQ201	AQ201	AQ201	AQ201	AQ201	AQ201
		Mo	Cu	Pb	Zn	Ag	Ni	Co	Mn	Fe	As	U	Au	Th	Sr	Cd	Sb	Bi	V	Ca	P
Unit		ppm	ppm	ppm	ppm	ppm	ppm	ppm	ppm	%	ppm	ppm	ppm	ppm	ppm	ppm	ppm	ppm	%	%	
MDL		0.1	0.1	0.1	1	0.1	0.1	0.1	1	0.01	0.5	0.1	0.5	0.1	1	0.1	0.1	2	0.01	0.001	
PFBD-01	Soil	2.1	975.5	62.1	163	1.7	10.1	11.2	170	4.42	8.0	2.4	71.3	6.7	26	1.2	0.4	6.1	18	0.15	0.048
PFBD-02	Soil	3.6	464.4	189.7	145	3.0	11.7	8.6	211	5.90	18.0	1.5	138.4	5.3	37	0.1	0.6	7.3	34	0.22	0.056
PFBD-03	Soil	1.0	15.2	24.6	28	0.2	5.3	3.7	65	2.64	8.6	1.1	1.4	21.3	37	<0.1	0.7	0.2	17	0.02	0.035
FPD-01	Soil	0.5	13.7	9.2	41	<0.1	10.6	5.1	190	1.65	4.5	1.3	1.8	5.8	16	<0.1	0.5	0.1	24	0.16	0.010
FPD-02	Soil	0.5	11.5	14.2	39	<0.1	7.5	5.9	302	1.39	3.1	1.2	1.2	14.4	11	<0.1	0.3	0.1	15	0.06	0.015
FPD-03	Soil	0.4	12.0	14.1	40	<0.1	7.0	5.2	145	1.52	3.2	1.3	1.2	14.9	9	<0.1	0.3	0.1	12	0.06	0.009
FPD-04	Soil	0.4	102.8	15.8	122	0.2	15.3	15.6	1073	4.02	3.6	0.5	3.5	3.7	10	0.4	0.3	0.1	62	0.36	0.079
FPD-05	Soil	0.9	53.4	10.7	71	0.1	11.2	6.3	296	2.63	11.6	1.3	1.8	6.6	10	<0.1	0.5	1.1	20	0.19	0.041
FPD-06	Soil	0.3	117.3	13.2	118	<0.1	10.6	10.1	872	1.97	1.7	0.4	3.8	15.6	10	0.2	0.3	0.1	22	0.19	0.034
FPD-07	Soil	0.5	194.0	10.7	163	<0.1	29.1	23.3	1998	4.43	1.5	0.5	3.4	3.4	17	0.2	0.3	0.1	121	1.18	0.037
FPD-08	Soil	0.6	91.3	38.9	75	0.3	10.4	12.3	594	2.20	1.4	0.5	6.3	14.4	13	0.4	0.1	0.6	19	0.71	0.057
FPD-09	Soil	1.5	39.8	34.1	72	0.2	11.1	5.8	307	2.77	17.1	1.8	6.1	11.5	33	<0.1	0.8	0.3	31	0.18	0.047
FPD-10	Soil	3.1	43.1	84.2	57	0.3	3.7	3.3	172	3.41	12.6	1.3	5.4	12.2	41	<0.1	0.7	1.2	16	0.08	0.080
FPD-11	Soil	1.5	86.2	42.2	99	0.3	5.9	4.4	179	4.05	15.2	2.5	10.1	14.0	49	<0.1	0.4	0.6	15	0.17	0.091
FPD-12	Soil	0.8	48.1	12.4	60	<0.1	20.6	11.7	528	2.96	7.7	0.8	2.8	4.9	18	0.1	0.5	0.4	49	1.15	0.028
FPD-13	Soil	<0.1	53.4	1.5	56	<0.1	19.5	27.8	814	3.72	1.4	0.1	1.1	0.6	12	<0.1	0.2	<0.1	66	0.68	0.027
FPD-14	Soil	0.9	123.6	8.7	55	0.3	12.1	8.7	229	2.69	8.4	0.5	0.8	6.0	7	<0.1	0.4	0.4	40	0.07	0.021
FPD-15	Soil	0.1	11.9	35.9	63	<0.1	4.4	6.0	298	1.46	0.9	1.1	1.3	23.2	18	0.2	0.2	0.6	5	2.11	0.056
FPD-16	Soil	2.1	54.7	28.3	205	<0.1	12.2	9.2	716	2.54	8.2	2.2	6.6	22.6	5	1.9	0.5	0.7	6	0.10	0.048
FPD-17	Soil	0.7	30.0	11.7	85	<0.1	6.8	3.1	277	2.50	7.8	1.4	1.5	4.0	4	<0.1	0.3	0.2	5	0.04	0.028
FPD-18	Soil	0.7	184.2	18.4	30	0.1	3.5	9.9	786	0.36	2.4	2.3	4.6	32.1	5	0.3	0.2	0.3	2	0.03	0.008
FPD-19	Soil	1.2	162.1	44.3	220	0.3	8.2	21.5	1376	1.44	8.1	4.3	9.9	26.0	10	1.8	0.4	0.6	3	0.07	0.028
FPD-20	Soil	1.5	16.1	59.1	48	0.3	4.6	1.6	53	3.58	3.9	1.7	3.9	15.6	51	<0.1	0.4	0.3	5	0.07	0.033
FPD-21	Soil	1.7	7.0	15.9	7	0.2	2.8	2.8	52	1.73	2.3	3.0	3.4	8.8	32	<0.1	0.4	0.5	5	0.02	0.022
FPD-22	Soil	1.9	265.4	9.1	29	0.6	1.6	3.8	107	3.91	18.3	1.1	22.0	4.9	15	<0.1	0.2	1.2	2	0.10	0.018
FPD-23	Soil	1.0	117.6	15.1	194	0.2	4.4	11.0	720	2.01	7.1	1.0	9.4	10.0	12	1.5	0.3	0.2	3	0.14	0.026
FPD-24	Soil	0.6	55.3	74.5	227	0.2	13.2	10.9	596	2.59	16.4	0.6	4.1	10.8	15	0.5	0.4	0.9	16	0.89	0.047
FPD-25	Soil	0.7	43.6	86.1	450	0.3	13.7	13.7	691	2.61	22.9	0.7	4.9	13.8	14	1.2	0.3	0.4	11	0.79	0.083
FPD-26	Soil	0.7	52.8	116.7	458	0.2	9.2	10.4	532	2.18	27.6	0.5	9.3	16.9	10	1.5	0.4	0.2	6	0.26	0.062



Bureau Veritas Commodities Canada Ltd.

9050 Shaughnessy St Vancouver British Columbia V6P 6E5 Canada

PHONE (604) 253-3158

Project: NA
Report Date: August 17, 2023

Page: 2 of 2

Part: 2 of 2

CERTIFICATE OF ANALYSIS

WHI23000258.1

Method	Analyte	AQ201	AQ201	AQ201	AQ201	AQ201	AQ201	AQ201	AQ201	AQ201	AQ201	AQ201	AQ201	AQ201	AQ201	AQ201	AQ201	AQ201
		La	Cr	Mg	Ba	Ti	B	Al	Na	K	W	Hg	Sc	TI	S	Ga	Se	Te
Unit		ppm	ppm	%	ppm	%	ppm	%	%	ppm	ppm	ppm	ppm	%	ppm	ppm	ppm	ppm
MDL		1	1	0.01	1	0.001	1	0.01	0.001	0.01	0.1	0.01	0.1	0.05	1	0.5	0.2	0.2
PFBD-01	Soil	9	21	0.30	294	0.006	1	1.31	0.021	0.33	<0.1	0.25	4.1	0.2	0.63	2	6.4	<0.2
PFBD-02	Soil	14	27	0.42	362	0.014	<1	1.20	0.038	0.26	<0.1	0.93	5.2	0.2	0.51	4	10.7	<0.2
PFBD-03	Soil	36	12	0.09	192	0.008	<1	0.74	0.113	0.10	<0.1	0.05	1.3	<0.1	0.47	1	<0.5	<0.2
FPD-01	Soil	16	18	0.32	433	0.034	<1	0.89	0.007	0.06	<0.1	0.02	3.2	<0.1	<0.05	3	<0.5	<0.2
FPD-02	Soil	33	11	0.32	158	0.027	<1	0.85	0.003	0.05	<0.1	0.01	2.9	<0.1	<0.05	2	<0.5	<0.2
FPD-03	Soil	33	9	0.29	184	0.012	<1	0.71	0.003	0.03	<0.1	0.01	3.8	<0.1	<0.05	2	<0.5	<0.2
FPD-04	Soil	13	14	1.33	247	0.005	<1	2.16	0.005	0.02	<0.1	0.04	13.6	<0.1	<0.05	6	<0.5	<0.2
FPD-05	Soil	14	13	0.18	337	0.008	<1	0.70	0.005	0.04	<0.1	0.03	4.7	<0.1	<0.05	2	<0.5	<0.2
FPD-06	Soil	43	15	0.96	271	0.003	<1	1.26	0.004	0.03	<0.1	0.04	4.2	<0.1	<0.05	3	<0.5	<0.2
FPD-07	Soil	14	75	2.89	190	0.006	<1	2.99	0.004	0.02	<0.1	0.06	22.6	<0.1	<0.05	8	<0.5	<0.2
FPD-08	Soil	39	19	1.10	262	0.002	<1	1.19	0.002	0.06	<0.1	0.04	4.3	<0.1	<0.05	3	<0.5	<0.2
FPD-09	Soil	22	18	0.86	285	0.039	<1	1.23	0.015	0.25	<0.1	0.06	3.2	0.5	0.33	4	0.9	<0.2
FPD-10	Soil	14	8	0.49	243	0.011	<1	0.74	0.047	0.44	<0.1	0.08	1.4	0.4	0.90	2	3.1	0.4
FPD-11	Soil	23	7	0.53	251	0.033	<1	0.82	0.015	0.44	<0.1	0.15	1.8	0.8	0.57	2	2.1	<0.2
FPD-12	Soil	17	24	0.66	314	0.021	<1	1.43	0.010	0.04	0.1	0.03	7.0	<0.1	<0.05	4	<0.5	<0.2
FPD-13	Soil	2	27	2.27	127	0.057	<1	2.51	0.004	0.03	<0.1	0.02	5.0	<0.1	<0.05	6	<0.5	<0.2
FPD-14	Soil	18	27	0.47	277	0.026	<1	1.88	0.006	0.06	0.1	0.01	2.9	0.1	<0.05	5	<0.5	<0.2
FPD-15	Soil	47	3	0.16	271	<0.001	<1	0.42	0.003	0.03	<0.1	0.01	4.7	<0.1	<0.05	<1	<0.5	<0.2
FPD-16	Soil	70	9	0.37	192	0.006	<1	0.68	0.002	0.04	<0.1	0.18	2.5	<0.1	<0.05	1	0.8	<0.2
FPD-17	Soil	6	8	0.43	90	0.003	<1	0.83	0.003	0.03	<0.1	0.01	2.4	<0.1	<0.05	3	<0.5	<0.2
FPD-18	Soil	28	3	0.11	206	0.002	<1	0.33	0.001	0.04	<0.1	0.17	1.0	<0.1	<0.05	<1	<0.5	<0.2
FPD-19	Soil	83	4	0.11	406	<0.001	<1	0.47	0.002	0.05	<0.1	0.20	1.2	<0.1	<0.05	<1	0.6	<0.2
FPD-20	Soil	31	6	0.09	251	<0.001	<1	0.42	0.258	0.19	<0.1	0.08	1.3	<0.1	0.97	2	0.5	<0.2
FPD-21	Soil	14	4	0.01	197	<0.001	<1	0.19	0.075	0.10	<0.1	0.43	1.2	<0.1	0.35	<1	0.8	<0.2
FPD-22	Soil	6	2	0.02	146	<0.001	<1	0.11	0.010	0.36	<0.1	0.05	0.4	<0.1	0.61	<1	0.6	<0.2
FPD-23	Soil	22	2	0.03	257	<0.001	<1	0.16	0.004	0.06	<0.1	0.10	1.2	<0.1	<0.05	<1	<0.5	<0.2
FPD-24	Soil	32	18	0.79	188	0.002	<1	1.22	0.005	0.04	<0.1	0.05	3.1	<0.1	<0.05	3	<0.5	<0.2
FPD-25	Soil	39	12	0.64	188	<0.001	<1	1.16	0.004	0.04	<0.1	0.07	2.5	<0.1	<0.05	3	<0.5	<0.2
FPD-26	Soil	46	5	0.33	131	0.001	<1	0.75	0.004	0.03	<0.1	0.08	2.3	<0.1	<0.05	2	0.5	<0.2



Bureau Veritas Commodities Canada Ltd.
9050 Shaughnessy St Vancouver British Columbia V6P 6E5 Canada
PHONE (604) 253-3158

QUALITY CONTROL REPORT

WHI23000258.1

Method	AQ201	AQ201	AQ201	AQ201	AQ201	AQ201	AQ201	AQ201	AQ201	AQ201	AQ201	AQ201	AQ201	AQ201	AQ201	AQ201	AQ201	AQ201	AQ201	AQ201	AQ201
Analyte	Mo	Cu	Pb	Zn	Ag	Ni	Co	Mn	Fe	As	U	Au	Th	Sr	Cd	Sb	Bi	V	Ca	P	
Unit	ppm	ppm	ppm	ppm	ppm	ppm	ppm	ppm	%	ppm	ppm	ppb	ppm	ppm	ppm	ppm	ppm	ppm	%	%	
MDL	0.1	0.1	0.1	1	0.1	0.1	0.1	1	0.01	0.5	0.1	0.5	0.1	1	0.1	0.1	0.1	2	0.01	0.001	
Pulp Duplicates																					
FPD-02	Soil	0.5	11.5	14.2	39	<0.1	7.5	5.9	302	1.39	3.1	1.2	1.2	14.4	11	<0.1	0.3	0.1	15	0.06	0.015
REP FPD-02	QC	0.5	11.7	14.3	39	<0.1	7.7	6.1	307	1.46	3.0	1.2	0.9	14.5	12	<0.1	0.3	0.1	15	0.07	0.016
Reference Materials																					
STD DS11	Standard	14.2	147.4	132.6	347	1.7	83.3	14.7	1023	3.21	42.6	2.4	59.7	7.2	63	2.3	8.5	11.1	51	1.03	0.071
STD OREAS262	Standard	0.6	111.8	54.3	151	0.4	63.8	27.7	509	3.28	35.4	1.1	67.6	8.5	34	0.6	5.2	0.9	22	2.82	0.038
STD DS11 Expected		14.6	149	138	345	1.71	77.7	14.2	1055	3.1	42.8	2.59	79	7.65	67.3	2.37	8.74	12.2	50	1.063	0.0701
STD OREAS262 Expected		0.68	118	56	154	0.45	62	26.9	530	3.284	35.8	1.22	65	9.33	36	0.61	5.06	1.03	22.5	2.98	0.04
BLK	Blank	<0.1	<0.1	<0.1	<1	<0.1	<0.1	<0.1	<1	<0.01	<0.5	<0.1	<0.5	<0.1	<1	<0.1	<0.1	<0.1	<2	<0.01	<0.001



Bureau Veritas Commodities Canada Ltd.
9050 Shaughnessy St Vancouver British Columbia V6P 6E5 Canada
PHONE (604) 253-3158

Project: NA
Report Date: August 17, 2023

Page: 1 of 1

Part: 2 of 2

QUALITY CONTROL REPORT

WHI23000258.1

Method	Analyte	AQ201	AQ201	AQ201	AQ201	AQ201	AQ201	AQ201	AQ201	AQ201	AQ201	AQ201	AQ201	AQ201	AQ201	AQ201	AQ201	AQ201
		La	Cr	Mg	Ba	Ti	B	Al	Na	K	W	Hg	Sc	Tl	S	Ga	Se	Te
Unit		ppm	ppm	%	ppm	%	ppm	%	%	%	ppm	ppm	ppm	ppm	%	ppm	ppm	ppm
MDL		1	1	0.01	1	0.001	1	0.01	0.001	0.01	0.1	0.01	0.1	0.05	1	0.5	0.2	
Pulp Duplicates																		
FPD-02	Soil	33	11	0.32	158	0.027	<1	0.85	0.003	0.05	<0.1	0.01	2.9	<0.1	<0.05	2	<0.5	<0.2
REP FPD-02	QC	33	11	0.32	160	0.028	<1	0.90	0.004	0.05	<0.1	<0.01	3.0	<0.1	<0.05	2	<0.5	<0.2
Reference Materials																		
STD DS11	Standard	18	60	0.85	374	0.093	7	1.12	0.072	0.39	3.0	0.25	3.0	4.7	0.36	5	2.5	4.8
STD OREAS262	Standard	16	41	1.10	229	0.003	4	1.22	0.062	0.27	0.2	0.17	3.0	0.5	0.35	4	0.6	0.3
STD DS11 Expected		18.6	61.5	0.85	385	0.0976		1.1795	0.0762	0.4	2.9	0.26	3.4	4.9	0.2835	5.1	2.2	4.56
STD OREAS262 Expected		15.9	41.7	1.17	248	0.0027	4	1.3	0.071	0.312	0.2	0.17	3.24	0.47	0.253	4.1	0.4	0.23
BLK	Blank	<1	<1	<0.01	<1	<0.001	<1	<0.01	<0.001	<0.01	<0.1	<0.01	<0.1	<0.1	<0.05	<1	<0.5	<0.2



**BUREAU
VERITAS**

MINERAL LABORATORIES
Canada

www.bvna.com/mining-laboratory-services

Bureau Veritas Commodities Canada Ltd.

9050 Shaughnessy St Vancouver British Columbia V6P 6E5 Canada

PHONE (604) 253-3158

Client: Kreft, Bernie

1 Locust Place

Whitehorse Yukon Y1A 5G9 Canada

Submitted By: Bernie Kreft

Receiving Lab: Canada-Whitehorse

Received: September 12, 2023

Analysis Start: September 15, 2023

Report Date: September 27, 2023

Page: 1 of 2

CERTIFICATE OF ANALYSIS

WHI23000604.1

CLIENT JOB INFORMATION

Project: NA
Shipment ID:
P.O. Number
Number of Samples: 23

SAMPLE DISPOSAL

DISP-PLP Dispose of Pulp After 90 days
DISP-RJT Dispose of Reject After 60 days

Bureau Veritas does not accept responsibility for samples left at the laboratory after 90 days without prior written instructions for sample storage or return.

Invoice To: Kreft, Bernie
1 Locust Place
Whitehorse Yukon Y1A 5G9
Canada

CC:

SAMPLE PREPARATION AND ANALYTICAL PROCEDURES

Procedure Code	Number of Samples	Code Description	Test Wgt (g)	Report Status	Lab
PRP70-250	23	Crush, split and pulverize 250 g rock to 200 mesh			WHI
AQ201	23	1:1:1 Aqua Regia digestion ICP-MS analysis	15	Completed	VAN
SHP01	23	Per sample shipping charges for branch shipments			VAN

ADDITIONAL COMMENTS



This report supersedes all previous preliminary and final reports with this file number dated prior to the date on this certificate. Signature indicates final approval; preliminary reports are unsigned and should be used for reference only. All results are considered the confidential property of the client. Bureau Veritas assumes the liabilities for actual cost of analysis only. Results apply to samples as submitted. *** asterisk indicates that an analytical result could not be provided due to unusually high levels of interference from other elements.



Bureau Veritas Commodities Canada Ltd.

9050 Shaughnessy St Vancouver British Columbia V6P 6E5 Canada
PHONE (604) 253-3158

Project: NA
Report Date: September 27, 2023

Page: 2 of 2

Part: 1 of 2

CERTIFICATE OF ANALYSIS

WHI23000604.1

Method	Analyte	WGHT	AQ201	AQ201	AQ201	AQ201	AQ201	AQ201	AQ201	AQ201	AQ201	AQ201	AQ201	AQ201	AQ201	AQ201	AQ201	AQ201	AQ201	AQ201	AQ201
			Mo	Cu	Pb	Zn	Ag	Ni	Co	Mn	Fe	As	U	Au	Th	Sr	Cd	Sb	Bi	V	Ca
Unit		kg	ppm	ppm	ppm	ppm	ppm	ppm	ppm	ppm	ppm	ppm	ppm	ppm	ppb	ppm	ppm	ppm	ppm	ppm	ppm
MDL		0.01	0.1	0.1	0.1	1	0.1	0.1	0.1	0.1	1	0.01	0.5	0.1	0.5	0.1	1	0.1	0.1	0.1	0.1
BKPU-01	Rock	0.56	0.8	225.4	14.3	623	1.4	4.5	1.4	760	9.61	39.8	1.1	4.1	4.3	10	1.6	<0.1	7.2	5	0.27
BKPU-02	Rock	0.51	1.4	42.7	11.4	747	0.2	5.3	3.4	851	2.38	5.9	0.3	1.3	6.2	3	1.9	0.2	1.4	2	0.04
BKPU-03	Rock	1.20	1.1	367.3	18.1	691	0.8	4.7	1.8	705	10.95	47.9	0.9	6.4	4.5	12	2.4	<0.1	7.8	5	0.32
BKPU-04	Rock	1.08	120.4	639.3	42.3	34	3.3	2.1	7.1	164	12.05	35.2	1.1	218.8	0.8	13	0.1	0.1	0.9	62	0.34
BKPU-05	Rock	0.53	1.2	242.0	56.1	95	0.1	5.3	20.7	1091	6.03	0.6	0.1	0.7	1.6	13	0.3	<0.1	0.2	76	0.90
BKPU-06	Rock	1.10	1.2	171.0	9.1	853	0.1	51.6	30.4	3337	5.68	1.0	0.3	3.0	0.3	10	1.8	<0.1	<0.1	111	2.67
BKPU-07	Rock	1.15	1.0	164.5	30.9	157	<0.1	18.7	21.0	2449	5.02	1.4	0.3	1.5	1.4	14	0.6	<0.1	0.1	55	2.58
BKPU-08	Rock	0.98	0.8	420.1	15.9	202	0.2	12.7	16.6	1964	4.51	1.8	0.2	4.1	1.2	12	1.1	<0.1	0.2	62	0.71
BKPU-09	Rock	0.76	12.6	58.9	38.8	9	0.8	2.4	0.4	59	3.77	24.8	0.6	8.7	5.0	8	<0.1	0.2	8.0	11	0.05
BKPU-10	Rock	1.08	8.0	300.4	253.2	644	1.3	43.5	31.5	190	11.05	44.7	3.5	12.9	9.8	49	0.2	29.8	3.1	14	0.07
BKPU-11	Rock	0.83	6.1	94.3	339.1	147	1.5	31.1	4.6	498	4.92	9.7	1.8	2.8	8.2	27	0.3	0.3	3.8	34	0.16
BKPU-12	Rock	1.28	2.7	134.9	67.6	122	0.5	29.9	3.6	351	3.70	7.2	1.9	3.9	10.8	21	0.4	0.5	1.4	26	0.11
BKPU-13	Rock	1.08	1.1	17.3	6.3	14	<0.1	2.4	0.7	45	1.18	1.9	0.4	0.5	1.1	5	<0.1	0.1	<0.1	3	<0.01
BKPU-14	Rock	0.87	3.4	289.0	148.0	64	0.5	10.7	2.9	213	9.20	13.8	2.3	4.9	11.4	30	0.1	0.3	2.1	56	0.10
BKPU-15	Rock	0.79	7.2	1127.1	23.9	10	0.5	4.0	6.7	111	11.01	77.3	1.7	3.5	6.1	17	<0.1	0.3	5.0	10	0.03
BKPU-16	Rock	1.08	11.1	627.8	408.6	212	4.1	14.8	8.0	380	4.91	96.3	2.2	41.3	5.1	9	0.2	0.2	3.4	17	0.02
BKPU-17	Rock	0.78	3.4	485.3	37.3	226	1.3	2.9	4.4	383	3.98	74.9	1.8	67.1	15.6	11	0.1	0.4	2.9	4	0.04
BKPU-18	Rock	1.60	2.6	305.2	23.1	251	0.4	13.2	2.8	617	3.57	17.8	2.9	7.1	6.0	24	0.1	0.4	1.0	21	0.09
BKPU-19	Rock	1.09	1.2	201.6	6.6	71	<0.1	6.9	15.0	1249	1.21	1.3	4.6	0.7	1.7	4	0.5	<0.1	<0.1	<1	<0.01
BKPU-20	Rock	0.24	3.4	842.7	53.7	782	<0.1	11.3	13.5	1426	8.46	6.7	31.5	3.1	34.8	32	0.4	0.4	1.1	15	0.10
PJR-01	Rock	0.43	3.2	657.2	58.3	61	0.1	3.8	1.1	125	8.77	2.5	1.0	4.2	8.0	29	4.5	0.1	0.3	19	0.12
PJR-02	Rock	0.81	4.2	67.3	26.4	11	1.9	1.6	0.3	44	4.80	11.5	0.3	94.2	3.2	38	<0.1	0.3	10.5	3	0.02
PJR-03	Rock	0.83	2.3	153.2	49.2	410	0.2	5.1	10.4	1140	1.98	2.8	0.9	11.0	6.2	17	1.7	0.2	0.2	5	0.16



Bureau Veritas Commodities Canada Ltd.

9050 Shaughnessy St Vancouver British Columbia V6P 6E5 Canada
PHONE (604) 253-3158

Project: NA
Report Date: September 27, 2023

Page: 2 of 2

Part: 2 of 2

CERTIFICATE OF ANALYSIS

WHI23000604.1

Method	Analyte	AQ201	AQ201	AQ201	AQ201	AQ201	AQ201	AQ201	AQ201	AQ201	AQ201	AQ201	AQ201	AQ201	AQ201	AQ201	AQ201	AQ201	AQ201	AQ201
		P	La	Cr	Mg	Ba	Ti	B	Al	Na	K	W	Hg	Sc	Tl	S	Ga	Se	Te	
Unit		%	ppm	ppm	%	ppm	%	ppm	%	%	ppm	ppm	ppm	ppm	%	ppm	ppm	ppm		
MDL		0.001	1	1	0.01	1	0.001	1	0.01	0.001	0.01	0.01	0.1	0.01	0.1	0.1	0.05	1	0.5	0.2
BKPU-01	Rock	0.009	13	5	2.93	499	0.011	<1	4.22	0.003	<0.01	<0.1	0.02	5.7	<0.1	<0.05	14	1.1	<0.2	
BKPU-02	Rock	0.011	13	7	0.99	183	0.001	<1	1.26	0.046	0.09	<0.1	0.54	4.4	<0.1	<0.05	3	<0.5	<0.2	
BKPU-03	Rock	0.010	14	4	2.67	654	0.009	<1	3.76	0.002	<0.01	<0.1	0.04	5.6	<0.1	<0.05	13	1.5	<0.2	
BKPU-04	Rock	0.059	5	12	0.16	263	0.008	<1	0.58	0.009	0.09	<0.1	0.28	6.7	<0.1	0.08	5	11.5	1.4	
BKPU-05	Rock	0.104	6	9	2.45	54	0.004	<1	3.53	0.030	0.06	<0.1	0.02	8.7	<0.1	<0.05	10	<0.5	<0.2	
BKPU-06	Rock	0.033	3	109	4.25	478	0.008	<1	4.06	0.023	0.05	<0.1	0.03	23.5	<0.1	<0.05	9	<0.5	<0.2	
BKPU-07	Rock	0.073	8	29	2.37	658	0.002	<1	3.03	0.014	0.14	<0.1	0.01	9.1	<0.1	<0.05	7	<0.5	<0.2	
BKPU-08	Rock	0.078	8	18	2.06	201	0.002	<1	2.78	0.026	0.10	<0.1	0.08	5.9	<0.1	<0.05	7	<0.5	<0.2	
BKPU-09	Rock	0.041	12	18	0.08	195	0.006	<1	0.46	0.020	0.52	0.2	0.06	0.8	0.5	0.70	1	14.4	1.1	
BKPU-10	Rock	0.148	15	10	0.08	161	0.002	<1	0.78	0.103	0.39	<0.1	0.26	2.2	0.3	0.57	<1	4.7	0.9	
BKPU-11	Rock	0.083	16	57	1.26	466	0.005	<1	1.38	0.021	0.23	<0.1	0.18	2.8	0.1	0.08	5	4.4	1.1	
BKPU-12	Rock	0.058	23	59	0.84	489	0.004	<1	1.10	0.025	0.27	<0.1	0.04	3.0	0.1	0.06	3	3.1	0.3	
BKPU-13	Rock	0.021	2	10	0.04	462	0.001	<1	0.14	0.006	0.05	<0.1	0.02	0.2	<0.1	<0.05	<1	0.6	<0.2	
BKPU-14	Rock	0.123	7	43	0.53	290	0.009	<1	1.05	0.023	0.30	<0.1	0.12	2.1	0.1	0.33	5	6.3	0.7	
BKPU-15	Rock	0.049	11	17	0.09	204	0.002	<1	0.60	0.027	0.18	<0.1	0.01	2.2	<0.1	0.12	3	7.2	0.3	
BKPU-16	Rock	0.049	11	34	0.90	681	0.003	<1	1.41	0.006	0.18	<0.1	0.37	2.7	<0.1	0.07	4	6.2	0.2	
BKPU-17	Rock	0.009	38	8	0.98	1153	0.002	<1	1.47	0.008	0.23	<0.1	0.04	1.0	<0.1	<0.05	4	2.0	<0.2	
BKPU-18	Rock	0.049	19	40	1.36	433	0.005	<1	1.82	0.008	0.22	<0.1	0.11	3.4	<0.1	0.20	4	0.7	<0.2	
BKPU-19	Rock	0.007	3	8	0.04	337	<0.001	<1	0.54	0.002	0.03	<0.1	0.01	0.5	<0.1	<0.05	<1	<0.5	<0.2	
BKPU-20	Rock	0.071	34	47	4.72	435	0.096	<1	4.76	0.010	0.15	<0.1	0.05	4.7	<0.1	0.19	11	1.8	<0.2	
PJR-01	Rock	0.113	4	43	0.09	969	<0.001	<1	0.66	0.011	0.18	<0.1	0.16	2.8	<0.1	0.10	6	2.2	<0.2	
PJR-02	Rock	0.024	4	17	0.03	94	0.002	2	0.23	0.050	0.96	0.1	0.31	0.7	0.6	1.70	2	17.3	<0.2	
PJR-03	Rock	0.036	10	15	0.12	948	<0.001	<1	0.52	0.012	0.16	<0.1	1.09	2.0	<0.1	0.06	1	0.5	<0.2	



Bureau Veritas Commodities Canada Ltd.
9050 Shaughnessy St Vancouver British Columbia V6P 6E5 Canada
PHONE (604) 253-3158

Project: NA
Report Date: September 27, 2023

Page: 1 of 1 Part: 1 of 2

QUALITY CONTROL REPORT

WHI23000604.1

Method	WGHT	AQ201	AQ201	AQ201	AQ201	AQ201	AQ201	AQ201	AQ201	AQ201	AQ201	AQ201	AQ201	AQ201	AQ201	AQ201	AQ201	AQ201	AQ201	AQ201	AQ201
Analyte	Wgt	Mo	Cu	Pb	Zn	Ag	Ni	Co	Mn	Fe	As	U	Au	Th	Sr	Cd	Sb	Bi	V	Ca	
Unit	kg	ppm	ppm	ppm	ppm	ppm	ppm	ppm	ppm	%	ppm	ppm	ppb	ppm	ppm	ppm	ppm	ppm	ppm	%	
MDL	0.01	0.1	0.1	0.1	1	0.1	0.1	0.1	1	0.01	0.5	0.1	0.5	0.1	1	0.1	0.1	0.1	1	0.01	
Pulp Duplicates																					
BKPU-03	Rock	1.20	1.1	367.3	18.1	691	0.8	4.7	1.8	705	10.95	47.9	0.9	6.4	4.5	12	2.4	<0.1	7.8	5	0.32
REP BKPU-03	QC		1.1	374.8	18.0	708	0.9	4.9	1.8	714	11.08	48.7	0.9	5.5	4.5	13	2.5	<0.1	7.7	5	0.32
Core Reject Duplicates																					
BKPU-13	Rock	1.08	1.1	17.3	6.3	14	<0.1	2.4	0.7	45	1.18	1.9	0.4	0.5	1.1	5	<0.1	0.1	<0.1	3	<0.01
DUP BKPU-13	QC		1.0	16.3	6.4	13	<0.1	2.2	0.7	49	1.25	1.9	0.4	<0.5	1.2	5	<0.1	0.1	<0.1	3	<0.01
Reference Materials																					
STD BVGEO01	Standard		10.2	4396.7	189.0	1723	2.5	159.9	24.5	731	3.72	125.0	3.6	212.7	14.4	54	6.2	3.0	24.6	72	1.32
STD OREAS262	Standard		0.6	113.6	58.0	157	0.4	64.3	27.0	546	3.29	35.9	1.2	60.2	9.3	34	0.6	4.6	1.0	21	2.92
STD BVGEO01 Expected			11.2	4415	187	1712	2.53	163	25	706	3.7	121	3.67	214	14.4	55	6.25	3.39	24.3	73	1.3219
STD OREAS262 Expected			0.68	118	56	154	0.45	62	26.9	530	3.284	35.8	1.22	65	9.33	36	0.61	5.06	1.03	22.5	2.98
BLK	Blank		<0.1	<0.1	<0.1	<1	<0.1	<0.1	<0.1	<1	<0.01	<0.5	<0.1	<0.5	<0.1	<1	<0.1	<0.1	<0.1	<1	<0.01
Prep Wash																					
ROCK-WHI	Prep Blank		2.0	3.3	1.0	27	<0.1	1.9	3.3	457	1.80	0.8	0.4	0.5	2.3	21	<0.1	<0.1	<0.1	20	0.62
ROCK-WHI	Prep Blank		1.9	3.5	0.9	27	<0.1	1.9	3.4	457	1.77	0.9	0.4	<0.5	2.2	21	<0.1	<0.1	<0.1	21	0.62



Bureau Veritas Commodities Canada Ltd.
9050 Shaughnessy St Vancouver British Columbia V6P 6E5 Canada
PHONE (604) 253-3158

Project: NA
Report Date: September 27, 2023

Page: 1 of 1

Part: 2 of 2

QUALITY CONTROL REPORT

WHI23000604.1

Method	AQ201	AQ201	AQ201	AQ201	AQ201	AQ201	AQ201	AQ201	AQ201	AQ201	AQ201	AQ201	AQ201	AQ201	AQ201	AQ201	AQ201	AQ201	AQ201
Analyte	P	La	Cr	Mg	Ba	Ti	B	Al	Na	K	W	Hg	Sc	Tl	S	Ga	Se	Te	
Unit	%	ppm	ppm	%	ppm	%	ppm	%	%	%	ppm	ppm	ppm	ppm	%	ppm	ppm	ppm	
MDL	0.001	1	1	0.01	1	0.001	1	0.01	0.001	0.01	0.1	0.01	0.1	0.1	0.05	1	0.5	0.2	
Pulp Duplicates																			
BKPU-03	Rock	0.010	14	4	2.67	654	0.009	<1	3.76	0.002	<0.01	<0.1	0.04	5.6	<0.1	<0.05	13	1.5	<0.2
REP BKPU-03	QC	0.011	14	4	2.73	660	0.009	<1	3.79	0.002	<0.01	<0.1	0.04	5.7	<0.1	<0.05	14	1.5	<0.2
Core Reject Duplicates																			
BKPU-13	Rock	0.021	2	10	0.04	462	0.001	<1	0.14	0.006	0.05	<0.1	0.02	0.2	<0.1	<0.05	<1	0.6	<0.2
DUP BKPU-13	QC	0.021	2	8	0.04	490	0.001	<1	0.14	0.006	0.05	<0.1	0.03	0.2	<0.1	<0.05	<1	0.6	<0.2
Reference Materials																			
STD BVGEO01	Standard	0.075	26	183	1.32	258	0.227	4	2.32	0.193	0.89	4.7	0.10	5.7	0.6	0.68	7	4.7	1.1
STD OREAS262	Standard	0.041	16	42	1.19	249	0.002	4	1.28	0.069	0.30	0.2	0.16	3.1	0.5	0.27	4	<0.5	0.2
STD BVGEO01 Expected		0.0727	25.9	187	1.3175	260	0.233	3.8	2.2628	0.1924	0.8669	5.3	0.1	5.97	0.62	0.6655	7.37	4.84	1.02
STD OREAS262 Expected		0.04	15.9	41.7	1.17	248	0.0027	4	1.3	0.071	0.312	0.2	0.17	3.24	0.47	0.253	4.1	0.4	0.23
BLK	Blank	<0.001	<1	<1	<0.01	<1	<0.001	<1	<0.01	<0.001	<0.01	<0.1	<0.01	<0.1	<0.1	<0.05	<1	<0.5	<0.2
Prep Wash																			
ROCK-WHI	Prep Blank	0.039	6	9	0.43	55	0.069	1	0.97	0.164	0.11	<0.1	<0.01	2.2	<0.1	<0.05	4	<0.5	<0.2
ROCK-WHI	Prep Blank	0.041	6	9	0.43	49	0.073	1	0.94	0.142	0.10	0.1	<0.01	2.3	<0.1	<0.05	3	<0.5	<0.2



BUREAU VERITAS
MINERAL LABORATORIES
Canada

www.bvna.com/mining-laboratory-services

Bureau Veritas Commodities Canada Ltd.
9050 Shaughnessy St Vancouver British Columbia V6P 6E5 Canada
PHONE (604) 253-3158

Client: **Kreft, Bernie**
1 Locust Place
Whitehorse Yukon Y1A 5G9 Canada

Submitted By: Bernie Kreft
Receiving Lab: Canada-Whitehorse
Received: September 12, 2023
Analysis Start: September 15, 2023
Report Date: September 26, 2023
Page: 1 of 2

CERTIFICATE OF ANALYSIS

WHI23000607.1

CLIENT JOB INFORMATION

Project: NA
Shipment ID:
P.O. Number
Number of Samples: 28

SAMPLE DISPOSAL

DISP-PLP Dispose of Pulp After 90 days
DISP-RJT-SOIL Immediate Disposal of Soil Reject

Bureau Veritas does not accept responsibility for samples left at the laboratory after 90 days without prior written instructions for sample storage or return.

Invoice To: Kreft, Bernie
1 Locust Place
Whitehorse Yukon Y1A 5G9
Canada

CC:

SAMPLE PREPARATION AND ANALYTICAL PROCEDURES

Procedure Code	Number of Samples	Code Description	Test Wgt (g)	Report Status	Lab
DY060	28	Dry at 60C			WHI
SS80	28	Dry at 60C sieve 100g to -80 mesh			WHI
DISPL	28	Disposal of pulps			VAN
SHP01	28	Per sample shipping charges for branch shipments			VAN
AQ201	28	1:1:1 Aqua Regia digestion ICP-MS analysis	15	Completed	VAN

ADDITIONAL COMMENTS

JEFFREY CANNON
Geochemistry Department Supervisor

This report supersedes all previous preliminary and final reports with this file number dated prior to the date on this certificate. Signature indicates final approval; preliminary reports are unsigned and should be used for reference only. All results are considered the confidential property of the client. Bureau Veritas assumes the liabilities for actual cost of analysis only. Results apply to samples as submitted.
*** asterisk indicates that an analytical result could not be provided due to unusually high levels of interference from other elements.



Bureau Veritas Commodities Canada Ltd.

9050 Shaughnessy St Vancouver British Columbia V6P 6E5 Canada
PHONE (604) 253-3158

Project: NA
Report Date: September 26, 2023

Page: 2 of 2

Part: 1 of 2

CERTIFICATE OF ANALYSIS

WHI23000607.1

Method	Analyte	AQ201	AQ201	AQ201	AQ201	AQ201	AQ201	AQ201	AQ201	AQ201	AQ201	AQ201	AQ201	AQ201	AQ201	AQ201	AQ201	AQ201	AQ201	AQ201	AQ201
		Mo	Cu	Pb	Zn	Ag	Ni	Co	Mn	Fe	As	U	Au	Th	Sr	Cd	Sb	Bi	V	Ca	P
Unit		ppm	ppm	ppm	ppm	ppm	ppm	ppm	ppm	%	ppm	ppm	ppm	ppm	ppm	ppm	ppm	ppm	%	%	
MDL		0.1	0.1	0.1	1	0.1	0.1	0.1	1	0.01	0.5	0.1	0.5	0.1	1	0.1	0.1	2	0.01	0.001	
CPUD-01	Soil	1.4	39.4	20.6	118	0.2	10.9	9.0	771	2.98	11.8	1.4	2.0	10.4	13	0.4	0.5	0.9	19	0.30	0.062
CPUD-02	Soil	0.9	37.2	11.6	67	0.1	13.4	6.3	226	2.11	7.4	1.1	2.3	6.7	15	0.1	0.7	0.6	32	0.19	0.020
CPUD-03	Soil	0.7	77.5	11.4	74	<0.1	5.9	3.3	425	2.57	7.9	1.1	2.4	8.8	12	0.2	0.4	2.2	14	0.17	0.022
CPUD-04	Soil	0.7	154.9	9.7	114	0.1	22.0	14.4	682	3.81	4.4	0.7	4.5	4.3	11	<0.1	0.5	0.1	73	0.13	0.011
CPUD-05	Soil	0.7	259.1	10.0	476	0.1	24.6	21.1	2624	3.97	2.7	0.4	3.9	3.5	8	1.3	0.3	0.1	85	0.23	0.055
CPUD-06	Soil	0.6	143.9	21.0	156	<0.1	25.1	16.1	775	3.97	4.7	0.5	5.9	3.3	13	0.1	0.5	0.1	80	0.35	0.021
CPUD-07	Soil	1.0	60.5	31.8	83	0.3	14.6	10.9	537	2.90	8.3	1.2	5.9	12.1	34	0.1	0.5	0.4	37	0.44	0.072
CPUD-08	Soil	2.6	142.3	83.7	169	0.4	7.8	4.6	286	4.75	17.2	2.3	14.4	10.4	33	<0.1	0.6	1.9	20	0.26	0.080
CPUD-09	Soil	2.6	68.3	148.2	79	0.5	12.8	3.8	474	4.23	21.4	2.0	7.6	9.4	103	0.2	0.3	3.1	25	0.18	0.101
CPUD-10	Soil	8.7	175.2	94.9	599	2.3	7.5	6.1	140	3.63	3.5	1.4	27.4	11.4	22	0.4	0.6	0.3	17	0.20	0.038
CPUD-11	Soil	1.5	14.1	55.9	39	0.2	4.4	4.0	67	4.08	9.1	1.8	1.0	28.0	67	<0.1	1.2	0.2	13	0.02	0.056
CPUD-12	Soil	1.3	12.7	31.1	20	0.1	7.3	3.4	74	2.63	5.8	0.8	4.6	15.4	29	<0.1	0.5	0.4	27	0.05	0.027
CPUD-13	Soil	1.1	208.4	21.1	62	0.4	6.7	3.0	156	4.00	11.3	3.5	10.6	8.8	49	<0.1	0.3	1.9	23	0.22	0.053
CPUD-14	Soil	1.3	375.9	38.9	169	0.3	7.5	8.0	394	3.01	9.6	2.2	9.5	12.0	20	0.2	0.5	1.5	17	0.05	0.027
CPUD-15	Soil	1.2	211.4	20.1	71	0.3	8.8	4.9	194	2.65	8.8	2.4	10.4	9.7	24	<0.1	0.4	0.9	27	0.13	0.024
PJD-01	Soil	1.1	39.6	27.1	135	0.2	12.8	9.0	643	2.80	13.6	1.5	7.7	9.1	17	0.5	0.6	1.0	24	0.28	0.052
PJD-02	Soil	0.7	38.7	11.3	61	<0.1	13.6	7.1	363	2.12	6.9	1.2	2.4	6.7	15	0.2	0.6	0.6	32	0.19	0.026
PJD-03	Soil	0.9	47.1	17.7	106	<0.1	12.4	8.8	610	3.51	6.8	1.0	2.3	5.8	12	0.3	0.5	0.3	40	0.25	0.061
PJD-04	Soil	0.9	197.0	16.2	459	0.2	4.6	4.0	989	2.55	4.2	1.5	0.6	9.4	5	2.2	0.3	3.3	2	0.06	0.007
PJD-05	Soil	0.4	192.5	13.2	79	0.1	2.0	3.7	932	3.19	10.2	1.7	1.1	10.3	9	0.8	0.1	6.8	3	0.17	0.036
PJD-06	Soil	1.5	247.9	32.6	377	0.3	24.0	24.9	2748	4.41	5.9	0.8	8.9	6.2	15	1.0	0.4	0.2	56	0.27	0.057
PJD-07	Soil	0.5	132.6	13.1	166	<0.1	17.5	12.8	997	2.79	2.2	0.8	3.2	13.6	10	0.1	0.4	0.1	39	0.19	0.035
PJD-08	Soil	1.0	86.1	22.4	92	0.1	28.0	14.7	747	3.36	8.8	0.5	4.3	4.1	20	0.2	0.7	0.2	66	0.44	0.051
PJD-09	Soil	2.3	195.4	44.0	154	0.1	30.8	21.5	610	4.09	13.8	5.5	8.3	11.1	83	0.4	0.5	0.5	22	0.20	0.088
PJD-10	Soil	1.6	62.0	38.9	72	0.3	17.7	9.4	418	2.96	12.7	2.1	5.4	7.4	38	0.2	0.7	0.4	37	0.46	0.060
PJD-11	Soil	1.4	15.1	31.5	33	0.2	8.5	4.6	97	3.28	10.0	1.0	3.0	16.7	50	<0.1	1.2	0.3	23	0.04	0.039
PJD-12	Soil	1.2	16.7	15.7	46	<0.1	15.8	7.4	128	2.94	5.8	0.6	1.4	8.7	35	<0.1	0.6	0.2	52	0.21	0.032
PJD-13	Soil	1.1	893.1	87.1	659	0.2	17.7	17.7	770	3.54	6.5	3.0	9.9	10.0	31	1.8	0.8	<0.1	38	0.34	0.067



Bureau Veritas Commodities Canada Ltd.

9050 Shaughnessy St Vancouver British Columbia V6P 6E5 Canada
PHONE (604) 253-3158

Project: NA
Report Date: September 26, 2023

Page: 2 of 2

Part: 2 of 2

CERTIFICATE OF ANALYSIS

WHI23000607.1

Method	Analyte	AQ201	AQ201	AQ201	AQ201	AQ201	AQ201	AQ201	AQ201	AQ201	AQ201	AQ201	AQ201	AQ201	AQ201	AQ201	AQ201	
		La	Cr	Mg	Ba	Ti	B	Al	Na	K	W	Hg	Sc	Tl	S	Ga	Se	Te
Unit		ppm	ppm	%	ppm	%	ppm	%	%	%	ppm	ppm	ppm	%	ppm	ppm	ppm	
MDL		1	1	0.01	1	0.001	1	0.01	0.001	0.01	0.01	0.01	0.1	0.05	1	0.5	0.2	
CPUD-01	Soil	24	10	0.19	304	0.008	<1	0.73	0.007	0.06	<0.1	0.06	4.1	<0.1	<0.05	2	<0.5	<0.2
CPUD-02	Soil	20	20	0.38	597	0.022	<1	1.21	0.007	0.05	0.1	0.05	4.4	<0.1	<0.05	3	<0.5	<0.2
CPUD-03	Soil	29	8	0.43	387	0.009	<1	1.10	0.005	0.04	<0.1	0.02	6.3	<0.1	<0.05	3	<0.5	<0.2
CPUD-04	Soil	15	45	1.93	270	0.016	<1	2.67	0.006	0.03	<0.1	0.04	9.5	<0.1	<0.05	7	<0.5	<0.2
CPUD-05	Soil	15	52	2.38	343	0.010	<1	2.70	0.005	0.02	<0.1	0.20	15.0	<0.1	<0.05	7	<0.5	<0.2
CPUD-06	Soil	12	42	1.41	235	0.021	<1	2.57	0.008	0.03	<0.1	0.08	11.0	<0.1	<0.05	7	<0.5	<0.2
CPUD-07	Soil	29	20	0.95	336	0.032	<1	1.51	0.010	0.14	<0.1	0.05	5.2	0.3	0.07	4	0.6	<0.2
CPUD-08	Soil	12	19	0.87	132	0.011	<1	1.20	0.054	0.56	<0.1	0.27	2.7	0.6	1.05	3	3.9	0.5
CPUD-09	Soil	6	33	1.55	125	0.015	<1	1.34	0.030	0.58	<0.1	0.13	2.8	0.3	0.98	4	7.0	0.9
CPUD-10	Soil	16	12	0.19	515	0.002	<1	0.69	0.028	0.15	<0.1	1.24	4.2	<0.1	0.26	2	1.3	<0.2
CPUD-11	Soil	37	8	0.06	171	0.005	<1	0.75	0.235	0.12	<0.1	0.07	1.1	<0.1	0.88	1	<0.5	<0.2
CPUD-12	Soil	16	15	0.17	279	0.016	<1	0.80	0.102	0.12	0.1	0.04	1.4	<0.1	0.44	2	<0.5	<0.2
CPUD-13	Soil	25	20	0.60	650	0.006	<1	1.60	0.018	0.17	<0.1	0.21	4.1	<0.1	0.23	4	0.6	<0.2
CPUD-14	Soil	43	18	0.71	251	0.006	<1	1.47	0.005	0.11	<0.1	0.52	4.0	<0.1	0.10	3	0.9	<0.2
CPUD-15	Soil	27	19	0.54	456	0.018	<1	1.43	0.008	0.11	<0.1	0.07	3.3	<0.1	0.12	3	0.5	<0.2
PJD-01	Soil	23	14	0.28	337	0.013	<1	0.95	0.008	0.05	<0.1	0.05	4.0	<0.1	<0.05	2	<0.5	<0.2
PJD-02	Soil	21	21	0.39	520	0.024	<1	1.24	0.007	0.05	0.1	0.03	4.4	<0.1	<0.05	3	<0.5	<0.2
PJD-03	Soil	19	13	0.71	430	0.012	<1	1.61	0.006	0.04	<0.1	0.04	8.5	<0.1	<0.05	4	<0.5	<0.2
PJD-04	Soil	13	1	0.03	295	<0.001	<1	0.19	0.003	0.02	<0.1	0.19	9.3	<0.1	<0.05	<1	<0.5	<0.2
PJD-05	Soil	36	<1	0.37	273	<0.001	<1	0.92	0.004	0.04	<0.1	0.02	6.0	<0.1	<0.05	3	<0.5	<0.2
PJD-06	Soil	24	38	2.26	504	0.011	<1	2.49	0.006	0.04	<0.1	0.15	9.8	<0.1	<0.05	6	0.8	<0.2
PJD-07	Soil	35	28	1.24	351	0.007	<1	1.66	0.004	0.04	<0.1	0.07	6.7	<0.1	<0.05	4	<0.5	<0.2
PJD-08	Soil	14	43	1.05	307	0.040	<1	2.07	0.014	0.04	0.1	0.06	7.1	<0.1	<0.05	6	<0.5	<0.2
PJD-09	Soil	21	12	0.59	461	0.005	<1	1.66	0.020	0.23	<0.1	0.08	4.2	0.3	0.36	2	1.1	0.3
PJD-10	Soil	22	21	0.63	355	0.039	<1	1.33	0.015	0.11	0.2	0.09	3.6	0.2	0.07	3	0.8	<0.2
PJD-11	Soil	35	14	0.15	222	0.011	<1	0.89	0.181	0.11	<0.1	0.09	1.9	<0.1	0.66	2	<0.5	<0.2
PJD-12	Soil	20	32	0.52	283	0.045	<1	1.63	0.075	0.08	<0.1	0.03	3.6	<0.1	0.21	4	<0.5	<0.2
PJD-13	Soil	25	33	0.72	673	0.013	<1	2.01	0.014	0.08	<0.1	0.88	9.1	<0.1	<0.05	4	0.6	<0.2



Bureau Veritas Commodities Canada Ltd.
9050 Shaughnessy St Vancouver British Columbia V6P 6E5 Canada
PHONE (604) 253-3158

Project: NA
Report Date: September 26, 2023

Page: 1 of 1 Part: 1 of 2

QUALITY CONTROL REPORT

WHI23000607.1

Method	Analyte	AQ201	AQ201	AQ201	AQ201	AQ201	AQ201	AQ201	AQ201	AQ201	AQ201	AQ201	AQ201	AQ201	AQ201	AQ201	AQ201	AQ201	AQ201	AQ201	AQ201
		Mo	Cu	Pb	Zn	Ag	Ni	Co	Mn	Fe	As	U	Au	Th	Sr	Cd	Sb	Bi	V	Ca	P
Unit		ppm	ppm	ppm	ppm	ppm	ppm	ppm	ppm	%	ppm	ppm	ppb	ppm	ppm	ppm	ppm	ppm	%	%	%
MDL		0.1	0.1	0.1	1	0.1	0.1	0.1	1	0.01	0.5	0.1	0.5	0.1	1	0.1	0.1	0.1	2	0.01	0.001
Pulp Duplicates																					
CPUD-11	Soil	1.5	14.1	55.9	39	0.2	4.4	4.0	67	4.08	9.1	1.8	1.0	28.0	67	<0.1	1.2	0.2	13	0.02	0.056
REP CPUD-11	QC	1.4	13.6	55.0	38	0.2	4.1	3.9	63	3.95	8.9	1.7	1.2	27.1	65	<0.1	1.2	0.2	12	0.02	0.054
Reference Materials																					
STD DS11	Standard	14.5	148.9	135.9	341	1.7	79.0	14.1	1012	3.12	42.6	2.5	67.6	7.5	67	2.3	7.7	11.4	51	1.01	0.070
STD OREAS262	Standard	0.6	116.4	57.1	161	0.5	63.1	27.3	536	3.32	36.4	1.2	59.4	9.1	34	0.6	4.4	1.0	24	2.90	0.039
STD DS11 Expected		14.6	149	138	345	1.71	77.7	14.2	1055	3.1	42.8	2.59	79	7.65	67.3	2.37	8.74	12.2	50	1.063	0.0701
STD OREAS262 Expected		0.68	118	56	154	0.45	62	26.9	530	3.284	35.8	1.22	65	9.33	36	0.61	5.06	1.03	22.5	2.98	0.04
BLK	Blank	<0.1	<0.1	<0.1	<1	<0.1	0.6	<0.1	<1	<0.01	<0.5	<0.1	<0.5	<0.1	<1	<0.1	<0.1	<0.1	<2	<0.01	<0.001



Bureau Veritas Commodities Canada Ltd.
9050 Shaughnessy St Vancouver British Columbia V6P 6E5 Canada
PHONE (604) 253-3158

Project: NA
Report Date: September 26, 2023

Page: 1 of 1

Part: 2 of 2

QUALITY CONTROL REPORT

WHI23000607.1

Method	Analyte	AQ201	AQ201	AQ201	AQ201	AQ201	AQ201	AQ201	AQ201	AQ201	AQ201	AQ201	AQ201	AQ201	AQ201	AQ201	AQ201	
		La	Cr	Mg	Ba	Ti	B	Al	Na	K	W	Hg	Sc	Tl	S	Ga	Se	Te
Unit		ppm	ppm	%	ppm	%	ppm	%	%	%	ppm	ppm	ppm	ppm	%	ppm	ppm	ppm
MDL		1	1	0.01	1	0.001	1	0.01	0.001	0.01	0.1	0.01	0.1	0.05	1	0.5	0.2	
Pulp Duplicates																		
CPUD-11	Soil	37	8	0.06	171	0.005	<1	0.75	0.235	0.12	<0.1	0.07	1.1	<0.1	0.88	1	<0.5	<0.2
REP CPUD-11	QC	37	8	0.06	169	0.004	<1	0.70	0.223	0.12	<0.1	0.08	1.1	<0.1	0.81	1	<0.5	<0.2
Reference Materials																		
STD DS11	Standard	19	59	0.83	380	0.093	7	1.14	0.073	0.38	2.9	0.29	3.1	5.0	0.27	5	2.2	4.5
STD OREAS262	Standard	17	45	1.17	252	0.003	4	1.31	0.066	0.32	0.2	0.18	3.2	0.5	0.27	4	0.6	0.2
STD DS11 Expected		18.6	61.5	0.85	385	0.0976		1.1795	0.0762	0.4	2.9	0.26	3.4	4.9	0.2835	5.1	2.2	4.56
STD OREAS262 Expected		15.9	41.7	1.17	248	0.0027	4	1.3	0.071	0.312	0.2	0.17	3.24	0.47	0.253	4.1	0.4	0.23
BLK	Blank	<1	<1	<0.01	<1	<0.001	<1	<0.01	<0.001	<0.01	<0.1	<0.01	<0.1	<0.1	<0.05	<1	<0.5	<0.2