

"Rite in the Rain"
WEATHERPROOF



MEMO

NOTEBOOK NO. 391

Leslie - Disrupting 88/89

PAP 88-040

Leslie Chapman winter 88/89

Nov. 25/88

- broke trail up Marten Ck.
as far as blueberry flat below
James Ck., lead over flow!

Nov 26/88

continued breaking trail up
Marten 2 bends beyond James.
climbed hillside left bank to
outcrop about 150' above
ck. bed - dark, weathers red

L88-1 - crumbly yellow

L88-2 - redish stained quartz

L88-3 - yellow

L88-4 - host

L88-5 - host - grainy

Nov. 27/88

breaking trail up Marten Ck
to first L.H. pup
sampled diff. places
in creek R.H.
approx 200' below pup

- L-88-6 - fractured
- L-88-7 - darker, fault?
- L-88-8 - " "

Nov. 28

investigated 1st LL.
 pass up Marten - very
 steep + narrow - large
 rock in ck bed near mouth

- L-88-9 } lg. boulder in
- L-88-10 } ck bed
- L-88-11 - red stained fault
- L-88-12 " "
- L-88-13 - further up pass
 slabby, hard bedrock

Nov. 29

Drove trail to fork up
 Marten Ck (2nd h.h. pass)
 more overflow

Nov. 30

sampled up Marden Ck fork

L-88-14

- Lost

L-88-15

- Lost grey

L-88-16

} darker crumbly rock

L-88-17

w/ quartz stringers

L-88-18

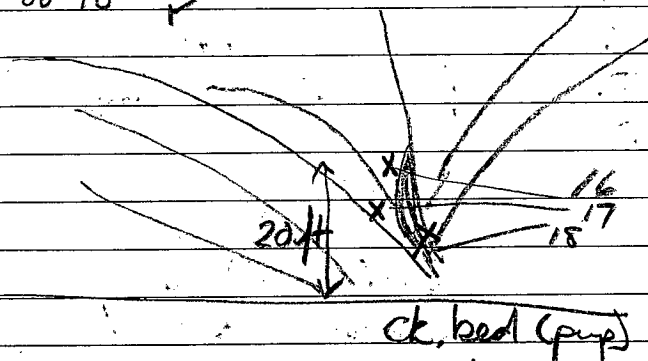

Dec 1/88

pushed trail further up
Marden valley wider above
pup

Dec 2/88

up Marten Cr

Sampled L.H. pup opposite
L.H. pup ~~opposite~~ sample
before

very steep few outcrops
climbed hillside about
200'

L-88-19 } hard weathered
L-88-20 } gray, slabby
L-88-21 }

Dec. 6/88

continued trail further up
Marten peak forks
sampled cliff face
L.H.

L-88-22 } quartz stringers
L-88-23 }
L-88-24 } crumbly rock
L-88-25 } stand, whitish
L-88-26 } from spring?

Dec 7/88

walked up L.L. pup, Marden
above forks, gentler slope
than other pups
sampled gravel from ck bed

L-88-27

L-88-28

L-88-29

L-88-30

} gravel samples ck bed

L-88-31

L-88-32

- h. rock samples cliff
face L.L. of L.L. pup

Dec 8/88

~~walked~~ trail further up
Marden - headwaters
sampled R.L. cliffs

L-88-33

L-88-34

L-88-35

- black, grainy
? greenish stained
near fault line

Dec 9/88

walked around upper part of Marden
climbed R.L. hillsides to sample

out crops about 200' above
creek bed

L-88-36 } weathered, gray
L-88-37 } ~100' up

L-88-38 } ~200' up
L-88-39 } very hard

Dec 10/88

broke trail up James Cr.
as far as slide

Dec 11/88

continued trail up James
to R.L. pup

Dec 12/88

walked up James R.L. pup
not much exposed rock
steep valley

Dec. 13/88

broke trail further up
James above RL jump
valley covered w/ scrubby
spruce not much rock
exposed here

Dec 14/88

continued trail up
James Ck took place
samples from ck bed
& bank

L-88-40

L-88-41

L-88-42

L-88-43

L-88-44

L-88-45

} loose gravel
creek bank

} creek bed gravel
from under
uprooted tree in ck.

43-45 → X jump

X ← 40-42

jump

James

Dec 15/88.

examined L.h. cliffs on
+0M immediately upriver
of Marten Cr. for graphite
schist - none observed at river
level - possibly higher - too steep
to climb up.

Dec 16/88

went ~~to~~ on the road upriver
along the creek to look
at the cliffs higher up.

crumpled yellow bedrock -
quartz L. 88.46 } ↑
L. 88.47 }

Dec 18/88

continued checking upriver
along cliffs R.h. opposite
pushed up bank road
sampled / upthrust section

darker than surrounding rock

L. 88.48 } ↑

L. 88.49 }

L. 88.50 }

L. 88.51

L. 88.52

reddish quartz
" "

Dec 19/88

went back to look at
chills upriver I looked at
yesterday. sampled green stained
crumbly quartz about
50' from area which
showed gold in 1st. yrs testing
work

L. 88.53

greenish quartz

L. 88.54

" "

L. 88.55

" "

L. 88.56

} " " smaller
straps

L. 88.57

Dec. 20

Broke trail a little
ways up B.L.S.D. ck.
(L.H. opposite upriver cut)

Dec 21/88

continued breaking trail
up B.L.S.D. creek area
far as old road workings
took place sampled
immediately upstream

from tailings

L. 88.58

L. 88.59

L. 88.60

L. 88.61

L. 88.62

L. 88.63

} tailings

Dec. 22/88

back up BLSO ck.
left the dogs at the spot
I quit yesterday &
walked up further.

Surprisingly large boulders
in ckl.

Dec. 23/88

took dogs to where
I walked yesterday
up BLSO ckl. then
walked up further, steep
country.

L. 88.64

L. 88.65

2

1

small pieces

samples from
ckl bed

Dec 26/88

went upriver to look at
boulders along river bank
L.L. below Sparks at bend.
Hard to see much, too much
snow, some gravel on hillside
at slides.

Dec. 27/88

upriver to Sparks Ck to
examine cliffs on river up + down
of creek - possible barite below ck.

L-88-67 } down river of Sparks

L-88-68 }

L-88-69 }

L-88-70 } dark, some steam-upriver

L-88-71 } of Sparks

L-88-72 }

228/88

broke trail up Sparks asp to
forks.

Dec 29/88

took dog up Sparks, tried to
take them up 1st K.h. pass, but it
was too tough so left them &
walked up. Not much exposed rock.

L. 88. 73 } placer samples ck. bed.
L. 88. 74 }

Dec. 30/88

pushed trail further up Sparks
Ck. took placer samples
from in bedrock cracks in ck. bed

L. 88-75 } ↑ placer ck. bed

L. 88-76 } above pass

L. 88-77

L. 88-78

L. 88-79

Dec. 31/88

took samples of soft, black
rock R.h. canyon near cave north

L. 88. 80

L. 88. 81

L. 88. 82

L. 88. 83

Jan 1 / 89

took samples L.H. canyon
on the way back from Wylie's

L. 89-84 } bdrk shelf
L. 89-85 }
L. 89-86 }

Jan. 2 / 89

broke out the trail up Sparks
again placer samples from
ck bed about 1 mile up ck.
from loose gravel from ck bank
stuff

L-89-87 } placer fr. ck bed
L-89-88 } Sparks
L-89-89 }
L-89-90 }

Jan. 3 / 89

mused up to h.h. cliffs
1st bend above Sparks. lots
darker rock, hard & blocky, no graphite
schist observed

Jan 4 went up to R.L. cliffs
below Boram Ck. sampled some
of the slide rock

L. 89.91

L. 89.92

L. 89.93

Jan 5/89

broke out trail up Sparks again.
went further up to L.L. gulch.
placer samples from creek bed
& bank

L. 89.94

L. 89.95

L. 89.96

L. 89.97

L. 89.98

L. 89.99

} creek bed

} L.L. gulch mouth
bank

Jan 6/89

went back up Sparks
made trail further up. took
more placer samples from creek
bed

L. 89-100

L. 89-101

L. 89-102

Jan. 7.

went downriver to look
at cliffs L.L. opposite
Bruin Ck. - some grt schist
observed, often near quartz
stringers

L. 89.103

L. 89.104

L. 89.105

L. 89.106

L. 89.107

} graphitic schist

} rotten red-yellow
quartz

Jan. 8

went back downriver
to look at cliffs upriver
of Bruin Ck. L.L.

L. 89.108

L. 89.109

L. 89.110

L. 89.111

L. 89.112

L. 89.113

L. 89.114

L. 89.115

} dark host, grainy

} rotten quartz

g-mica

g-perovskite?

Jan. 9/89

- dug out hardrock sampling equipment & supplies + brought it into the house to thaw out,
- organized h.rock samples & stored them under the porch
- picked most interesting samples to work on 1st.

Jan 10/89

set up h.rock sampling station
did

L. 88.53	-	no purple stain
L. 88.54	-	"
L. 88.46	-	"
L. 88.47	-	"

Jan 11/89

worked on 4 more h.rock samples

L. 88.80	-	blank
L. 88.81	=	some purple colour
L. 89.103	-	little purple
L. 88.104	-	blank

Jan 12/89

L. 88. 48

—

L. 88. 50

—

L. 88. 71

—

L. 89. 86

—

Jan 13/89

L. 89. 107

slightly purple

L. 89. 91

—

L. 89. 93

—

L. 88. 52

—

Jan 14/89

L. 89. 110

—

L. 89. 109

faint purple stain

L. 89. 107

—

L. 88. 16

—

L. 88. 14

—

Jan 15/89

L. 89. 113

—

L. 88. 2

—

L. 88. 25

—

L. 88. 83

—

Jan 16 8/17/89

cutting wood for camp

Jan. 18/89

- we cleared snow off placer samples & sorted them out
- got tubes & pans together for panning samples

Jan 19/89

hauled water w/dogs for panning

Jan. 20/89

we panned placer samples (results from Bill's samples are in his book)

L-89-94	—	6 lb
L-89-95	1 fine colour	6 lb
L-89-96	—	5 1/2 lb

Jan. 21/89 - panned placer samples

L-89-87	—	7 lb
L-89-88	—	6 lb
L-89-89	fine colour	6 lb

Jan 22-23

cut wood - cold!

Jan. 24/89

L. 88. 75

—

6 lb

L. 88. 76

—

6.5 lb

L. 88. 77

1 flake

7 lb

Jan 25/89

placer

L. 88. 78

2

fine colour 6 lb

L. 88. 79

—

7 lb

L. 88. 90

—

7 lb

Jan 26/89

placer

L. 88. 73

—

7 lb

L. 88. 74

—

7 lb

L. 88. 58

—

6 lb

Jan 27/89

placer

L. 88. 59

flake

8 lb

L. 88. 60

fine colour

7 lb

L. 88. 61

—

6.5 lb

L. 88. 62

—

7 lb

Jan 28/89 placer

L. 88.40	-	7 lb
L. 88.41	-	7 lb
L. 88.42	1 colour	7 lb

Jan 29/89 placer

L. 88.43	2 colour (fine)	6.5 lb
L. 88.44	-	7 lb
L. 88.45	1 colour	7 lb

Jan 30/89

had to go up on top of hill
to phone on Dawson chnd - took
some samples from road bed
in new switch back

L. 89.116

L. 89.117

L. 89.118

Feb. 1/89 placer

L. 88.58 - 7 lb

L. 88.63 - 7 lb

L. 88.64 2 colour 1 flake 5.5 lb

L. 88.65 1 colour 6 lb

Feb. 2/89

L. 89. 97	—	6 lb
L. 89. 98	1 colour	6 lb
L. 89. 99	—	6 lb
L. 89. 100	1 colour	7 lb

Feb 3/89

L. 89. 101	—	5 lb
L. 89. 102	—	6 lb
L. 88. 27	1 colour	7 lb
L. 88. 28	—	7 lb

Feb. 4/89

L. 88. 29	2 colours	7 lb
L. 88. 30	—	7 lb

Feb 5+6+7/89

closing up camp

"Rite in the Rain"
WEATHERPROOF



MEMO

NOTEBOOK NO. 391

PROSPECTING

JOURNAL

WINTER 88-89

BILL CLAXTON

FORTY MILE RIVER

YUKON.

88-040

NOV, 24

broke trail upriver as far as Browns Ck.

took quartz samples about 1000 ft up Browns Ck.

- rotten quartz strings, heavily oxidized

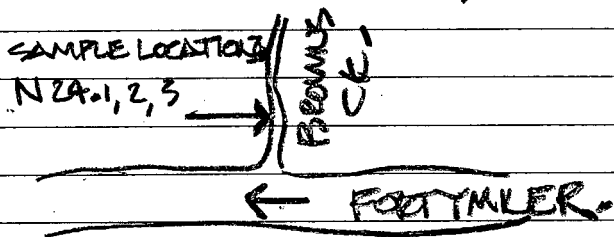

NOV, 25

broke trail out to boundary Ck.

went up boundary about 1/2 mi.

no samples.

W50, 2 to

took samples out
of bedrock crevices
in creek bed of
boundary cut,
approx. 100' up

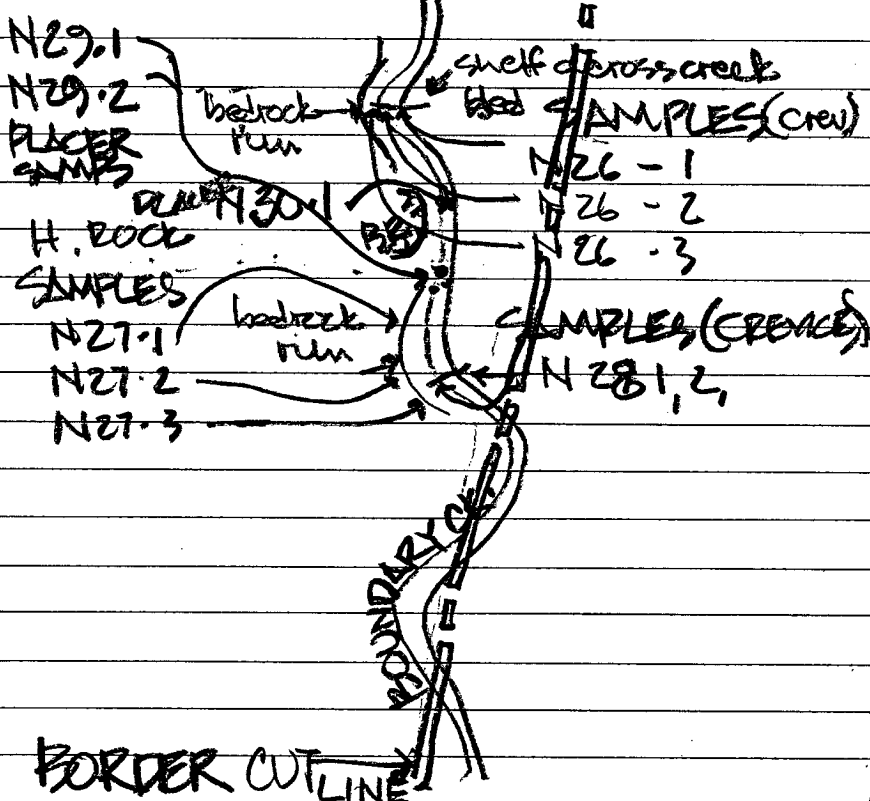
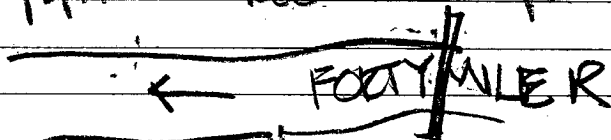

Nov. 27

took handrock samples
out of exposed bedrock
rim up boundary
- stained schist
bedrock host with
bands of crumbly
yellow decomposed
rock bands about
1-2" wide

Nov. 28, 29, 30

took handrock ^{crevice} samples
out of crevices on
boundary.

DEC 1.

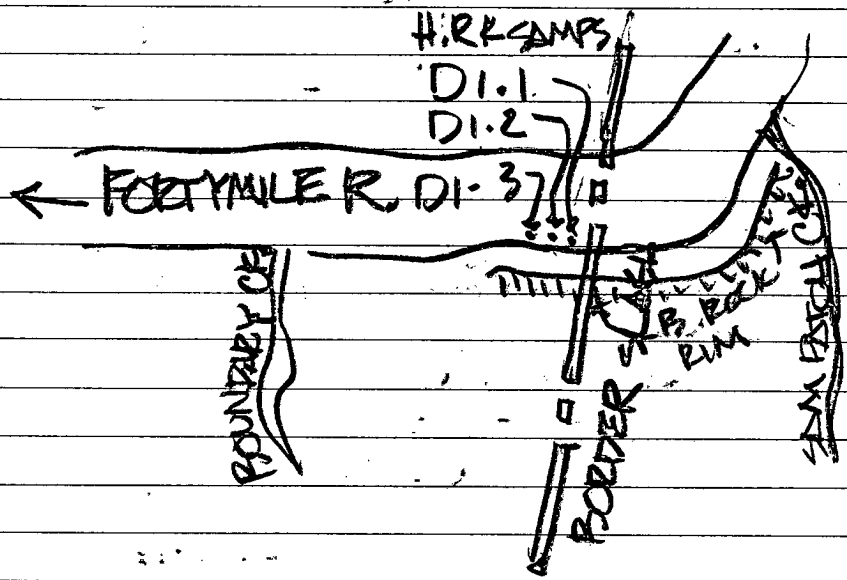

took HIRE samples
out of bedrock face
SCHIST ROCK - BLACK
layered

DEC 2

put trail in up to
Horse Ck. didn't
take any samples.

DEC 3

went up Houtpometry
creek about $\frac{1}{4}$ mi
narrow gulch

- floor approx 100' wide
at mouth

- narrows approx
500' up to about
30' wide

- grade approx
1' in 10'

- lots of shell rock

- chopper drop today

PLACER
SAMPLES

D 5.1

D 5.2

PLACER SAMPLES

D 4.1

D 4.2

HARD ROCK SAMPLES

D 3.1

D 3.2

OLD CHANNEL
CREEK HAS
BEEN MOVED

LOW BENCH

← FORT MILE R

took samples of
quartz which
had sluffed into
creek

Dec 4

took placer samples
out of mountains.
Ok. lots of stony
stuff not very
washed looking
some old workings
& a pretty good
trail going up
Ok.

DEC 5

took more placer
samples, approx
1500' up creek,
getting real narrow
& steep. Tough to
find any placer
material but looks
like the creek has

been worked before

DEC. 6

went back up
Montgomery ck.

took some glassy
pieces out of the
creek bed to look
at for Hardrock
possibility - black
schisty platy
rock.

DEC 7.

Broke trail downriver
ran into overflow
around kink.

went home - shovelled
out track & creased
skidoo, no samples!

DEC. 8

broke trail further
down river & went
up basin about
 $\frac{1}{2}$ mi. good going
smooth ice travel.
no samples.

DEC 9,

went up basin
to Preston Ck.

took placer samples
out of side gravel
where creek had
cut on Preston Ck.

PRESTON CK

OLD
SHOTS
OF

D9-1, 2, 3

CAT TRAIL

HARDROCK SAMPL

D11-1

D11-2

BRUNN CK

← FORTY MILE R.

DEC 10

walked further
up Preston CK.

(RIGHT LIMIT OF
BRUNN approx. 3 MI.
UPSTREAM FROM MOUTH)

narrows to about
40' about 2000'
up from mouth.

a few shatts here
& there.

narrows again

no samples

DEC. 11

went up basin
approx 2 MI took
some bedrock
samples. look
like graphite schist

DEC 12

went up basin
about 4 mi to
narrow canyon
too much overflow
couldn't get through
no samples.

DEC. 13

Wrote out trail to
upper end of the
canyon took sample
out of schist on
canyon wall,

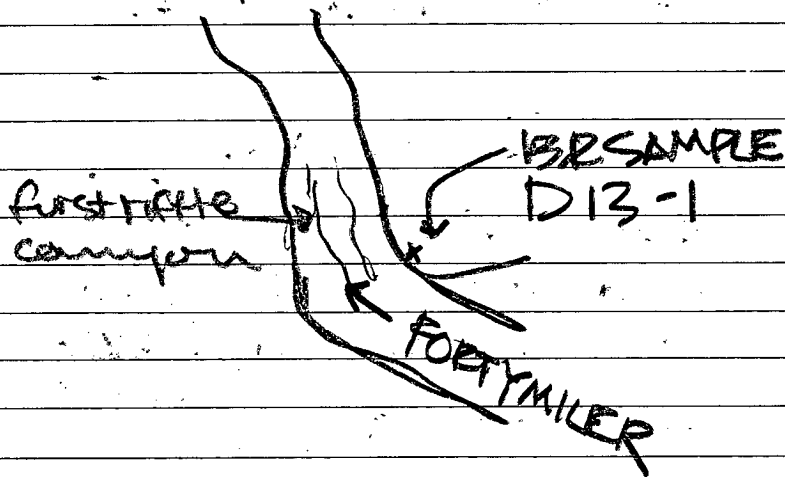

DEC 14

went down river
walked up MAJAN CK.
(Left trail quick
approx $\frac{1}{2}$ mi above
canyon)

Creek has been
moved around at
the mouth

looks like quite a
bit of work was
done. pretty good
trail up CK.

didn't take any
samples.

DEC. 15

Walked back up
MAJAN CK. took 2
samples - for placer
+ could be old
river gravel
- well washed

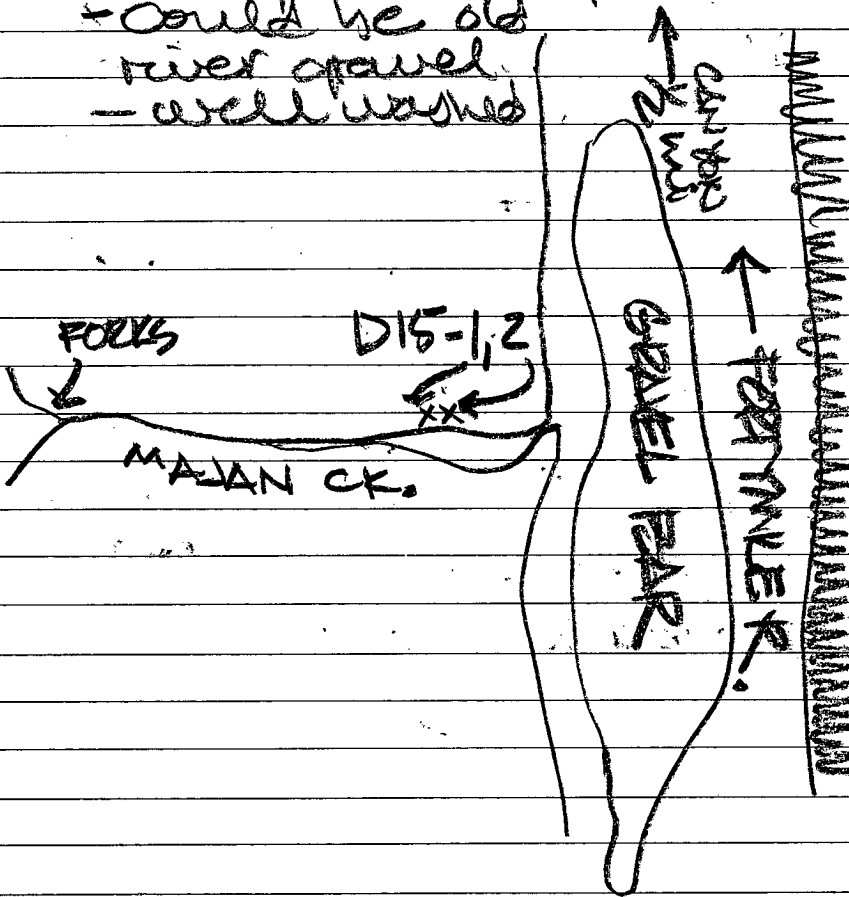

DEC 16

went back up
mayan ct - no
gravel accessible
further up.
valley widens
slightly further
up. looks like the
ct has been moved
around. lots of
overflow up the ct.

DEC 17.

helicopter drop
today - worked on
skidoo - chainrings
belt, sp. plug, greased
etc.

Dec 18

Went up Brun
took H.R. samples
from cliff face
approx 800' up ck

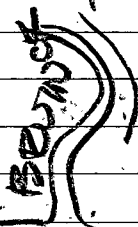

← FORTY MILE R

Yellow stained B.R.
(looks the same
as kink B.R.)

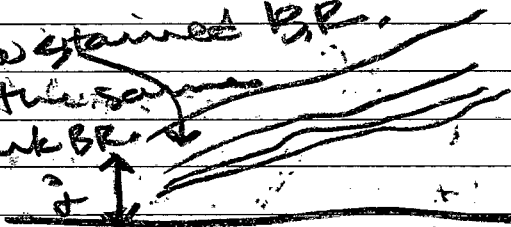

2 samples ICE LEVEL
taken

DEC 19,

Went up Basin
ck. took some
bedrock samples
approx 1/4 mi
up from a
outcrop in the
Creek bed.

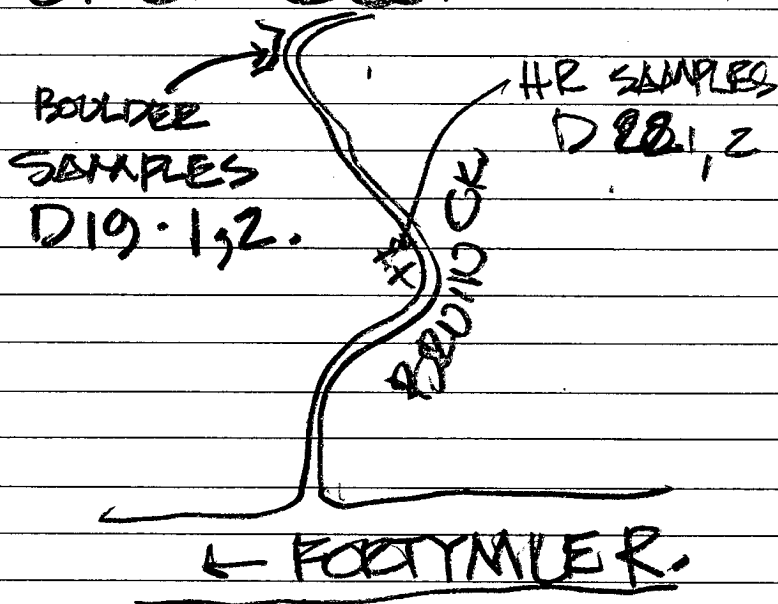

DEC 20

went up Bruin
approx 4 mi
no samples.

DEC 21,

went up Bruin
no samples.

DEC 22.

Bruin ck.

took 2 samples
from quartz
stringers

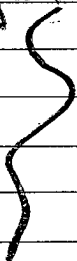

DEC 23

went up Brown
to get my rock
hammer that
I left

DEC 24.

mixed more
slideo gas - organized
samples & stored
them out of the
snow.

DEC 25, 26

Christmas

(31)

DEC, 27

put trail through
canyon.

DEC 28

extended trail
down to wash in
ok.

DEC 29

broke trail out
to the sea
forty mile bridge

DEC 30

took some HR
samples out
of the bedrock
rim on RIGHT
LIMIT lower canyon
wall, crumbly
schist

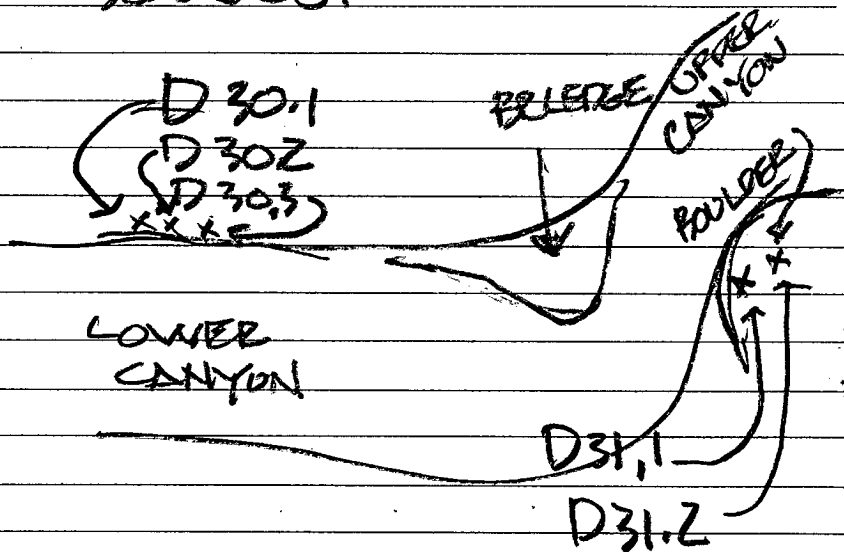

DEC 31

took 2 samples
off of the big
white boulder
on LEFT LIMB
UPPER CANYON

JAN 1

DAY OFF

JAN 2

Went over road
took 2 placer
samples out
of sidehill road
cut on pup at
CC. where road

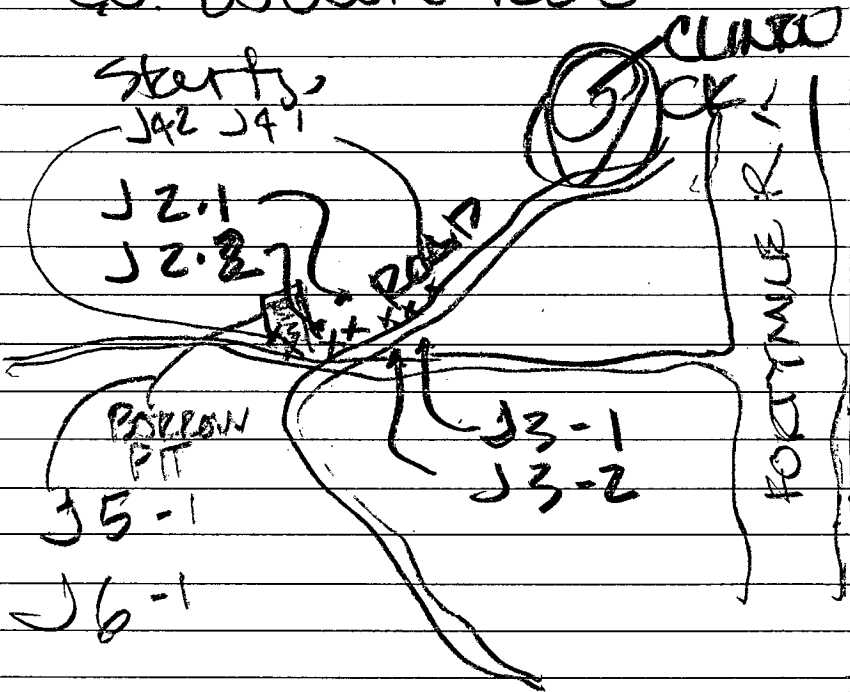

JAN 3

took 2 more
samples (plaster)
out of cut face
on road - looks
like old river
channeled
gravel.

JAN 4

took 2 bedrock
samples out
of cut face
from road
crumbly schist
looks like the
same as our
bank (on house site
HR. clams)

Jan 5

took a placer
sample out of
the borrow pit
for the road fill
across the creek
see map

Jan 6

dug hole deeper
& took another
placer sample
out of borrow pit
see map

Jan 7

walked up pup
a ways - steep -
no placer materials

Jan 8

went down river -
took some placer
samples across
the river from the
old dredge

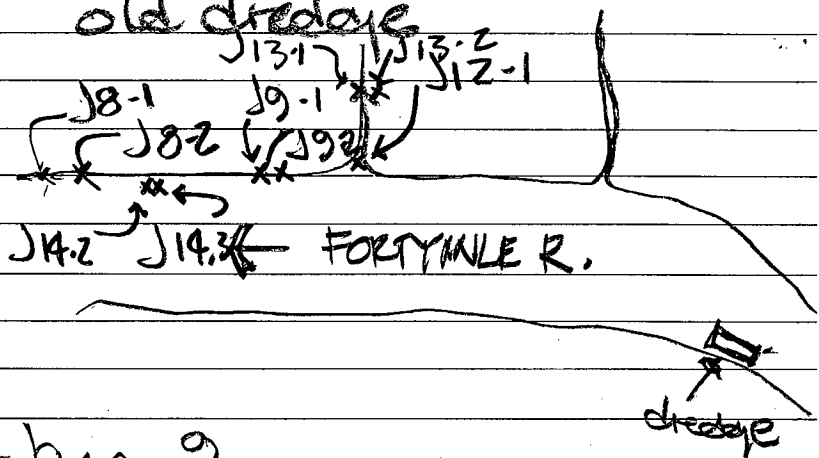

Jan 9

took more samples
out of river gravel across
from dredge

Jan 10

walked up pup
across from dredge
found remains of
an old test pit, pretty
narrow.

Jan 11

walked further up
pup across from
dredge. no samples

Jan 12.

walked up pup
below dredge
(~~+~~ across the river)
got about 800' up.
took a plaster
sample near
mouth.

Jan 13,

walked further up
pup across from and
below dredge narrow
& steep. took 2
samples out of
reef bed.

Jan 14

took two more placer
samples from gravel
sluff & across and
downriver from
dredge.

Jan 15

went downriver
& horse trail out over
the road - no samples

Jan 16

Colder today -
went up to Spruce
& cut wood

Jan 17

cut wood & hauled
it home

Jan 18

cold - 50 organized
a batch of placer
samples to sample

Jan 19

set up panning
outfit in cabin.
brought in a
batch of placer
samples to thaw
for processing.

Jan 20, 2/1968

Processed samples that I got on the road side hill cut where our road starts. See JAN 2-6

RESULTS

J 2.1 (6/16) 0

J 2.3 (6/16) 0

J 3.1 (6/16) 0

J 3.2 (7/16) one tiny colour

J 4.1 (6/16) 0

J 4.2 (6/16) 2 tiny colour

J 5.1 (7/16) 0 colour

J 6.1 (7/16) 0 colour

Jan 22-23

cut & hauled
wool all day
still cold.

Jan 24, 25, 26

Processed placer samples from
across river from
dredge. See

JAN 17 - 14

RESULTS.

J8.1 (8lb) 3 colours (merged)

J8.2 (6lb) 3 colours

J9.1 (7lb) 0 colours.

J9.2 (6lb) 2 colours.

J12.1 (9lb) 3 colours.

1 pretty big

Jan 27

J 14.2 (12 lb) 7 colours

J 14.3 (8 lb) 1 colour

J 13.1 (6 lb) 0 colours

J 13.2 (7 lb) 0 colours

Jan 27

processed samples from
up MAJAN CK. See
DEC 14-16

D 15.1 (7 lb) 0 colours.

D 15.2 (6 lb) 0 colours.

Jan 28

processed ^{plaster} samples
taken from Preston
Ck.

D9.1 (8 lb) 0 colours

D9.2 (8 lb) 1 tiny colour

D9.3 (6 lb) 0 colours

Jan 29, Jan 30, Feb 1-2

processed ^{plaster} samples
taken from BOUNDARY
Ck.

RESULTS

N 29.1 (8 lb) 0 colours

N 29.2 (7 lb) 1 very small colour

N 26.1 (3lb) 3 colours

N 26.2 (2lb) 0 colours

N 29.1 (5lb) 1 colour

N 29.2 (3lb) 2 colours
1 pretty bigflake

N 30.1 (2lb) 1 colour
(very small.)

Feb 3, Feb

~~Processed plankton samples
taken from MONTGOMERY
CK. (see DEC 3-5~~

RESULTS

D4.1 (6lb) 0 colour.

D4.2 (7lb) 0 colours

D5.1 (616) 3 colours

D5.2 (816) 1 very small
colour

Feb 4, 5, 6,

closed up camp
got ready to leave
the bush.

71 days

**116C-7
PLACER**

LATITUDE 64° 15' TO 64° 30'
 LONGITUDE 140° 30' TO 141° 00'

ISSUED UNDER THE AUTHORITY OF THE MINISTER
 OF
 INDIAN AFFAIRS AND NORTHERN DEVELOPMENT

SCALE 1:30,000

METRES 0 1000 2000
 FEET 0 1000 2000

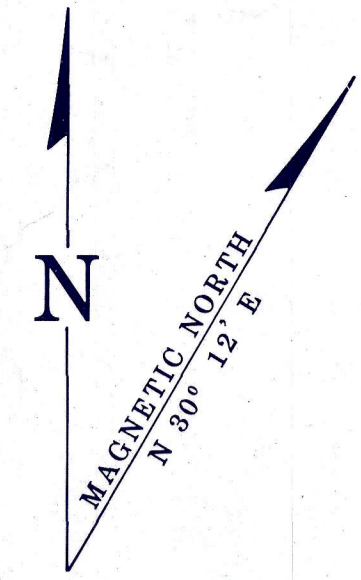

NOTE:
 THIS MAP IS ISSUED AS A PRELIMINARY GUIDE FOR WHICH THE DEPARTMENT OF INDIAN AFFAIRS AND NORTHERN DEVELOPMENT WILL ACCEPT NO RESPONSIBILITY FOR ANY ERRORS, INACCURACIES OR OMISSIONS WHATSOEVER.
 TOPOGRAPHY COMPILED FROM 1:50,000 NATIONAL TOPOGRAPHIC SERIES.
 CONTOUR INTERVAL 500 FEET.
 SURVEY INFORMATION COMPILED FROM LEGAL SURVEYS, BY DRAFTING SERVICES.
 Note: Entry on certain Lands is withdrawn from staking by P.C.1985-2065 to facilitate the settlement of Native Land Claims without prejudice to Existing surface and Subsurface Rights.

	116C-10	116C-9
ALASKA	116C-7	116C-8
	116C-2	116C-1

DAWSON 23 JULY 86

FOR QUARTZ SEE 116C-2

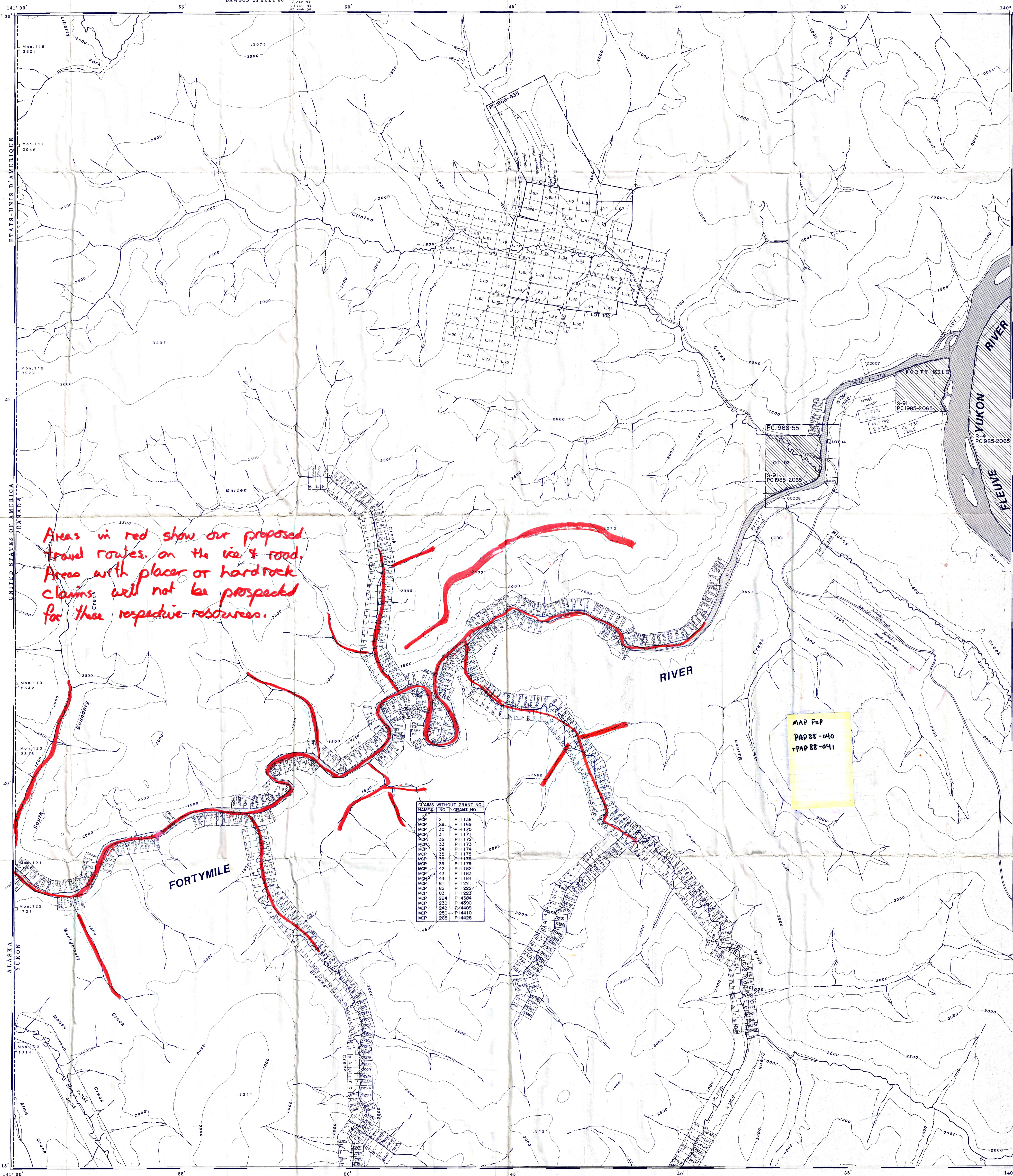

Areas in red show our proposed travel routes on the ice & road. Areas with placer or hardrock claims will not be prospected for these respective resources.

CLAIMS WITHOUT GRANT NO.	NAME	NO.	GRANT NO.
MCP	2	P11138	
MCP	29	P11169	
MCP	30	P11170	
MCP	31	P11171	
MCP	32	P11172	
MCP	33	P11173	
MCP	34	P11174	
MCP	35	P11175	
MCP	36	P11176	
MCP	37	P11177	
MCP	38	P11178	
MCP	39	P11179	
MCP	40	P11180	
MCP	41	P11181	
MCP	42	P11182	
MCP	43	P11183	
MCP	44	P11184	
MCP	81	P11221	
MCP	82	P11222	
MCP	83	P11223	
MCP	224	P14384	
MCP	230	P14390	
MCP	249	P14409	
MCP	250	P14410	
MCP	269	P14428	

MAP FOR
 PAP 88-040
 TPAP 88-041