

TOM MORGAN
PAP 89-032

May 28. Got grub and gear together and left for Hoole River, where we stayed at its mouth on the Pelly River.

29. Took some pans from a small bench on the left limit of the Hoole around $\frac{1}{4}$ mile up from the bridge and found some fine color (4) on the gravel-bedrock contact. The two bars I panned on ~~the~~ up from the bridge had a couple fines in them also. Worked down the Pelly and found the same thing. Nothing was very encouraging so took off to find a route to the upper Hoole. Ended up going up Mink C. Drove around 2 km. up road before hitting swamp.

30 Backpacked through around 5 miles of swamp then around 3 miles of hills before stopping for camp.

May 31 Broke camp and set around the divide between Mink Cr. and Hoole Cr. I noticed a Gausson across the valley. Left pack on roadside and hiked over to it. Turned out to be a disseminated sulfide zone at around the 5000' level that was as far as I could tell around 80' by 100'. Looked around and found no other mineralization. Took some samples and headed back. Left samples by road and found campsite.

June 1 Hiked 8 more miles. On the north side coming out of the Hoole River trail ran into around 3 miles of 2' deep snow. Found a dry area beside a small creek and camped there.

June 2 Kept going up the Hoole panned the little creeks as I passed them but found nothing. Noticed a

large amount of quartz and chlorite schist. The gravel I came across was unsorted and silty, glacial origin. Made it to the last creek on the road ~~at~~ around dark where an old cabin and camp ~~was~~ ^{are}.

June 3 Slept late; dried things out; made a good stew and took a few pans of the cut that was beside camp. Found only black sand + garnet.

June 4 Went up creek. Seems that the bottom 2 miles have been mined. At the edge of a cut at the $1\frac{1}{2}$ mile mark found 3 chunky colors in one pan. Lots of quartz boulders at this point in cut. Found two places where bedrock surfaced in creek. At these points I dug in as deep as I could but

only found a fine color (2 in one) (3 in the other)
^{which} were the best along this bedrock.

June 5. Went up ridge (Right limit) around 4 miles up to where I noticed a green body of rock the day before. It was a serpentine body in which most of it was in the claim block M.A.G. I came back down into the valley of the small trib. The upper end of this creek was all blocks & boulders, with practically no gravel in it. Panned a few places coming down but found nothing.

June 6. Haded 2 miles downstream to next R. limit trib. where I noticed a road going up. Went upstream and found a stripped area. Out of a cat trench I found up to 3 fens in a pan, no coarse colors were found.

June 7 Hiked down to the Hool and across to the left limit tributary. A round mile up there was a cabin (remnants) and some hand workings. Upon digging in the bottom of the old pit I found four course colors - (small but course). There was fines in the creek gravels but no course color such as the color in the pit. Decided to head out as grub was getting low.

June 8 Hiked over to road on right limit and camped at spot where I camped the last night hiking in at the dry spot beside the small creek.

June 9 Hiked to within 5 miles of the truck and camped there beside Mink Creek.

June 10 Made it out to road and stayed in Ross River.

July 20 Took off to Dawson

21. Went across the Yukon River and was hiking around left limit cliffs of the Yukon. Right across from the mouth of the Klondike there were small quartz veins in the schist. As I worked my way down river the quartz veins became larger and mineralized although the small veins that I was finding at first had at times a blue-green copper stain. At around $\frac{1}{2}$ mile above where the ferry docks I found large quartz veins in a graphite schist. Below these veins there was sulfides in an altered graphitic quartzite?

22. Went back and followed the large quartz veins (3' to 4' wide) up into the hillside. Found minor chalcopryite around 150' up. Found a body of altered serpentine which had some long fiber asbestos in it. Some of the fibers were up to 6" long. Most of them were around 2" though. At around 300 yds. or so I started running into old river channels. I found upon coming down the bank a lower back channel that appeared to be white channel. 80% quartz

23. Went back to the spot where I saw these ~~the~~ white channel and started digging. There appeared to be a definite lense of this gravel along this back flat. I could only get so far down before hitting frost. Part of it was on open ground and part was on the Co-Discovery of the Dawson Cr. claims.

July 27 Went up the Dome and ~~walked~~ went down the Foster Creek road. Walked from there over towards the Klondike. Extending for a mile up from Foster Creek along the right limit of the Klondike was what appeared to be the extension of the old Hunker channel. Standing on the edge of where this upper bench starts it lines up with Australia Hill and the rest of the high level white channels. Dug in on top and found ~~no~~ rounded pebbles. Couldn't find a gravel-bedrock contact.

28 Went over to the other limit of Foster Creek and found a small gulch which cut the bench and at the same time was not willowed and massed, mudded over. Dug in and found some color 2+3 fines in the area that was almost a bedrock gravel shuff. Found a few fines after that but no colors. Noticed how distinct the left limit bench coming off Bear Cr. was on the left limit of the Klondike R.

29. Climbed up onto the left limit of Bear Cr. and found a series of shafts going up the side of the old river channel. They were approx 100' apart and there were 7 of them in a row. These shafts only went around $\frac{2}{3}$ of the way up the side of bench. I found no shafts on the top of the river flats of the old channel. Took some samples and panned them

down below but found nothing in the old tailings of these shafts.

July 30

Dug in along old ditch which cross-cuts bench. Found a pebbles till that was quartz and black chert which was also ~~the~~ muddy in color the same type of gravel that is found on top of the white channel gravels. Panned some of this in the valley floor but found nothing in it. The bench is a good 2000' across ~~far~~ on the upper flats.

July 31

Further back along the bench I found some ^{cut} cuts going up the side of it. This was approx. $\frac{3}{4}$ mile up from the mouth. There was old gravels along these cuts, but no white channels that I could see. The gravel flats seem to pinch out on this left limit at a mile upstream from the mouth of Bear Cr. Could not find any shafts on top of these flats. Look to be around 200' deep.

Aug 1

Tried to trace where the gravel-bedrock contact showed through ~~the~~ on the side of Klondike R. bank hillside. Dug in a gulch ~~cut~~ that cut this contact (appeared to) and panned it on the flats (2 fines). Found a Y C G C stock yard below with steam pts, hoses, cables, and iron everywhere.

Aug 26 Took off to Davidson Creek outside Mayo.

Aug 27 Went up creek to upper end with loader carrying suction dredge and gear. Clear off a spot that had shallow bedrock, diverted some water to make a pool to dredge in and cleaned up around a 10' x 10' area. Out of this material we got around 1/4 oz.

Aug 28 Decided to take off so we figured the way the bedrock was, that I should have ^{been} a good spot.

by Sept
30, 31, 1.

Got together with Charlie and got grub bobcat, gas, diesel, tools, pump, hoses, and box parts

Sept 2 Left for Florence Creek with gear. Made it into Rollingson Cr and camped there waiting for Charlie.

Sept 3 Went back into Carmacks to find out what happened to Charlie. The trailer had had a couple flats on the way to Carmacks.

Sept 4 We got a spare tire and went back to pick up bobcat where he left it off the road in the bushes. Went back into Rollingson and camped there.

Sept 5 Organized gear and started in with 4-wheeler + bobcat. Made it into Florence late that night. Charlie was somewhere back on the trail.

Sept 6 Went back up road to see what happened to Charlie. Found him ground 5 miles back. Turned out he had camped around 3 or 4 miles back from where I met him. Got back into Florence organized gear and set up camp.

Sept 7 Checked out cuts, panning different gravel layers. There was a few odd colors in the upper layers 3' to 10' but almost all the gold was on the gravel bedrock contact. Found the best color upstream from camp where the recent creek cut the old bench. Come back to camp and started to put box together while Charlie went staking.

Sept 8 Finished sluice box set up pump and hoses and set up box at the base of the pile where the best pans were found.

Sept 9 Started ground sluicing, although there was problems with surging and plugging up of the box. Started using big rocks to try and control the flow of the gravel slurry. Put through around 3 yards.

Sept 10 Flashed up box, panning down the concentrate to ~~the~~ only gold with no black sand. Pushed up more dirt with bobcat and put box back together. 2 1/2 grams of gold was taken from this 3 yards of gravel.

Sept 11 Washed around 4 yds. of gravel through.
By using big rocks I kept the box from
plugging up most of the time and had
a fairly regular flow. Bobcat got a flat
so decided to head out and at the same time
make sep a spray bar so that we can use
the grizzly that was left from years past.
There are too many big rocks to ground
slice and also a lot of the gold is being
left behind in the gravel not washed
through the box.

Sept 12 Cleared up and got just under 3 grams, then
headed out to get spray bar and tire fixed.

Sept 13 Met some hunters going into Little Buffalo
Lake in Carmacks who grabbed the spare
tire for the bobcat to bring it back into
Charlie. Dropped flat tire off at garage and
headed to Dawson to get spray bar, extra hose &
fittings.

Sept 14 Picked up gear I needed at Harvey's on
Little Blanche and fabricated a spray bar.

Sept 16 Got some food and headed back to Carmacks.

Sept 17 Drove four-wheeler into Florence with
gear.

Sept 18 Rigg'd up spray bar and pump. The amount
of water moved some gravel but the box
that was under the grizzly was too
big for the 3 in pump. The small

wood box I couldn't seal off properly so I ripped it all apart and went back to the ground sluicing ^{spot} where I was before.

Sept 19 Washed around 2 yds. of dirt and called it quints. Cleaned up and got 1.2 grams. There were some silver colored colors from this one and the others which I collected and will send out for assay.

Sept 20 Started a hole in the side bank around 150 yds upstream from the ground sluicing pile at what I figured would be the gravel bedrock contact of the left limit bench. After getting in around $2\frac{1}{2}'$ I hit an orange totally decayed bedrock. This was not the same type of contact of the pile of 150 yds downstream. The gravel ^{compact} covering the bedrock here was sloping about the same grade as the hillside of the bench so I moved up around 8' and dug in there. At this spot I ran into boulders around 3' across. With much prying and digging went down and in, so that there was a 6' face in front of me, but still no bedrock.

Sept 21 Kept digging and prying to where there was a $7\frac{1}{2}$ to 8' face in the side of the bench. At this point I found a rusty red totally decayed clay bedrock. There was 1 to 2 cm. wide seams of (50% black sand) running just above bedrock (decayed). In one pan there was around $\frac{1}{5}$ of a pan

of black sand + 3 colors. Dug around 10 pans ~~out~~ off the contact area (from a foot above to a foot below) with no pan having more than 3 color. Dug 2 more holes upstream around 50' where the contact was just leveling off on this bench. There was the same fine black sand and a little color. Although the face was only around 3 1/2' high into the side of the bench it was the same as the deeper hole (bedrock color and decayedness)

Sept
22

Took off upstream checking bars, benches and side banks. At around 2 miles up from camp dug into what looked like a gravel bench. The gravel was unsorted with no real fines to speak of right to a level bedrock-gravel contact at 50' of depth. Figure it was a glacial dump as there wasn't even much black sand.

On one inside corner I got 4 color which was the max. On the left limit there were granite cliffs that would predominate for a while, then the larger ^{gravel} banks would. I think almost all the large gravel banks were glacial. On the spots where the granite cliffs were, the creek channels on this left limit looked undisturbed and frozen. All the way along there were ultramafic boulders and smaller sizes, but none to be found in situ in any exposed bedrock at around 3 miles up I turned around

Sept
23

Went downstream digging into the contact zone of the bench which went from around 10' above creek level at camp to at least

100' a mile and a half down, where the bench ended and a deep canyon started, with no real side benches. In the creek I found a couple coarse colors and some fine staurolite a mile below camp. Found ^{it} to speak of in the bench contacts.

Sept 24

Went upstream ~~to~~ 200 m to where the wide (200') ~~creek~~ low-level (5' above water level) creek banks had been cut by either spring runoff or old timers as there was a fair amount of angular granite in the cuts. Dug into three different cuts where I came up with lots of fractured granite and ground water with a few fine colors, but nothing that looked very encouraging.

Sept 25

Was taking off to go and check a right limit trail around 2 1/2 miles downstream when the chapter came in and halted my trail. It was Suede Swain & Bob Wondga. I showed Suede the work and the gold we'd recovered, which he figured was substantial. I decided to go get more equipment and come back in to do a better test.

Sept 26

Went to south of July Creek by Kluane Lake to Suede's operation there, to pick up riffles + another 3" pump and hose.

Sept

28-29

Organized to get 930 loader from Coins ^{along} with another truck, welder, matting and more grub with Iwede's backing.

Sept 30 Got everybody and everything together and made it to Carmacks and stayed the night there.

Oct 1 Drove in organized and set up camp a little better than previously.

Oct 2 Hooked up both 3" pumps to grizzly & built a ramp to it. Cleaned out old logs and dirt covering the old angled cross riffle-director pieces of steel that were welded in the box. Looks like



an inefficient way to try and mine.

Oct 3 Cut out the angled cross pieces. Welded a new side on the box to get rid of the holes which were used as some kind of concentrator and to fit the riffles and expanded metal of Sweden's into the run snugly. Put the matting, the riffles and expanded metal and clamp down in to be ready for slicing.

Oct 4 Started slicing, but had to change the pumps around as the grizzly and box were plugging up. Instead of a spray bar and nozzle on the head of the grizzly we ended up putting ~~the~~ ~~to~~ a nozzle on the spray bar hose and the other nozzle underneath the grizzly to wash the dump box clean. Sliced around 15 yds. and the grizzly snapped in two. Cleaned out what we had and put it in buckets and then long tommed it and put it aside in a bucket.

Oct 5 Had to take all the bars off the grizzly and put a new railway rail in place. ~~and~~ Rewelded the bars back on the rail ~~and~~ and raised the angle of it.

Oct 6 Sluiced around 20 yds. The grizzly on the steeper angle worked much better although the box kept on packing up, so we had to go with a slow feed. Checked at the end of the box and found a fair amount of color. There is so much black sand that ~~there~~ it is running thick over the riffles. Part of the problem is that the box is only 1" to the foot. Took the concentrate and long tumbled it. Put the concentrate of this in another bucket. A lot of this material was from the downstream side of the cut where there was an iron stained red gravel. Unless the other 1 Syd. test was from an older pushed up pile. This was all around (downstream) 250' from the ground sluicing area we were working with the bobcat.

Oct 7 Tried to change angle of box. There was too many nails and ^{rocks} packed solid all around the box as well as the dumb box, grizzly and run being one solid welded mass. We started sluicing some material from the ground sluicing pile, but after the second bucket I could pan gold out of the last riffles so we said the hell with it.

Oct 8 Started out and got stuck around 10 miles from Florence ⁱⁿ with truck ~~and~~ with welding trailer. Tried to dig out but sunk worse.

- Oct 9 Went ahead in little 4x4 to catch loader which was ahead of us and found it stuck in a swamp off the road. Why, I still can't figure out. ~~Smart~~ operator
- Oct 10 Phoned in Carmacks to get equipment to get loader out, then went back in to get 3/4-ton 4x4 and welding trailer out. Went back down to Florence to get Bobcat to help. Tried using truck (small 4x4) and bobcat with no luck.
- Oct 11 Jackknifed, cordroyd and blocked until ~~the~~ we got the truck out, then drove through the swampy area. ~~and~~ We then pulled the trailer through with chains and made it out to Carmacks.
- Oct 13 Went back to Whitehorse where we got Sweden's D-6 and went back out and winched out loader. Then back to town.
- Oct 15 Went back into get Bobcat and 4-wheeler
- Oct 16 Went on a traverse along granite bluffs on the left limit and looped out around 1/2 mile from the creek to determine where all the ultramafics in the creek may be coming from. Found only gravel and granite with almost no alteration anywhere.
- Oct 17 Found some quartz coming out of Buffalo Lake basin and after looking around found a rusty altered quartz vein. Carmacks for the night.
- Oct 18 Back to Whitehorse

PARA-032

SHEET 105G-6

QUARTZ & PLACER

LATITUDE 61° 15' to 61° 30'
LONGITUDE 131° 00' to 131° 30'

SCALE 1:31,680

ISSUED UNDER THE AUTHORITY OF THE MINISTER OF INDIAN AFFAIRS AND NORTHERN DEVELOPMENT

NOTICE

THIS MAP IS ISSUED AS A PRELIMINARY GUIDE FOR WHICH THE DEPARTMENT OF INDIAN AFFAIRS AND NORTHERN DEVELOPMENT WILL ACCEPT NO RESPONSIBILITY FOR ANY ERRORS, INACCURACIES OR OMISSIONS WHATSOEVER.

Note: Entry on certain lands is withdrawn from staking in cross-hatched areas to facilitate the settlement of Native Land Claims without prejudice to Existing Surface and Subsurface Rights.

105G-12	105G-11	105G-10
105G-5	105G-6	105G-7
105G-4	105G-3	105G-2

Canada

WATSON LAKE
28 Feb. 84
27 Mar. 72
22 Mar. 56



MAP 87-032

SHEET 105G-II

LATITUDE 61° 30' To 61° 45'
LONGITUDE 131° 00' To 131° 30'

CANADA
DEPARTMENT OF NORTHERN AFFAIRS AND NATIONAL RESOURCES
NORTHERN ADMINISTRATION AND LANDS BRANCH
LANDS DIVISION

SCALE: 1/2 MILE TO 1 INCH

FT. 1500 3000 4500 6000 7500 9000 10500

ISSUED UNDER THE AUTHORITY OF THE MINISTER
OF NORTHERN AFFAIRS AND NATIONAL RESOURCES

NOTICE

THIS MAP IS ISSUED AS A PRELIMINARY GUIDE FOR WHICH THE DEPARTMENT OF INDIAN AFFAIRS AND NORTHERN DEVELOPMENT WILL ACCEPT NO RESPONSIBILITY FOR ANY ERRORS, INACCURACIES OR OMISSIONS WHATSOEVER.

1 MAR 79
2 OCT 79
3 SEP 79
29 AUG 87
19 MAR 88
23 FEB 89
18 JUL 88
18 JUL 88
26 JAN 89
21 JUL 89
10 MAR 87
17 MAY 86

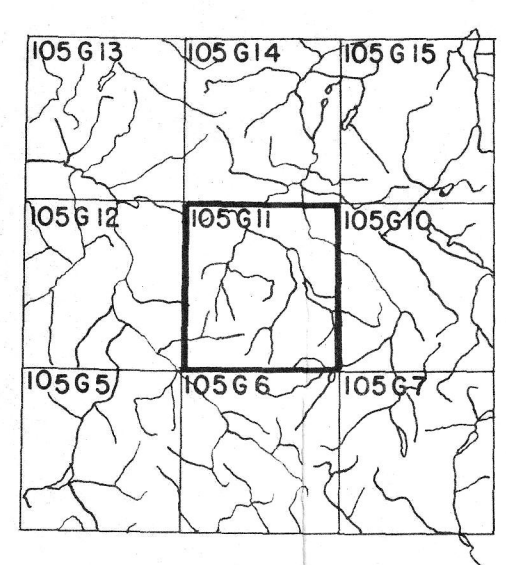
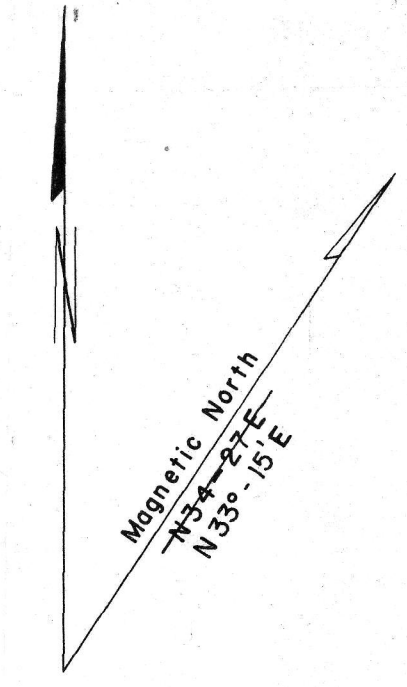

Note: Entry on certain lands is withdrawn from staking in cross-hatched areas to facilitate the settlement of Native Land Claims without prejudice to Existing Surface and Subsurface Rights.

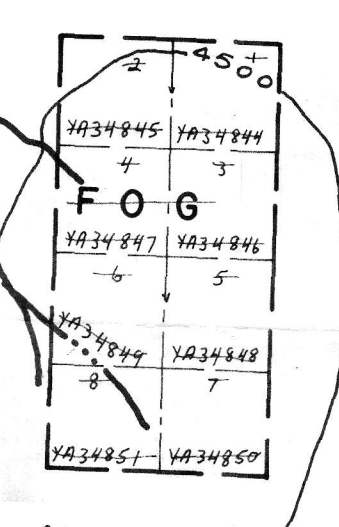

NOTE: OPEN SPACES BETWEEN CLUSTERS

DAP89-032

SHEET 115-H-16

LATITUDE 61° 45' To 62° 00'
LONGITUDE 136° 00' To 136° 30'

MOUNT MORRISON

CANADA
DEPARTMENT OF NORTHERN AFFAIRS AND NATIONAL RESOURCES
NORTHERN ADMINISTRATION BRANCH
RESOURCES DIVISION

SCALE: 1/2 MILE To 1 INCH
FT. 1500 0 500 1000 1500 2000 2500 3000 3500 4000 4500 5000 5500 6000 6500 7000 7500 8000 8500 9000 9500 10000 FT.

ISSUED UNDER THE AUTHORITY OF THE MINISTER
NORTHERN AFFAIRS AND NATIONAL RESOURCES

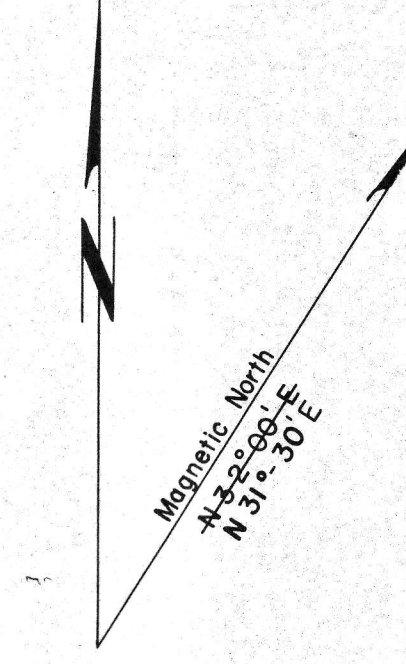

115-I-2	115-I-1	105-L-4
115-H-15	115-H-16	105-E-13
115-H-10	115-H-9	105-E-12

Note: Entry on certain Lands is withdrawn from staking by P.C.1988-1694, P.C.1988-1025 & P.C.1988-1011, to facilitate the settlement of Native Land Claims without prejudice to Existing Surface and Subsurface Rights.

NOTICE

THIS MAP IS ISSUED AS A PRELIMINARY GUIDE FOR WHICH THE DEPARTMENT OF INDIAN AFFAIRS AND NORTHERN DEVELOPMENT WILL ACCEPT NO RESPONSIBILITY FOR ANY ERRORS, INACCURACIES OR OMISSIONS WHATSOEVER.

30 AUG 88.
2 NOV 71.
14 FEB 61.
31 NOV 85.
01 OCT 81.
13 JAN 83.
01 OCT 88A.
01 SEPT 88.

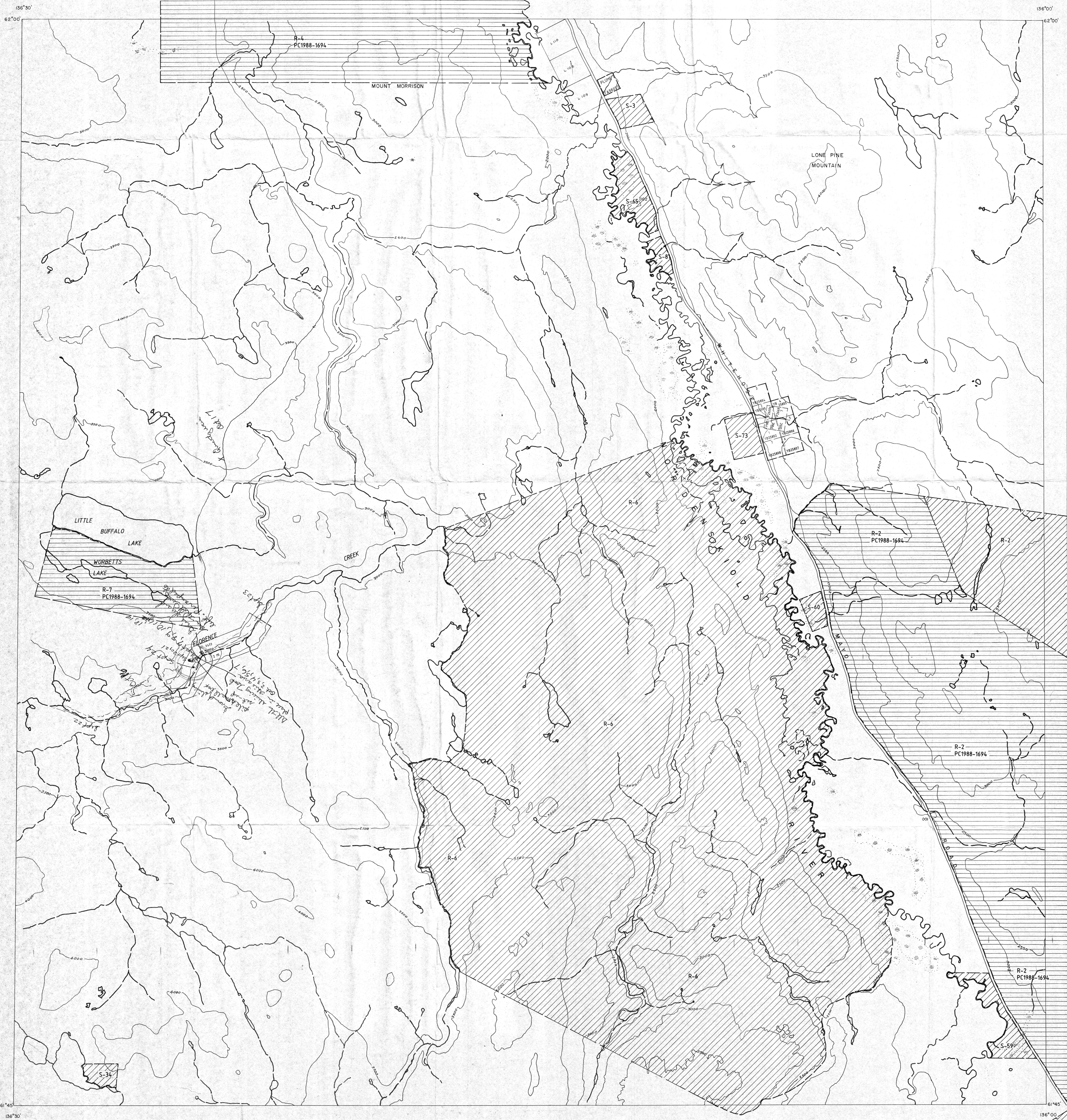

Mineral Rights Droits miniers

Canada

21 SEPT 84
 DAWSON 23 NOV 81

PLACER SHEET

116B-3b

LATITUDE 64°00' to 64°05'
 LONGITUDE 139°10' to 139°20'

SCALE 1:10,000

ISSUED UNDER THE AUTHORITY OF THE MINISTER
 OF INDIAN AFFAIRS AND NORTHERN DEVELOPMENT

PAR 88-832

*July 27, 28, 29, 30, 31
 Aug 1*

NOTICE

THIS MAP IS ISSUED AS A PRELIMINARY GUIDE FOR WHICH THE DEPARTMENT OF INDIAN AFFAIRS AND NORTHERN DEVELOPMENT WILL ACCEPT NO RESPONSIBILITY FOR ANY ERRORS, INACCURACIES OR OMISSIONS WHATSOEVER.

TOPOGRAPHY COMPILED FROM 150,000 NATIONAL TOPOGRAPHIC SERIES. CONTOUR INTERVAL 100 FEET. SURVEY INFORMATION COMPILED FROM LEGAL SURVEYS, BY DRAFTING SERVICES.

NOTE: ENTRY ON CERTAIN LANDS IS WITHDRAWN FROM STAKING BY P.C. 1984-2829 TO FACILITATE THE SETTLEMENT OF NATIVE LAND CLAIMS WITHOUT PREJUDICE TO EXISTING SURFACE AND SUBSURFACE RIGHTS.

116B-3	116B-3	116B-3
116B-3c	116B-3b	116B-3a
1150-141	1150-14b	1150-14g

NOTE: FOR QUARTZ CLAIMS SEE 116B-3



Mineral Rights / Droits miniers

PLACER SHEET

116B-3c

LATITUDE 64° 00' TO 64° 05'
 LONGITUDE 139° 20' TO 139° 30'

ISSUED UNDER THE AUTHORITY OF THE MINISTER
 OF INDIAN AFFAIRS AND NORTHERN DEVELOPMENT

SCALE 1:10,000

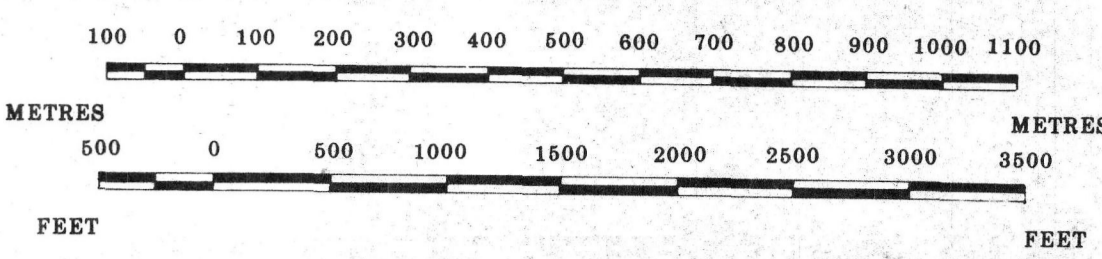

METERS: 0 500 1000 1500 2000 2500 3000 3500
 FEET: 0 1000 2000 3000 4000 5000

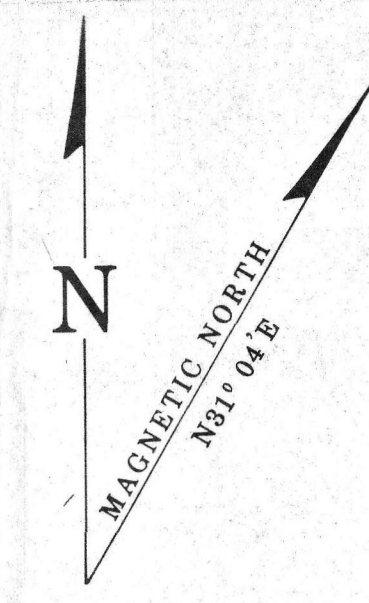

NOTE:
 THIS MAP IS ISSUED AS A PRELIMINARY GUIDE FOR WHICH THE DEPARTMENT OF INDIAN AFFAIRS AND NORTHERN DEVELOPMENT WILL ACCEPT NO RESPONSIBILITY FOR ANY ERRORS, INACCURACIES OR OMISSIONS WHATSOEVER.
 TOPOGRAPHY COMPILED FROM 1:50,000 NATIONAL TOPOGRAPHIC SERIES.
 CONTOUR INTERVAL 100 FEET.
 SURVEY INFORMATION COMPILED FROM LEGAL SURVEYS, BY DRAFTING SERVICES.
 Note: Entry on certain lands is withdrawn from staking in cross-hatched areas to facilitate the settlement of Native Land Claims without prejudice to Existing Surface and Subsurface Rights.

116B-4PL	116B-3PL
	116B-3c
	116B-3b
116B-13	116B-14
	116B-14B



Canada

DEC. 22 89
 AUG. 27 84
 NOV. 23 81

30 MAR 89
 15 FEB 89
 16 JAN 89
 19 JAN 89
 27 DEC 89

DAWSON

July 21, 22, 23

July 23

July 22

July 21

NOTE: FOR QUARTZ CLAIMS SEE 116B-3