

YEIP
2001-055
2001

Prospecting Report for Goring Creek

YMIP 01 -055

Prepared For David McBurney

By David McBurney

NTS Map Number 116 B2

Grid Coordinates 031021 - 033027

Claim Numbers P35209 - P35229

Dates 9th September - 12th September, 2001

YEIP
2001-055
2001

TABLE OF CONTENTS

Prospecting - Goring Creek

Technical Report	Page 1
Interpretation	Page 1
Prospecting - Goring Creek ..	Page 3
Summary of expenditures	Page 5
Maps	Page 6
Photos	Page 10

TECHNICAL REPORT

Work was carried out on claims # P35219, P35224, P35225, owned by R Berglund

Dates 9th - 12th September, 2001

Work performed by David McBurney, Box 475, Dawson City
Roland Berglund, Bonanza Sales, Dawson City

Report prepared by David McBurney, address as above
Ren Causer, Box 475, Dawson City

Drilling Equipment 6 inch auger drill

Samples were cleaned up using a long tom, and then the concentrate was panned

Details of drilling enclosed

Maps enclosed

INTERPRETATION

Two holes were drilled, 30m apart, on both sides of Goring Creek, on claim # P35219
We had anticipated finding bedrock at a relatively shallow depth, however both holes reached bedrock at around 70 ft, and both contained a typical creek section of thick mud (60 - 70 ft) and thin gravel (3 - 6 ft)

Hole 1/ contained only a trace of gold

Hole 2/ yielded 70mg of coarse and flat gold

This is a totally uneconomic proposition when the depth of ground is taken into consideration

It was decided to drill around the old shafts on claim # P35224 / P35225

Bedrock was reached at 40 ft in hole 3/, between two shafts The mud layer was only 25 ft thick, bedrock was very sticky gumbo

The sand and gravel layer yielded only a trace of gold

Hole 4/ was directly down valley from the main production shaft The mud layer was 35 ft thick
Drilling could not proceed beyond a boulder at 48 ft

Hole 5/ was drilled 3m N of hole 4/ Bedrock was thought to have been reached at 53 ft, and drilling continued to 58 ft When the stem was pulled however, it contained no bedrock Instead the material was very soft silt, fine sand, and chips of wood

It is assumed this is an infilled drift, and that bedrock was directly below this, probably at around 60 ft

The samples from holes 4/ and 5/ contained only a trace amount of very fine gold The material was very sticky and gumbo-like

INTERPRETATION cont

Sample 5/ also contained a 1/4 cup size lump of dark grey grease which could only have come from the drill hole. This lends support to the theory that old-timers works were encountered in the drill hole.

It was decided not to proceed any further with drilling on this property. This was based on the following features:

Bedrock is rotten granite/gumbo which is very hard to sluice, and probably resulted in a fairly high gold loss in the old sluiced tailings from the shafts. The \$5 00CDN/yd³ value previously obtained from sluicing the tailings could represent something like 20 - 30% of the total gold content, as opposed to the 10% normally estimated. If this was the case, the original value of the mined gravels prior to sluicing would be around \$20 00CDN/yd³.

The 70mg recovered from hole 2/ represents approx \$15 00CDN/yd³, based on a 6 ft section.

The 20 - 30 ft gravel/sand section in the area of the old shafts contains only trace gold, and would have to be stripped, in addition to the thick mud section.

This depth of stripping would be fairly high cost, and even at \$1 00/yd to strip, the cost of reaching pay gravels would be at least \$20 00/yd² of bedrock.

The pay channel is narrow. The two old prospect shafts, and shallow bedrock in hole 3/ with trace gold only, indicates there is a large section of valley width with no pay. The total volume of pay gravels is unlikely to exceed 10,000yd³ per claim, based on a channel 100 ft wide, and a depth of 6 ft. Such a small volume would have to grade substantially more than \$20/yd³ to warrant an economic mine.

This small drilling program did not come up with any results to encourage further testing.

- 1/ 140m downstream from claim post #2 35219 18m from creek, R) limit
 Old bridge across creek here
 This hole is 20m higher elevation than boiler/shafts, another 10m elevation to creek crossing /
 end of 4WD access

0 - 58 ft	Mud / silt
58 - 64 ft	Gravel
64 - 69 ft	Bedrock

Test Sample

Lots of groundwater, wet sample, but most drill flights were full of material
 Trace of very fine gold and 1 small, very light, flake
 All of sample gumbo-like, had to be extensively puddled

- 2/ 30m from 1/, across creek 12m (left limit), same elevation
 15m out from edge of hill on left limit

40 - 50 ft	Gravel, with some minor sand layers
50 - 56 ft	Mud? Smooth drilling
56 - 57 ft	Sand? Gritty drilling
57 - 70 ft	Mud? Smooth drilling
70 - 73 ft	Gravel
73 - 75 ft	Bedrock Dry quartz schist Good sample on drill stem

Test Sample

Dry hole Lots of pans of mid gravel layer - no colours at all
 Mostly quartz/granite sands, bits of granite, etc
 70mg gold Some coarse gold to 3mm, some flat flakes, some specks

- 3/ Downstream, near old shafts 170m up track from claim post #1, P35226 #2 P35225
 35m down track from main shaft, and 35m to creek from track

0 - 25 ft	Mud, silt
25 - 28 ft	Sand
28 - 33 ft	Gravel
33 - 38 ft	Sand
38 - 40 ft	Gravel
40 - 59 ft	Silt ?, occasional stone
59 - 63 ft	Gravel?
63 - 69 ft	?

Note 40 - 69 ft - Rotten granite/gumbo bedrock with occasional band of competent
 bedrock

Green and green/yellow/tan colour

Test Sample

Trace to 5mg Lots of very, very fine specks

4/ Hole 4 - 5m W of access track, 30m E of 3/, 38m N of shaft with boiler

0 - 35 ft	Mud
35 - 38 ft	Sand / gravel / silt layers
38 - 42 ft	Gravel
42 - 48 ft	Gravel, silt layers, stopped on boulder - couldn't drill through

Test Sample

Bottom drill stem had lost its sample when pulled
Trace of very fine gold only

5/ 3m N of 4/

0 - 31 ft	Mud, Lots of wood top 10 ft
31 - 35 ft	Coarse gravel
35 - 38 ft	Sand
38 - 41 ft	Gravel
41 - 45 ft	Sand / clay? wood?
45 - 46 ft	Gravel
46 - 50 ft	Sand, some gravel
50 - 53 ft	Gravel
53 - 58 ft	? Bedrock, Smooth drilling

Test Sample

Silt / fine sand/ wood from 53 -58 ft - old infilled drift / mined out old ground
Trace of very fine gold only

V111 SUMMARY OF EXPENDITURES

1	Daily living allowance	\$ 35 00/day x 2 x 4 days	\$280 00
2	Transport	60 km/day @ 0 42c = \$25 20/day x 4	\$100 00
		Set-up/demob 60km x2 @0 42c/km	\$50 00
3	Not applicable		
4	Not applicable		
5	Drilling	\$10 00 ft x 319 ft	\$3190 00
		Daily mob fee \$100 00 x 4	\$400 00
		Hauling drill mob/demob	\$500 00
6	Not applicable		
7	Not applicable		
8	Not applicable		
9	Not applicable		
10	See 5 above		
11	Not applicable		
12	Report Preparation	1 1/2 days applicant @ \$350 00/day	\$525 00
		1 day typist, printing, binding etc	\$200 00
13	Other expenses	Wages - applicant \$350 00/day x 4 days	\$1400 00
		Topo/claim maps	<u>\$10.00</u>
TOTAL			<u>\$6655.00</u>

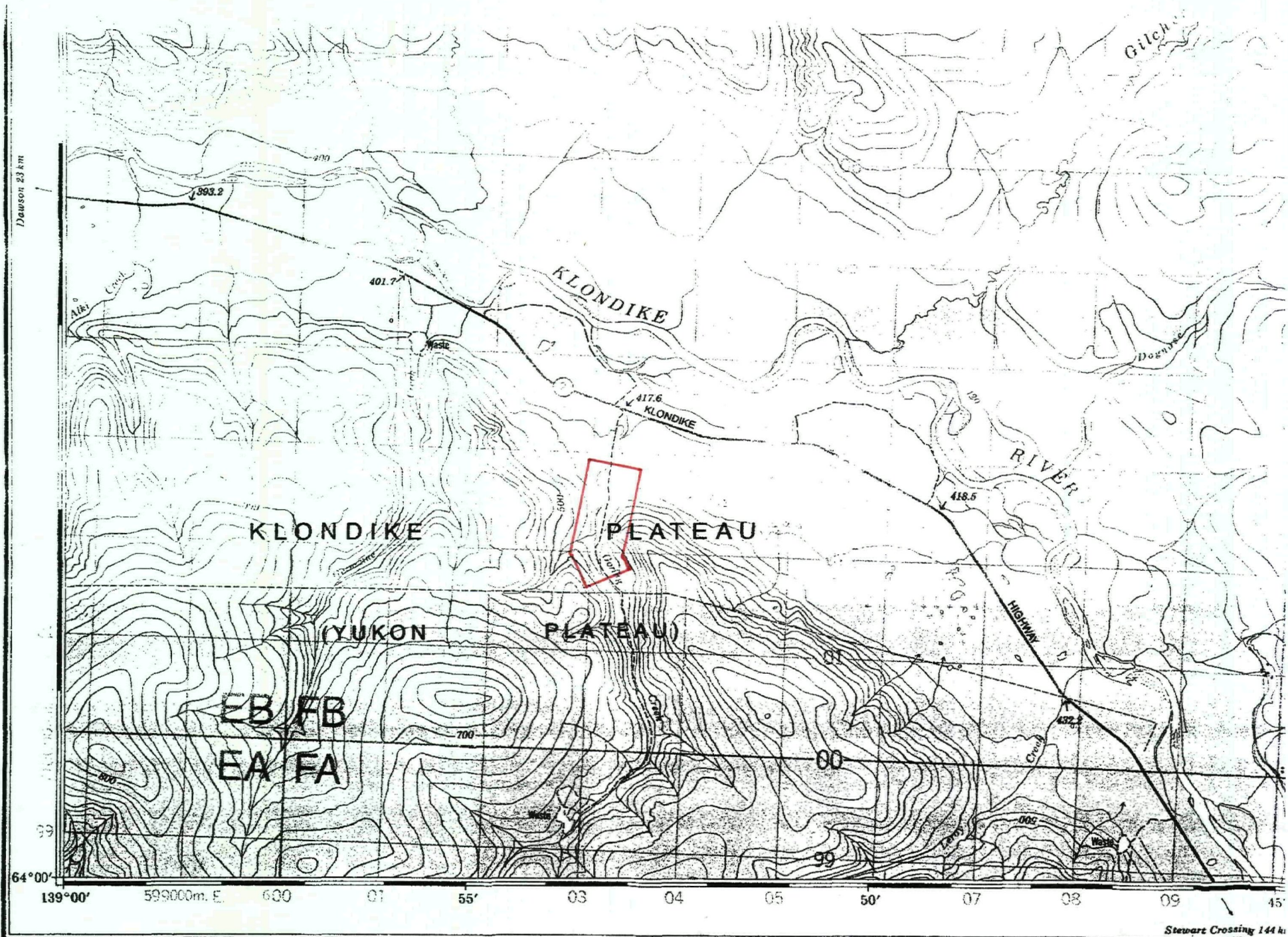

PRODUCED BY THE CANADA CENTRE FOR MAPPING,
 DEPARTMENT OF ENERGY, MINES AND RESOURCES.
 INFORMATION CURRENT AS OF 1989. PUBLISHED IN 1993.

COPIES MAY BE OBTAINED FROM THE CANADA MAP OFFICE,
 DEPARTMENT OF ENERGY, MINES AND RESOURCES,
 OTTAWA, OR YOUR NEAREST MAP DEALER.

Roads:
 hard surface
 hard surface

Routes:
 revêtement dur
 revêtement dur



NTS MAP # 116 B/2
 PROSPECTING AREA OUTLINED IN RED.

RABBIT
 YUKON TERRITORY

Stewart Crossing 144 km

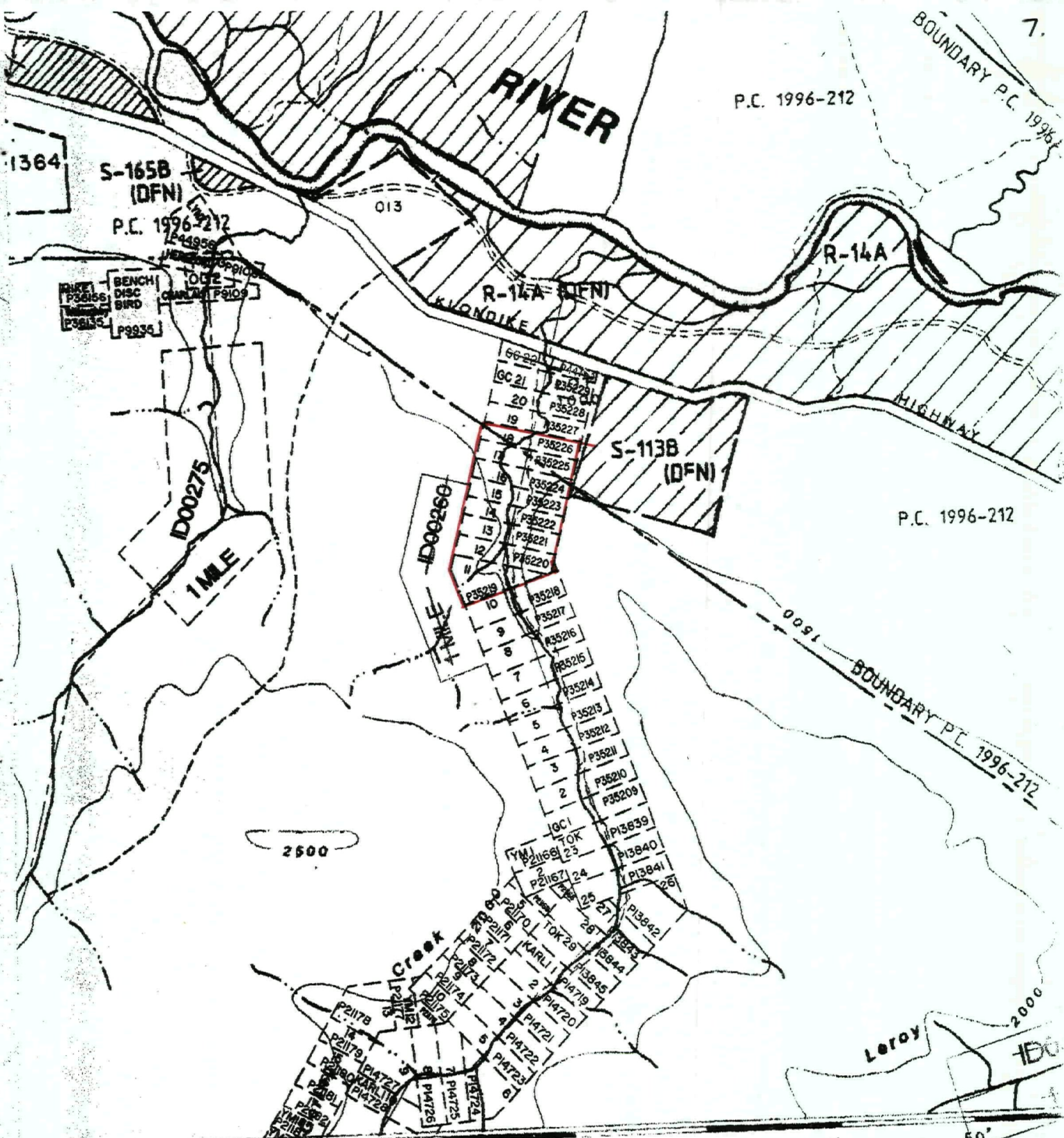

NTS MAP # 116 B/2
 PROSPECTING AREA OUTLINED IN RED

GORING CREEK

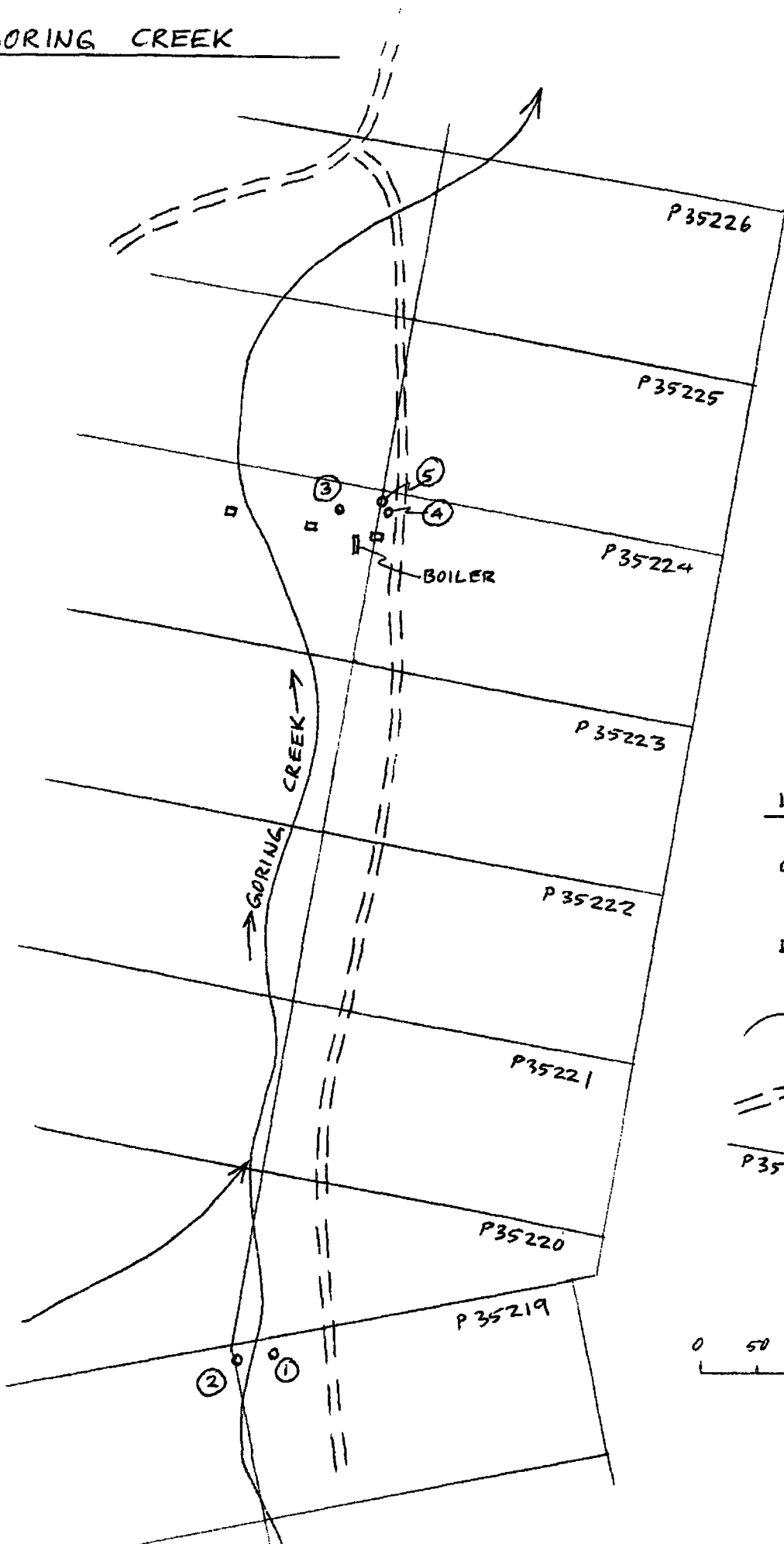

LEGEND

○ (2) DRILL HOLE & NUMBER

□ OLD SHAFT

→ CREEK

== ACCESS TRACK

P35221 | CLAIM BOUNDARY & NUMBER



SCALE (APPROX)
1:5000

SCHEMATIC CROSS SECTIONS - GORING CREEK

NOT TO SCALE

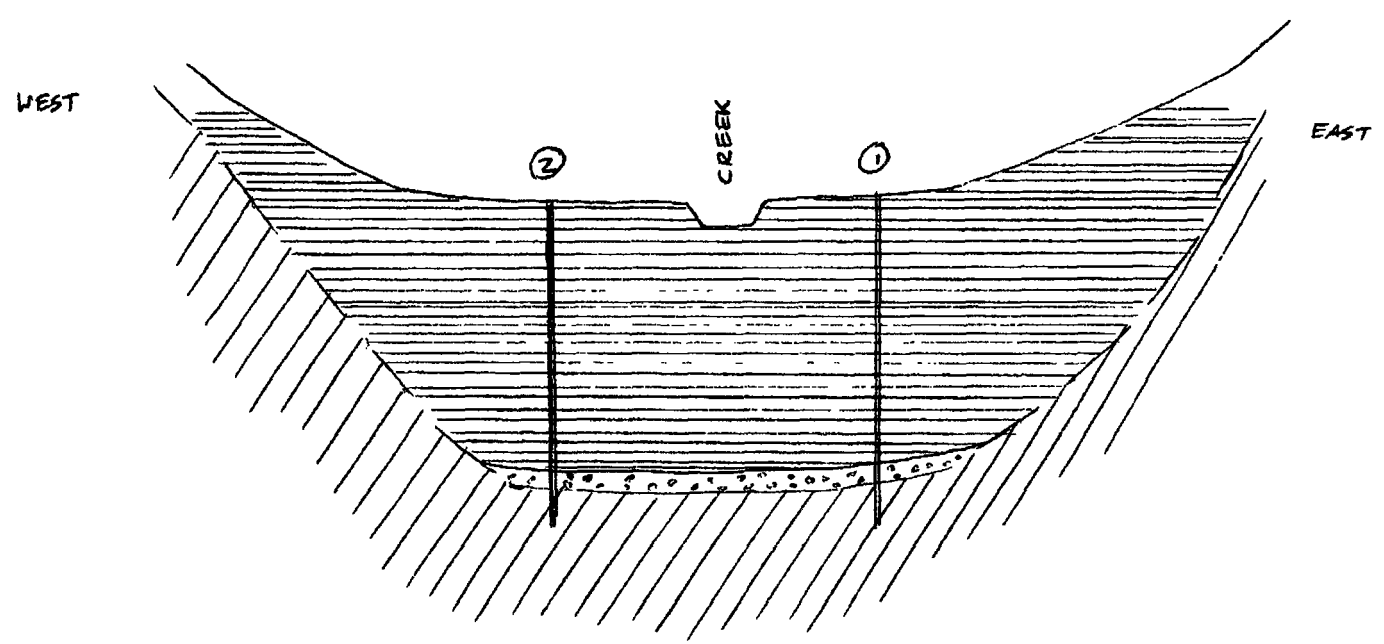
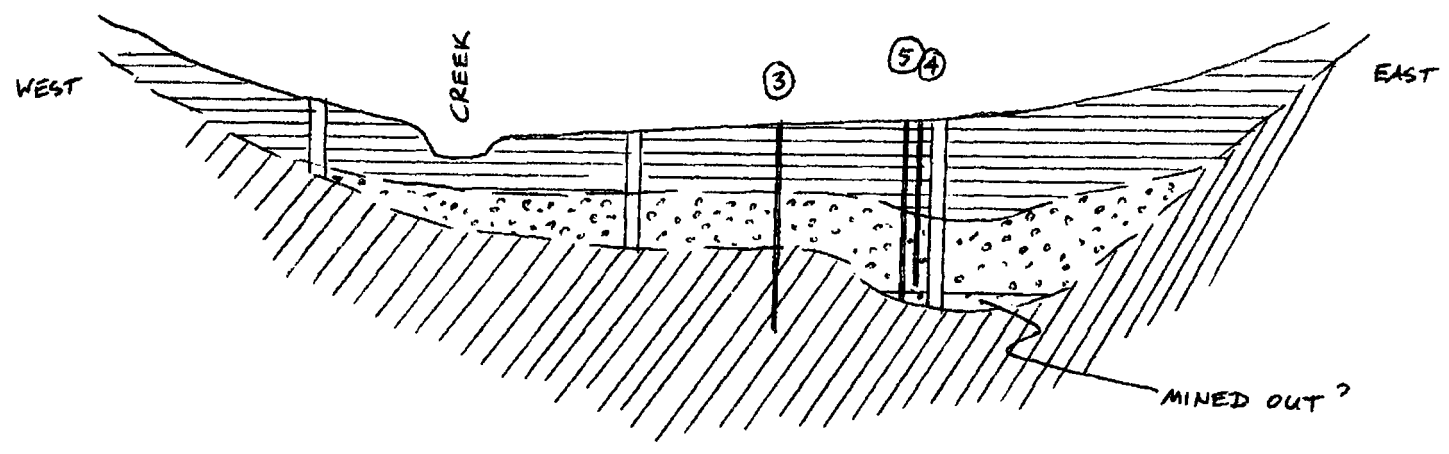

LEGEND

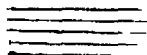
 MUD/SILT/CLAY

 BEDROCK

 DRILL HOLE & NUMBER

 GRAVEL/SAND

 OLD SHAFT



DRILLING HOLE #3 , GORING CK.
SITE OF OLD BOILER & SHAFTS & TAILINGS .



OLD BOILER , GORING CK.



DRILLING HOLE #2 , GORING CK.

FAITH CLAIM BOUNDARY

Creek

L 27W

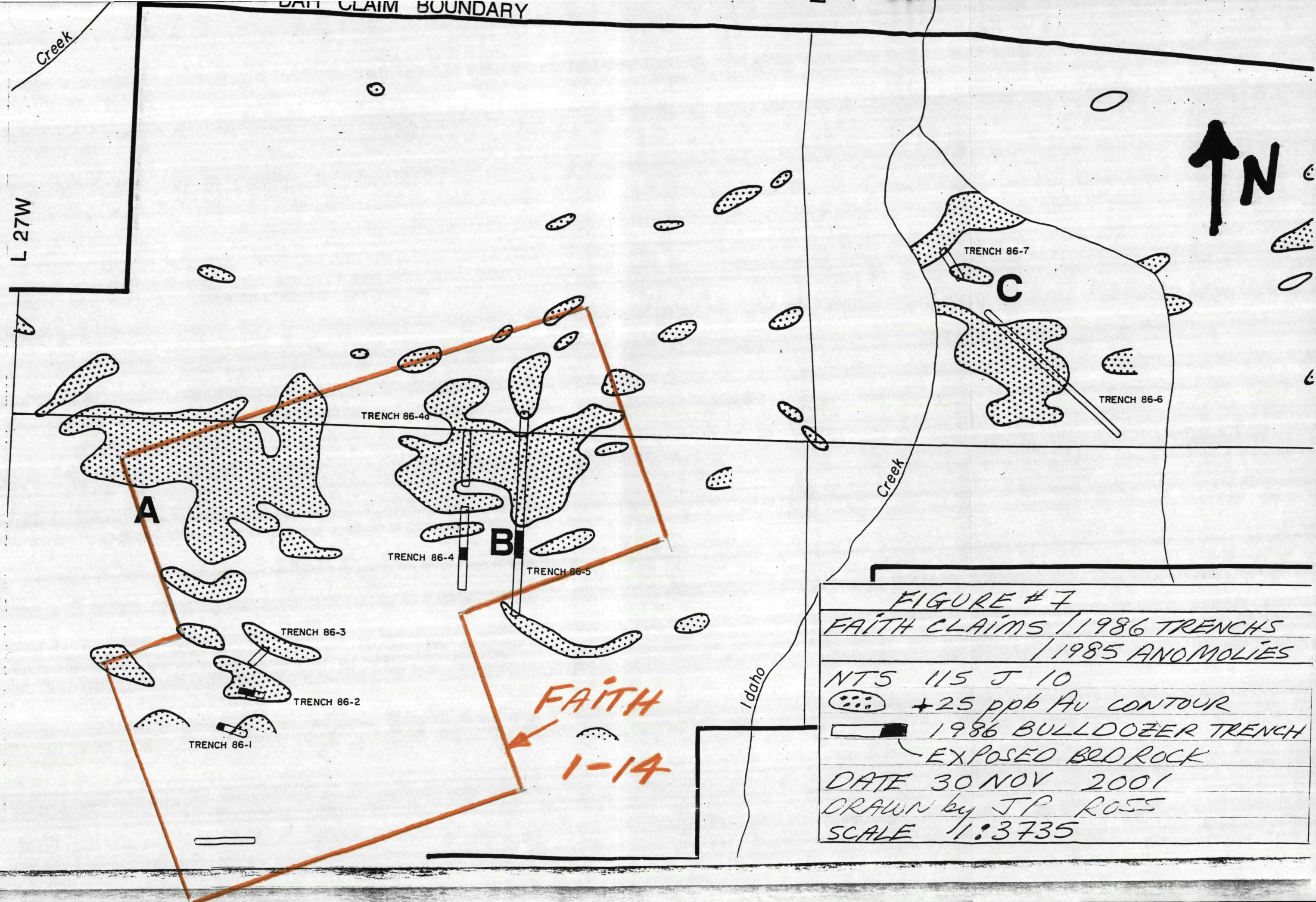

FIGURE #7
 FAITH CLAIMS / 1986 TRENCHES
 / 1985 ANOMOLIES
 NTS 115 J 10
 (stippled circle) +25 ppb Au CONTOUR
 (thick line) 1986 BULLDOZER TRENCH
 (thin line) EXPOSED BEDROCK
 DATE 30 NOV 2001
 DRAWN by JP ROSS
 SCALE 1:3735

FIGURE #6
 BEDROCK TRENCHS (2001)
 1986 TRENCHS
 WHITEHORSE MIN. DIST.
 NTS 115 J 10
 2001 BEDROCK TRENCH
 DATE 30-NOV-2001
 DRAWN by J.P. ROSS
 SCALE 1:200

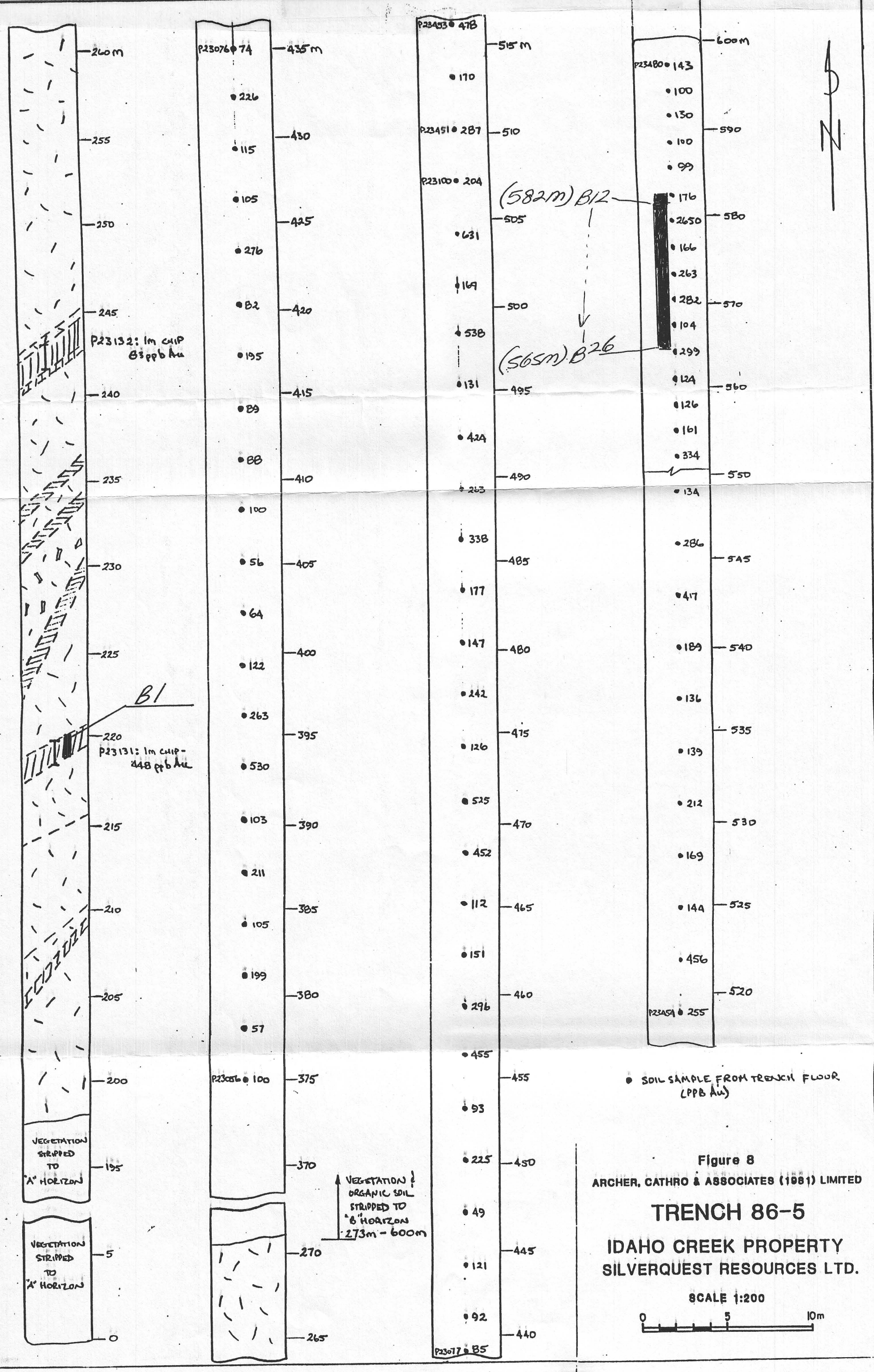
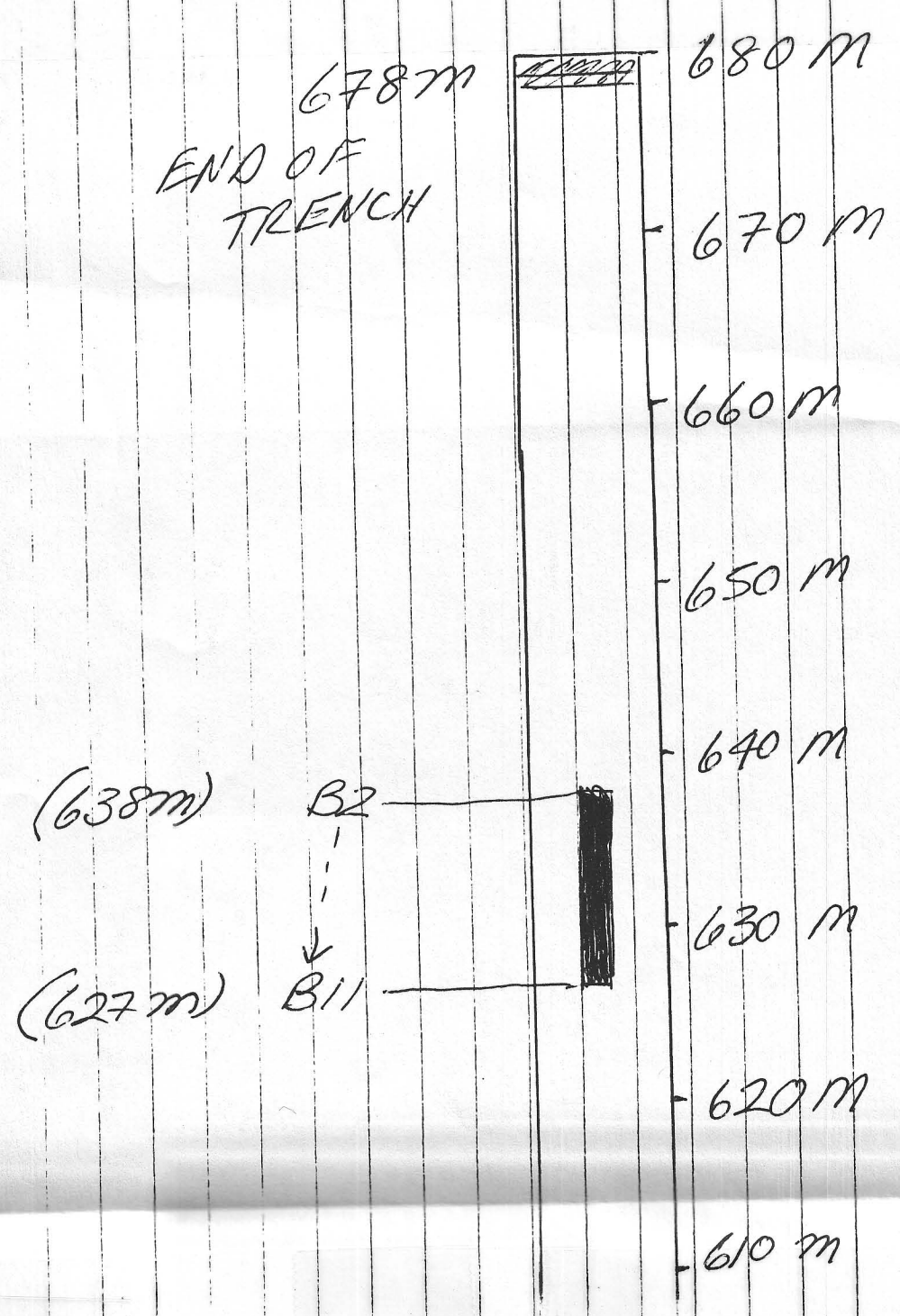

FIGURE #5
 FLOAT/BEDROCK SAMPLES
 11986 TRENCHES
 WHITEHORSE MIN. DIST.
 NTS 115 J 10
 X FLOAT SAMPLE
 BEDROCK SAMPLE
 DATE 30-NOV-2001
 DRAWN BY JTP ROSS
 SCALE 1:200

