

**ABROL-AKA GOLD MINING CORP
ABROL KAKHAROV
90 BURNDALE AVE.
TORONTO, ON M2N 1S7**

DECEMBER 31, 2009

**YUKON MINING INCENTIVE PROGRAM
ENERGY, MINES AND RESOURCES
BOX 2703 (K102)
WHITEHORSE, YUKON Y1A 2C6**

**SUMMARY AND TECHNICAL REPORT
FINAL SUBMISSION AND REIMBURSEMENT REQUEST
09-068 NTS 116C01**

**PROSPECTING LEASE NO: ID00643
PLACER CLAIM NO: P49441, P49442, P49443
P49444, P49445, P49446
P49447, P49448, P49449**

**GPS: NW CORNER -- 140^o 21' 59" W
64^o 5' 29" N**

**NE CORNER -- 140^o 21' 14" W
64^o 5' 21" N**

**SW CORNER -- 140^o 21' 56" W
64^o 4' 45" N**

**SE CORNER -- 140^o 21' 3" W
64^o 4' 45" N**

**SUMMARY AND TECHNICAL REPORT
FINAL SUBMISSION AND REIMBURSEMENT REQUEST
CALIFORNIA CREEK PROJECT
ABROL KAKHAROV**

Page 10 Clarification

Most samples were collected from A Horizon, within 6 inches of the surface soil. Additional samples were selected from B Horizon, just below vegetation roots. All samples were taken from less than 1 meter in depth. The chosen sample sites varied. Some samples were collected from completely flat areas near water's edge. Others were taken from more distant spots, heavily covered with vegetation. Several samples were collected from the creek bank itself approximately 1 meter above water level as shown on page 10 of the "Summary and Technical Report". These samples were sluiced and panned on location. Approximately 30% of the samples consisted of soil only. The remainder contained small, rounded gravels, quartz fragments and schist. No samples were collected from below the water. A Fisher Gold Bug II Detector was used in the creek itself to scan for coarse gold. The water was clear, cold and moving slowly downstream as could be expected in early July. No coarse gold was located. Sample sites were numbered but not individually photographed.

Page 12 Correction

Sample CCS 018 was estimated to be .1 OZ/YD³ Au. Somehow, the . was deleted when "right justify and spell check" took place. The chart was correct. The text on page 12 contained the error. Thank you for bringing that to our attention. Due to the difficulty in accurately measuring small amounts of flour gold in panned concentrates, the values established for these samples were visual and not supported by assay.

Pages 13 and 14, Sample Chart

The sample chart will be converted to EXCEL SPREADSHEET FORMAT as requested and forwarded separately.

Please attach these modifications to the previously submitted California Creek Summary and Technical Report.

| CALIFORNIA CREEK SAMPLE CHART | | |
|-------------------------------|--------------------------------|--------------------|
| SAMPLE # | GPS | OZ/YD ³ |
| CCS 001 | 140° 21' 49.3"W 64° 5' 27.5" N | --- |
| CCS 002 | 140° 21' 34.4"W 64° 5' 27.5" N | --- |
| CCS 003 | 140° 21' 21.3"W 64° 5' 27.5" N | --- |
| CCS 004 | 140° 21' 48.3"W 64° 5' 24.6"N | 0.001 |
| CCS 005 | 140° 21' 33.7" W 64° 5' 24.6"N | --- |
| CCS 006 | 140° 21' 49.4"W 64° 5' 24.6"N | 0.001 |
| CCS 007 | 140° 21' 33.6"W 64° 5' 23.2"N | 0.001 |
| CCS 008 | 140° 21' 20.5"W 64° 5' 22.9"N | 0.02 |
| CCS 009 | 140° 21' 44.2"W 64° 5' 19.9"N | 0.01 |
| CCS 010 | 140° 21' 23.9"W 64° 5' 19.9"N | 0.02 |
| CCS 011 | 140° 21' 36.6"W 64° 5' 18.0"N | 0.01 |
| CCS 012 | 140° 21' 30.3"W 64° 5' 18.2"N | --- |
| CCS 013 | 140° 21' 18.2"W 64° 5' 18" N | --- |
| CCS 014 | 140° 21' 34.5"W 64° 5' 14.8N | 0.001 |
| CCS 015 | 140° 21' 17.9"W 64° 5' 14.8"N | 0.001 |
| CCS 016 | 140° 21' 44.4"W 64° 5' 12.6"N | 0.02 |
| CCS 017 | 140° 21' 32.9"W 64° 5' 13.3"N | 0.02 |
| CCS 018 | 140° 21' 15.9"W 64° 5' 13.4"N | 0.1 |
| CCS 019 | 140° 21' 35.1"W 64° 5' 9.7"N | 0.001 |
| CCS 020 | 140° 21' 18.8"W 64° 5' 9.9"N | 0.02 |
| CCS 021 | 140° 21' 42.1"W 64° 5' 8.1"N | 0.02 |
| CCS 022 | 140° 21' 28.5"W 64° 5' 8.2"N | --- |
| CCS 023 | 140° 21' 15.7"W 64° 5' 8.4"N | --- |
| CCS 024 | 140° 21' 31.4"W 64° 5' 4.9"N | --- |
| CCS 025 | 140° 21' 20.3"W 64° 5' 4.8"N | --- |
| CCS 026 | 140° 21' 41.3"W 64° 5' 3.2"N | --- |
| CCS 027 | 140° 21' 27.9"W 64° 5' 3.5"N | --- |
| CCS 028 | 140° 21' 17.3"W 64° 5' 3.4"N | 0.01 |
| CCS 029 | 140° 21' 32.8"W 64° 4' 59.9"N | 0.01 |
| CCS 030 | 140° 21' 22.0"W 64° 4' 0.2"N | 0.01 |
| CCS 031 | 140° 21' 39.9"W 64° 4' 58.3"N | 0.01 |
| CCS 032 | 140° 21' 28.2"W 64° 4' 58.2"N | 0.01 |
| CCS 033 | 140° 21' 20.0"W 64° 4' 58.4"N | --- |
| CCS 034 | 140° 21' 28.7"W 64° 4' 55.2"N | --- |
| CCS 035 | 140° 21' 17.8"W 64° 4' 55.0"N | --- |
| CCS 036 | 140° 21' 35.4"W 64° 4' 53.6"N | --- |
| CCS 037 | 140° 21' 26.1"W 64° 4' 53.7"N | --- |
| CCS 038 | 140° 21' 14.5"W 64° 4' 53.5"N | 0.02 |
| CCS 039 | 140° 21' 31.3"W 64° 4' 50.5"N | 0.02 |
| CCS 040 | 140° 21' 35.4"W 64° 4' 50.1"N | 0.05 |
| CCS 041 | 140° 21' 40.3"W 64° 4' 48.1"N | 0.005 |
| CCS 042 | 140° 21' 25.6"W 64° 4' 48.6"N | 0.005 |
| CCS 043 | 140° 21' 18.2"W 64° 4' 48.1"N | 0.005 |
| CCS 044 | 140° 21' 30.6"W 64° 4' 45.3"N | 0.005 |
| CCS 045 | 140° 21' 17.2"W 64° 4' 45.7"N | --- |

JAN - 8 2010

JAN 8 - NVF

TABLE OF CONTENTS

| | PAGE |
|--|-------------|
| COVER SHEET – SUMMARY AND TECHNICAL REPORT FINAL SUBMISSION AND REIMBURSEMENT REQUEST | 1 |
| TABLE OF CONTENTS (pages 1 - 10) | 2 |
| TABLE OF CONTENTS (pages 11 - 24) | 3 |
| TABLE OF CONTENTS (pages 25 - 28) | 4 |
| SUMMARY AND TECHNICAL REPORT | 5 |
| PHOTO CALIFORNIA CREEK – JULY 2009 | 6 |
| PREVIOUS INVESTIGATION AND HISTORY | 6 |
| PROJECT BACKGROUND | 7 |
| PHOTO – AERIAL VIEW OF CALIFORNIA CREEK | 7 |
| PROJECT BACKGROUND (CONTINUED) | 8 |
| ACTIVITIES COMPLETED IN 2009 | 9 |
| PROPOSAL PARTICIPANTS | 9 |
| PHOTO – ABROL, ROBERT, SHARON AND JOAN | 9 |
| SAMPLE COLLECTION | 10 |
| PHOTO – ROBERT COLLECTING SAMPLES | 10 |

| | |
|--|-----------|
| PHOTO – ROBERT PANNING CONCENTRATES | 11 |
| PHOTO – JOAN WITH FISHER GOLD BUG II | 11 |
| ANALYSES | 12 |
| SAMPLE CHART | 13 |
| SAMPLE CHART (CONTINUED) | 14 |
| SAMPLE LOCATION MAP (P49441 – P49443) | 15 |
| SAMPLE LOCATION MAP (P49444 – P49446) | 16 |
| SAMPLE LOCATION MAP (P49447 – P49449) | 17 |
| STAKING TO CLAIMS | 18 |
| PHOTO – ABROL AND ROBERT PREPARING CLAIM POST | 18 |
| PHOTO – ABROL AND ROBERT ERECTING CLAIM POST | 19 |
| PHOTO – SHARON AND ABROL WITH CLAIM POST 2 | 19 |
| PHOTO – SHARON, ROBERT AND ABROL AT CA. CREEK BASE CAMP | 20 |
| CLAIM MAP (P49441-P49449) | 21 |
| CONCLUSION AND RECOMMENDATIONS | 22 |
| COST AND REIMBURSEMENT REQUEST | 22 |
| FINAL SUBMISSION AND REIMBURSEMENT REQUEST | 23 |
| FINAL SUBMISSION AND REIMBURSEMENT REQUEST (CONTINUED) | 24 |

| | |
|---|-----------|
| YMIP FINAL SUMMARY REPORT FORM | 25 |
| YMIP FINAL SUMMARY REPORT FORM (PAGE 2) | 26 |
| YMIP FINAL SUBMISSION FORM | 27 |
| YMIP FINAL SUBMISSION FORM (PAGE 2) (SIGNATURE AND DATE) | 28 |

**ABROL-AKA GOLD MINING CORP.
ABROL KAKHAROV, PH.D
90 BURNDALE AVE.
TORONTO, ONTARIO
M2N1S7**

DECEMBER 31, 2009

**YUKON MINING INCENTIVES PROGRAM
ENERGY, MINES AND RESOURCES
BOX 2703 (K102)
WHITEHORSE, YUKON
Y1A2C6 CANADA**

SUMMARY AND TECHNICAL REPORT

Although the original application and exploration proposal included mechanical trenching, portions of the 14 kilometer access road to California Creek was impassable due to heavier than average snowfall and the ensuing runoff in late 2008 and early 2009. The unfavorable road conditions prevented machine trenching as proposed. Extensive hand sampling and material processing was chosen as an alternative to the proposed machine operation. Please see: "ACTIVITIES COMPLETED IN 2009"



California Creek – July, 2009

PREVIOUS INVESTIGATION AND HISTORY of the California Creek area dates back to 1918 with reports of “undetermined values”. In 1977 Cogasa Mining Corp. held a five mile placer lease on lower California Creek.

In 1981 and 1982, Panterra Resources began mining the property and constructed 2 settling ponds. A D7 and a D8 Bulldozer, along with loaders, and a processor consisting of grizzly, shaker screens and 2 long, narrow sluice boxes were used. No gold recovery figures were recorded.

In 1985 Wilshire Mortgage undertook a drilling program which reported frozen silt and gravel as deep as 30 feet before reaching bedrock. Depth to bedrock, however, averaged 6 to 10 feet. Nearly all samples taken at 2 foot intervals reportedly contained gold. The highest value (screened to minus 12 mesh) was 0.0229 ounces per ton and was taken in the feet preceding bedrock at a depth of 16 feet. It was reported that 6 samples contained 2 mesh or larger nuggets but were void of measureable fine gold.

In July and August, Karens began an exploration program which included 13 machine trenches. Frozen coarse gravel 8 to 11 feet deep were encountered. Calculations by Al Ollson indicated grades of \$7 to \$47 (approximately 0.02 to 0.12 ounces) per cubic yard were retrieved.

PROJECT BACKGROUND 2006

In 2006, ABROL-AKA GOLD MINING staked and recorded a section of California Creek (which is the left arm of the Sixty Mile River) to "Prospecting Lease". The site, which is approximately 100 km southwest of Dawson City, lies in a valley accessible by gravel road. Please see aerial view of California Creek and Prospecting Lease ID 00643

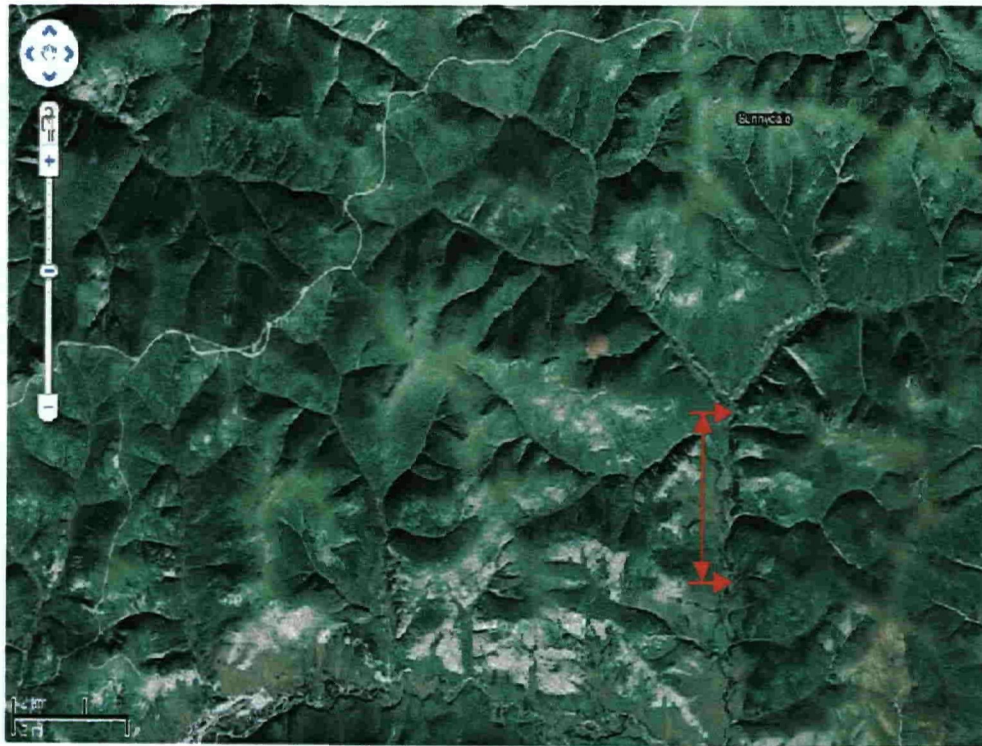

Map #1. Aerial view of California Creek, Dawson Mining District, Yukon.

Prior to staking, a visual examination and evaluation was completed by hand panning and sluicing at intervals of 200 and 300 meters throughout stream length. A temporary camp was established, samples of gold bearing ore were selected for further analysis and photographs taken of the site. A study of the district was conducted with the use of aerial photos and archived information.

IN 2007, a travel trailer was transported to the area for temporary habitation and to serve as a base of operation. Tents were erected and prospecting equipment was delivered to the site. Hand trenching was undertaken, with samples collected, washed and analyzed. Mineral analyses are shown on page 7 of the "2009 Proposal".

ACTIVITIES COMPLETED IN 2009

PROPOSAL PARTICIPANTS

All on site work was completed during the month of July by the 4 participants listed below:

Abrol Kakharov, Ph.D.
90 Burndale Ave.
Toronto, Ontario M2N1s7
Tele: 647 505 4381
416 364 4381
Fax: 416 221 3451
Kakharov@abrol-aka.com
Kakharov2004@mail.ru

Joan Betts, Ed.D.
PMB 4849, PO Box 2428
Pensacola, FL 32513
Tele: 775 830 8549
jvhexpat@yahoo.com

Robert T. Betts
PO Box 20317
Las Vegas, NV 89112
Tele: 775 830 8539
rtbatslt@yahoo.com

Sharon L. Betts, BA.
PO Box 20317
Las Vegas, NV 89112
Tele: 775 815 0627
wolfencritter@yahoo.com



Abrol, Robert, Sharon and Joan

SAMPLE COLLECTION

A 3 day sampling program was carried out on July 11, 12 and 13, with Forty-five separate samples, weighing 200 pounds each, collected and analyzed. Sample preparation was carried out by screening to ten mesh followed by weighing, labeling and transporting by wheelbarrow to a portable test sluice. Ground markings were made with spray painted numbers corresponding to the sample number.



Robert Collecting Samples at California Creek



Robert Panning Concentrates



Joan with Fisher Gold Bug II Detector at California Creek

ANALYSES

All samples collected consisted of approximately 50% rounded water-worn quartz pebbles with the remaining 50% intermixed with schist bedrock and soil. All samples were hand fed by the four members of the prospecting team: Abrol Kakharov, Ph.D, Robert Betts, Joan Betts, Ed.D and Sharon Betts, BA. The end concentrate from each sample was dried and placed in uncontaminated plastic bags for later examination in a more controlled environment. The gold occurs as smoothed and rounded grains with 90% measuring under 20 mesh and the remainder under 40 mesh. No gold greater than 40 mesh was encountered during the 2009 season. Some highlights from the sampling program include 1 OPY Au in sample CC18 and .05 OPY Au in sample CC40. Please see: **SAMPLE CHART** and **SAMPLE LOCATION MAPS: P49441, P49442, P49443, P49444, P49445, P49446, P49447, P49448, P49449.**

CALIFORNIA CREEK SAMPLE CHART

| SAMPLE # | | OZ PER YD |
|----------|--|-----------|
| CCS 001 | 140 ⁰ 21' 49.3"W 64 ⁰ 5' 27.5" N | --- |
| CCS 002 | 140 ⁰ 21' 34.4"W 64 ⁰ 5' 27.5" N | --- |
| CCS 003 | 140 ⁰ 21' 21.3"W 64 ⁰ 5' 27.5" N | --- |
| CCS 004 | 140 ⁰ 21' 48.3"W 64 ⁰ 5' 24.6" N | .001 |
| CCS 005 | 140 ⁰ 21' 33.7"W 64 ⁰ 5' 24.6" N | --- |
| CCS 006 | 140 ⁰ 21' 49.4"W 64 ⁰ 5' 24.6" N | .001 |
| CCS 007 | 140 ⁰ 21' 33.6"W 64 ⁰ 5' 23.2" N | .001 |
| CCS 008 | 140 ⁰ 21' 20.5"W 64 ⁰ 5' 22.9" N | .02 |
| CCS 009 | 140 ⁰ 21' 44.2"W 64 ⁰ 5' 19.9" N | .01 |
| CCS 010 | 140 ⁰ 21' 23.9"W 64 ⁰ 5' 19.9" N | .02 |
| CCS 011 | 140 ⁰ 21' 36.6"W 64 ⁰ 5' 18.0" N | .01 |
| CCS 012 | 140 ⁰ 21' 30.3"W 64 ⁰ 5' 18.2" N | --- |
| CCS 013 | 140 ⁰ 21' 18.2"W 64 ⁰ 5' 18" N | --- |
| CCS 014 | 140 ⁰ 21' 34.5"W 64 ⁰ 5' 14.8" N | .001 |
| CCS 015 | 140 ⁰ 21' 17.9"W 64 ⁰ 5' 14.8" N | .001 |
| CCS 016 | 140 ⁰ 21' 44.4"W 64 ⁰ 5' 12.6" N | .02 |
| CCS 017 | 140 ⁰ 21' 32.9"W 64 ⁰ 5' 13.3" N | .02 |
| CCS 018 | 140 ⁰ 21' 15.9"W 64 ⁰ 5' 13.4" N | 0.1 |
| CCS 019 | 140 ⁰ 21' 35.1"W 64 ⁰ 5' 9.7" N | .001 |
| CCS 020 | 140 ⁰ 21' 18.8"W 64 ⁰ 5' 9.9" N | .02 |
| CCS 021 | 140 ⁰ 21' 42.1"W 64 ⁰ 5' 8.1" N | .02 |
| CCS 022 | 140 ⁰ 21' 28.5"W 64 ⁰ 5' 8.2" N | --- |
| CCS 023 | 140 ⁰ 21' 15.7"W 64 ⁰ 5' 8.5" N | --- |
| CCS 024 | 140 ⁰ 21' 31.5"W 64 ⁰ 5' 4.9" N | --- |
| CCS 025 | 140 ⁰ 21' 20.3"W 64 ⁰ 5' 4.8" N | --- |
| CCS 026 | 140 ⁰ 21' 41.3"W 64 ⁰ 5' 3.2" N | --- |
| CCS 027 | 140 ⁰ 21' 27.9"W 64 ⁰ 5' 3.5" N | --- |
| CCS 028 | 140 ⁰ 21' 17.3"W 64 ⁰ 5' 3.4" N | .01 |
| CCS 029 | 140 ⁰ 21' 32.8"W 64 ⁰ 4' 59.9" N | .01 |
| CCS 030 | 140 ⁰ 21' 22.0"W 64 ⁰ 4' 0.2" N | .01 |

| SAMPLE # | | | | OZ PER YD |
|-----------------|----------|------------|-----------|------------------|
| CCS 031 | 140° 21' | 39.9"W 64° | 4' 58.3"N | .01 |
| CCS 032 | 140° 21' | 28.2"W 64° | 4' 58.2"N | .01 |
| CCS 033 | 140° 21' | 20.0"W 64° | 4' 58.4"N | --- |
| CCS 034 | 140° 21' | 28.7"W 64° | 4' 55.2"N | --- |
| CCS 035 | 140° 21' | 17.8"W 64° | 4' 55.0"N | --- |
| CCS 036 | 140° 21' | 35.4"W 64° | 4' 53.6"N | --- |
| CCS 037 | 140° 21' | 26.1"W 64° | 4' 53.7"N | --- |
| CCS 038 | 140° 21' | 14.5"W 64° | 4' 53.5"N | .02 |
| CCS 039 | 140° 21' | 31.3"W 64° | 4' 50.5"N | .02 |
| CCS 040 | 140° 21' | 35.4"W 64° | 4' 50.1"N | .05 |
| CCS 041 | 140° 21' | 40.3"W 64° | 4' 48.1"N | .005 |
| CCS 042 | 140° 21' | 25.6"W 64° | 4' 48.6"N | .005 |
| CCS 043 | 140° 21' | 18.2"W 64° | 4' 48.1"N | .005 |
| CCS 044 | 140° 21' | 30.6"W 64° | 4' 45.3"N | .005 |
| CCS 045 | 140° 21' | 17.2"W 64° | 4' 45.7"N | --- |

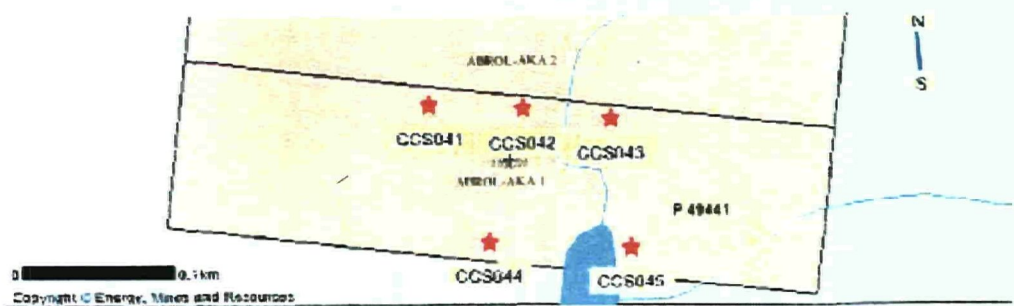

Copyright © Energy, Mines and Resources

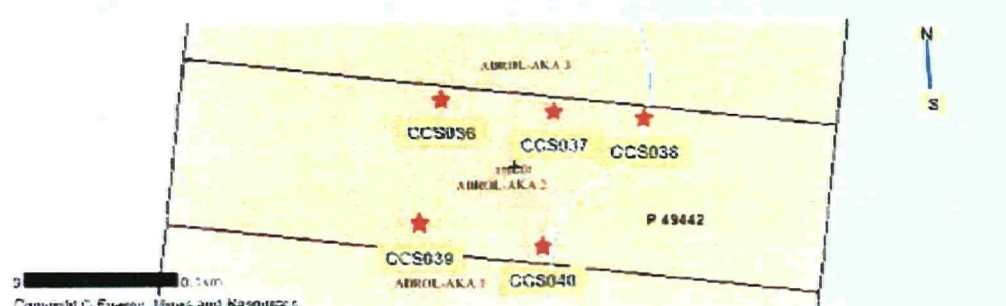

Copyright © Energy, Mines and Resources

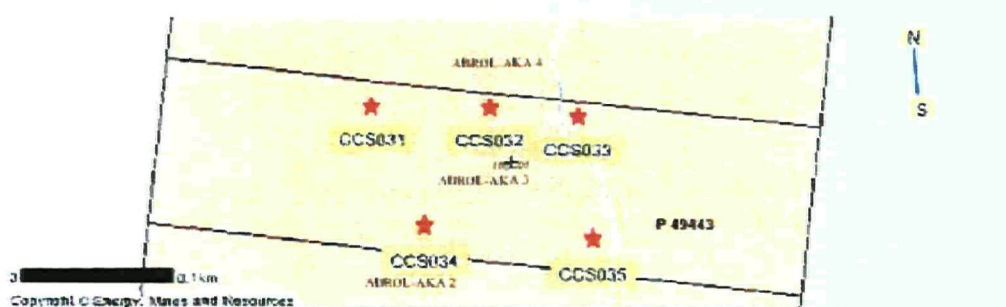

Copyright © Energy, Mines and Resources

SAMPLE LOCATIONS ARE APPROXIMATE. PLEASE SEE SAMPLE CHART FOR GPS READINGS.

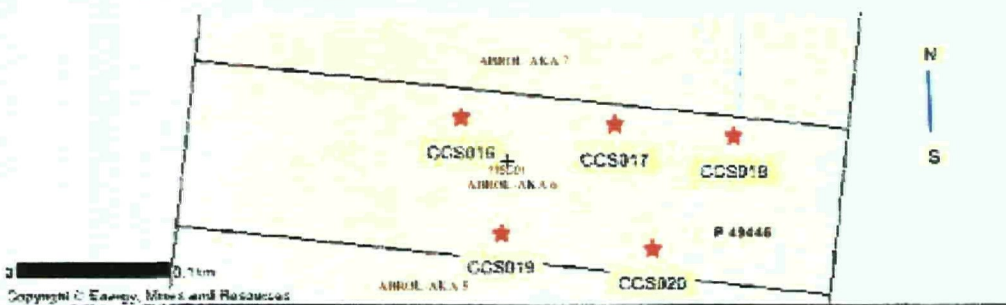
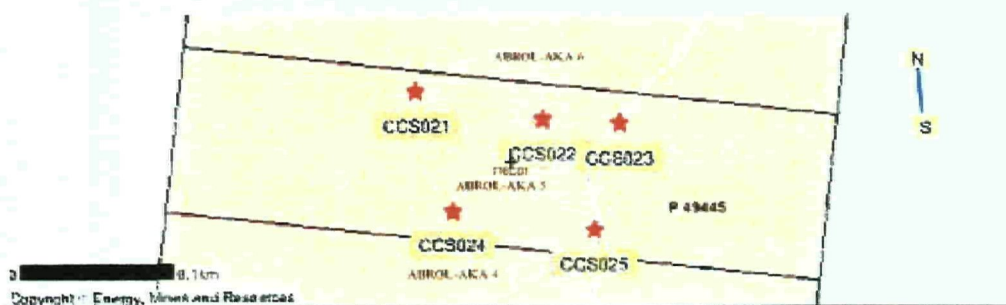
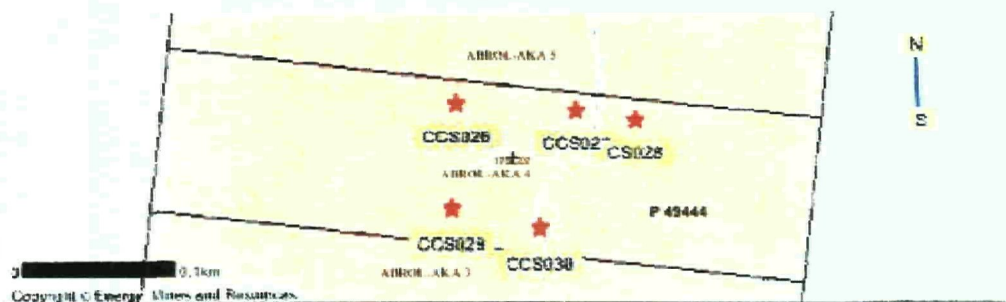

SAMPLE LOCATIONS ARE APPROXIMATE. PLEASE SEE SAMPLE CHART FOR GPS READINGS.

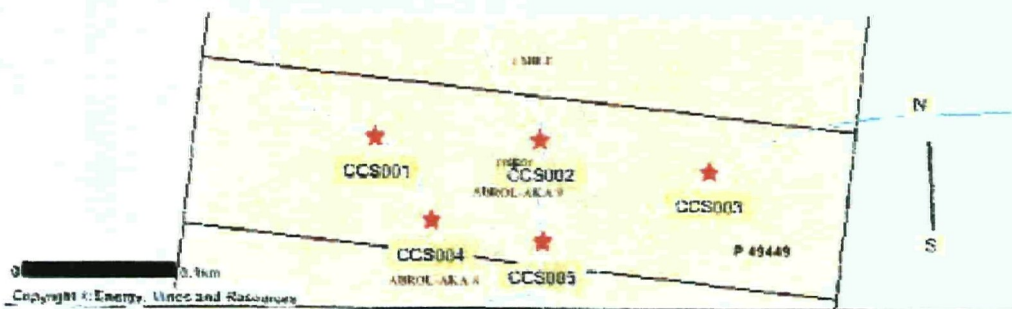
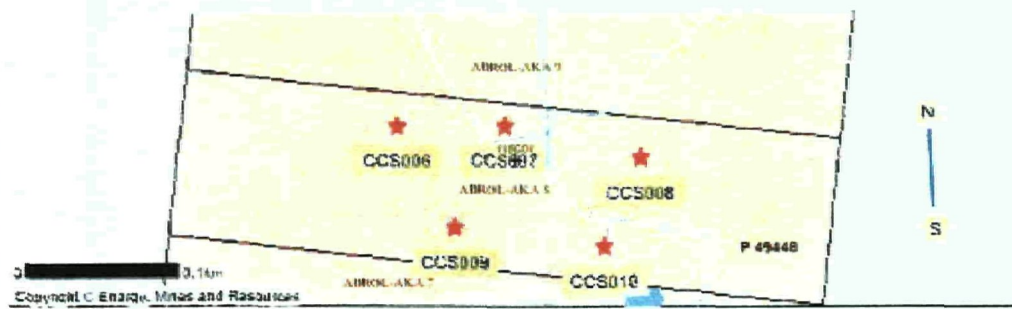
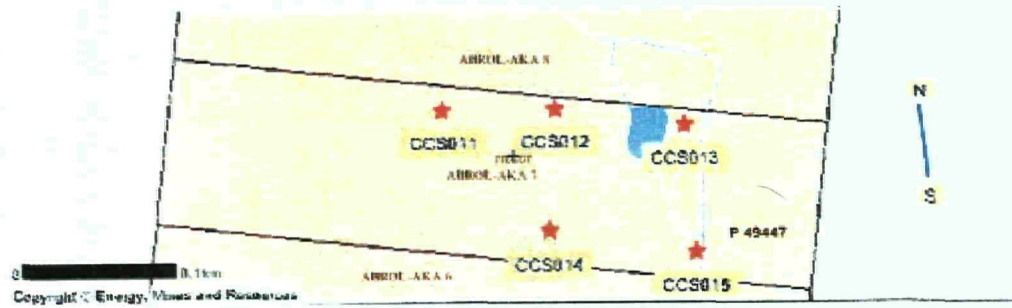

SAMPLE LOCATIONS ARE APPROXIMATE. PLEASE SEE SAMPLE CHART FOR GPS READINGS.

STAKING TO CLAIMS

On July 14, 2009, portions of Prospecting Lease ID00643 were staked to Placer Claim numbers: P49441, P49442, P49443, P49444, P49445, P49446, P49447, P49448 and P49449. Lines were created with a chain saw and machete. Claim posts were cut, labeled, appropriately placed and recorded on July 15 in the Dawson City Mine Recorders Office. Please see: Map # NTS 116C01 (CLAIMS: P49441-P49449)



Abrol and Robert preparing Claim Post!



Abrol and Robert erecting Claim Post



Sharon and Abrol with Claim Post 2



Sharon, Robert and Abrol at California Creek Base Camp

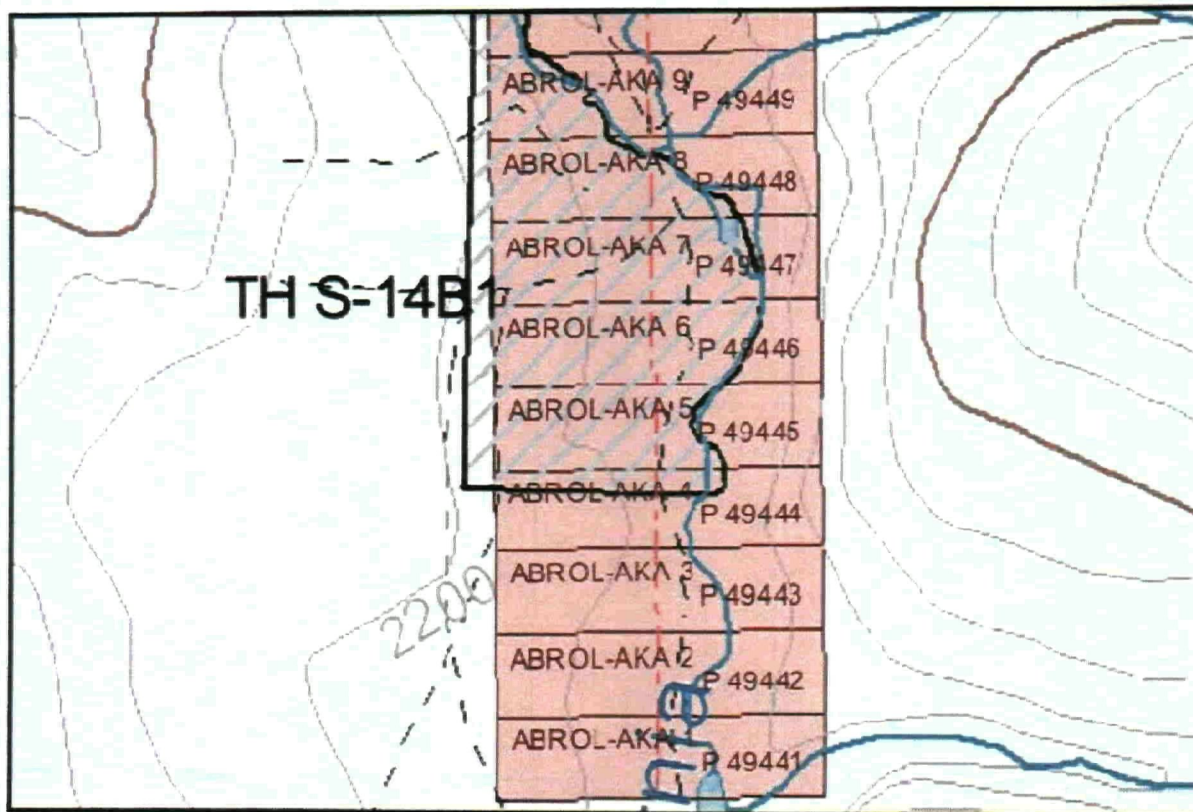

CLAIMS P49441 THROUGH P49449 CALIFORNIA CREEK

CONCLUSION AND RECOMMENDATIONS

The 1985 drill results reported by Wilshire Mortgage are encouraging. The remains of abandoned equipment found on the property (1 small and 2 large wash plants) suggest that substantial time and attention was awarded the area by previous miners. Some areas appear to have been extensively explored while other locations were less disturbed. Given the quality of randomly selected samples, taken at less than 1 meter in depth in 2009, it would seem reasonable to trench and bulk sample. We are encouraged by the results of our 2009 sampling program and feel these claims deserve further exploration.

COSTS AND REIMBURSEMENT REQUEST Total costs and expenditures for work completed in 2009 at California Creek are listed in the following: "FINAL SUBMISSION AND REIMBURSEMENT REQUEST". Receipts are available on request.

**ABROL-AKA GOLD MINING CORP
 ABROL KAKHAROV
 90 BURNDALE AVE.
 TORONTO, ONTARIO
 M2N1S7**

DECEMBER 31, 2009

**YUKON MINING INCENTIVE PROGRAM
 YUKON GEOLOGICAL SURVEY
 ENERGY, MINES AND RESOURCES
 BOX 2703 (K102)
 WHITEHORSE, YUKON Y1A 2C6 CANADA**

FINAL SUBMISSION AND REIMBURSEMENT REQUEST

09-068 NTS 116C01

AABM CORP. PROJECT NO: 09-YKAU-CCPM

PROSPECTING LEASE NO. ID00643

**PLACER CLAIM NO. P49441, P49442, P49443, P49444, P49445, P49446
 P49447, P49448, P49449**

TARGET EVALUATION PROGRAM (YMIP 09)

**Abrol Kakharov, Ph.D
 90 Burndale Ave.
 Toronto, Ontario
 M2N 1S7**

| | |
|---|-------------------|
| 1. Daily Living Expenses (4 days, 4 persons @ \$50 / day) | \$ 800.00 |
| 2. Contractors in Field: | |
| Geologist (Abrol Kakharov) 4 days @ \$450 day | \$ 1800.00 |
| Prospector (Robert Betts) 4 days @ \$350 day | \$ 1400.00 |
| Sampler (Sharon Betts) 4 days @ \$325 day | \$ 1300.00 |
| Sampler (Joan Betts) 4 days @ \$325 day | \$ 1300.00 |
| 3. Truck Rental (4x4, 1 week) | \$ 565.00 |
| 4. Chain Saw Rental (2 days) | \$ 70.00 |
| 5. Mileage (Truck-Dawson City to CA. Creek) 1120 km @ \$ 0.59 km | \$ 660.80 |

| | |
|---|--------------------|
| 6. Travel (within Yukon-Abrol Kakharov-WH to Dawson City RT) | \$ 340.00 |
| 7. Report Preparation (Joan & Robert Betts) | \$ 250.00 |
| TOTAL EXPENSES | \$ 8,485.80 |
| TOTAL EXPENSES X 50% | \$ 4,242.90 |
| TOTAL AMOUNT IN CONTRIBUTION AGREEMENT | \$13,000.00 |
| INTERIM CLAIM | \$ 0. |
| CURRENT CLAIM | \$ 4,242.90 |
| ALLOWABLE CURRENT CLAIM | \$ 4,242.90 |
| BALANCE UNUSED IN CONTRIBUTION AGREEMENT | \$ 8,757.10 |



YUKON MINING INCENTIVES PROGRAM (YMIP)

FINANCIAL SUMMARY REPORT

Submit completed form by February 16th to:

Yukon Mining Incentives Program
Energy, Mines and Resources
Government of the Yukon
102 - 309 Main Street
Box 2703 (K182), Whitehorse, Yukon, Y1A 2C8
E-mail: ymip@ecov.yk.ca

YMIP #09-068

PROJECT NAME: LARGE I EVAL (CALIF. CREEK)

| | |
|------------------|--|
| NAME AND ADDRESS | Please indicate any changes or omissions |
| | <u>ABROL-AMA GOLD MINING CORP.</u> |
| | <u>ABROL KAKHAROV, Ph.D</u> |
| | <u>90 BURNDALE AVE.</u> |
| | <u>TORONTO, ON M2N 1S7</u> |
| E-mail | Correct e-mail if it has changed. |

| |
|---|
| TOTAL PROJECT EXPENDITURES |
| Within the Yukon \$ <u>8,485.00</u> |
| Outside the Yukon \$ _____ |
| \$ of person days of paid employment <u>16 (4 PERSONS @ 4 DAYS)</u> |

| | |
|--|------------------|
| SUMMARY OF EXPENDITURES - Please attach copies of any receipts not yet submitted | |
| 1. Daily Living Expense No. of days x YG rate/person, per day <u>4 DAYS X \$50. PER PERSON/DAY</u> | \$ <u>800.00</u> |
| 2. Travel (state method: road, air, etc.) Truck - total km x YG rate/km <u>TRUCK 1120km @ \$.59 per km.</u> | \$ <u>660.80</u> |
| Air <u>AIR NORTH ABROL -WH TO DAWSON RT</u> | \$ <u>340.00</u> |
| Other _____ | \$ _____ |
| 3. Analysis/Assay Costs (specify sample type and priority) | \$ _____ |
| 4. Equipment Rentals/Supplies <u>TRUCK RENTAL - 1 WEEK</u> | \$ <u>565.00</u> |
| <u>CHAIN SAW RENTAL - 2 DAYS</u> | \$ <u>70.00</u> |
| _____ | \$ _____ |

| | | |
|-----|---|--------------------|
| 5 | Contractors (state name and type of work) | |
| | GEOLOGIST (ABROL KAIGAROV) 4 DAYS @ \$450. DAY | \$ 1800.00 |
| | PROSPECTOR (ROBERT BETTS) 4 DAYS @ \$350. DAY | \$ 1400.00 |
| | SAMPLER (SHARON BETTS) 4 DAYS @ \$325. DAY | \$ 1300.00 |
| | SAMPLER (JOAN BETTS) 4 DAYS @ \$325. DAY | \$ 1300.00 |
| 6. | Line Cutting No. of km x price/km _____ | \$ _____ |
| 7. | Geochemical Survey (specify sample type) No. of km x price/km _____ | \$ _____ |
| 8. | Geophysical Survey (specify type of survey) No. of km x price/km _____ | \$ _____ |
| 9. | Trenching (specify equipment used and price/foot) | \$ _____ |
| 10. | Drilling (specify diameter or percussion and rod size) No. of meters x price/meter _____ | \$ _____ |
| 11. | Reclamation (specify type) _____ | \$ _____ |
| 12. | Report Preparation JOAN AND ROBERT BETTS | \$ 250.00 |
| 13. | Other Expenses (specify) | \$ _____ |
| | _____ | \$ _____ |
| | _____ | \$ _____ |
| | _____ | \$ _____ |
| | _____ | \$ _____ |
| | TOTAL EXPENDITURES | \$ 5,455.00 |

IMPORTANT NOTE

The deadline for submission of the Summary or Technical Report for this project is March 31st. A holdback of 15% of the 'Contribution Funds' will be retained pending receipt and approval of the Summary or Technical Report and a signed copy of the Final Submission Form (if the Summary or Technical Report for this project is being submitted at this time please ensure that a signed copy of the Final Submission Form is attached).

Access to Information and Protection of Privacy Act
 The information requested on this form is collected under the authority of and used for the purpose of administering the Yukon Mining Incentives Program. Questions about the collection and use of this information can be directed to the Mineral Development Geologist, Department of Energy, Mines and Resources, Yukon Government, Box 2703 (C102), Whitehorse, Yukon Territory, Y1A 2C6 (867) 456-3526.



YUKON MINING INCENTIVES PROGRAM (YIMP)

FINAL SUBMISSION FORM

Submit completed forms by March 31st to:

Yukon Mining Incentives Program
Energy, Mines and Resources
Government of the Yukon
102 - 300 Main Street
Box 2703 (K102), Whitehorse, Yukon, Y1A 2C6
E-mail: yimp@egm.gov.yk.ca

YIMP #09-068 _____

PROJECT NAME: TARGET EVAL (CALIF. CREEK)

NAME AND ADDRESS

Please indicate any changes or omissions

ABROL- AKA GOLD MINING CORP

ABROL KAKHAROV, Ph.D

90 BURNHAM F AVE

FORONTO, ON M2N 1S7

E-mail: kakharov@abrol-aka.com

Correct e-mail if it has changed: kakharov2004@mail.ru

SUMMARY OR TECHNICAL REPORT CHECKLIST

- Please check appropriate sections.
- **MUST** be completed and submitted with your final report.
- Ensure all required information is attached to prevent delays in processing your claim

| INFORMATION | INCLUDED | NOT APPLICABLE |
|---|----------|----------------|
| 1. Description/implementation of work | <u>X</u> | |
| 2. Location map(s) of completed work | <u>X</u> | |
| 3. Colored maps at adequate scale showing | | |
| - Geology | | <u>X</u> |
| - Geophysics | | <u>X</u> |
| - Geochemistry | | <u>X</u> |
| 4. Results | | |
| - Drill core assays | | <u>X</u> |
| - Geochemistry data | <u>X</u> | |
| - Geophysical data | | <u>X</u> |
| 5. Drill collar location map(s) | | <u>X</u> |
| 6. Drill hole sections | | <u>X</u> |
| 7. Typewritten drill logs | | <u>X</u> |
| 8. Longitudinal Section(s) | | <u>X</u> |
| 9. Reconnaissance photos | <u>X</u> | |
| 10. Fence Plans | | |
| 11. Detailed list of project expenditures | <u>X</u> | |
| 12. Copies of receipts | | |
| 13. Final submission form signed and dated | <u>X</u> | |
| 14. Hardcopy of report with maps and data | <u>X</u> | |
| 15. Electronic Version of report, etc in PDF format | <u>X</u> | |

Access to Information and Protection of Privacy Act

The information requested on this form is collected under the authority of and used for the purpose of administering the Yukon Mining Incentives Program. Questions about the collection and use of this information can be directed to the Mineral Development Geologist, Department of Energy, Mines and Resources, Yukon Government, Box 2703 (K102), Whitehorse, Yukon Territory, Y1A 2C6 (867) 456-3826.

The Department of Energy, Mines and Resources may verify all statements related to and made on this form, in any previously submitted reports, interim claims and in the Summary or Technical Report which accompanies it. I certify that:

1. I am the person, or the representative of the company or partnership, named in the Application for Funding and in the Contribution Agreement under the Yukon Mining Incentives Program.
2. I am a person who is nineteen years of age or older, and I have complied with all the requirements of the same program.
4. I hereby apply for the final payment of a contribution under the Yukon Mining Incentives Program (YMIP) and declare the information contained within the Summary or Technical Report and the Financial Summary Report to be true and accurate.

Signature of Applicant _____ Date _____

Name (print) ABRQL KANCHAROV, Ph.D.

Your opinions are requested to help evaluate the formal objectives of the program, client satisfaction with regard to its administration and delivery and to determine if any changes or improvements are indicated.

1. Have you previously applied for financial assistance through YMIP? YES NO

a. If YES, proceed to Question 2.

- b. If NO, what was your reason for not applying:
- Desire to maintain confidentiality
 - Moral objection to YMIP
 - Thought it was a handout program
 - Not aware of YMIP
 - To reach a peak to apply
 - Other _____

2. How important was YMIP funding to your decision to undertake the proposed project?

| | Strongly Agree | Considerable Agree | Somewhat Disagree | Strongly Disagree |
|---|----------------|--------------------|-------------------|-------------------|
| a. Without YMIP the project would not have gone ahead. | == | - | - | - |
| b. The project would have gone ahead, but on a reduced scale. | .. | - | - | - |
| c. The project would have gone ahead with or without YMIP. | 0 | - | - | - |

Comments: Did Previously apply. Agree with a.

3. Did YMIP help us let or additional funding and/or secure an option deal? YES NO

If YES, please provide details: No additional funding or options.

4. Regarding the YMIP application's process, please indicate your agreement or disagreement with the following statements.

| | Strongly Agree | Somewhat Agree | Somewhat Disagree | Strongly Disagree |
|---|----------------|----------------|-------------------|-------------------|
| a. Written program information and forms were clear. | - | - | 0 | - |
| b. Questions and inquiries were answered promptly. | - | - | - | - |
| c. Applications were fairly and consistently handled. | - | - | 0 | - |
| d. Project evaluations were done in a timely manner. | - | - | - | - |
| e. Interim claims and payments were processed in a timely manner. | - | - | - | - |

5. If you have any suggestions for improvements or changes to YMIP or any other additional comments, please include them below.

Strongly agree with a,b,c,d, and e above