

# Calder Creek Watershed Placer Exploration Project

YMEP Project 17 – 031 Technical Report - March 26<sup>th</sup>, 2018

The area that was further evaluated is on the Dawson Mining District maps 115-O-14b in the Calder Creek watershed, where placer claims CAL 1 to 28 are, and Placer Lease IDO 1448 was located approximately 32 km in a straight line SSE of Dawson City. Calder Creek and its watershed flows SE into Quartz Creek from the Eldorado Summit. Approximate location is:

Lat: 63 deg. 48 min. 13 sec. north

Long: 139 deg. 10 min. 11 sec. west

The Placer Lease work program was completed and the Lease broken into 6 placer claims – CAL 30 to CAL 35.

## Summary of previous exploration in the Calder Creek watershed:

There is considerable loess deposits on the right limit of Calder Creek which could be covering a gold bearing paleochannel. Over time the creek was pushed to the left side of the valley where it currently is. In 2016 gold was found in 2 drill holes by Ground Truth Exploration on the edge of the right limit bench on the CAL 1 claim which supported that hypothesis.

Based on previous work and 2016 drilling it is now known that it is gold bearing. A shaft previously dug in Mike Power's shafting program produced a small amount of gold and intersected bedrock at 22 to 23 ft. The conclusions resulting from his program, was that the flood plain of Calder Creek is underlain by black muck in the area of the shaft and likely along the length of the flood plain. The modern creek has incised neither the black muck nor the underlying barren red gravels.

This likely accounts for the reported lack of gold in the modern creek channel. Exploration and further testing by drilling and shafting has recovered little or no gold in the main valley.

Research was done at the archives and on line from assessment reports and elsewhere. There is little information on work done on Calder Creek. Zeke Ogilvie reportedly prospected Calder Creek after 1896, as well as many other Klondike Creeks. There are reports of old workings on the lower creek, and geochemical surveys have been done. The creek has been staked previously over many years but there are no records of extensive prospecting or mining being done. At the top right fork a soil sample of 60 ppb was found in 1989 by Robert Truswell for Placer Dome. Bill Mann in his report for Klondike Star Mineral Corporation in 2005 states that a high of 10 ppb found up the slope above the upper right fork of Calder Creek. Taku Gold has found anomalous

gold values in soil of up to 24 ppb in the area of the prospecting lease. (see map #10)

In 2012 a 3 mile prospecting lease ID01067 was staked by Grant Allan on the upper Calder Creek. Mike Power had staked 13 claims below the lease and had ground penetrating radar and In 2013 two drill programs were completed on Calder creek, both with 6" auger drills. The first in June by Gateway Drilling saw 241.5 ft. of drilling completed – 12 holes over 2 lines. The lease was broken into 25 claims placer claims (CAL1- 25). Traces of gold were recovered from two of the holes.

In September, 2013 JB Drilling completed 9 holes for a total of 201 ft. Gravel was drilled into but no gold was recovered. Interestingly, one hole, on the ridge between Calder Creek and a tributary encountered water at 12 ft. which rose in the hole about 9 ft..

In August 2015 Gateway Drilling, with an improved drill, did a drill program, but did not encounter significant gravel or any gold.

In May and June, 2016 Ground Truth Exploration did a DC Resistivity Survey Aerial Photogrammetry survey and 6 hole RAB Drilling Program. As mentioned earlier, gold was found in 2 drill holes on the edge of the right limit bench on the CAL 1 claim.

There are economic pay channels in the surrounding creeks and tributaries and there is a lack evidence of any systematic exploration and testing done on Calder Creek. Economic gold deposits have been successfully mined, and are still being mined on Little Blanche Creek and Canyon Creek to the east, both tributaries of Quartz Creek as is Calder Creek. Quartz Creek on both sides of Calder Creek has been mined over the past 10 years and is still being mined by Stuart Schmidt. Eldorado Creek, one of the Klondike's richest creeks is a few kilometers to the north.

#### **YMEP 2017-31 2017-18 Work program:**

The 2 shafts dug were by KMorgan Exporation (see maps and logs, diagram)

From June 30<sup>th</sup> to July 5<sup>th</sup>, with Kane Morgan and Charles Blanchard completed the approved work program on Placer Lease IDO 1448. Shaft 2017-1 was dug, 3 ft. x 3 ft. x 11 ft. deep with electric jackhammer and shovel on the Lease. The shaft was dug into soft schist material and no gravel or gold was found.

From Feb. 20<sup>th</sup> to March 10<sup>th</sup>, Kane Morgan and Aaron Mendelson dug shaft 2018-2, 3 ft.x 3 ft. x 30 ft. deep.

Low Impact Drilling (Sean Payne) did 2 drilling programs on the CAL 1 claim (see maps and logs). The first was on August 15<sup>th</sup> and 16<sup>th</sup> and the second, September 26<sup>th</sup>.

The objective was to do a grids of drill holes to bedrock, to determine what gold may be present.

3 different companies with 6" auger drills on Nodwell type all terrain tracks were scheduled to do drill programs. Being on tracks they could have accessed most areas on the claims, but all became unavailable or cancelled their contracts, due to other contracts coming up including lucrative government contracts, and other problems with their schedules. Very disappointing!

Testing of samples from Shaft 2018 - 1 and from Low Impact Drilling program GA1703 will be done in the Spring when it warms up and the ice melts. Results will be attached to this report.

**Recommendations:**

An additional two shafts should be dug to bedrock with drifting along the bedrock in 4 directions for at least 3 ft. to get a least a 2 cu. yd. sample to test. Auger drilling using a track mounted drill on claims on the right limit of Calder Creek on CAL 26 to CAL 30 claims. Initially there would be 10 drill holes spread out over most of these claims. Depending upon results, where significant gold is found (minimum 50 mg. in a drill hole) some shafts to bedrock should be dug at those locations.

# Location Map 1 – Calder Creek Placer claim CAL 33 P519341

Shaft 2017 – 1: Shafting done by KMorgan Exploration  
June 30 to July 5, 2017

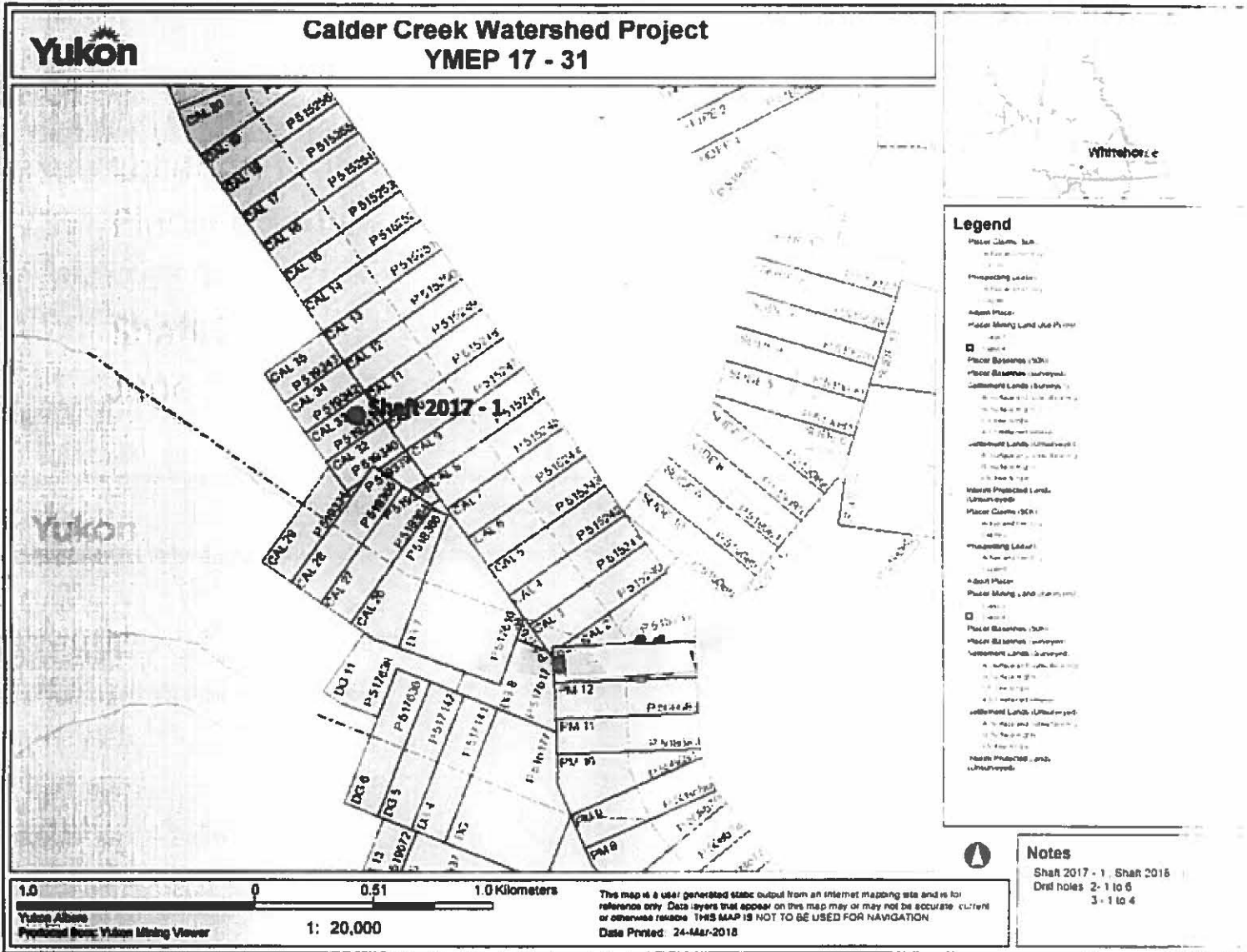



# Location Map 2 - Calder Creek YMEP 17-031 Shaft 2018-1

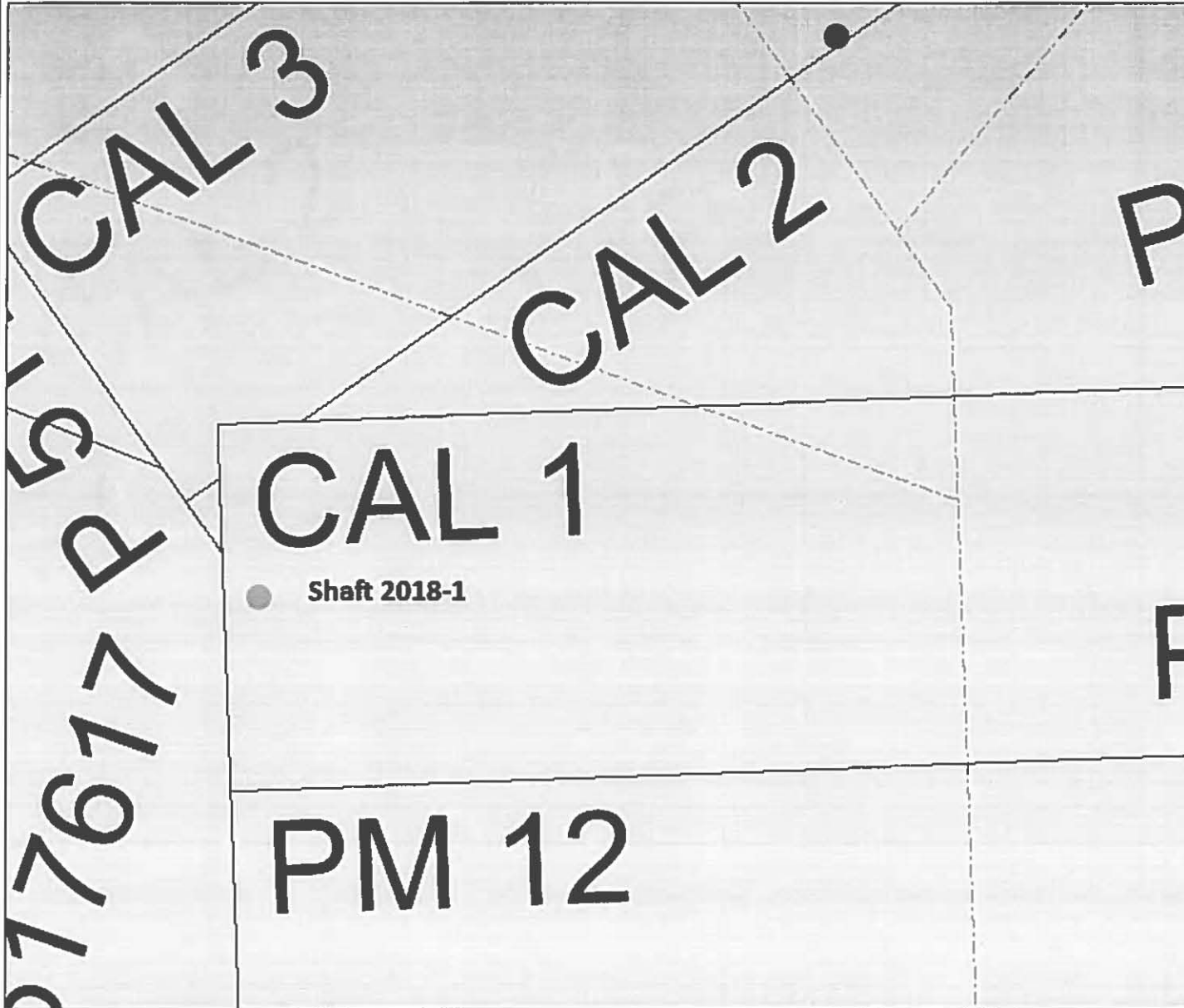

### Legend

- Placer Claims (50K)
  - Active and Pending
  - Expired
- Prospecting Leases
  - Active and Pending
  - Expired
- Adjoin Placer
  - Placer Mining Land Use Permit
    - Class 3
    - Class 4
- Placer Baselines (50K)
  - Placer Baselines (surveyed)
- Placer Claims (50K)
  - Active and Pending
  - Expired
- Prospecting Leases
  - Active and Pending
  - Expired
- Adjoin Placer
  - Placer Mining Land Use Permit
    - Class 3
    - Class 4
- Placer Baselines (50K)
  - Placer Baselines (surveyed)

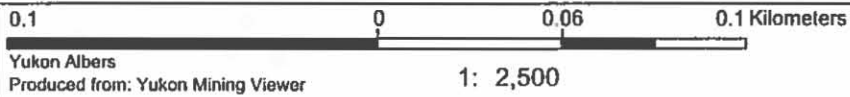

This map is a user generated static output from an Internet mapping site and is for reference only. Data layers that appear on this map may or may not be accurate, current, or otherwise reliable. THIS MAP IS NOT TO BE USED FOR NAVIGATION.  
Date Printed: 26-Mar-2018



### Notes

Shaft 2018-1 on Placer claim  
CAL 1 P515238



# Location Map 3 – Calder Creek

Placer claim CAL 4 P515241

Low Impact Drilling drill programs GA1702 (6 holes 1 to 6)



Cal	
PLACER_CLAIM_ID	16724
GRANT_NUMBER	P 515241
DRAFTING_TENURE_TYPE	Placer
REGULATION_TYPE	P
TENURE_STATUS	Active
CLAIM_LABEL	Cal 4
CLAIM_NAME	Cal
CLAIM_NUMBER	4
OWNER_NAME	Grant N. Allan - 100%
STAKING_DATE	6/19/2013 9:00:00 AM
RECORDED_DATE	6/20/2013 9:00:00 AM
EXPIRY_DATE	6/20/2018
DISTRICT_NAME	Dawson
SHAPE	Polygon
SHAPE.AREA	92630.039832
SHAPE.LEN	1522.126987

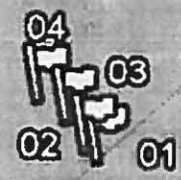

**Location Map 4 – Calder Creek**

**Placer claim CAL 1 P515238**

**Low Impact Drilling drill programs GA1702 (6 holes 1 to 6)**

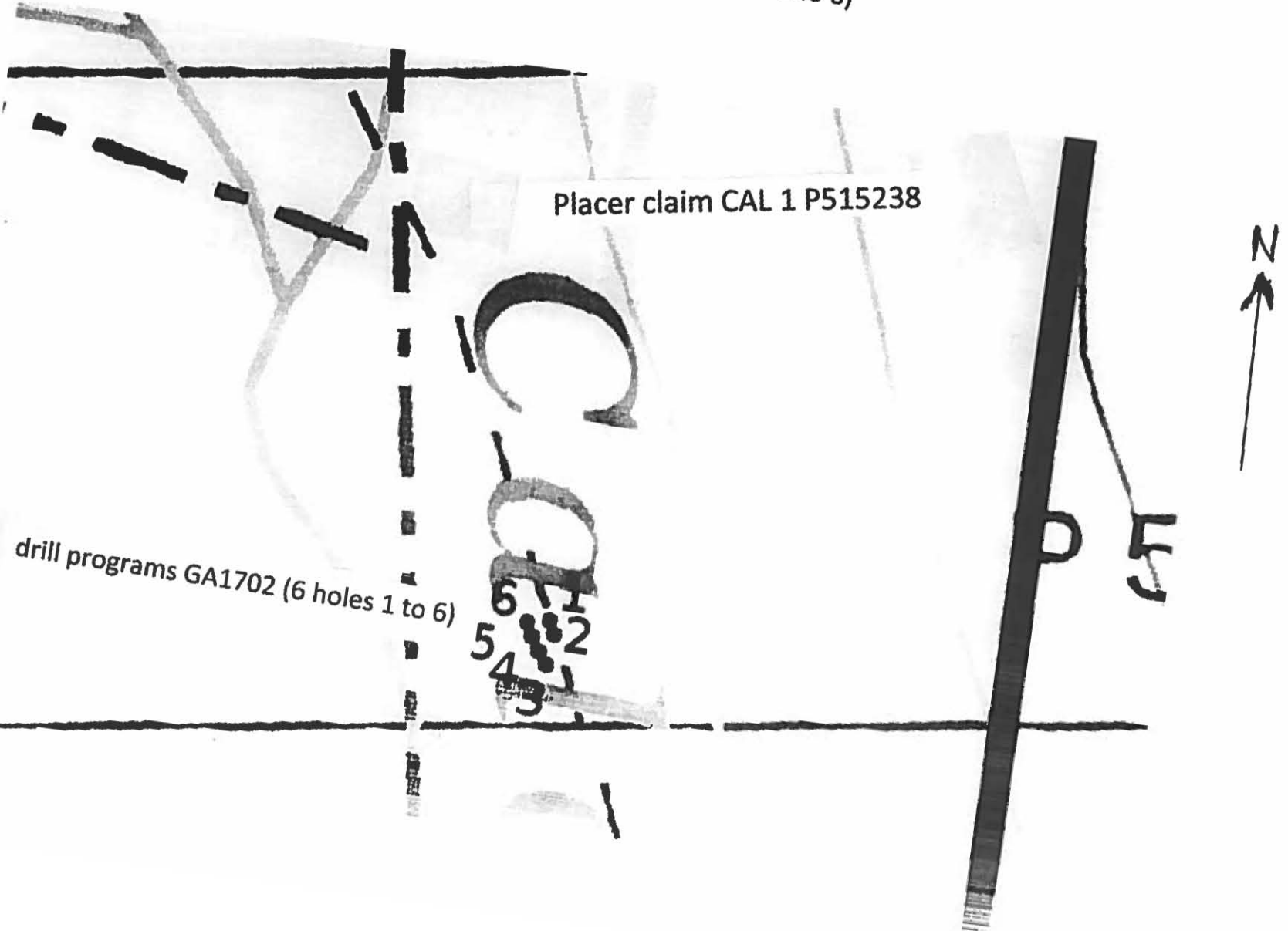

Log Calder Shaft 2017 – 1 on Placer claim CAL 33 P519341

Approved work program of 1 shaft on 1 mile Placer Lease IDO 1448  
on 1<sup>st</sup> tier bench on right limit Calder Creek.

Completed June 30 to July 5<sup>th</sup>, 2017.

Shafters – Kane Morgan and Charles Blanchard

0- 2 ft. humus, soil and mud

2 – 11 ft. hard schist type rock – no gravel, no gold



# Low Impact Drilling – Drill Log



Low Impact Drilling, Box 761, Dawson City, YT, Y0B 1G0, 867 993 3302

<b>Customer:</b> Grant Allan		
<b>Location:</b> Calder Creek	<b>Driller:</b> Sean Payne	<b>Date:</b> 2017-08-16

<b>Hole:</b> GA1702-01	<b>GPS:</b> 7 V 590216 7076405
<b>Depth (feet)</b> 0 to 7 7	<b>Material</b> Angular sand & gravel (unwashed) Bedrock refusal
<b>Hole:</b> GA1702-02	<b>GPS:</b> 7 V 590216 7076406
<b>Depth (feet)</b> 0 to 7 7	<b>Material</b> Angular sand & gravel (unwashed) Bedrock refusal
<b>Hole:</b> GA1702-03	<b>GPS:</b> 7 V 590217 7076407
<b>Depth (feet)</b> 0 to 15 15	<b>Material</b> Angular sand & gravel (slightly rounded) Bedrock refusal
<b>Hole:</b> GA1702-04	<b>GPS:</b> 7 V 590215 7076406
<b>Depth (feet)</b> 0 to 6 6	<b>Material</b> Angular sand & gravel (unwashed) Bedrock refusal
<b>Hole:</b> GA1702-05	<b>GPS:</b> 7 V 590215 7076405
<b>Depth (feet)</b> 0 to 12 12	<b>Material</b> Angular sand & gravel (slightly rounded) Bedrock refusal
<b>Hole:</b> GA1702-06	<b>GPS:</b> 7 V 590215 7076403
<b>Depth (feet)</b> 0 to 12 12	<b>Material</b> Angular sand & gravel (slightly rounded) Bedrock refusal

**Low Impact Drilling – Drill Log**

#04005



**Low Impact Drilling, Box 761, Dawson City, YT, Y0B 1G0, 867 993 3302**

<b>Customer:</b> Grant Allan	<b>Hole type:</b> 4.5" auger
<b>Location:</b> Calder Creek	<b>Driller:</b> Sean Payne
	<b>Date:</b> Sept 25, 2017

**Hole:** GA1703-01

**GPS:** 7 V 589960 7076860

<b>Total Depth (ft)</b>	<b>Depth (ft)</b>	<b>Material</b>
25	0 to 17	Angular sand & small gravel (unwashed)
<b>Cumulative Depth (ft)</b>	17 to 18	Angular sand & small gravel (unwashed) w/water
25	18 to 25	Frozen, angular sand & small gravel (unwashed)
	25	Refusal

**Hole:** GA1703-02

**GPS:** 7 V 589970 7076852

<b>Total Depth (ft)</b>	<b>Depth (ft)</b>	<b>Material</b>
29	0 to 18	Angular sand & small gravel (unwashed)
<b>Cumulative Depth (ft)</b>	18 to 19	Angular sand & small gravel (unwashed) w/water
54	19 to 29	Frozen, angular sand & small gravel (unwashed)
	29	Refusal

**Hole:** GA1703-03

**GPS:** 7 V 589978 7076842

<b>Total Depth (ft)</b>	<b>Depth (ft)</b>	<b>Material</b>
25	0 to 20	Angular sand & small gravel (unwashed)
<b>Cumulative Depth (ft)</b>	20 to 21	Angular sand & small gravel (unwashed) w/water
79	21 to 25	Frozen, angular sand & small gravel (unwashed)
	25	Refusal

**Hole:** GA1703-04

**GPS:** 7 V 589982 7076838

<b>Total Depth (ft)</b>	<b>Depth (ft)</b>	<b>Material</b>
21	0 to 17	Angular sand & small gravel (unwashed)
<b>Cumulative Depth (ft)</b>	17 to 18	Angular sand & small gravel (unwashed) w/water
100	18 to 21	Frozen, angular sand & small gravel (unwashed)
	21	Refusal

Feb 20 to March 10  
 2018  
 K. Morgan  
 A. Mendelson

# Shaft Diagram + Log

Calder shaft 2018-1 on ~~Calder~~ CAL 1  
 placer claim P5152

