

SUMMARY FOR YMEP #20-123

The following is a summary of the 2020 YMEP program that took place on Brimstone Gulch. The target and work plan proposed was to continue a hand-shaft down to somewhere between 50 to 60 feet deep and hopefully hit placer gravels or bedrock. The target was reached with a final depth of 56ft, where gravels were struck, yielding trace gold just below contact

All work was carried out by 3 people, Kane Morgan, Robin Netro and Ben Barnes. A hand-shaft with dimensions of 4x4ft and a depth of 56ft was dug with two electric jackhammers, a 38pd Hilti and a 68pd Makita, powered by a 6000W Honda generator. Equipment was mobilized by pick-up truck and trailer, followed by snow-machine and tub trailer once access was off-road. Material was removed by shovel with a hand cranked windlass. A total volume of approximately 900 square feet was excavated, at the end of the 2020 YMEP season, from February 25, 2021 to March 24, 2021. The shaft is located on the left limit side of a left limit tributary of Brimstone Gulch, at the border of co-discovery claims Fire 10-11. (Red Dot on map below) This season a trail was established along the limit of this tributary, beginning at the main valley of Brimstone Gulch, continuing off of the end of the cat trail.

The layering is as follows: from 0-15.5ft, it consisted of brown mud with organics and the occasional reddish, rusty looking stain. From 15.5-20ft, it consisted of a pungent smelling black muck. A significant change appears from 20-22ft consisting of a quartz/feldspar/mica/schists mixture, bound together with a sticky brown clay. From 22-31ft it consisted of a mixture of pungent mud/quartz mixture chunks/sticks/ice/ appearance of dark grey mud chunks.

Water striations layer throughout 31-39ft in a brown mud. After this from 39-44ft the next layer of significance appears consisting of the same quartz/feldspar/mica/schists mixture, only the size of the majority of the rocks are three to five times as large and appear slightly travelled with the odd round edge and a small amount of sands. Pyrites make a first appearance, along with a microscopic piece of gold, panned from a 15L bucket. More and more quartz pieces have cavities, and pieces with what appears to be a tin mineralization.

From 44-56ft it consisted of a thick, heavy, volcanic dark brown mud that smelled awful. No rocks, roots or anything else other than the mud for 12ft. The last few inches of 55ft held a layer of volcanic ash that was 1-5 inches thick. From this ash layer to 56ft striations of sand composed of previous quartz layers appears. At 56ft a small bone was discovered at gravel contact with vertical ice striations starting at 56ft going upwards to 53-54ft.

A 35L sample was taken of this new material which consisted of ½-2 inch rocks of the same quartz/feldspar/mica/schists mixture from previous layers of significance. Trace gold was discovered and fine sands were more abundant and obvious than found at 39-44ft. Density and consistency seems not be a mixture of previous layers but a solid, water sorted assortment. Round rocks with in chip style mixture with round sands. More depth is needed to confirm whether or not this actually the alluvial channel but all appearances are positive indicators.

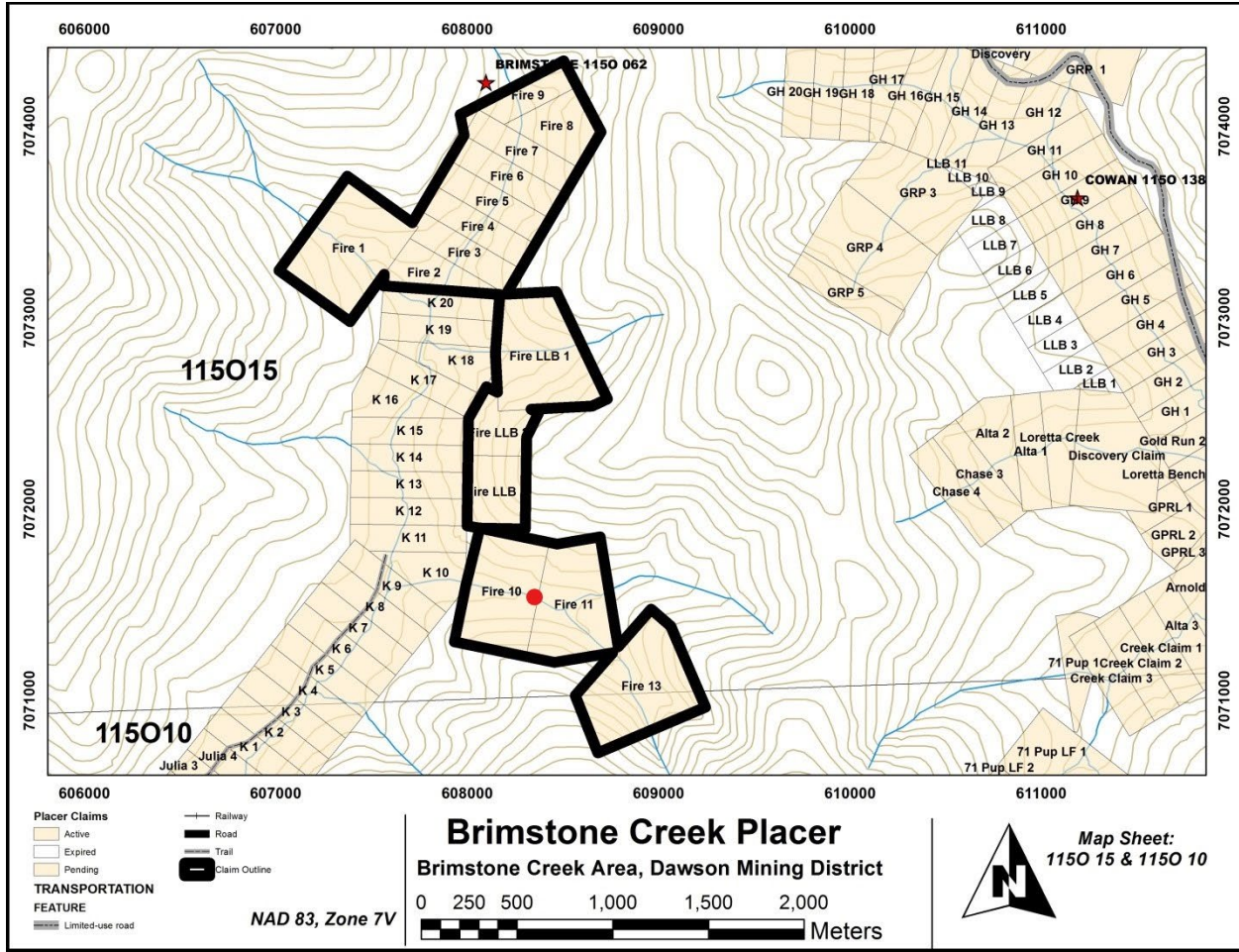







0-15.5
ft

Brown Mud w/
occasional reddish stain

15.5
- 20 ft

Pregnant Black Muck

20-
22 ft

Quartz / Mica / Feldspar /
schists mixture / brown
clay

22 ft
- 31 ft

Mixed mud w/ chunks of
quartz mixture / sticks /
dark grey mud chunks
First appearance

31-
39 ft

Water Striations
in Brown Mud

39-
44 ft

Trace Gold
Quartz / Mica / Feldspar / schists
mixture, pyrites First appearance

44-
56 ft

Heavy, Stinky Dark
Brown Volcanic Mud.

← Volcanic Ash
1-5 inch
thick

Sands / Gravel contact.
1st Bones discovered.
Trace Gold
on Quartz Mixture
appearing just past 56ft, beginning of
gravel