

Dear Cam.

A.E.Thom

Box # 712

Summerland B.C.

VOH 120

I had a call from (Nels Harper) by (Radio Phone) he said tell you the weather is like Summer they moved into the (Creek) on the 13Th of may and they phoned me the night of the 23Rd at 9-30 PM .That is quite a surprise to be into (Clear Creek) that early.

In the envelope you will find the Data I spoke to you on the phone.

Hoping it is of

good use to you

Youre Sincerely

A.E.Thom

A handwritten signature in cursive script that reads "A.E. Thom". The signature is written in dark ink and is positioned below the typed name.

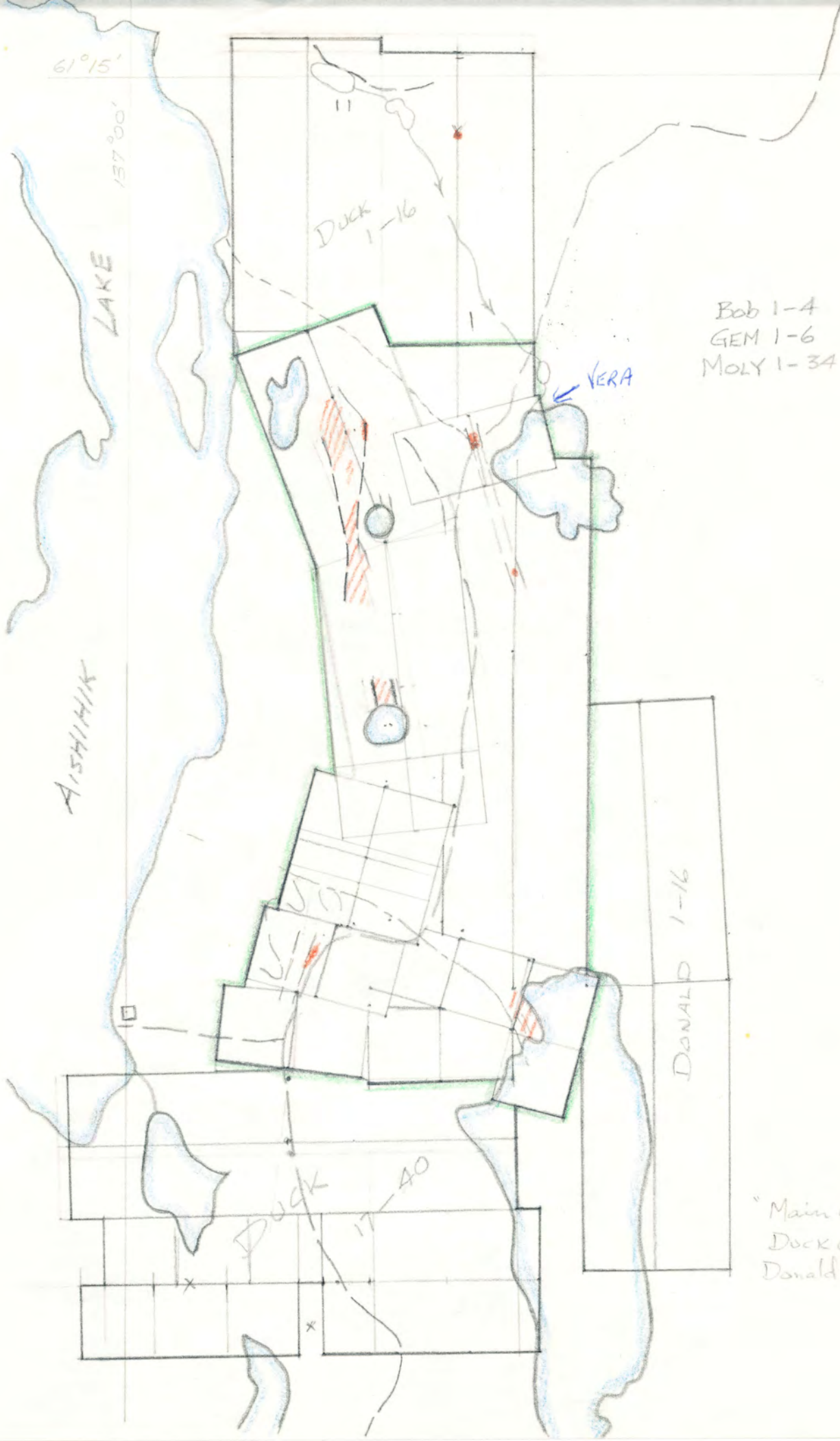

61°15'

157°00'

LAKE

AISHIHIK

Duck 1-16

VERA

Bob 1-4
GEM 1-6
MOLY 1-34

DONALD 1-16

Duck 17-40

"Main Gp."	44
Dock Gp.	40
Donald Gp.	16
	100

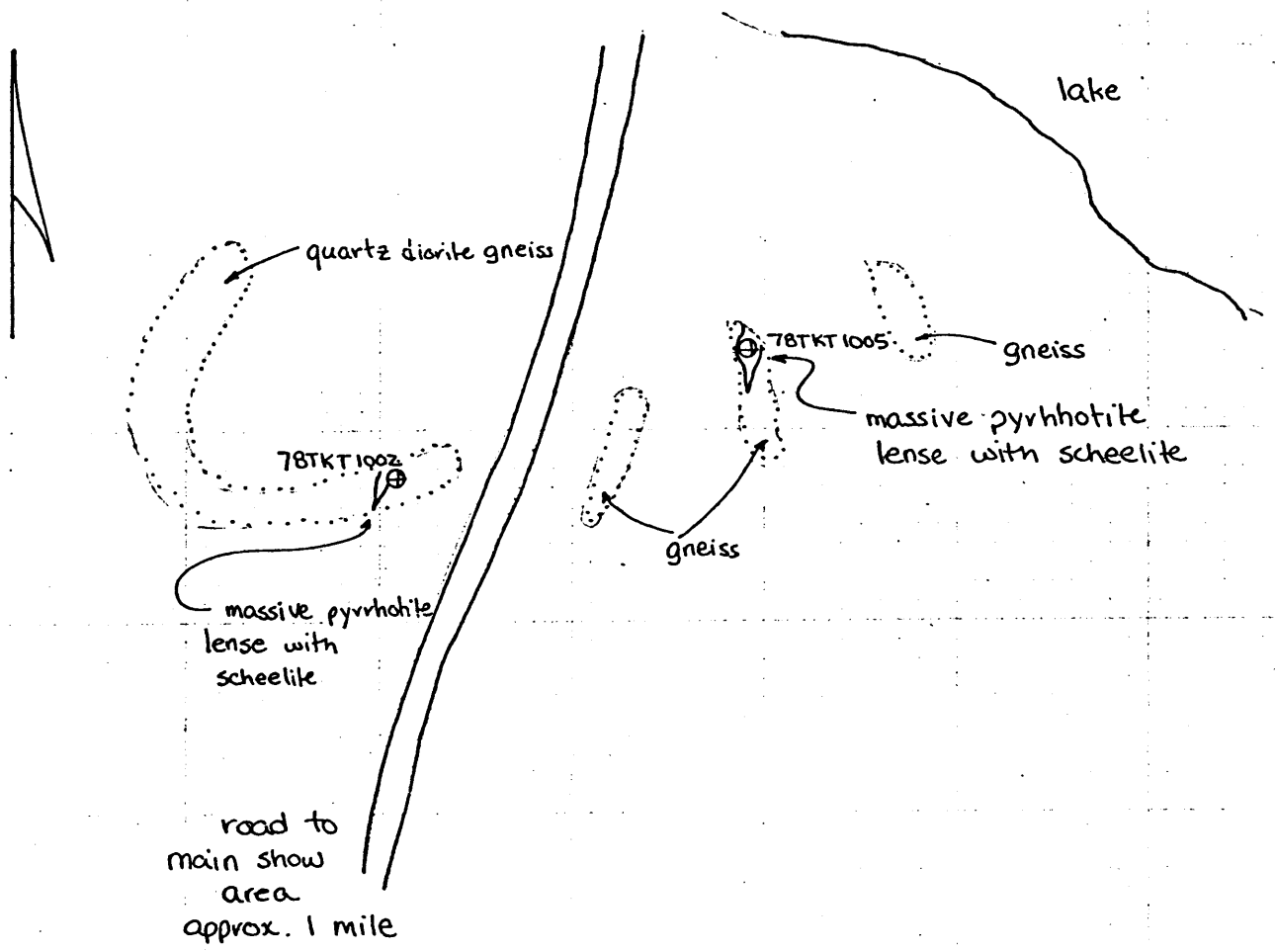

FIGURE 1b

AISHIHIK LAKE PROSPECT
 GEOLOGICAL SKETCH MAP
 PIT 3

SCALE: 1 cm = 20 m (approximate)
 NTS - 115 H

geochem results

	W (ppm)
78TKT 1002	850
78TKT 1005	300

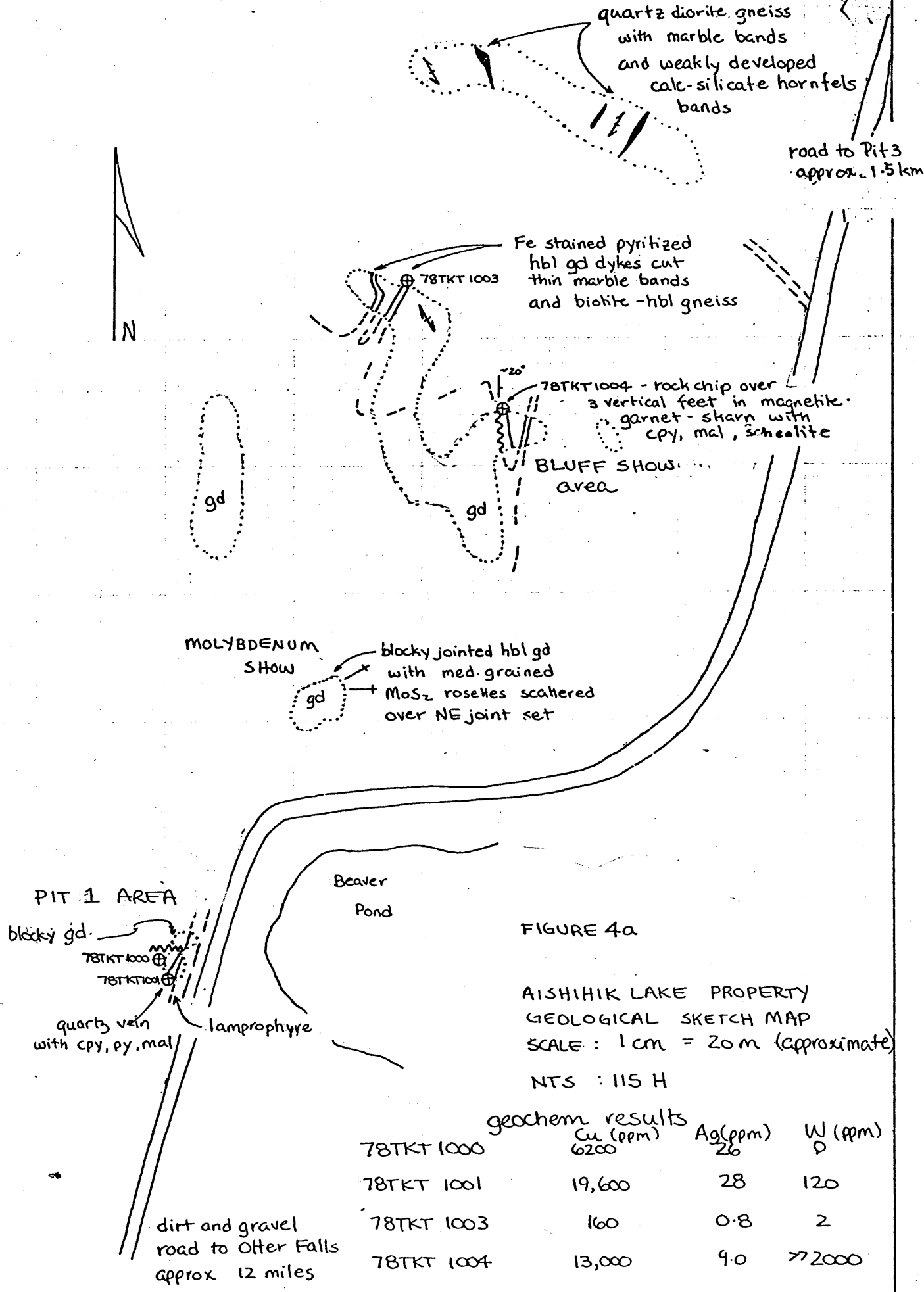

FIGURE 4a

AISHIHIK LAKE PROPERTY
 GEOLOGICAL SKETCH MAP
 SCALE: 1 cm = 20 m (approximate)

NTS : 115 H

geochem results

	Cu (ppm)	Ag (ppm)	W (ppm)
78TKT 1000	6200	26	0
78TKT 1001	19,600	28	120
78TKT 1003	160	0.8	2
78TKT 1004	13,000	9.0	>2000

Rossbacher Laboratory

GEOCHEMICAL ANALYSTS & ASSAYERS

2225 S. SPRINGER AVE.,
 BURNABY, B. C.
 CANADA
 TELEPHONE: 299-6910
 AREA CODE: 604

CERTIFICATE OF ANALYSIS

CERTIFICATE NO. *8183*

TO:

INVOICE NO.

PROJECT

DATE ANALYSED *Nov. 23/7*

No.	Sample	pH	Mo	Cu	Ni	Co	Mn	Fe	Ag	Zn	Pb	W	Sn	No
01	<i>78TKT/1000</i>		<i>20</i>	<i>6200</i>	<i>52</i>	<i>42</i>	<i>420</i>	<i>1.8</i>	<i>26.0</i>	<i>56</i>	<i>66</i>	<i>0</i>	<i>0</i>	01
02	<i>1001</i>		<i>168</i>	<i>19600</i>	<i>90</i>	<i>86</i>	<i>240</i>	<i>3.3</i>	<i>28.0</i>	<i>118</i>	<i>108</i>	<i>120</i>	<i>0</i>	02
03	<i>1005</i>		<i>22</i>	<i>1740</i>	<i>270</i>	<i>240</i>	<i>60</i>	<i>6.4</i>	<i>0.8</i>	<i>6</i>	<i>12</i>	<i>300</i>	<i>0</i>	03
04	<i>1002</i>		<i>52</i>	<i>540</i>	<i>16</i>	<i>16</i>	<i>240</i>	<i>1.7</i>	<i>0.6</i>	<i>14</i>	<i>10</i>	<i>850</i>		04
05	<i>1003</i>		<i>12</i>	<i>160</i>	<i>18</i>	<i>26</i>	<i>320</i>	<i>4.5</i>	<i>0.8</i>	<i>34</i>	<i>16</i>	<i>2</i>		05
06	<i>1004</i>		<i>170</i>	<i>13,000</i>	<i>74</i>	<i>94</i>	<i>280</i>	<i>>10.0</i>	<i>9.0</i>	<i>150</i>	<i>28</i>	<i>>>2000</i>		06
07														07
08														08
09														09
10														10
11														11
12														12
13														13
14														14
15														15
16														16
17														17
18														18
19														19
20														20
21														21
22														22
23														23
24														24
25														25
26														26
27														27
28														28
29														29
30														30
31														31
32														32
33														33
34														34
35														35
36														36
37														37
38														38
39														39
40														40

Certified by

R. Rossbacher

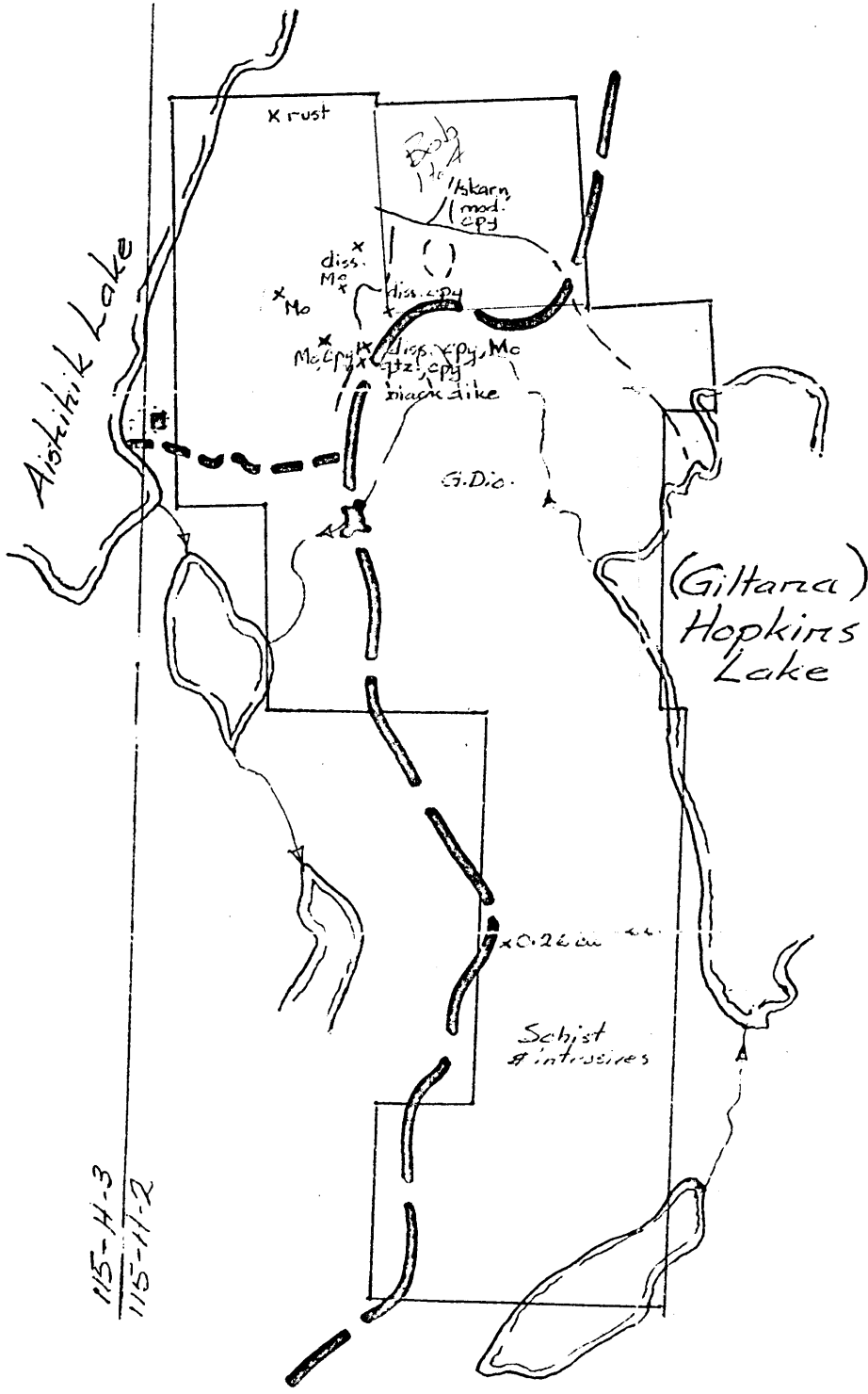

Total No. Claims 41

1" = 1/2 mi.

staked

staked
just N of turnoff into Lake, about
mile 27(?)

